

B.M. 11763 "E" in ditch E. of, corner of N.L. Mohawk  
 B.M. 12003 NW cor. conc. porch W.S. House at S.E. cor. 13th & Arrowhead  
 Stationing on N.R.

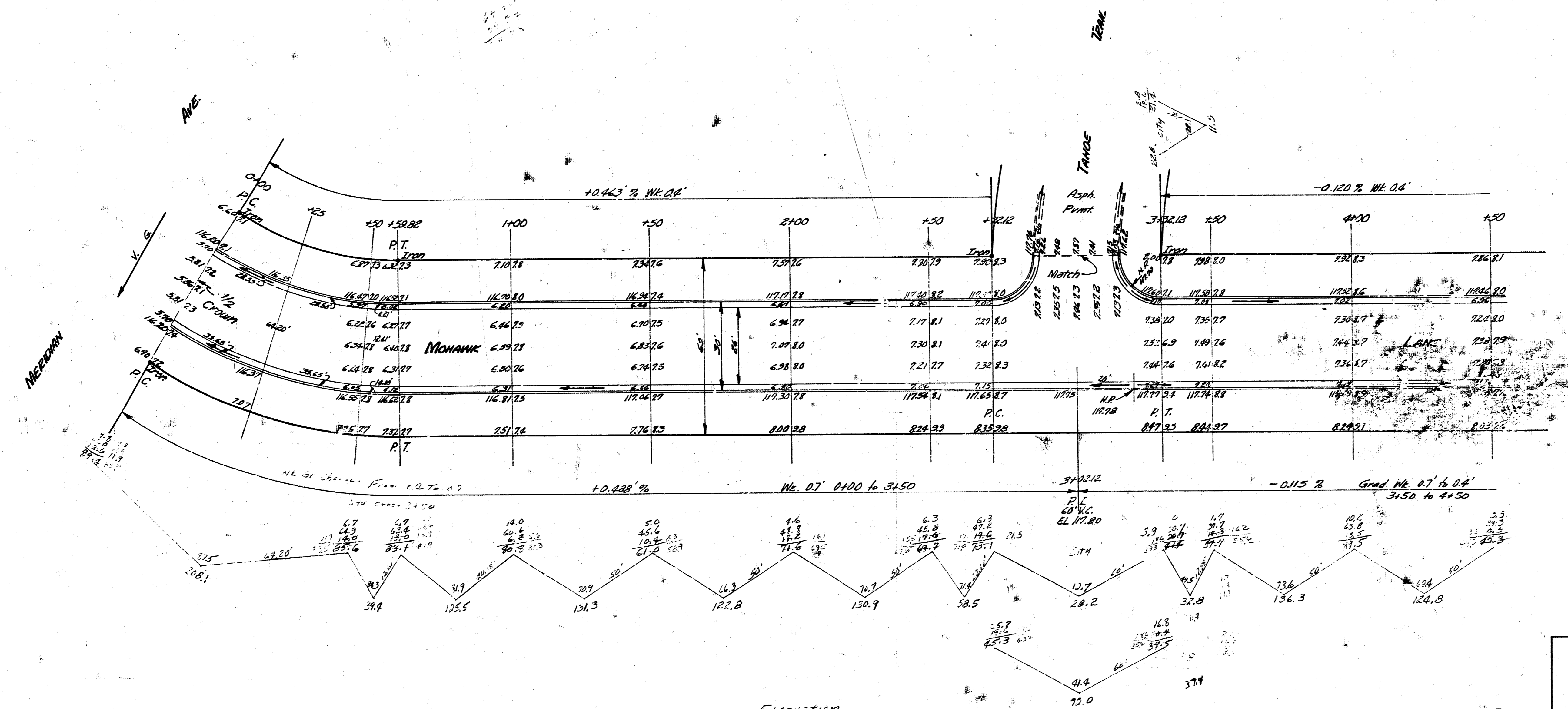

Station	Chord Length	Chord Bearing	Delta	Delta
0+00 P.C.	10.65'	16.56'	2° 33' 48"	16° 13' 30"
1+25	17.07'	36.99'	6° 46' 51"	27° 48' 42"
2+50	10.65'	16.56'	2° 33' 48"	16° 13' 30"

Prop		Excavation		City	
Cut	Fill	Cut	Fill	Cut	Fill
260.7.3	0	187.9	0		
210.5	0	18.8	0		
265.8 cu yds		206.7 cu yds			

**MOHAWK LANE**  
 E.L. MERIDIAN TO WL. IROQUOIS  
 26-2-30 A.C.  
 CITY OF WICHITA KANSAS  
 B.E. SMITH CITY ENGINEER  
 AUGUST 1956 PROJ. NO. C14-217

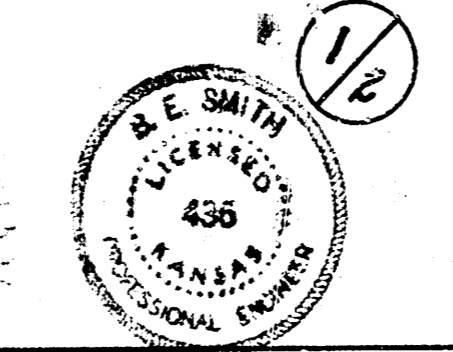

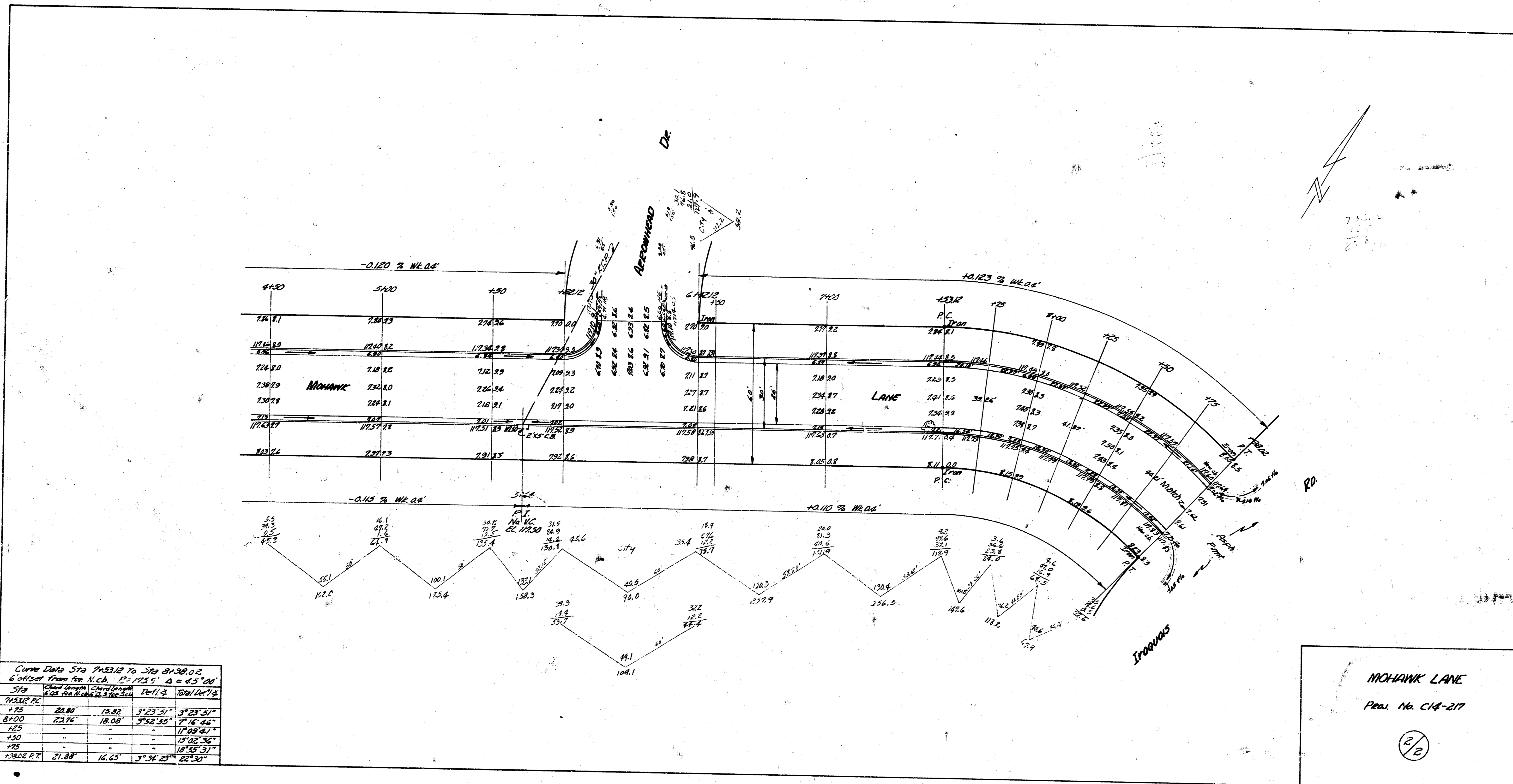

Curve Data Sta 7+32.12 to Sta 8+38.02  
 6' offset from N.C.B.  $R=1735'$   $\Delta=45^{\circ}00'$

Sta	Clearance	Clearance	Dist. to	Total Dist.
7+32.12	28.80	15.98	3'25.51"	3'25.51"
8+00	23.76	18.08	3'52.35"	7'17.86"
8+25	-	-	-	11'09.67"
8+50	-	-	-	15'02.36"
8+75	-	-	-	18'55.31"
8+38.02	21.88	16.65	3'34.25"	22'30"

MOHAWK LANE  
 Plan No. C14-217  
 2/2