

B.M. 108.01 "G" IN GLOBE E. END RAD. S.E. COR. EDWARDS & WHEELER  
 B.M. 10776 "G" IN GLOBE W. END RAD. S.W. COR. MONROE & RICHMOND  
 BASE LINE ON e

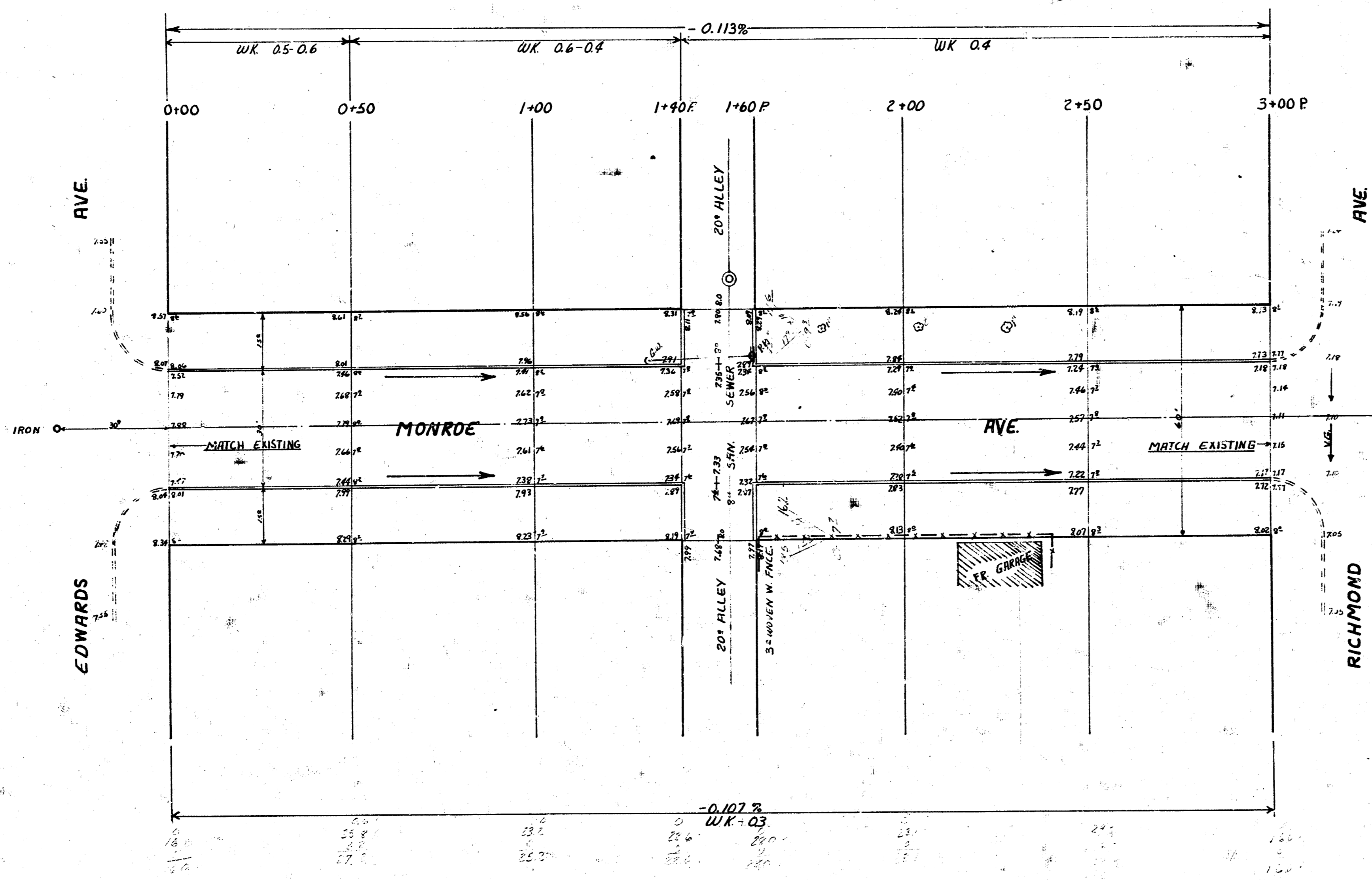

REVISED  
 NIGHT 3:55:59  
 10/27/59

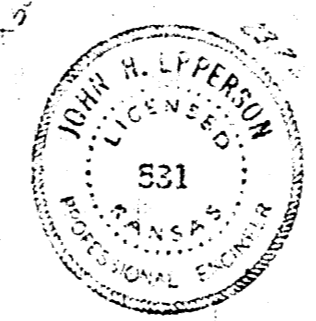
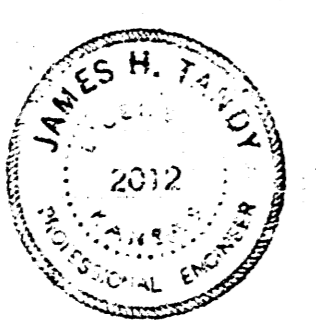

TOTAL EXCHG  
 PROR CITY  
 256.2 367  
 100 264 100 264  
 357.2 373.2

**MONROE AVE.**  
 E.L. EDWARDS W.L. RICHMOND  
 30' CONC. & CB.  
 CITY OF WICHITA, KANSAS  
 B.E. SMITH CITY ENGINEER  
 DATE APRIL 1959 PROJ. No. C19-23