

# MURRAY AVENUE

S.L. LOT 4, BLOCK I, WESTLINK VILLAGE 12th ADDN.-S.L. 17th ST.  
DAKS575059

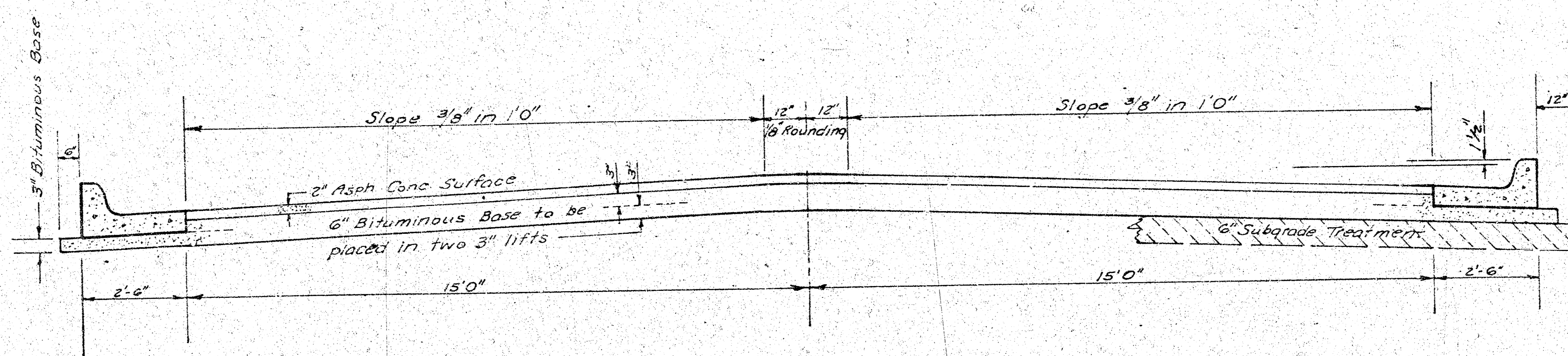

## TYPICAL SECTION

### 35' ASPHALTIC CONCRETE PAVEMENT WITH BITUMINOUS BASE

The A.C. Pavement between the comb curb & gutter shall be paid as Sq.Yds. 8" A.C. Pavement (6" Bituminous Base).  
The Bituminous Base under the comb curb & gutter shall be paid as Sq.Yds. 3" Bituminous Base.

A TACK COAT OF EMULSIFIED ASPHALT (SS-1H) SHALL BE APPLIED AT AN APPROXIMATE RATE 0.05 GALLONS PER SQ YD BETWEEN LIFTS OF ASPHALTIC MATERIALS WHEN ORDERED BY THE ENGINEER. TACK COAT WILL NOT BE PAID FOR DIRECTLY AND SHALL BE CONSIDERED AS SUBSIDIARY TO PRICE BID FOR ASPHALTIC PAVEMENT.  
BITUMINOUS BASE AND ASPHALTIC CONCRETE WEARING SURFACE SHALL BE PLACED WITH A LAYDOWN MACHINE HAVING AUTOMATIC ELECTRONIC CONTROLS FOR CROWN AND GRADE. CONSTRUCTION JOINTS IN EACH LIFT SHALL BE STAGGERED A MINIMUM DISTANCE OF 1' WITH JOINTS IN PRECEDING LIFTS AND PLACED SUCH THAT A JOINT WILL BE CONSTRUCTED ON THE CENTERLINE IN THE TOP LIFT.

### DETAIL OF TRANSVERSE CONSTRUCTION JOINTS

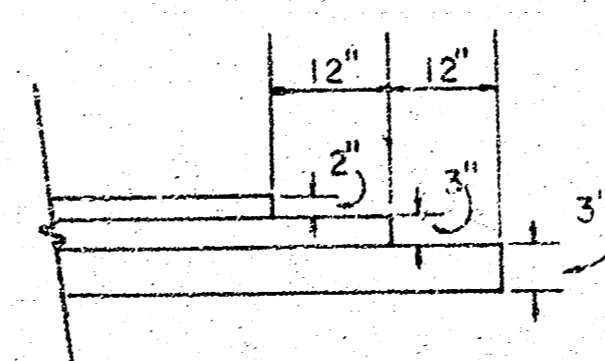

TRANSVERSE CONSTRUCTION JOINTS SHALL BE CONSTRUCTED IN FLEXIBLE BASE PAVEMENTS AT LOCATIONS WHERE PAVEMENT TEMPORARILY ENDS TO FACILITATE FUTURE PAVEMENT CONSTRUCTION AS SHOWN BY DETAIL. THE COST OF CONSTRUCTING THE TRANSVERSE CONSTRUCTION JOINTS SHALL NOT BE MEASURED OR PAID FOR DIRECTLY BUT SHALL BE INCLUDED IN THE BID PRICE FOR SQUARE YARDS OF ASPHALTIC CONCRETE PAVEMENT.

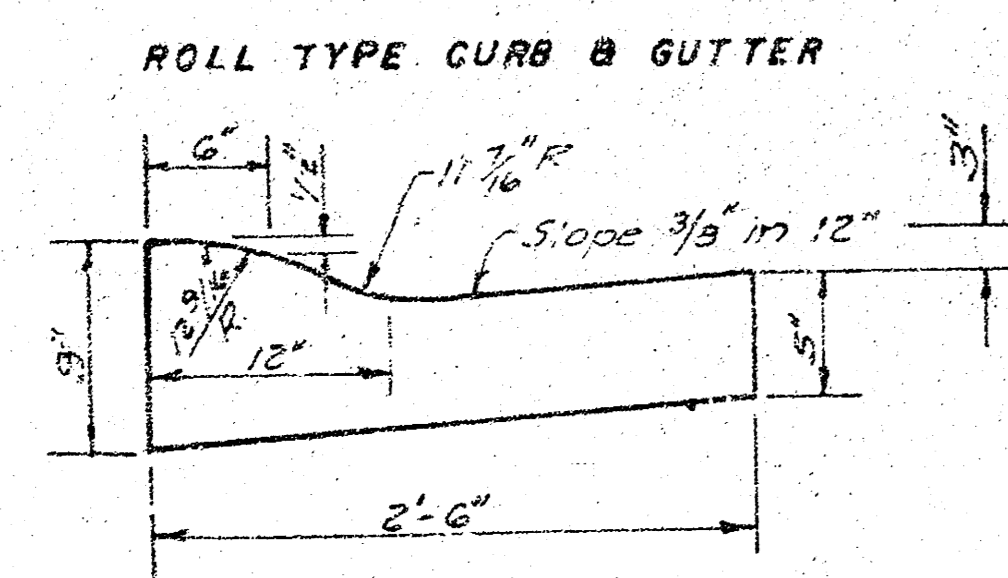
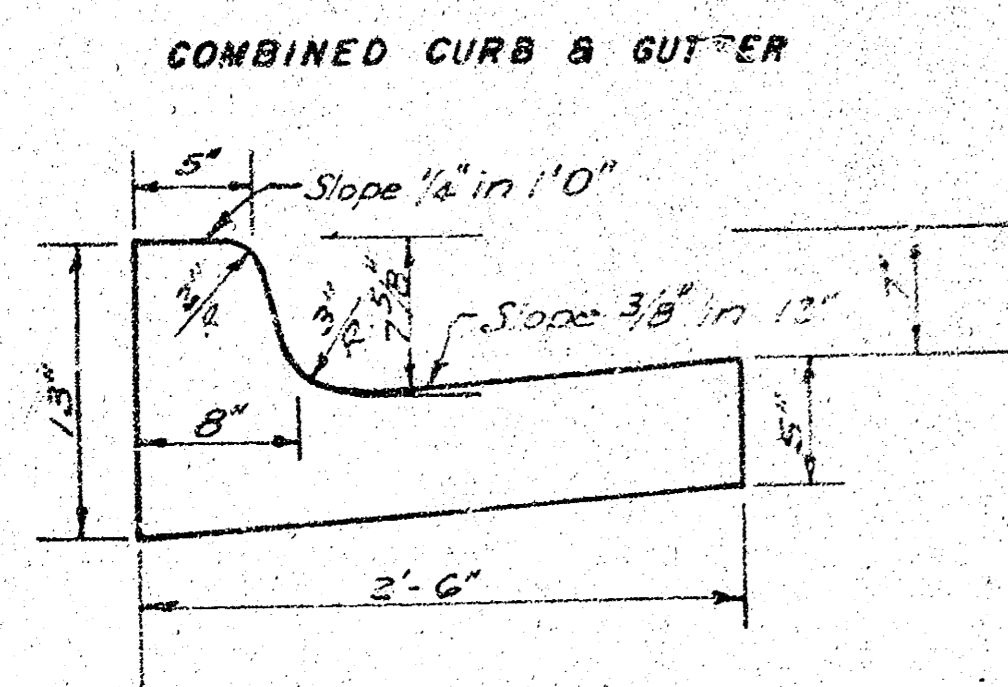

CITY OF WICHITA KANSAS

DEPARTMENT of PUBLIC WORKS - Engineering Division.

R. W. LINN CITY ENGINEER

DATE \_\_\_\_\_ Proj. No. DAKS575059

FILMED FROM THE BEST AVAILABLE COPY .....

B.M. 158.58 N.W. Corner Concrete Porch, W.S. House at 1502 Murray  
 B.M. 157.10 N.E. Corner Concrete Patio Porch at Rear of House at 9304 Nantucket  
 @ is @ Murray

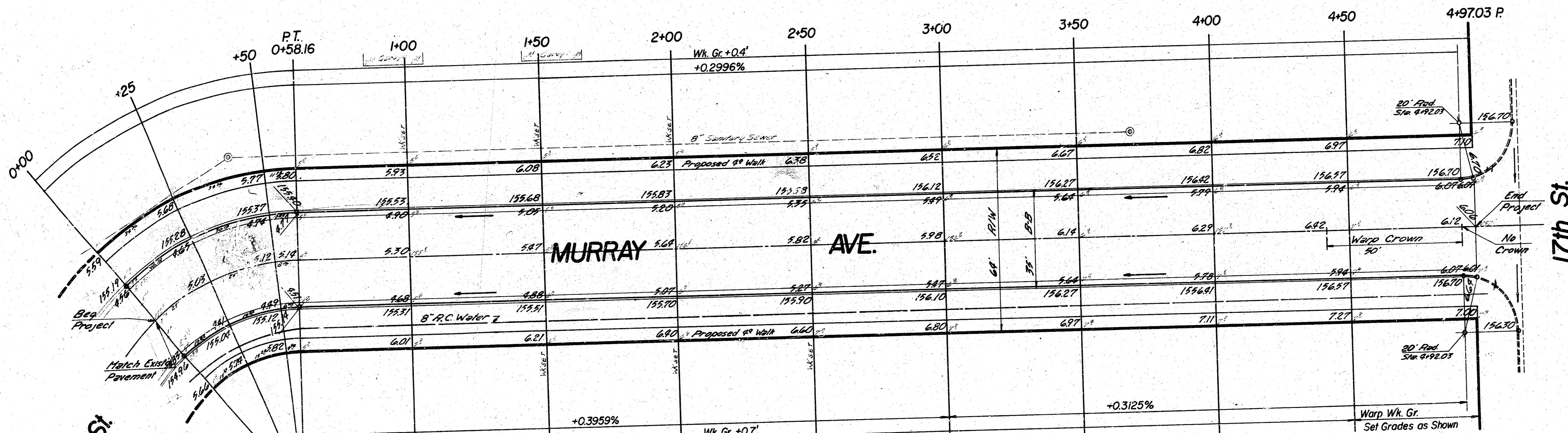
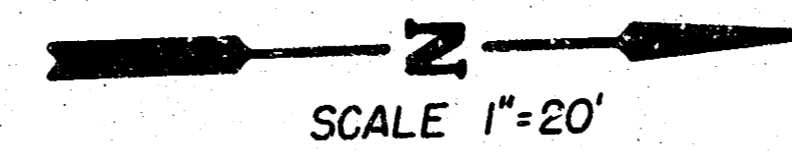

$\Delta = 40^\circ 31' 18''$  R. = 32.00' T. = 30.2% L. = 38.16' LC. = 36.95'

CURVE DATA BASED ON  $\frac{E}{R}$  RAD.  $\Delta = 207.909^\circ$

STA.	ARC.	CHORD LENGTH		DEFLECTION	
		CHORD LENGTH	DEF. @ END	DEFLECTION	TOTAL DEFLECTION
0+00	-	-	-	-	0+00'00"
0+25	25.0	32.50	17.31	8'44"03"	8'44"03"
0+50	50.0	62.50	17.31	8'44"03"	17'28"06"
0+58.16	8.16	10.64	5.67	2'51"05"	20'19"09"

Def. @ 20' = 20' 96" 18" 11" 17"

**SUB-GRADE**  
 TYPE OF SUB-GRADE TREATMENT SHALL BE DETERMINED BY THE FIELD ENGINEER. SUB-GRADE TREATMENT MAY CONSIST OF LIME TREATMENT, CEMENT TREATMENT, SUB-GRADE MODIFICATION, OR ANY COMBINATION OF THESE.

**NOTE TO FIELD ENGINEER & CONTRACTOR**  
 Grade posting and clear right-of-way for proposed sidewalk. Compact fill in sidewalk area. TO BE CONSTRUCTED BY "OTHERS".

3+00  
 P.I.  
 No V.C.

**EARTHWORK**  
 Excavation 1169.3 Comp. Fill 29.1  
 +10% 116.9 +10% 2.9  
 Total 1286.2 C.Y. 32.0 C.Y.

Manipulation 2043.3 S.Y.

**CAUTION**  
 UNDERGROUND UTILITIES  
 • For location with K & E or Southwestern Bell Telephone Co. for location

MURRAY AVE.  
 S.L. Lot 4, Blk. 1, Westlink Village  
 12th Addn. - S.L. 17th

FILMED FROM THE BEST AVAILABLE COPY .....