

**OLIVER STREET
FROM DOUGLAS AVE. TO CENTRAL AVE.
PROJECT NO. C16-147**

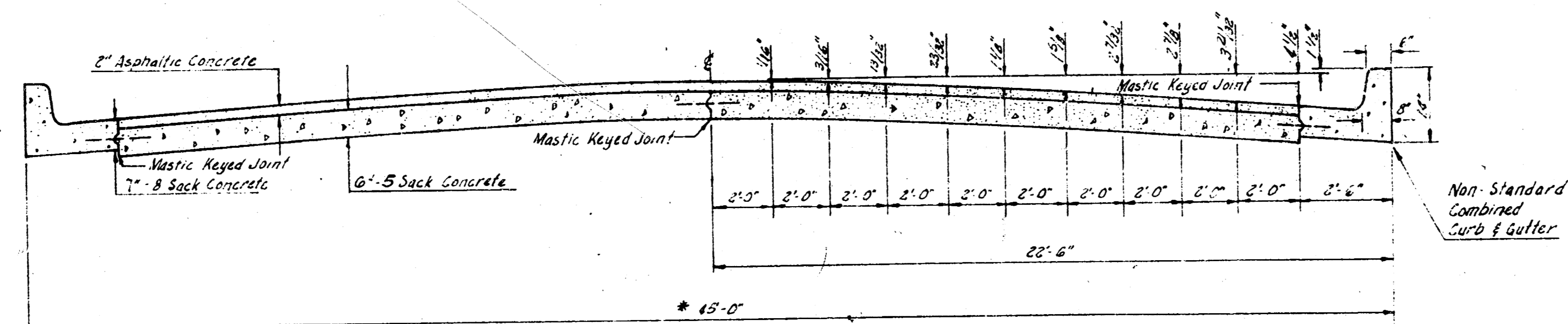

TYPICAL SECTION
NOT TO SCALE * 47'-0" From Sta 24+25 to Sta 25+72.9
(Other dimensions to correspond)

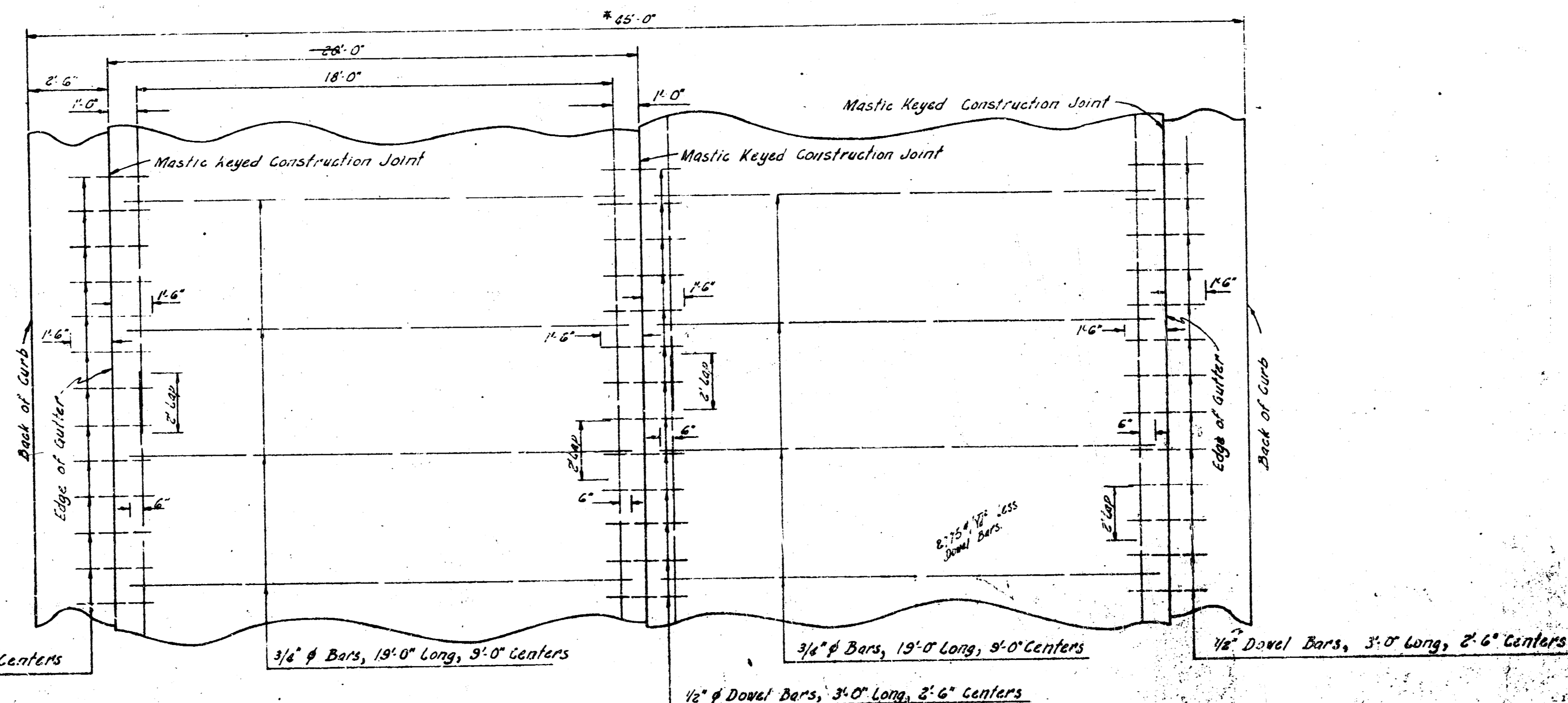

STEEL PATTERN
NOT TO SCALE
USE 3/4" Ø BARS EXCEPT WHERE NOTED

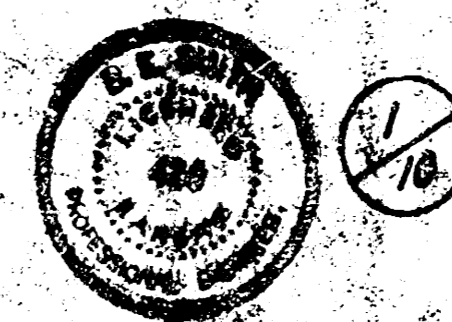

B.M. 168.54 Standard S.W. Cor. Douglas & Oliver
 B.M. 173.63 NW Cor. 1st Step House #254 Oliver
 B.M. 178.65 Top 1/2" Pipe in W.S. Flag Pole Base in School Yard
 B.M. 168.46 + On S.W. Cor. Retaining Wall, N.E. Cor. 1st & Oliver
 B.M. 177.84 Standard S.E. Cor. Oliver & Central, 10' W. & 4' N. of S.E. Cor.
 Stationing & Base Line 5' East of W. Prop. Line

EXCAVATION			
PROP.	11184	CITY	87.0
PLUS 10%	1118	PLUS 10%	87
	12302		95.7

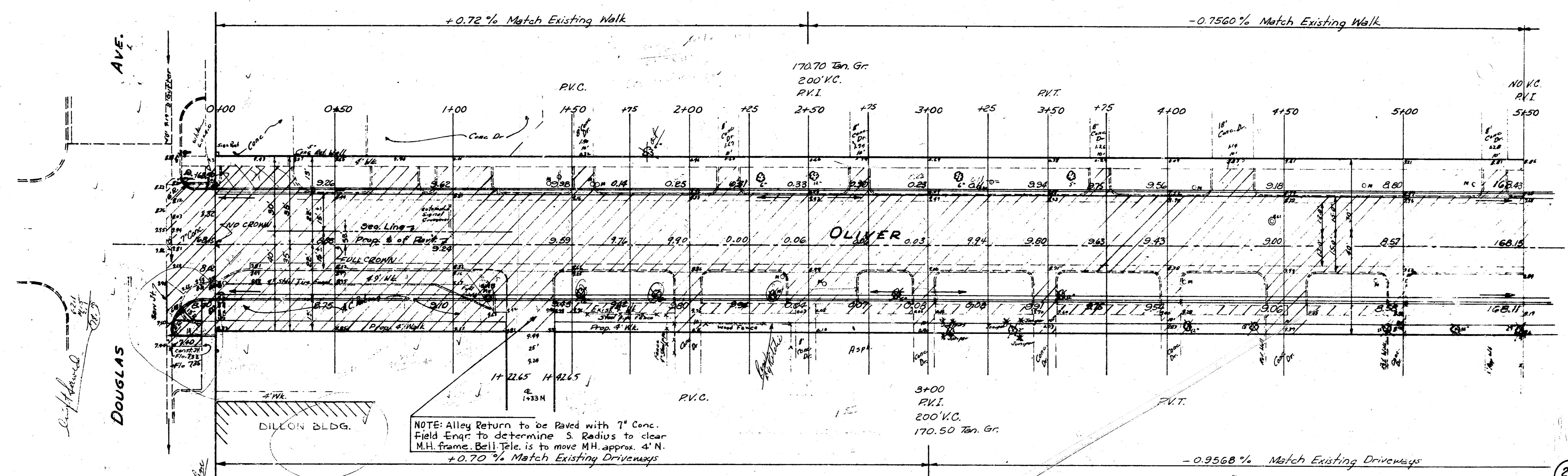

NOTE: Alley Return to be Paved with 7" Conc.
 Field Engr. to determine S. Radius to clear
 M.H. frame. Bell Tele. is to move M.H. approx. 4' N.
 +0.70% Match Existing Driveways

NOTE TO CONTRACTOR & FIELD ENGINEER:
 The City Engineer is to approve schedule of Work.
 The intersections of 1st St. & 2nd St. are to be
 paved with Hi-early Cement and construction of
 these intersections to be accomplished in as short
 time as possible and opened to traffic as soon as
 concrete is sufficiently cured. Hi-early cement used
 to be incidental to the project.

22.5
 11.25
 22.5
 11.25
 31.0
 15.5
 45.0

OLIVER
 DOUGLAS TO CENTRAL
 40'-2'-44" & 42'-2'-46"
 CITY OF WICHITA
 B.E. SMITH CITY ENGINEER
 MARCH 1957 PROJ. C16-147

11-17-57
 P. S. & D. M. K.

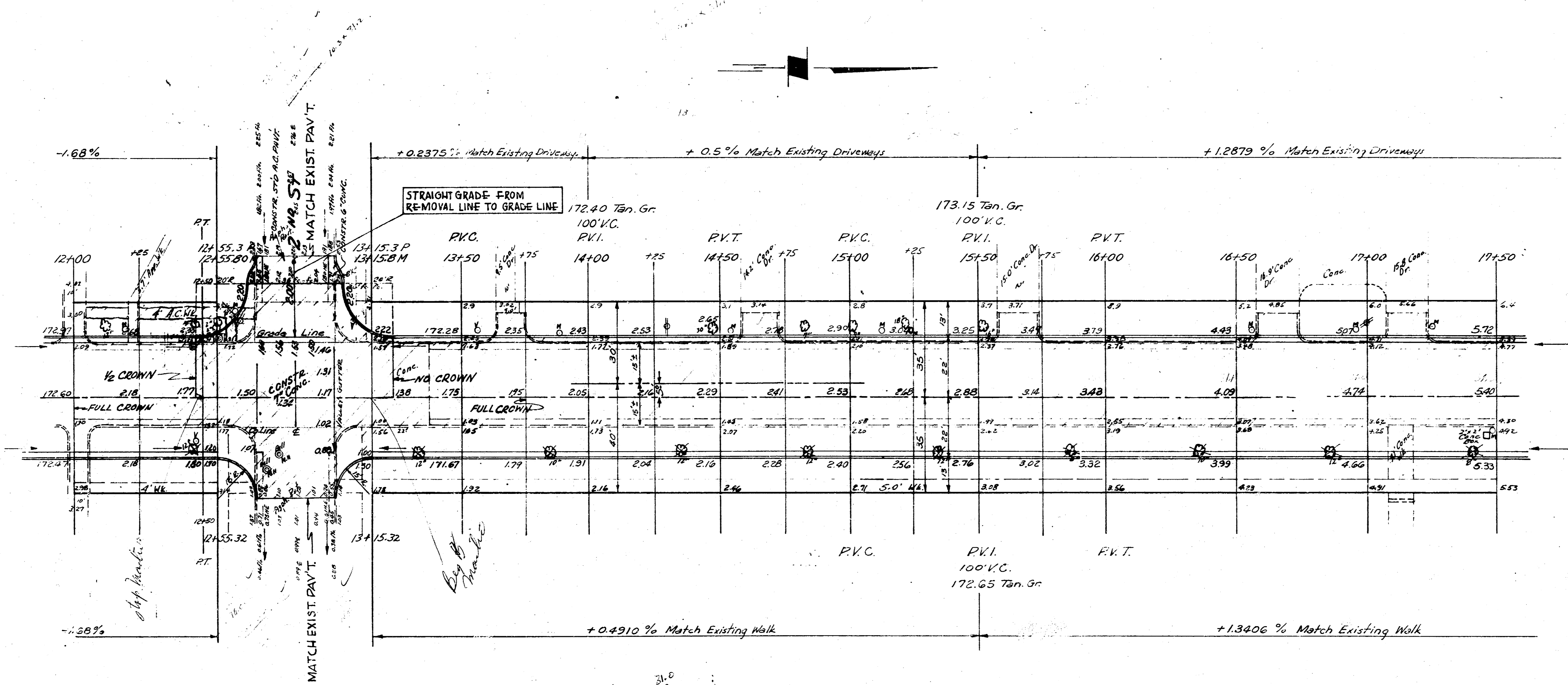

$\frac{22.5}{75.0} = \frac{3.0}{45.0}$
 $\frac{22.5}{75.0} = \frac{3.0}{45.0}$
 $\frac{22.5}{75.0} = \frac{3.0}{45.0}$

4/10

OLIVER
DOUGLAS TO CENTRAL

FIELD ENGINEER'S NOTE:
E MOVES 12' WEST IN CTR. 3RD ST.

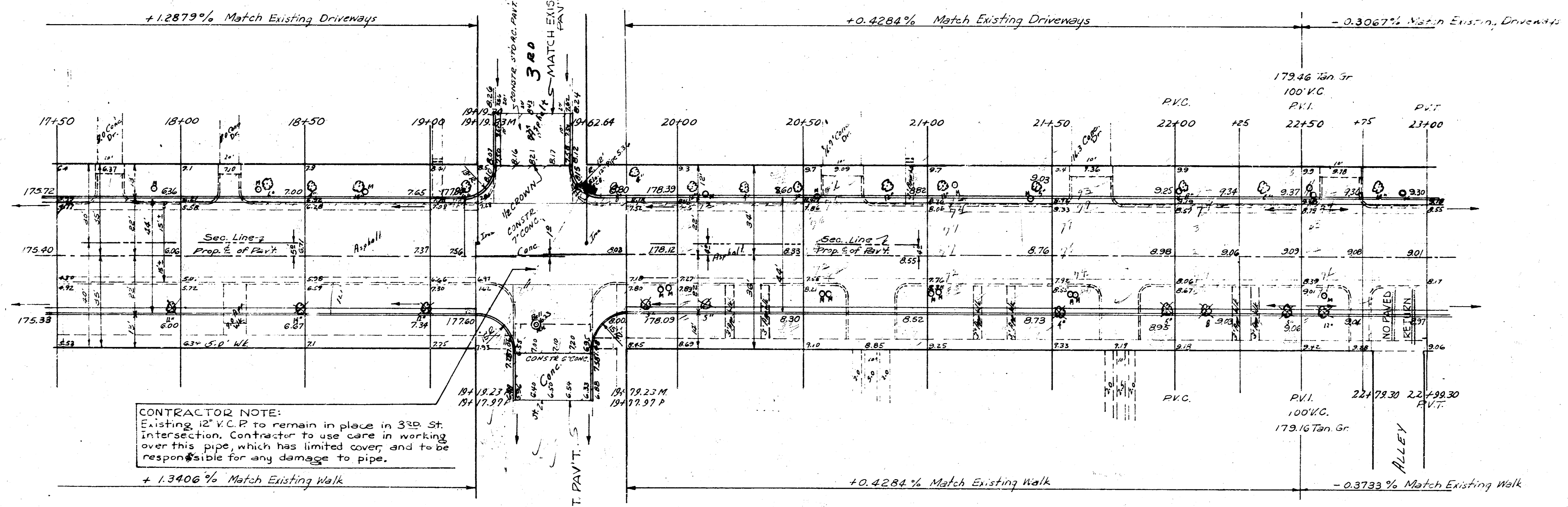

CONTRACTOR NOTE:
Existing 12" V.C.P. to remain in place in 33rd St. intersection. Contractor to use care in working over this pipe, which has limited cover, and to be responsible for any damage to pipe.

22.5
14.5
10.5
11.5

5/10

OLIVER
DOUGLAS TO CENTRAL

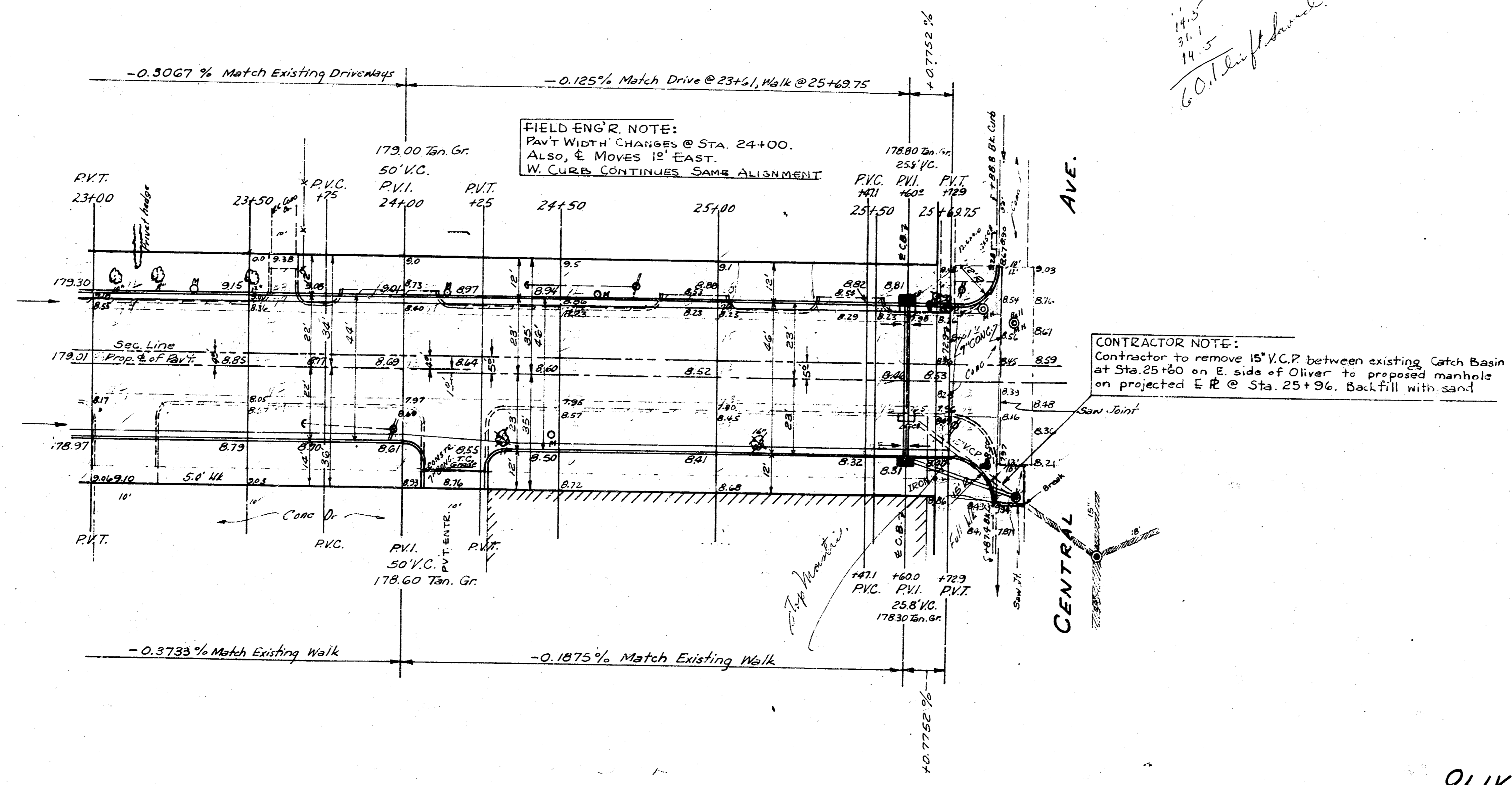
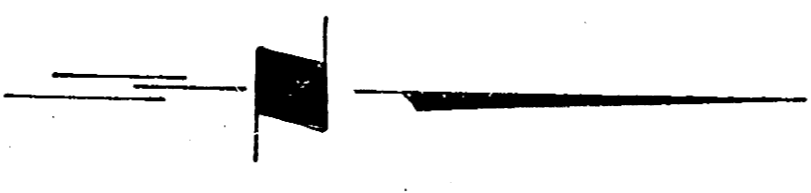

FIELD ENG'R. NOTE:
PAVT WIDTH CHANGES @ STA. 24+00.
ALSO, E MOVES 12" EAST.
W. CURB CONTINUES SAME ALIGNMENT

CONTRACTOR NOTE:
Contractor to remove 15' V.C.P. between existing Catch Basin at Sta. 25+60 on E. side of Oliver to proposed manhole on projected E.R. @ Sta. 25+96. Backfill with sand.

14.5
9.1
14.5
60.1 diff. allowed

6/10

OLIVER
DOUGLAS TO CENTRAL

**OLIVER STREET
FROM DOUGLAS AVE. TO CENTRAL AVE.
PROJECT NO. C 16-147**

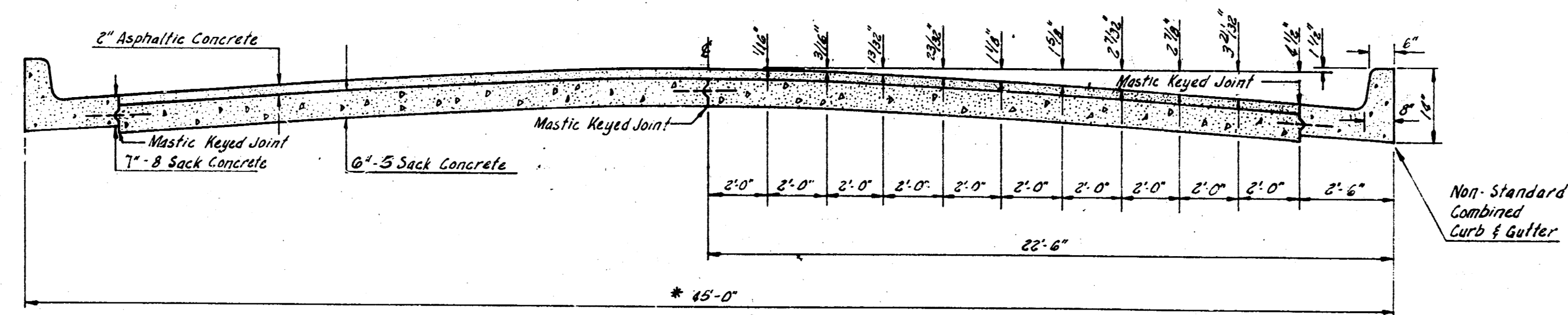

TYPICAL SECTION
NOT TO SCALE

* 45'-0"
* 47'-0" From Sta. 24+25 to Sta. 25+72.9
(Other dimensions to correspond)

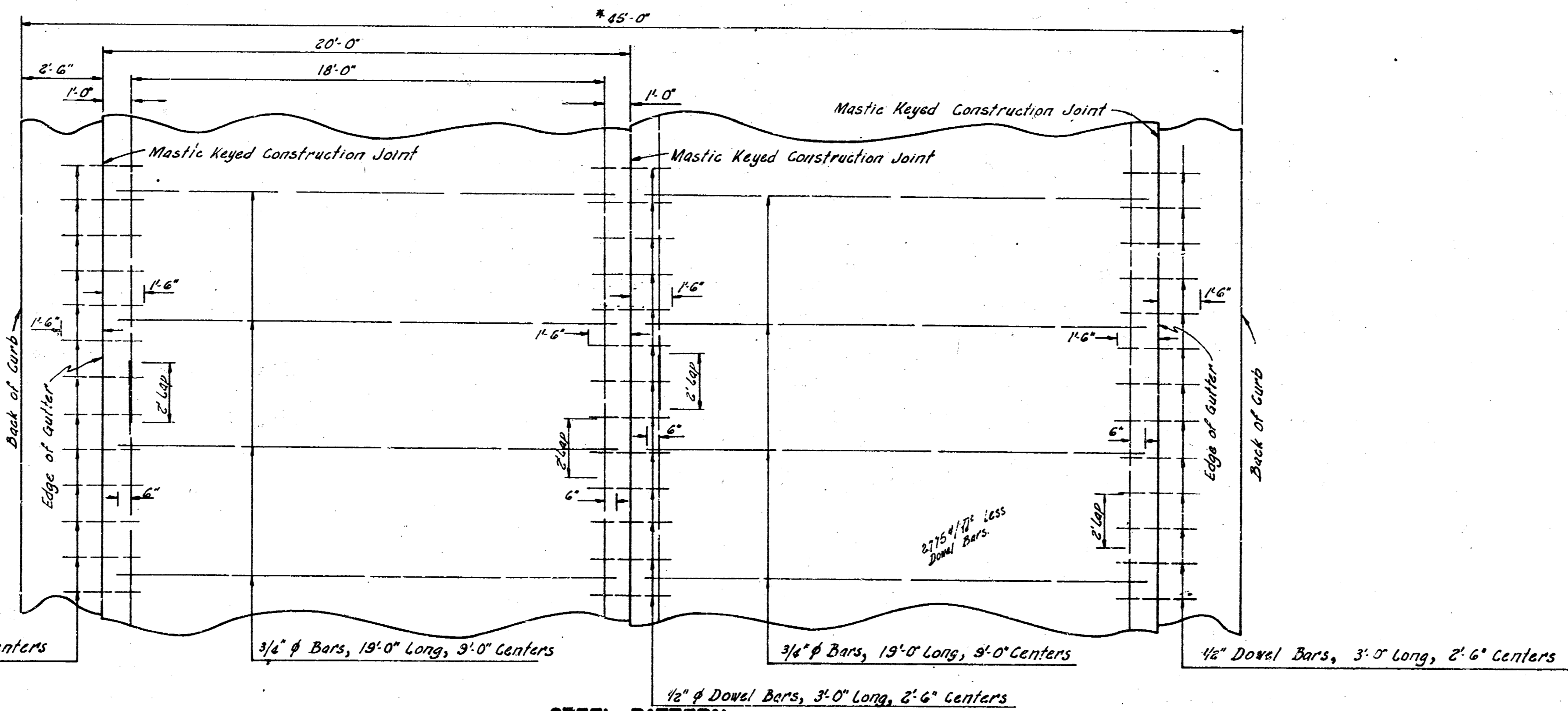

STEEL PATTERN

NOT TO SCALE
USE 3/4" Ø BARS EXCEPT WHERE NOTED



1/10

SEE DRAWING P. 15
D.M.H.

B.M. 168.54 Standard S.W. Cor Douglas & Oliver.
 B.M. 173.63 N.W. Cor. 1st Step House #254 Oliver.
 B.M. 178.65 Top 8" Pipe In W.S. Flag Pole Base In School Yard.
 B.M. 168.46 + On S.W. Cor Retaining Wall, N.E. Cor. 1st & Oliver.
 B.M. 177.84 Standard S.E. Cor. Oliver & Central, 10' W. & 4' N. of S.E. Cor.
 Stationing & Base Line 5' East of W. Prop. Line

EXCAVATION			
PROP.	1118.4	CITY	87.0
PLUS 10%	1118	PLUS 10%	8.7
	1230.2		95.7

Checked
 Exc
 Plans
 P.S.
 5/15

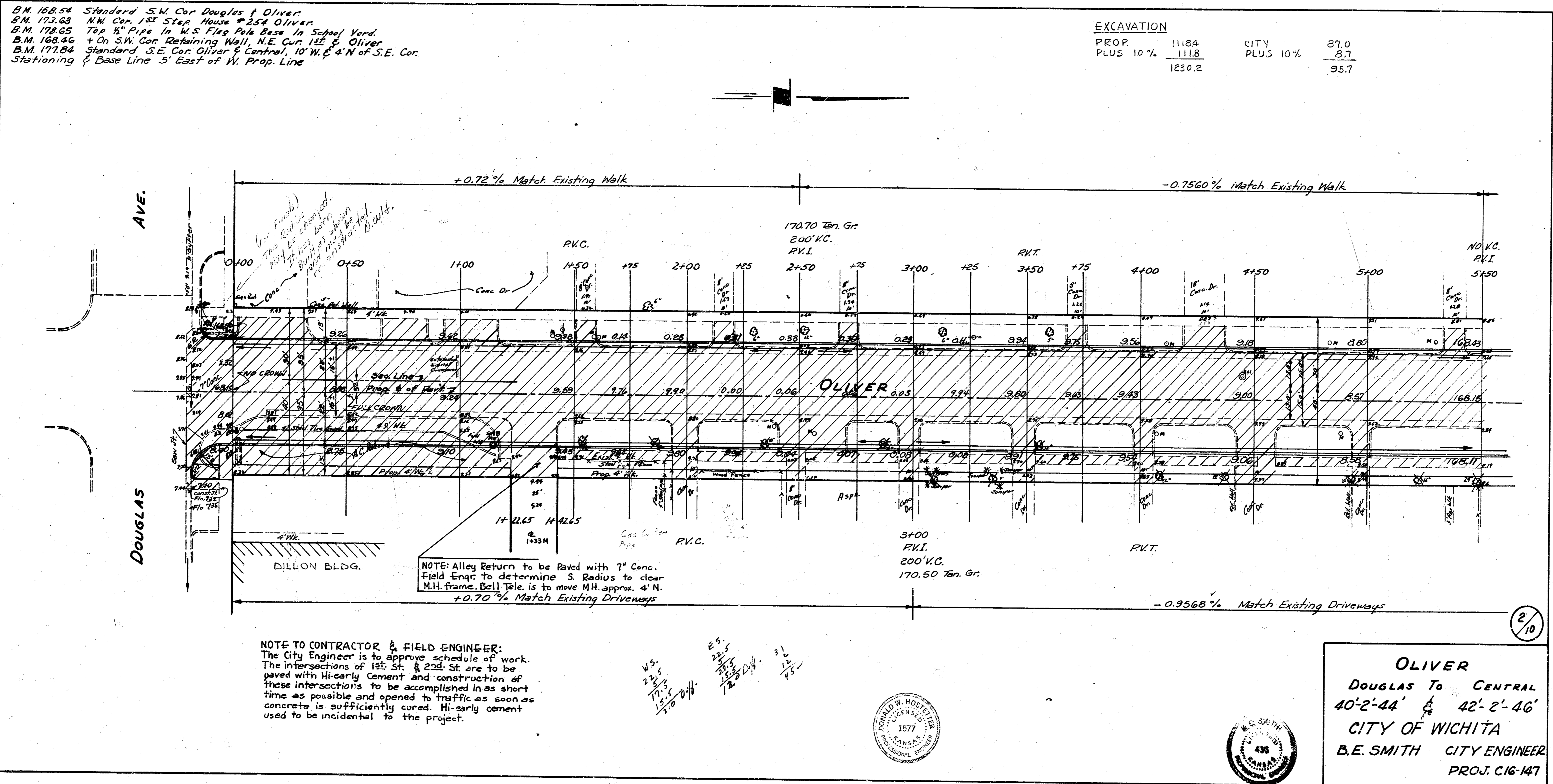

NOTE TO CONTRACTOR & FIELD ENGINEER:
 The City Engineer is to approve schedule of work.
 The intersections of 1st St. & 2nd St. are to be paved with Hi-early Cement and construction of these intersections to be accomplished in as short time as possible and opened to traffic as soon as concrete is sufficiently cured. Hi-early cement used to be incidental to the project.

Handwritten notes and calculations:
 25.5
 22.5
 15.5
 12.5
 10.5
 8.5
 6.5
 4.5
 2.5



OLIVER
 DOUGLAS To CENTRAL
 40'-2'-44' & 42'-2'-46'
 CITY OF WICHITA
 B.E. SMITH CITY ENGINEER
 PROJ. C16-147

2/10

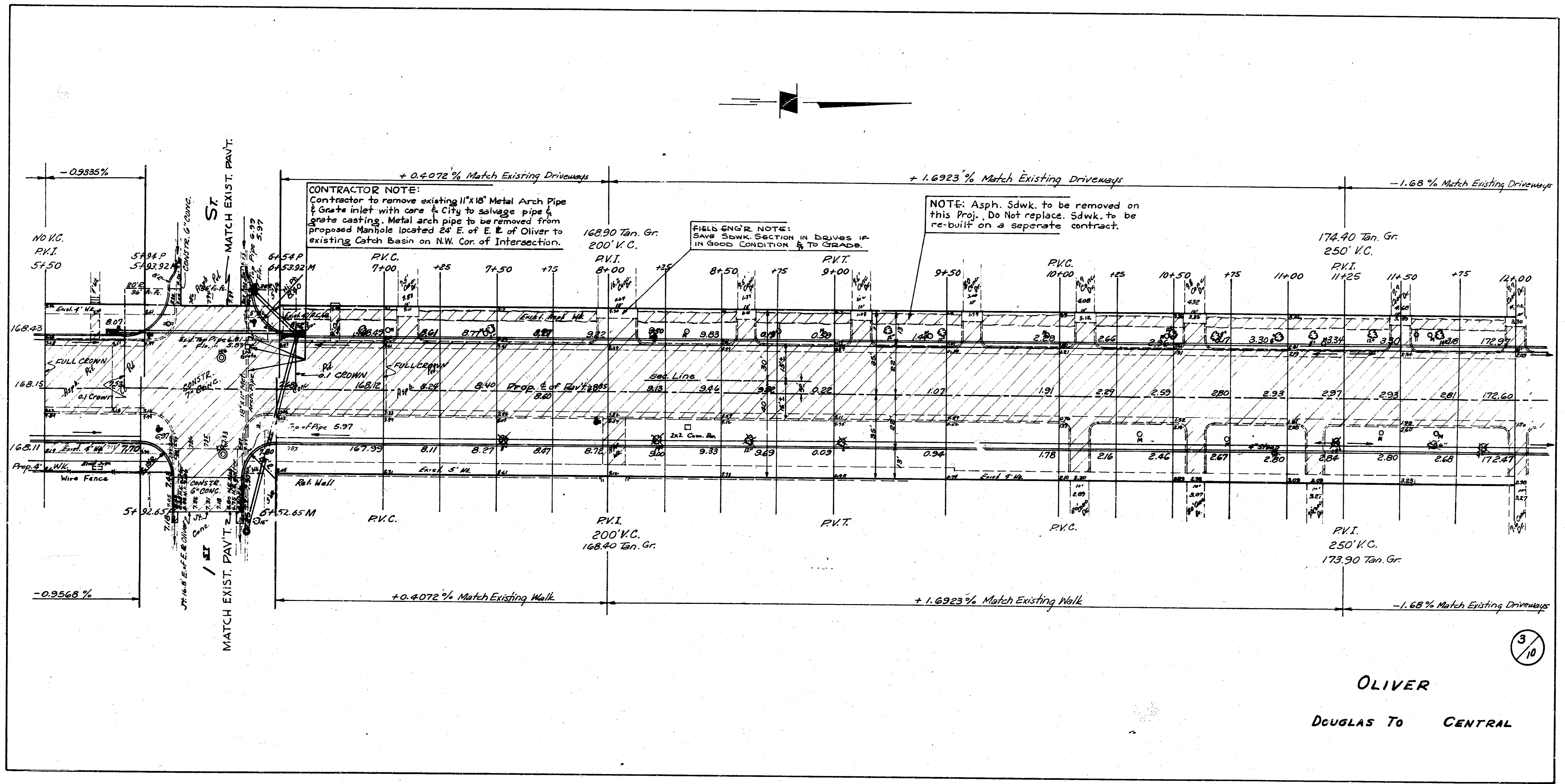

3/10

OLIVER
DOUGLAS TO CENTRAL

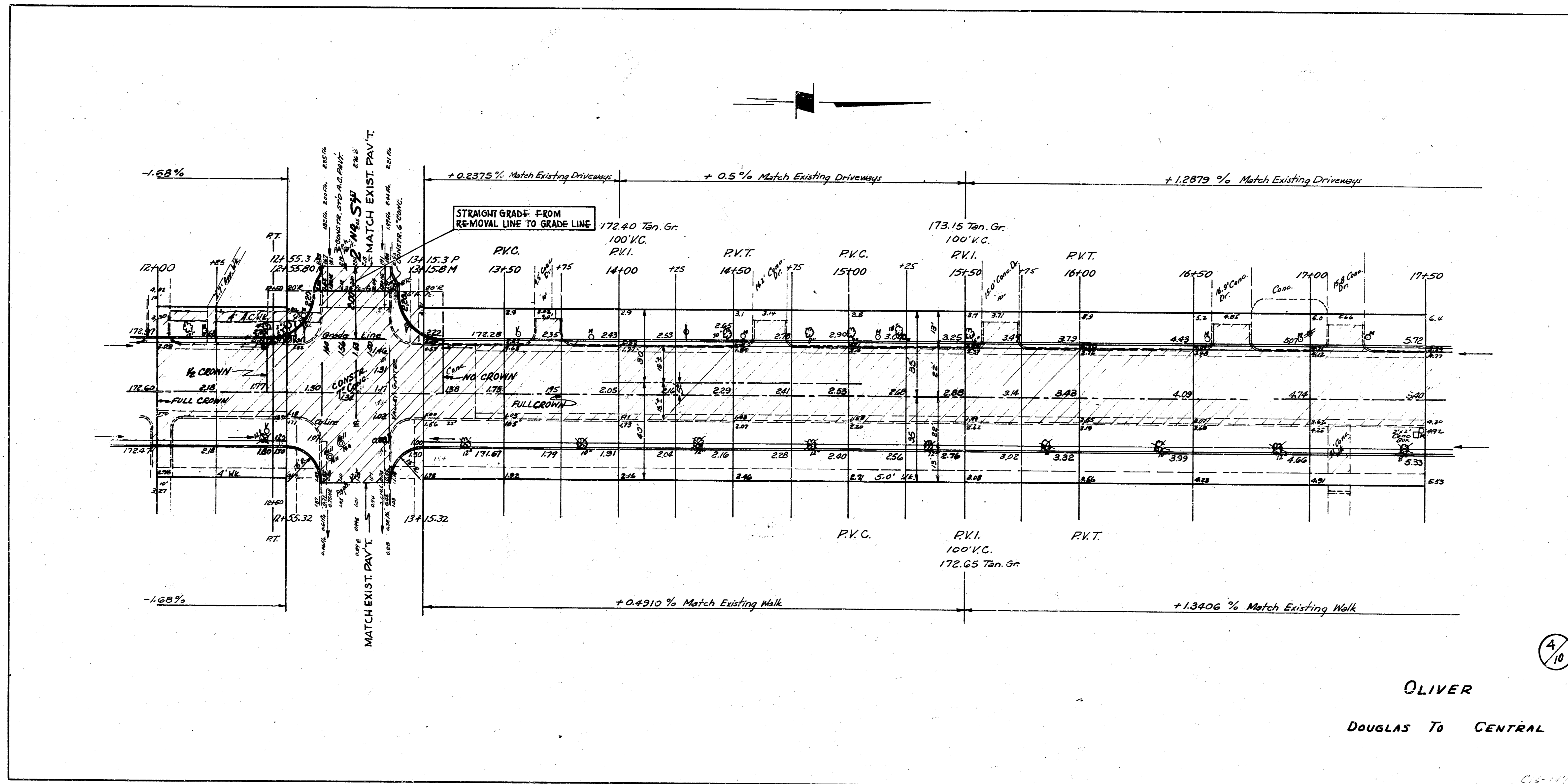

OLIVER
DOUGLAS TO CENTRAL

C. 10-141
12-1

FIELD ENGR. NOTE:
 E MOVES 18' WEST IN CTR. 3RD ST.

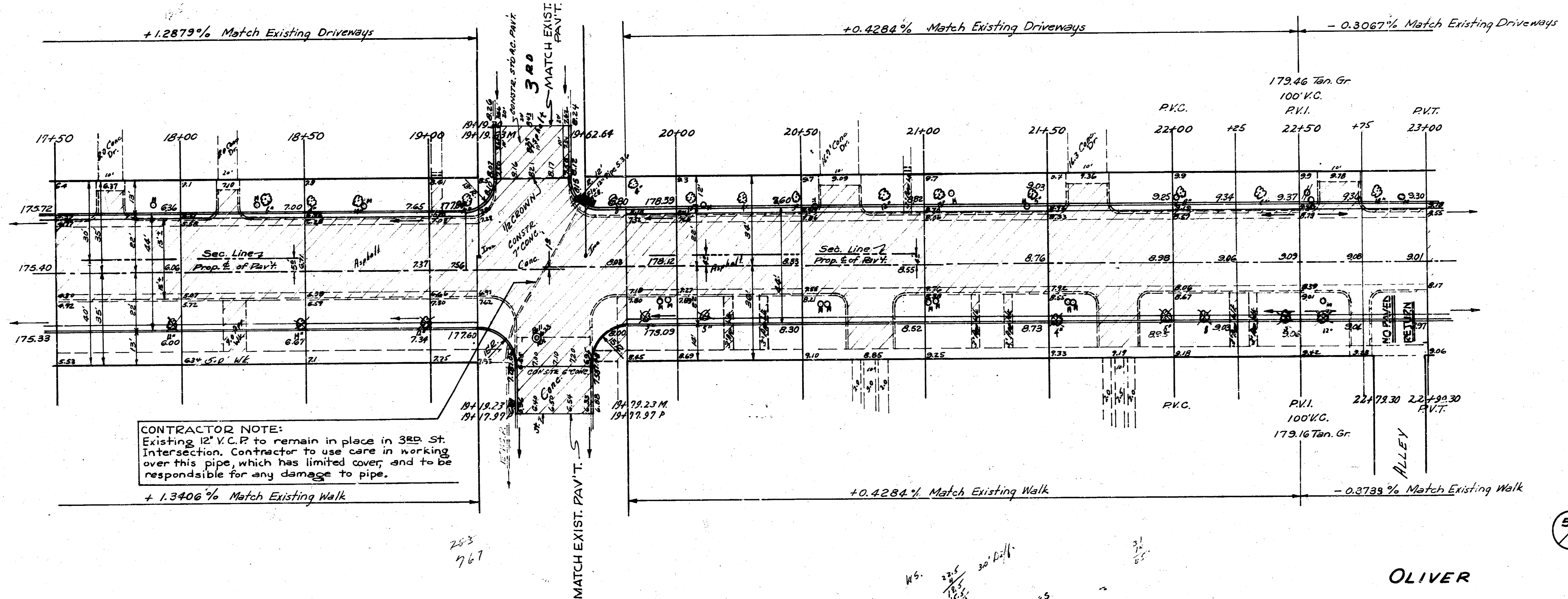

CONTRACTOR NOTE:
 Existing 12" V.C.P. to remain in place in 3RD St.
 Intersection. Contractor to use care in working
 over this pipe, which has limited cover, and to be
 responsible for any damage to pipe.

253
 767

WS.
 22.5
 18.5
 30' D.I.V.
 25
 22.5
 18.5
 30' D.I.V.

5/10

OLIVER
 DOUGLAS TO CENTRAL

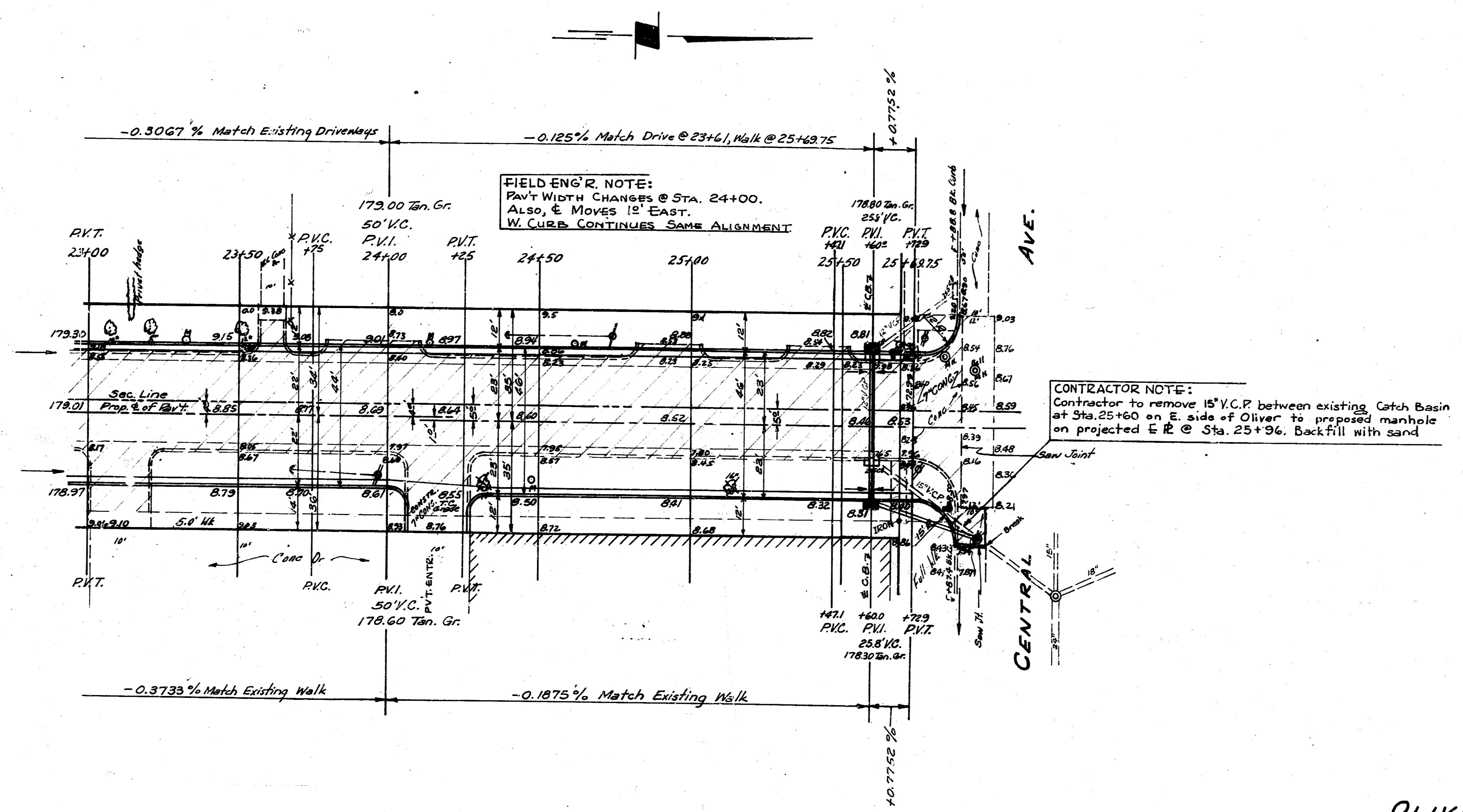

OLIVER
DOUGLAS TO CENTRAL

6/10

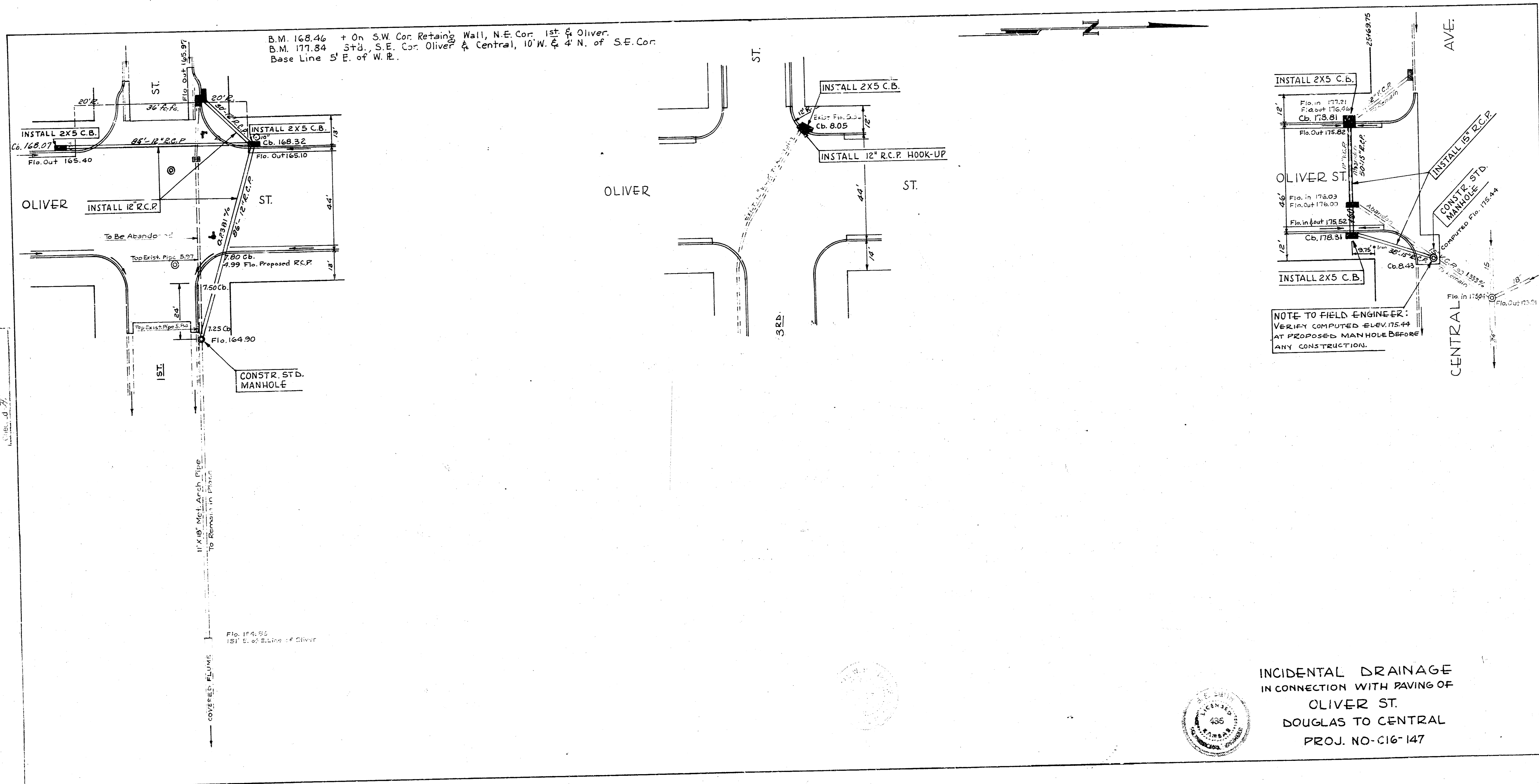

B.M. 168.46 + On S.W. Cor. Retaining Wall, N.E. Cor. 1st & Oliver.
 B.M. 177.84 + On S.E. Cor. Oliver & Central, 10' W. & 4' N. of S.E. Cor.
 Base Line 5' E. of W.R.

Seal
 P.S. & D.W.H.
 C.E. & D.W.H.
 11/15/27

NOTE TO FIELD ENGINEER:
 VERIFY COMPUTED ELEV. 175.44
 AT PROPOSED MANHOLE BEFORE
 ANY CONSTRUCTION.

INCIDENTAL DRAINAGE
 IN CONNECTION WITH PAVING OF
 OLIVER ST.
 DOUGLAS TO CENTRAL
 PROJ. NO-616-147

