

B.M. 106.30 "X" cut Top Conc. Ret. wall N. at N.E. cor. Morris & Washington.  
 B.M. 106.14 "X" cut S.E. cor. conc. slab in front of Building N.W. cor. Lincoln & Washington.  
 Base Line of Stationing on & Morris St.

**NOTE:**  
 Remove existg walk and  
 remove cb of gr. at north  
 side of refurbs at Washington  
 Ave. and Ida Ave.

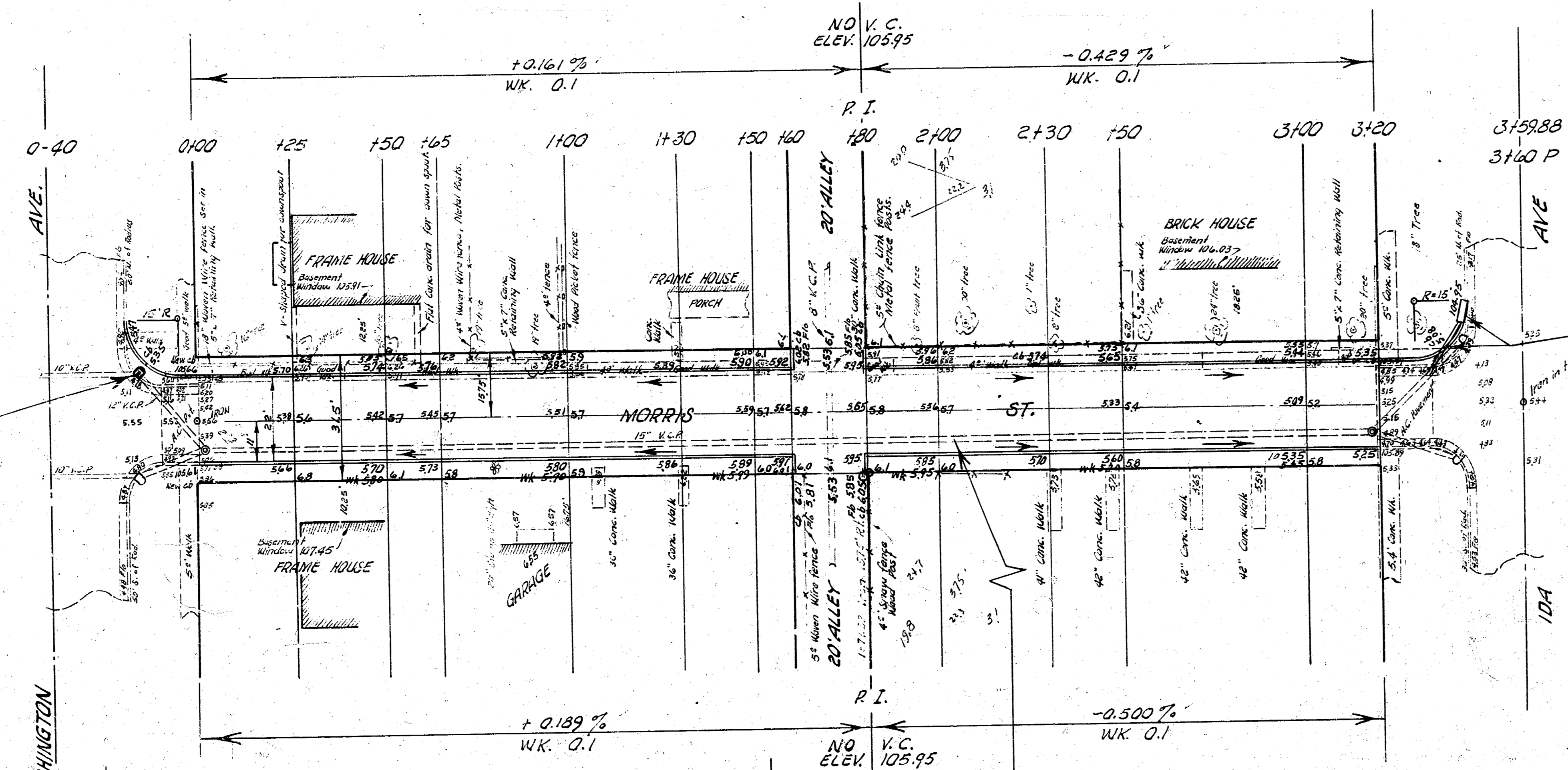
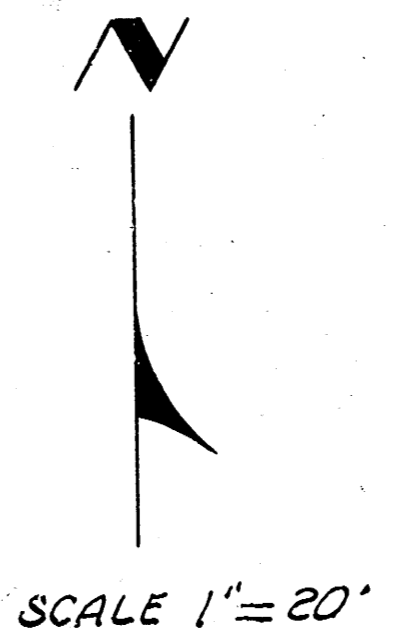

**NOTE:**  
 Install 2x2 Grate  
 Flo in 104.80

**NOTE:**  
 Install 2x5 C.B.  
 Elev. Flo in 104.38  
 Install 16 Lin Ft. 10" R.C.P.

EARTH WORK

Excavation		Prop.	
CITY			
19.8		20.1	
+10%	2.0	+10%	20.2
	21.8 Cu. Yds.		221.9 Cu. Yds.

REIN. STEEL PATTERN  
 FOR  
 CONC PAVEMENT  
 SCALE 0.5" = 10'

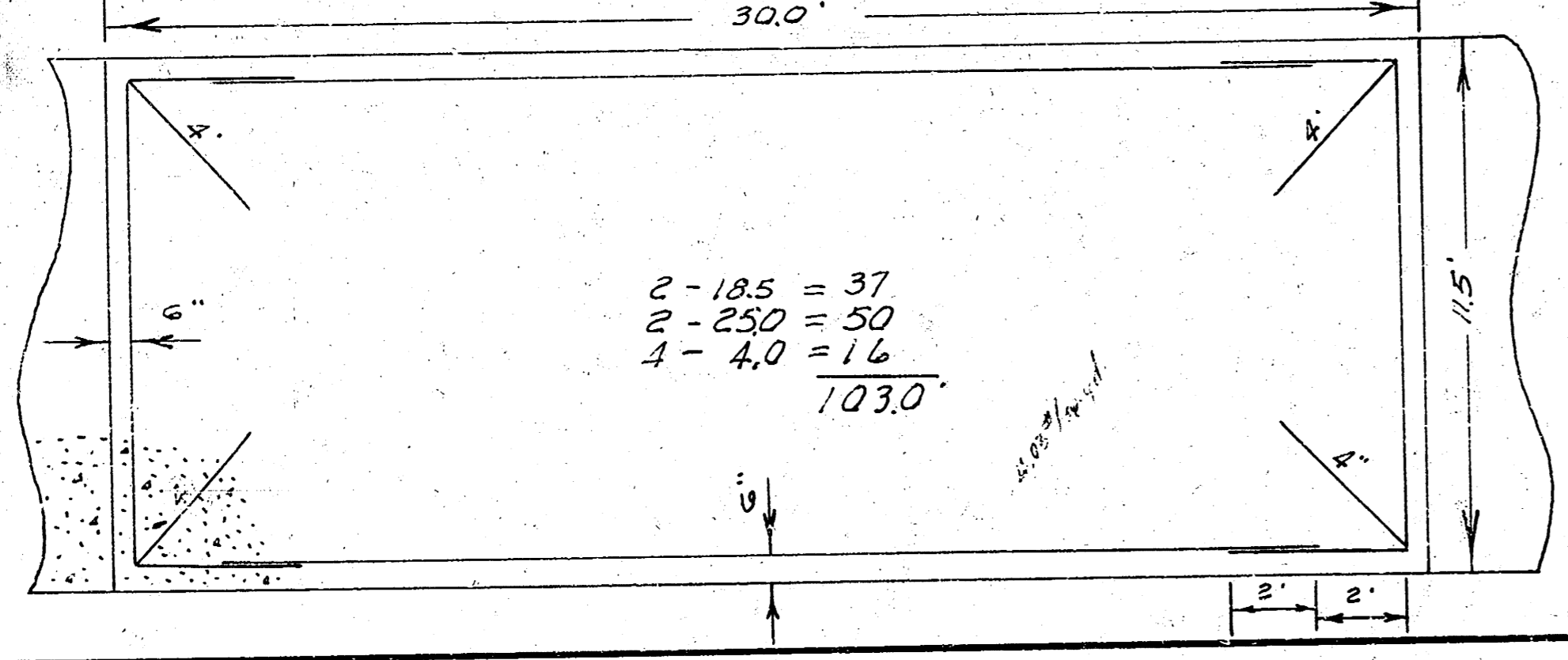

**NOTE:**  
 TO CONTRACTOR & FIELD ENGINEER:  
 Use extreme CAUTION when excavating  
 over existing 15" V.C.P. storm water  
 sewer.

**MORRIS ST.**  
 EL WASHINGTON TO WL IDA  
 22" CONC. & CB  
 CITY OF WICHITA, KANS.  
 B. E. SMITH - CITY ENGINEER  
 MARCH 1959, PROJ. NO. C18-3

Survey  
 Plan  
 Exc.  
 Checked

