

Standard 74.83 Hydraulic Levy

Prop.	City
8.6	14.3
23.1	14.2
14.7	52.1
59.2	16.2
147.1	58.1
251.9	27.7
34.1	29.1
180.7	22.9
183.7	
128.3	
73.5	
3.4	
1178.3	235.2
+1070	+1070
1230.1	258.7

Grand Total	
Prop	City
1230.1	258.7
573.3	258.2
1823.4 cu Yds	516.9 cu Yds

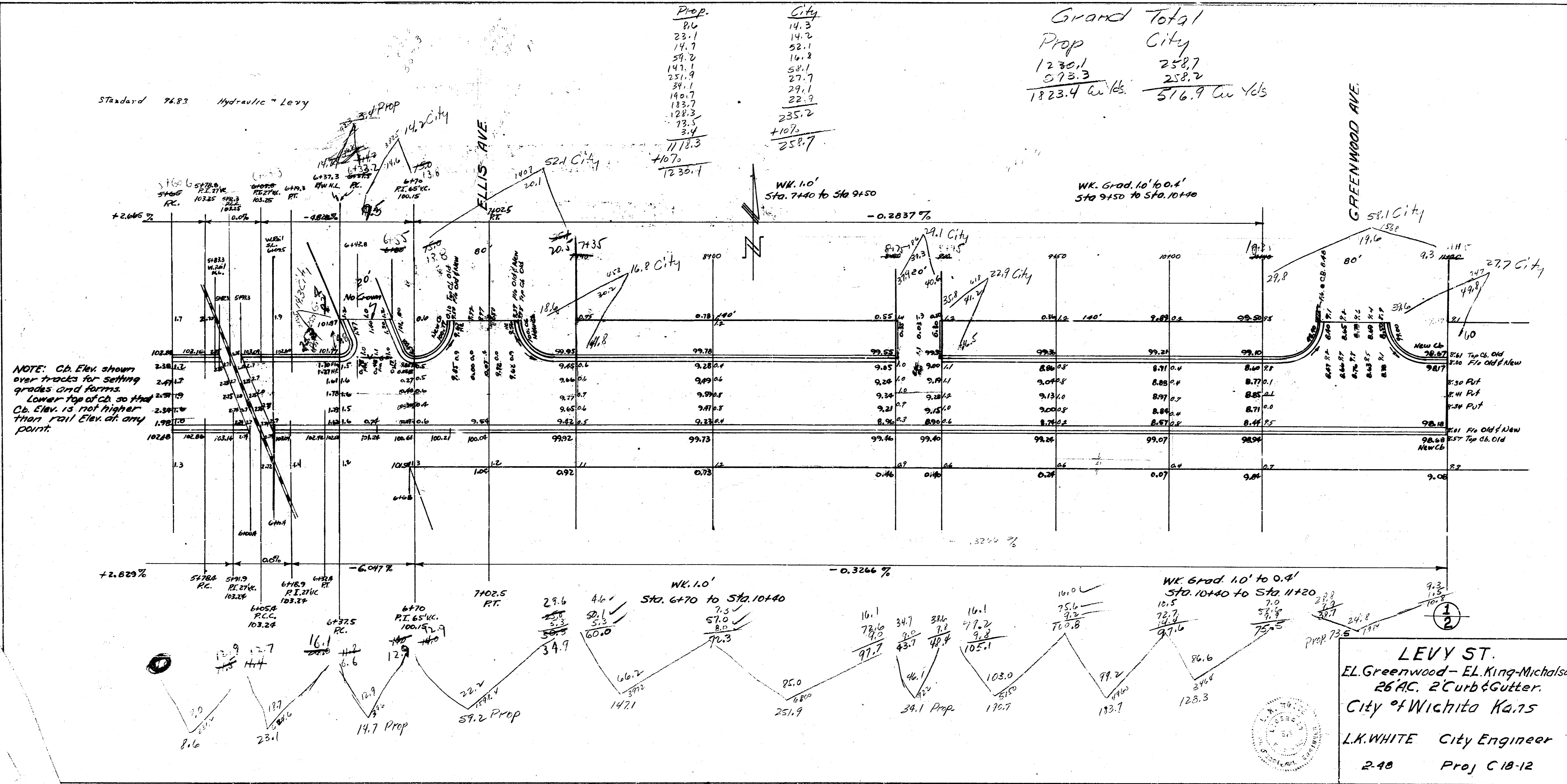

NOTE: Cb. Elev. shown over tracks for setting grades and forms. Lower Top of Cb. so that Cb. Elev. is not higher than rail Elev. at any point.

LEVY ST.
 EL Greenwood - EL King-Michalsen
 26 AC, 2' Curb & Gutter.
 City of Wichita, Kan.
 L.K. WHITE City Engineer
 2-48 Proj C18-12



B.M. 100.42 Stake End Aviny WL King Mike ANW

Prop	City
47.0	7.7
47.0	14.7
26.9	27.2
15.6	42.1
13.2	3.3
58.9	55.0
7.2	31.4
6.3	234.7
0.0	253.2
51.0	
539.4	
+10.2	
549.6	

NOTE: Sta 475 to Sta 475 N.S., grad gtr. H.E. to Fl. Elev. Sta. 475 to Sta. 548.9 N.S., make Fl. Elev. H.E. Elev. the same. Sta. 548.9 to Sta. 545 N.S., grad. H.E. to standard. Ch. f. gtr. Elev. as shown on plan.

