

MOSLEY AVENUE  
SL 13TH. TO SL 17TH.

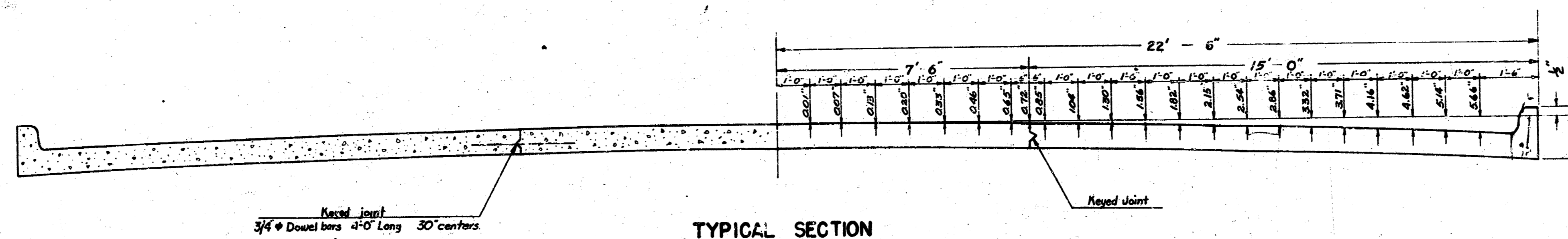

TYPICAL SECTION  
NO SCALE

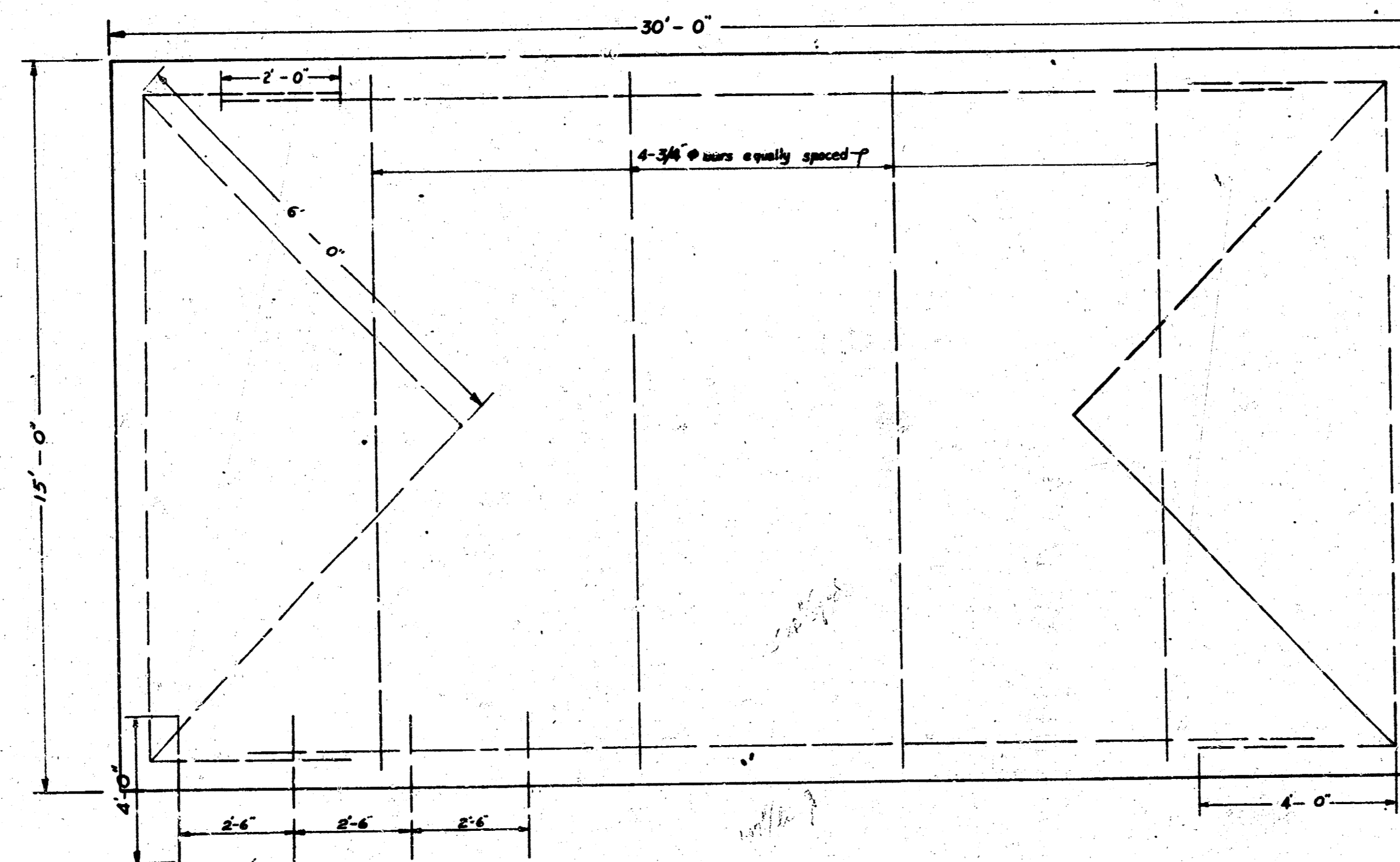

STEEL PATTERN  
NO SCALE

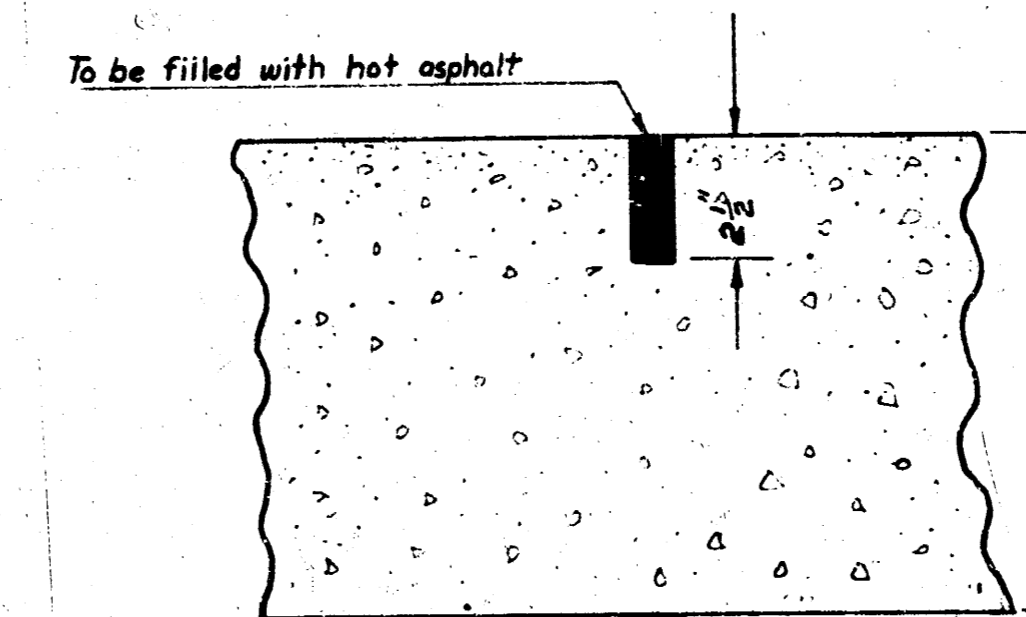

DETAILS OF CONTRACTION JOINT  
NO SCALE

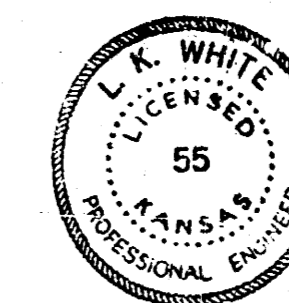

BM 116.18 Standard SW Cor. 13th & Washington  
 BM 116.56 NW Cor Signal Light Base NW Cor 13th & Mosley.

Excavation  
 Property - 2628.5 cu yds  
 City - 218.1 cu yds

BM 119.88 N.W. Cor Top Conc. Step Hos. \*H54 N. Mosley

NOTE: All fill to be mixed 1/3 sand and compacted.

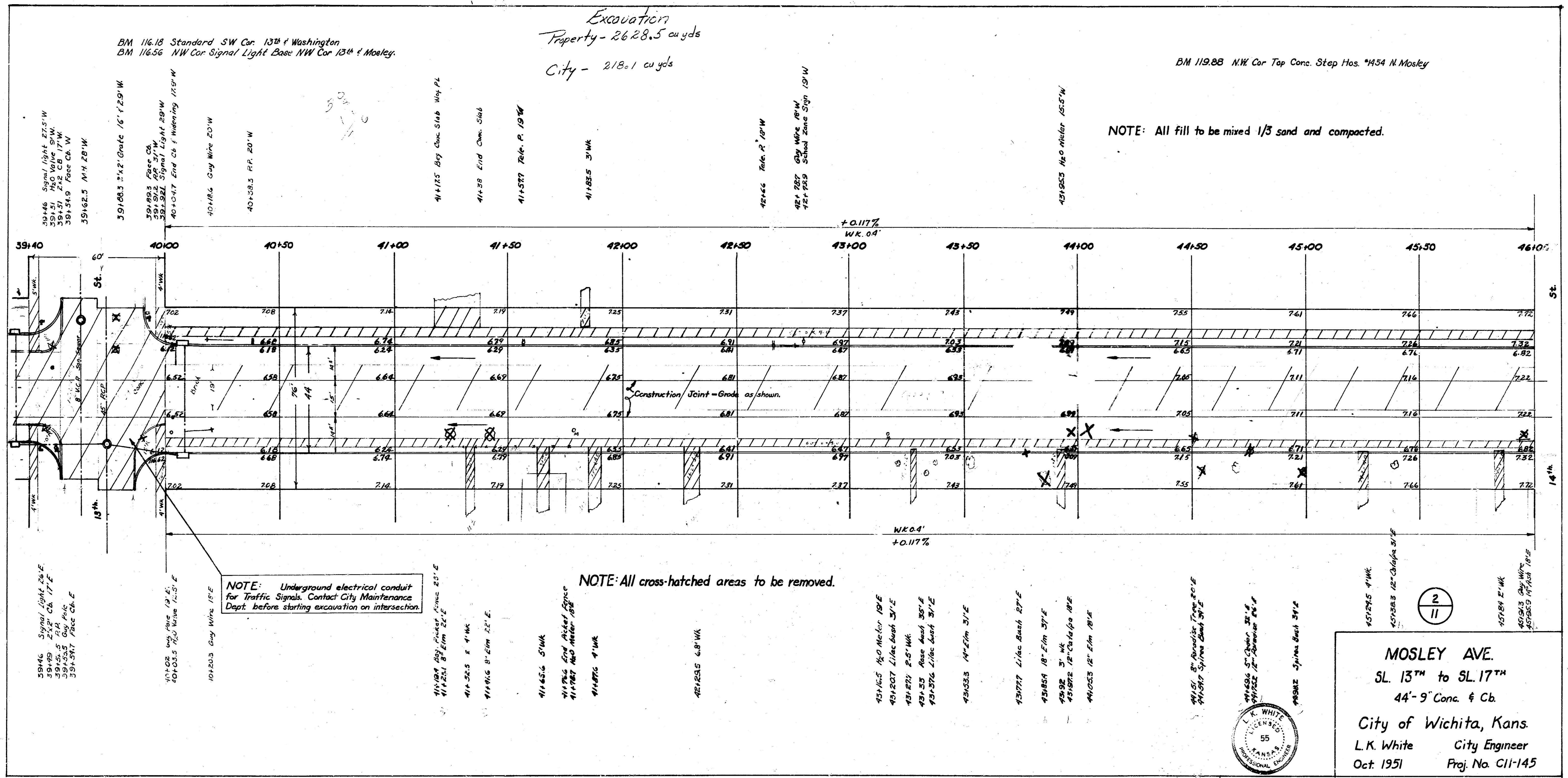

NOTE: Underground electrical conduit for Traffic Signals. Contact City Maintenance Dept. before starting excavation on intersection.

NOTE: All cross-hatched areas to be removed.

MOSLEY AVE.  
 SL. 13<sup>TH</sup> to SL. 17<sup>TH</sup>  
 44'-9" Conc. & Cb.  
 City of Wichita, Kans.  
 L.K. White City Engineer  
 Oct. 1951 Proj. No. C11-145

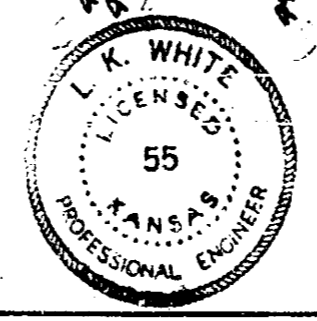

BK-I

BM. 118.60 S.E. Cor. Conc. Step Cape S.E. Cor. 15th & Mosley

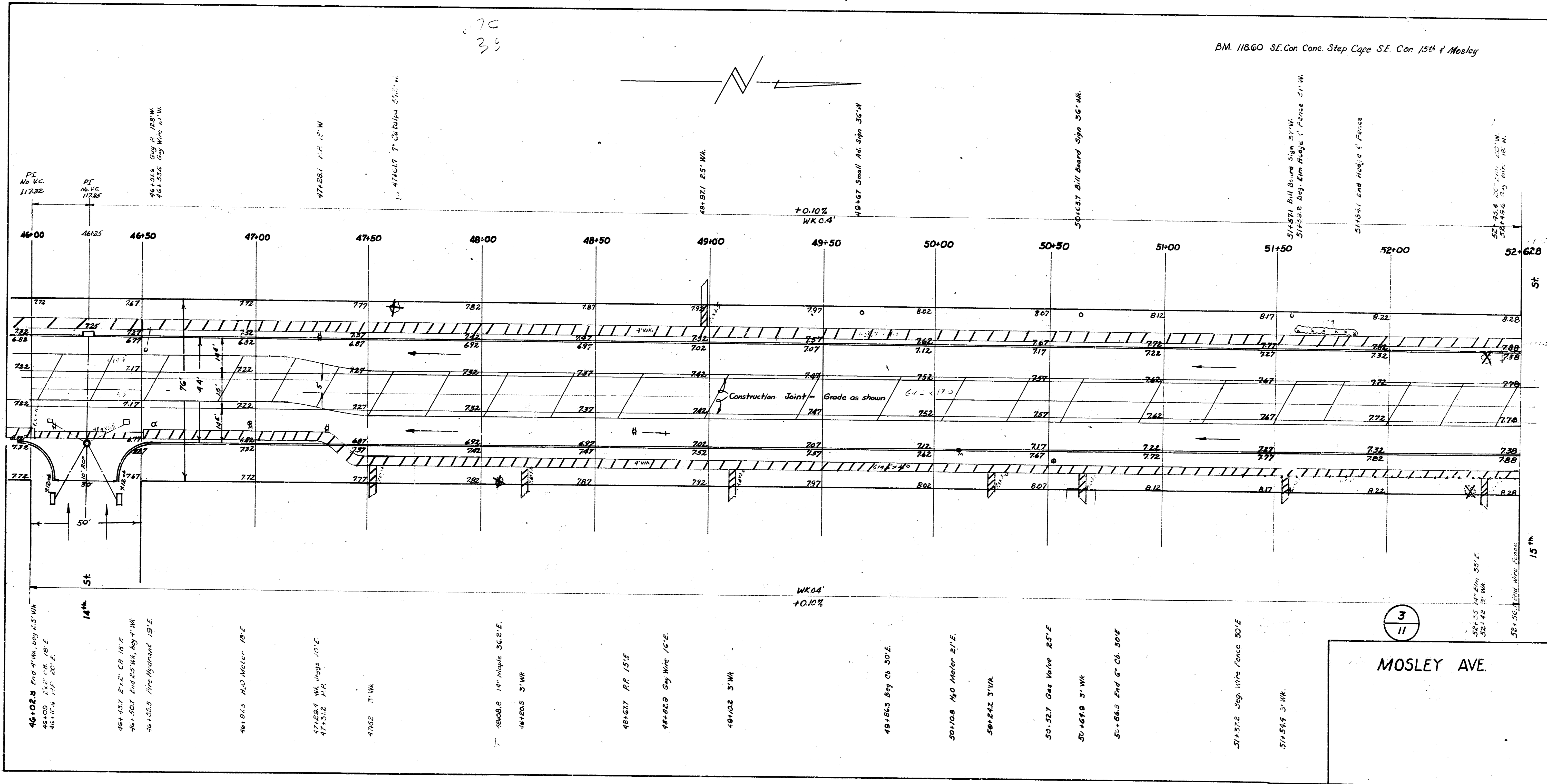

- 46+00.3 End of 4" W. Pipe 2" W.K.
- 46+00.4 2" W.K.
- 46+00.5 2" W.K.
- 46+43.7 2" x 2" CB 18"E
- 46+50.7 End of 2" W.K. 4" W.K.
- 46+52.3 1" x 1" Hydrant 18"E
- 46+58.3 R.O. Meter 18"E
- 47+50.9 W. Pipe 10"E
- 47+51.2 W.K.
- 4+65.2 3" W.K.
- 48+08.8 14" Hydrant 36"E
- 48+20.5 3" W.K.
- 48+67.7 R.R. 15"E
- 49+02.9 Gas Pipe 15"E
- 49+02.2 3" W.K.
- 49+02.3 Gas 30"E
- 50+02.8 H.O. Meter 21"E
- 50+24.2 3" W.K.
- 50+52.7 Gas Valve 25"E
- 50+65.9 3" W.K.
- 51+06.3 End of 6" Cl. 30"E
- 51+37.2 3" W.K. Pipe 30"E
- 51+54.5 3" W.K.

3  
11

MOSLEY AVE.