

BM 121.66 City standard S.E. cor. Central & Sheridan  
 B.M. 124.08 Top 3" bolt N.W. cor. R.R. crossing signal.

Ties to iron @ Mt. Carmel & Elm  
 350' N.E. to top end deadman @ cable.  
 242' S.E. to ctr. of N.E. side p. pole.

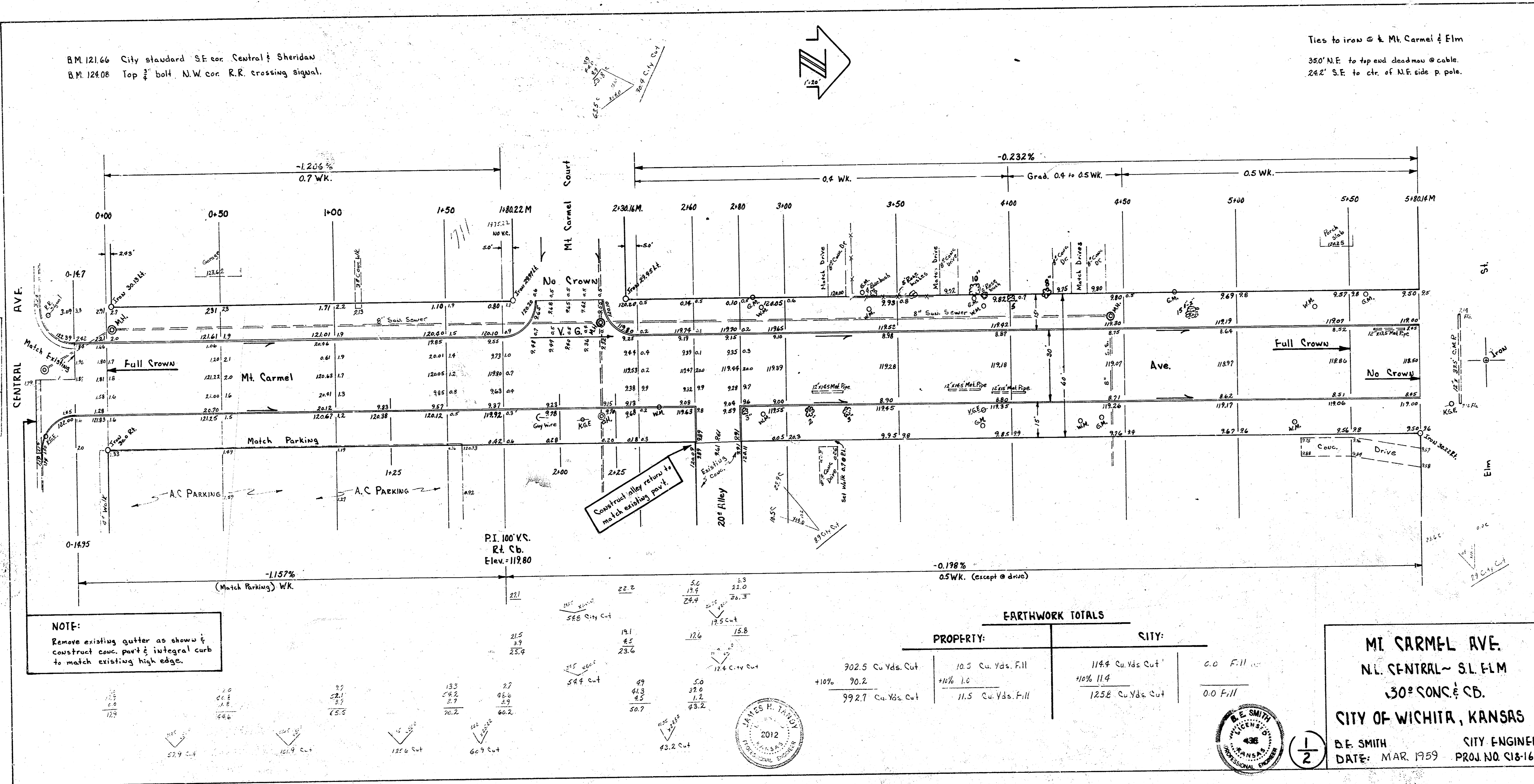

**NOTE:**  
 Remove existing gutter as shown &  
 construct conc. curb & integral curb  
 to match existing high edge.

EARTHWORK TOTALS			
PROPERTY:		CITY:	
902.5 Cu Yds. Cut	10.5 Cu Yds. Fill	1144 Cu Yds. Cut	6.0 Fill
+10% 90.2	+10% 1.6	+10% 114.4	0.0 Fill
992.7 Cu Yds. Cut	11.5 Cu Yds. Fill	1258 Cu Yds. Cut	

**MI CARMEL AVE.**  
 N.L. CENTRAL - S.L. ELM  
 30" CONC. & CB.  
 CITY OF WICHITA, KANSAS  
 D.E. SMITH CITY ENGINEER  
 DATE: MAR. 1959 PROJ. NO. S18-166

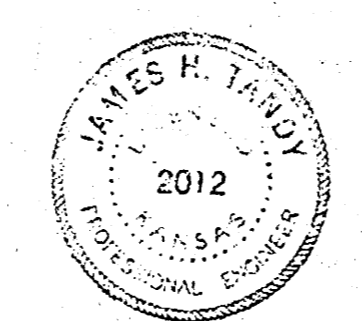

1/2