

MT. VERNON ROAD
E.L. OLIVER TO W.L. EDGEMOOR

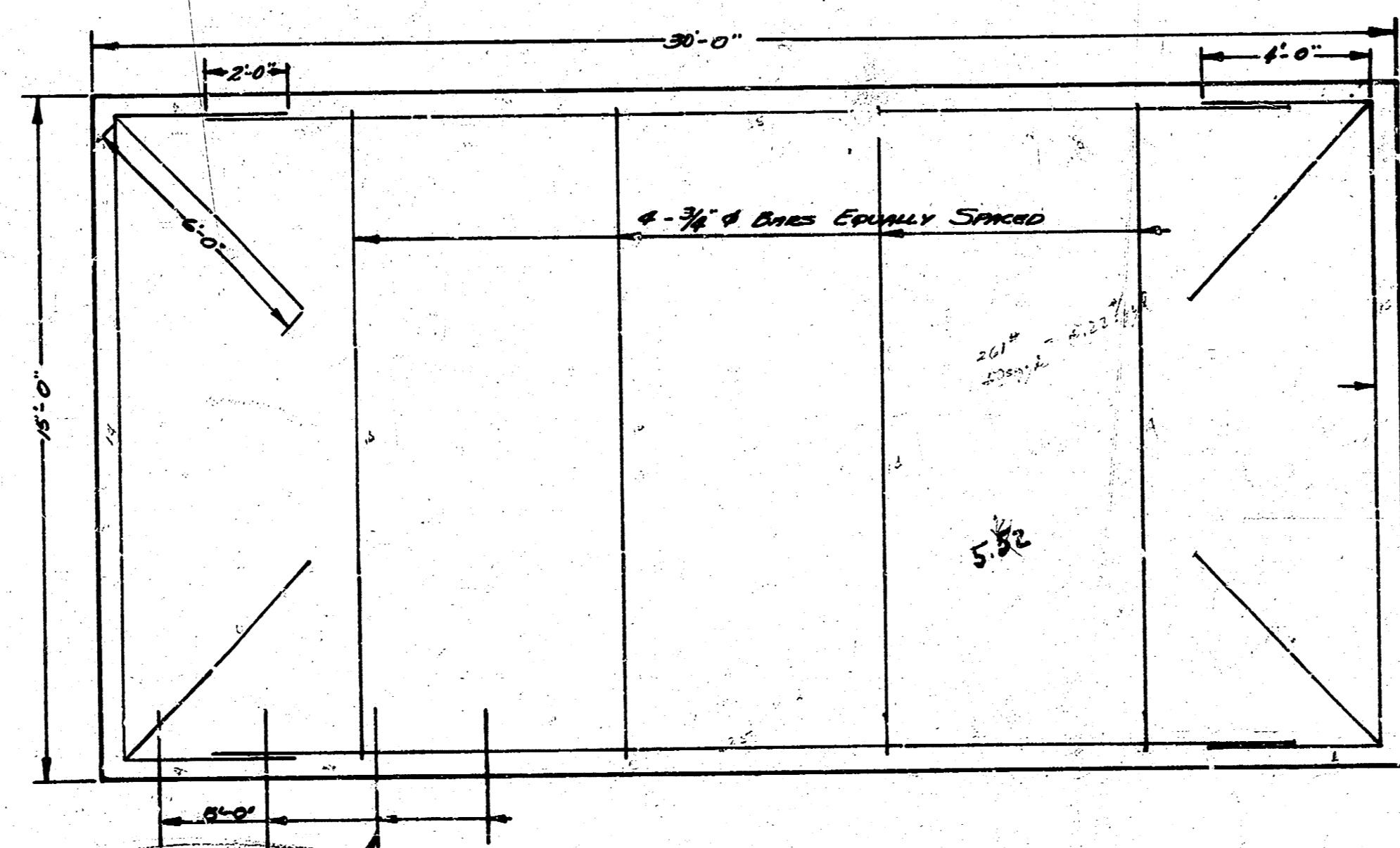

NOTE

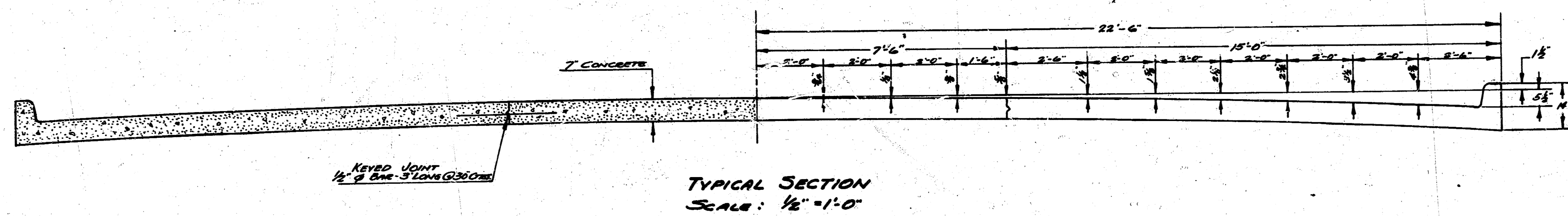
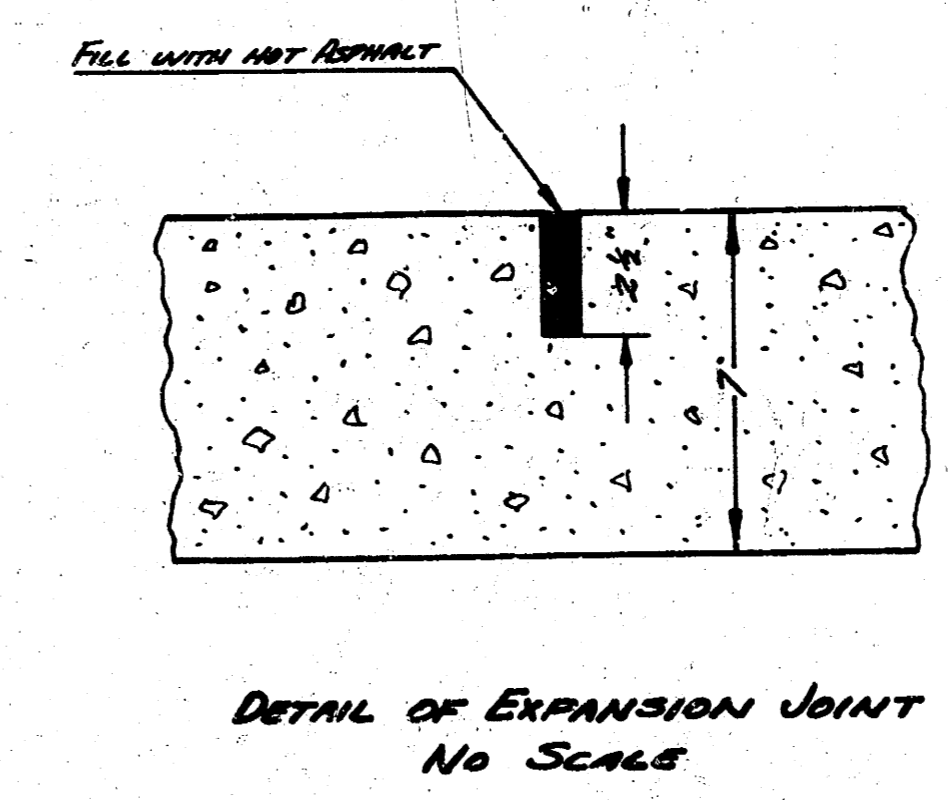

6570

By 38 Y
28 31-40
P.A. 251/200
23

B.M. 144.31 B.C. N.S. E. Town 144.31 N.W. of Co. N.W. of A.W. Co. 144.31 & 144.31 DESTROYED?
B.M. 139.87 STANDARD N.W. COR. EDGEWOOD & MT. VERNON

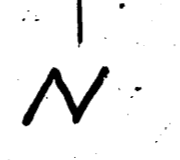

0+40 & 0+50 on Oliver
 0+50 Edge of Sub on Oliver
 Oliver Ave.
 Build approach with Asphaltic
 Binder & Sheet Asphalt

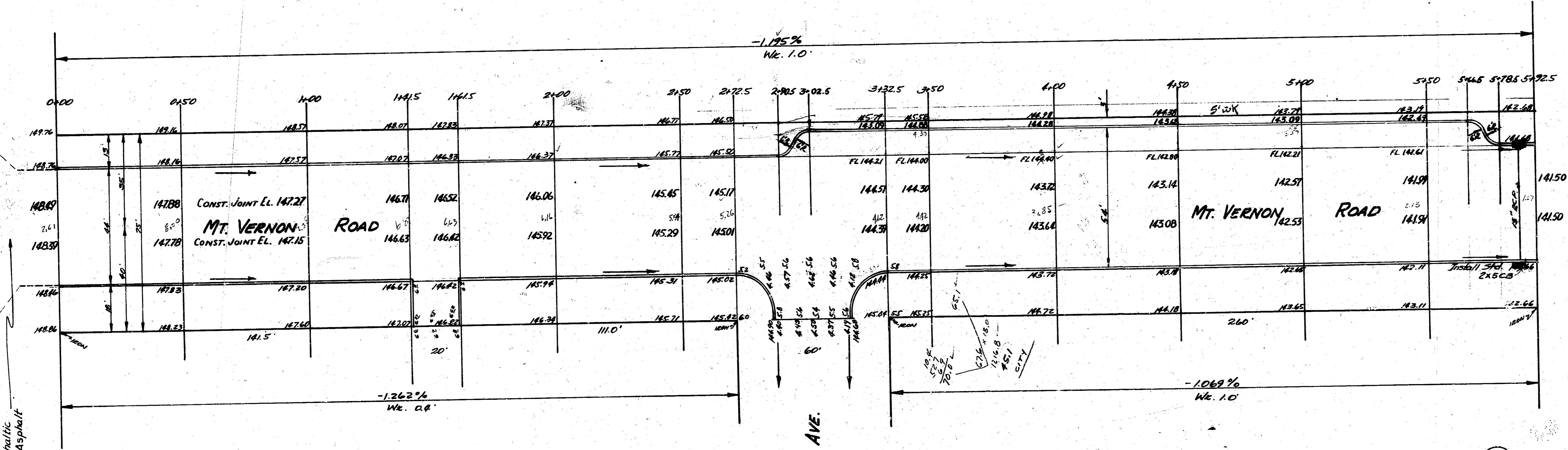

144.31
144.31
144.31

1/5

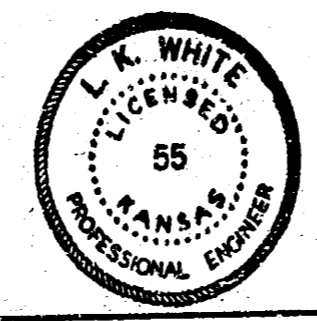

MT. VERNON ROAD
 E.L. OLIVER TO W.L. EDGEWOOD
 44' CONC(T) & C.
 CITY OF WICHITA, KANSAS
 L.K. WHITE CITY ENGINEER
 MAY 1951 PROJ. C10-132

B.M. 144.31 Box N.S. Elm Tree 100' W. & 50N. of N.W. Cor. ELPICO & LARRY LANE
 B.M. 139.87 STANDARD N.W. Cor. EDGEWOOD & MT. VERNON

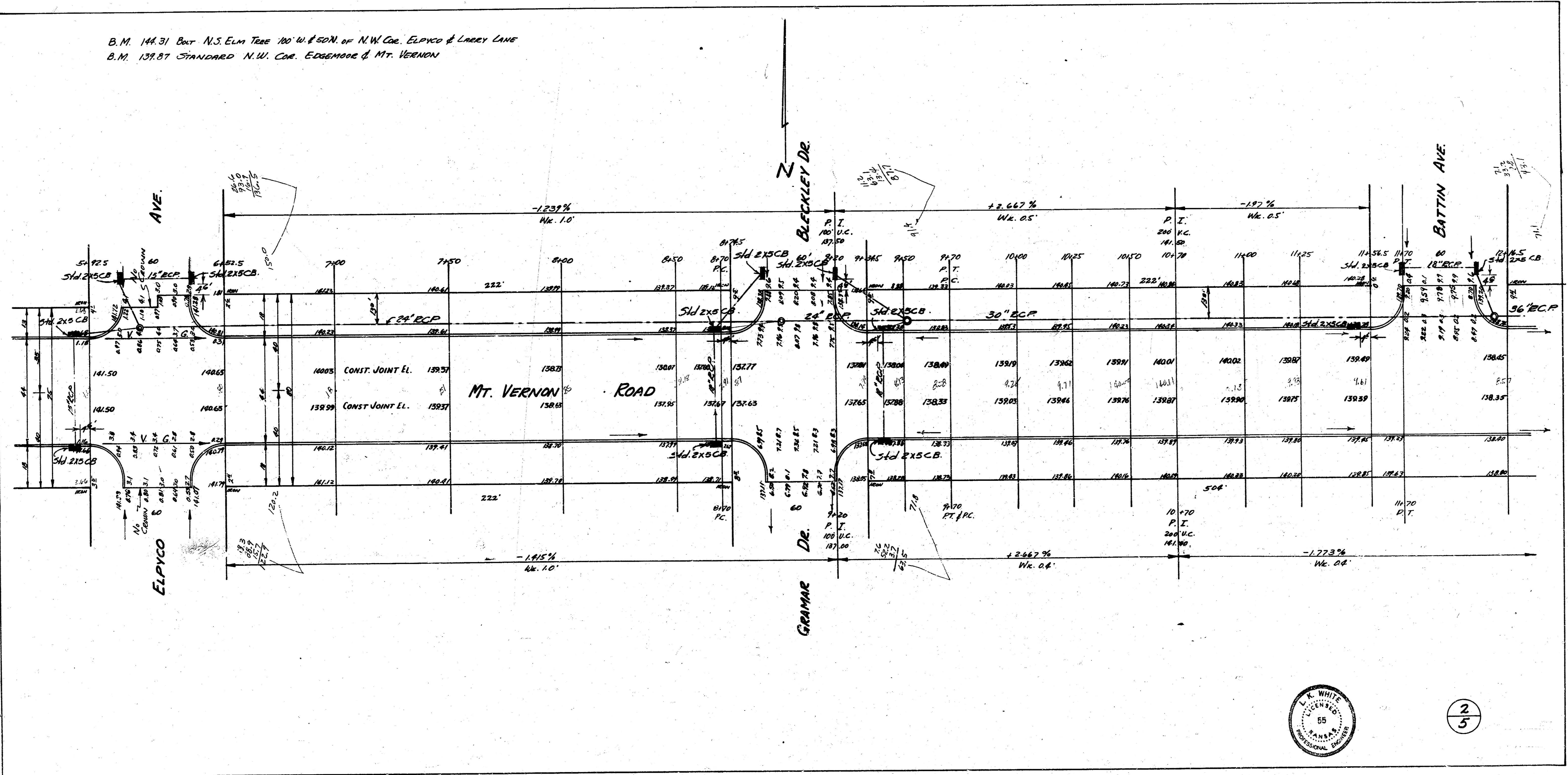

B.M. 144.31 Bolt N.S. Elm Tree 100' W. & 50' N. of N.W. Cor. ELPYCO & LARRY LANE
 B.M. 139.87 STANDARD N.W. COR. EDGEWOOD & MT. VERNON

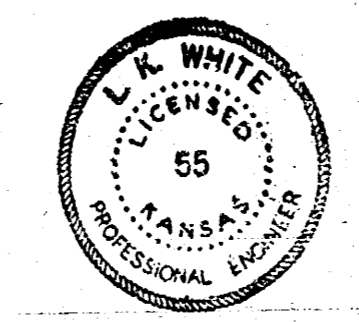
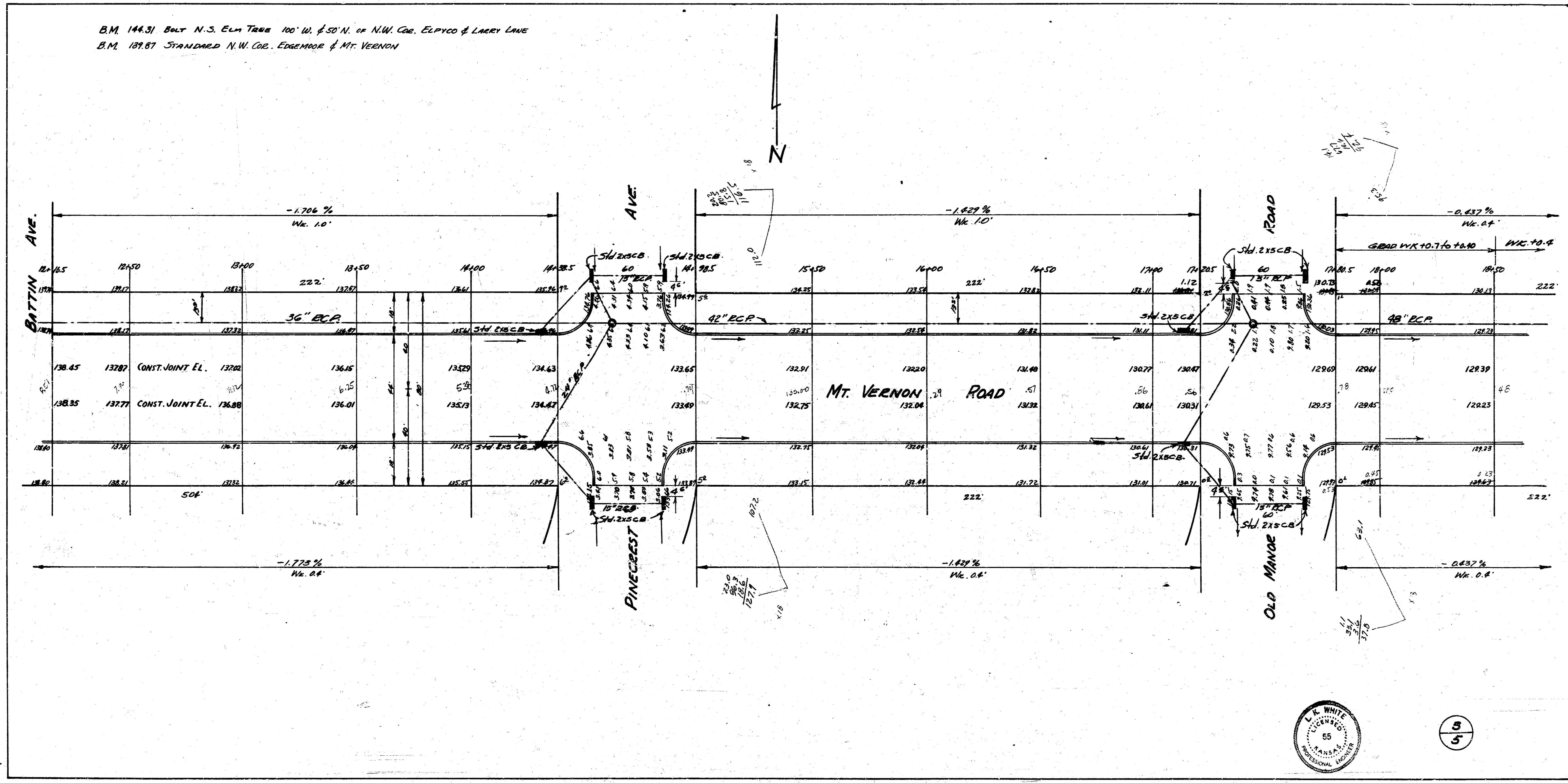

5
5

B.M. 144.31 Bolt N.S. Elm Tree 100' W. & 50' N. of N.W. Cor. Elyco & Larry Lane
 B.M. 137.67 Standard N.W. Cor. Edgebrook & Mt. Vernon

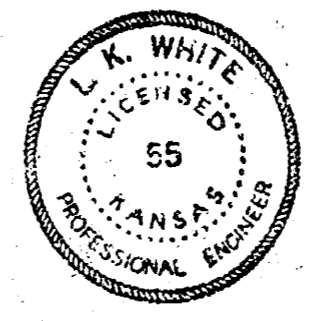
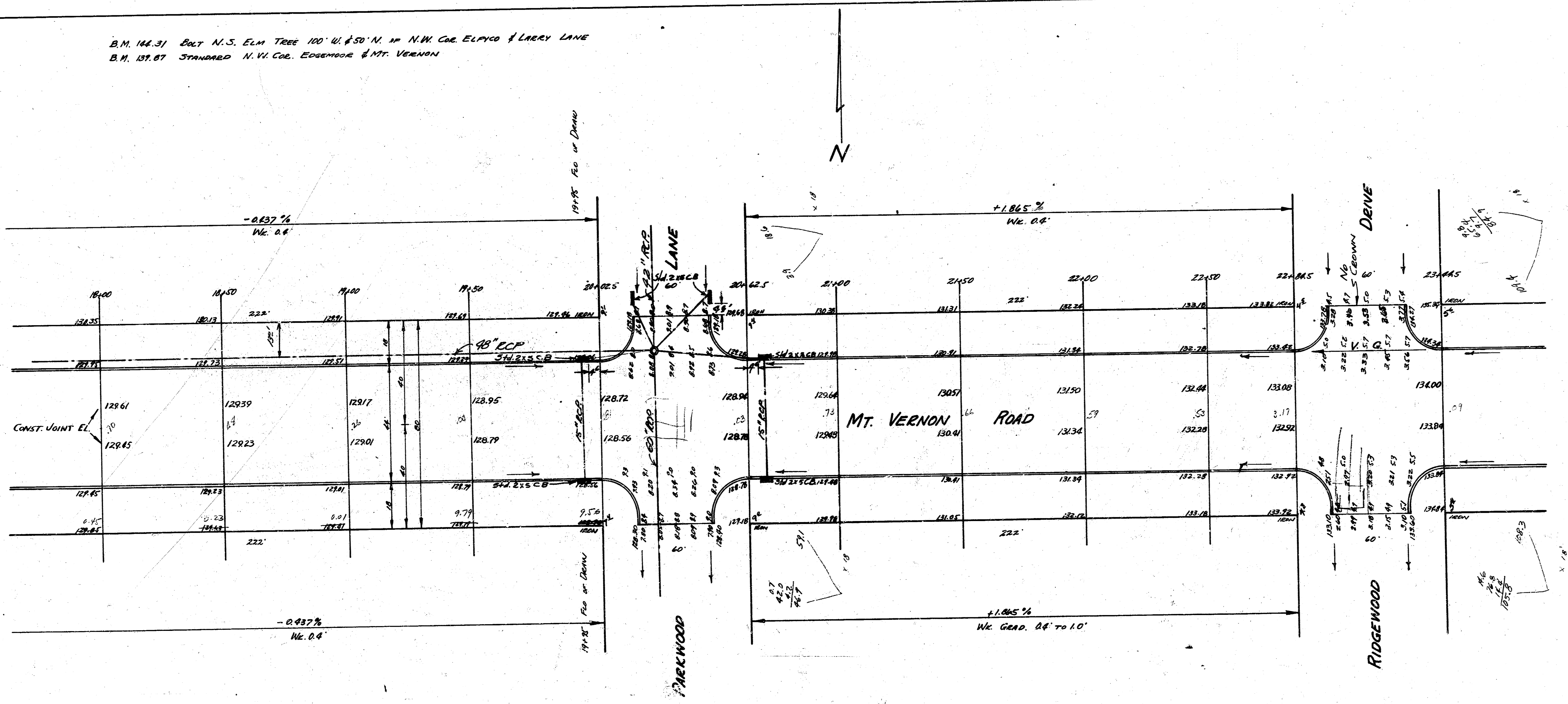

4/5

B.M. 144.31 Bolt N.S. Elm Tree 100' W. & 50' N. of N.W. Cor. Elyco & Larry Lane
 B.M. 151.87 Standard N.W. Cor. Edgemore & Mt. Vernon

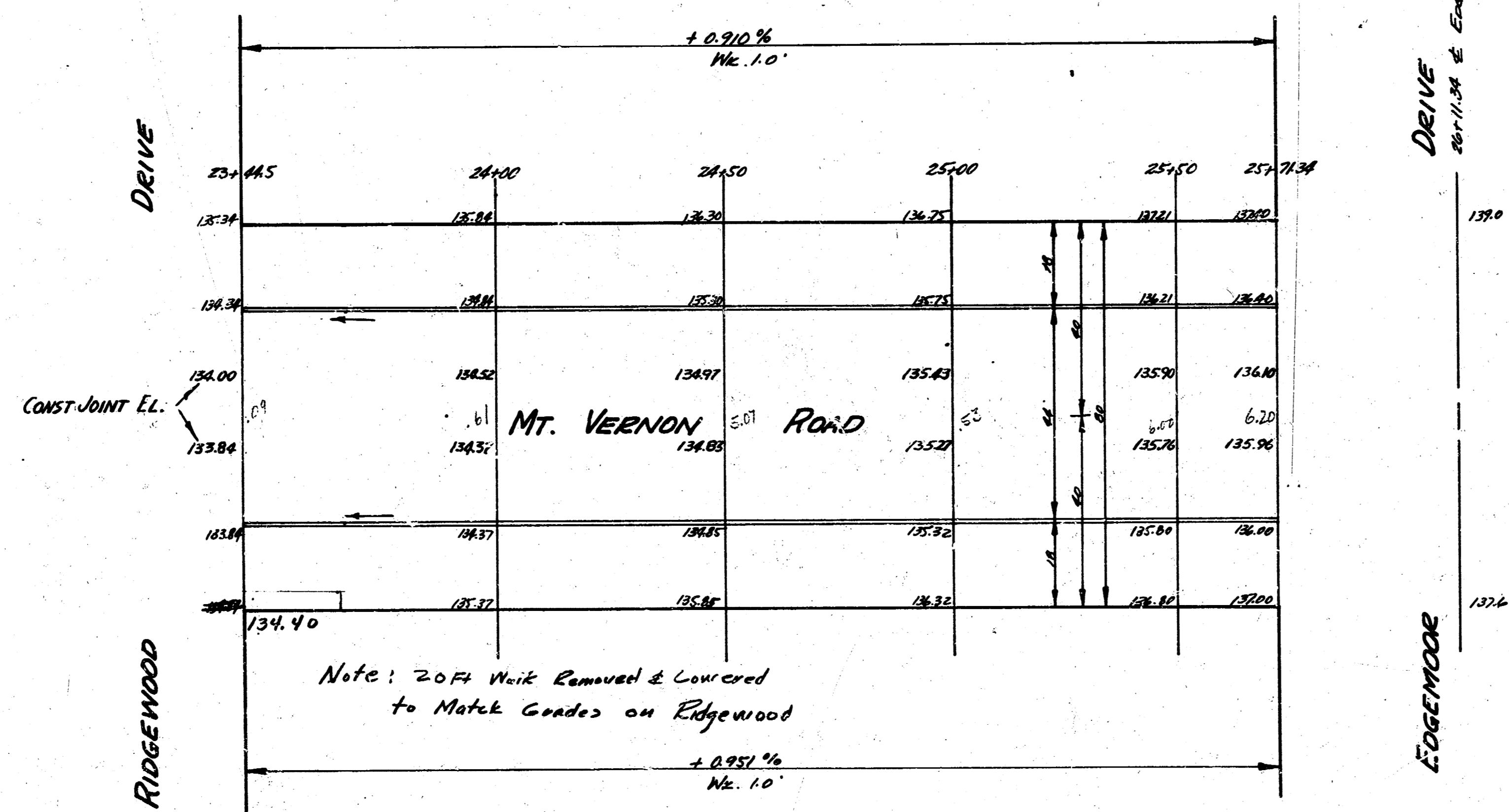
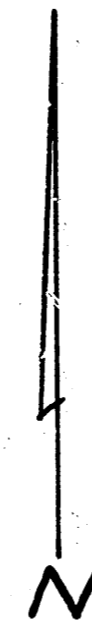

5/5

7375
 2-21-24
 257
 1-1-24