

BM "T" IN TROY F. HYD. NW. COR. MT. VERNON & EXCHANGE PLACE Elev. 102.59

NOTE: CHAINING EAST ON CTRL. LINE MT. VERNON

BM "G" IN GLOBE W. END RADIUS SW. COR. GOLD & MT. VERNON Elev. 99.88

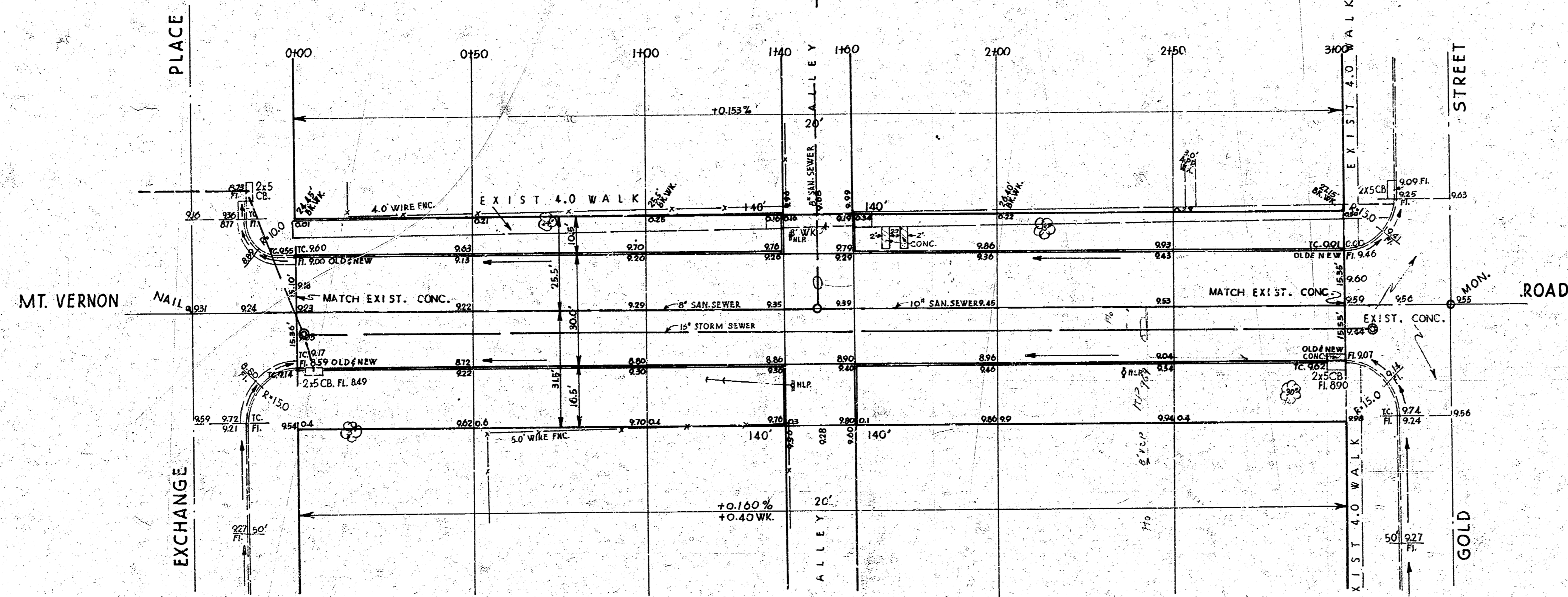

ENGINEER'S SEAL
B.E. SMITH
CITY ENGINEER

EXCAVATION TOTALS

PRCP.	209.1	CITY	42.4
	104.5		20.2
	336.0		20.0 Cu Yds.

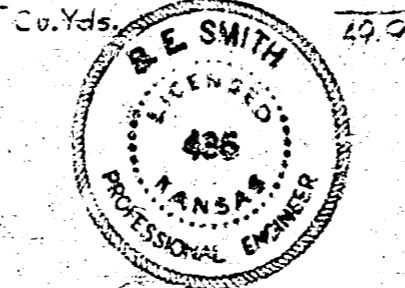

MT. VERNON ROAD
 EXCHANGE PL. TO WL. GOLD
 30' CONC. & CB.
 CITY OF WICHITA, KANSAS
 B.E. SMITH CITY ENGINEER
 MARCH 1956 PROJ. NO. C15-250

