

B.M. 113.18 "6" In Globe Top E. Curb Mathewson Approx. & OP Wk. N.S. Murdock
 B.M. 115.95 "12" On N.W. Cor. N.W. Wing Bridge @ Murdock & Canal
 Stationing On Base Line As Shown.

Checked
 EAC
 B.M. 113.18
 B.M. 115.95

NOTE: TO FIELD ENG. & CONTRACTOR
 1" Drive Is Requested At This Location
 Remove Wk. Seat & Replace On Prop.
 Line To Grade Shown

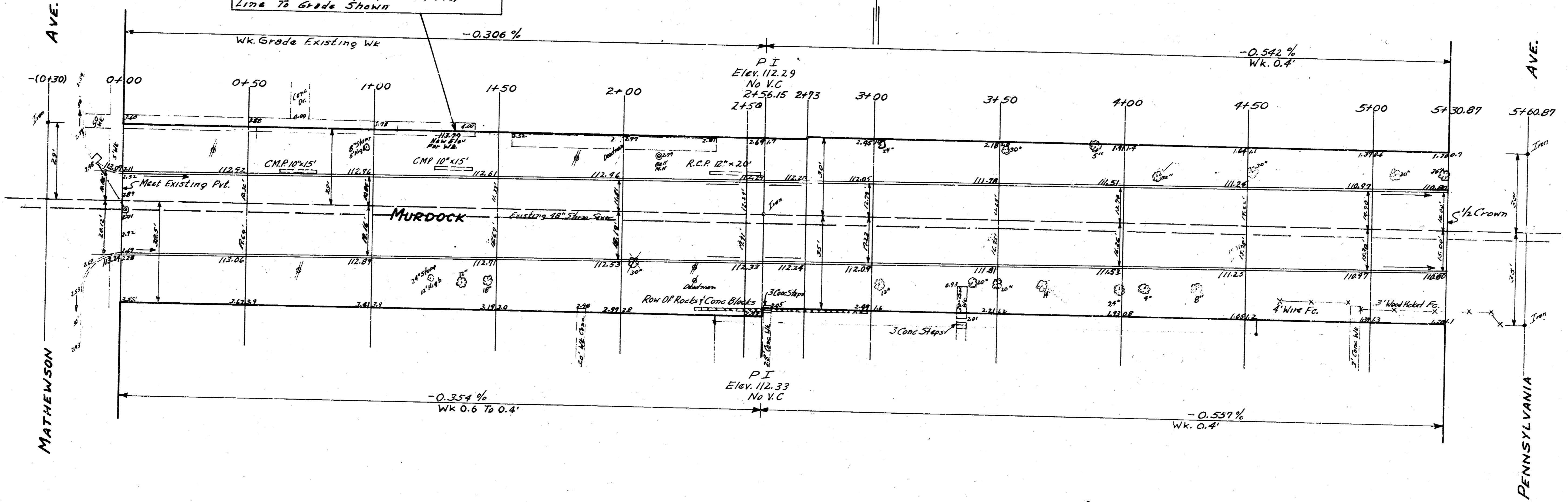

Property
 CUB
 5016
 147-585
 59013 days



MURDOCK
 EL. MATHEWSON TO W.L. WICHITA DRAINAGE CANAL
 30' CONC. & CB.
 CITY OF WICHITA, KAN.
 BE SMITH CITY ENGINEER
 APRIL 1936 Proj. No. C15-195

1/4

NOTE: To Field Eng. And Contractor
 Top Of 48" Brick Storm Sewer
 At This Point Is 102.22 Elev. Use
 Extreme Caution In Paving Construction

50' Reverse Curve
 $E = 126.72$ $\Delta = 11^{\circ} 24'$
 Chord = 25.12'

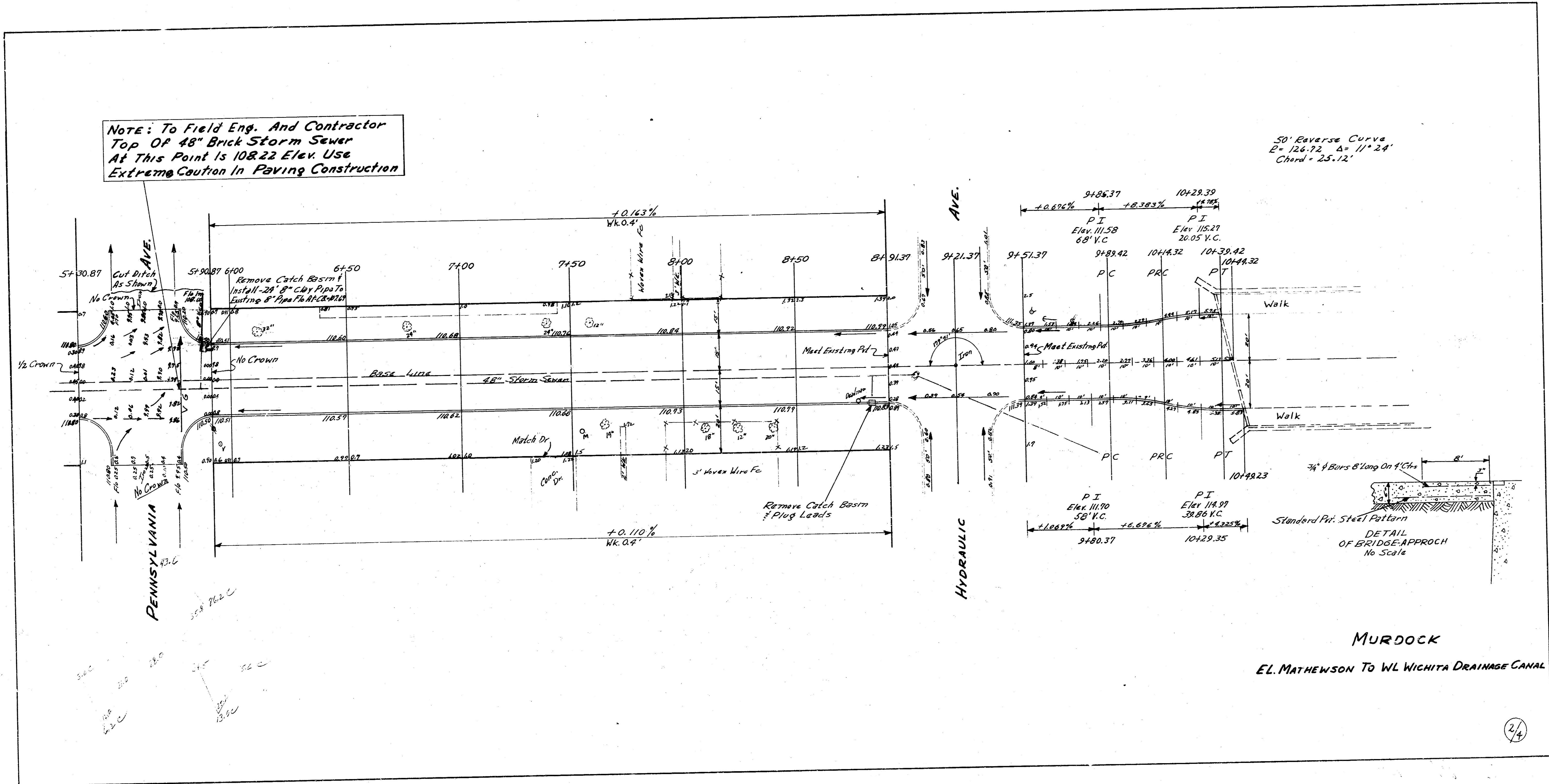

MURDOCK
 EL. MATHEWSON TO WL WICHITA DRAINAGE CANAL