

STREET IMPROVEMENTS

FOR

THE NETT PARK ADDITION

**GREENFIELD CIRCLE: From the west line of Yosemite to
and including Cul-de-sac**

**CARRWOOD CIRCLE: From the west line of Yosemite to
and including Cul-de-sac**

PROJECT NUMBER

472-76-245-81614-000-000-001

GENERAL NOTES

- Utility service lines, poles, valve boxes, meters, and etcetera are to be adjusted as necessary by others prior to construction unless the plans specifically call for their adjustment by the Contractor or unless the plans specifically identify a utility to be adjusted by its owner during construction. Existing utilities and their location, as shown on the plans, represent the best information obtainable for design. The contractor will be required to work around existing utilities within the right-of-way which do not conflict with proposed construction.
- Limits of earthwork shall match existing ground elevations at the right-of-way line unless otherwise noted on the plans with a new finished grade elevation. When a new finished grade elevation is shown, the earthwork shall extend one foot beyond the right-of-way line and then sloped up or down using permissible slopes to match the existing ground surface.
- The Contractor shall be responsible for preserving property irons. The Contractor will be required to re-establish any property irons which are damaged or destroyed by his construction operations. Such irons shall be re-established by a licensed land surveyor or a licensed professional engineer in accordance with state laws.
- No more than 10 drives 80 feet in width, or equivalent combinations thereof, are to be constructed with this project.
- Contractor shall contact Gaylan Nett (942-2062) for driveway locations and for locations to deposit excess excavation material.

BENCHMARKS

- Square cut in top of curb, south side of Yosemite, near the S.E. corner of lot 51, block B, The Nett Park Addition (see plan sheet 2). Elevation = 135.15
- City disc at Maize Road and 27th Street South, 25 feet east and 4 feet south of quarter section corner
Elevation = 145.54 City Datum
- City disc at the SE Corner, NW 1/4 of Section 5-28-1W
Elevation = 128.38 City Datum

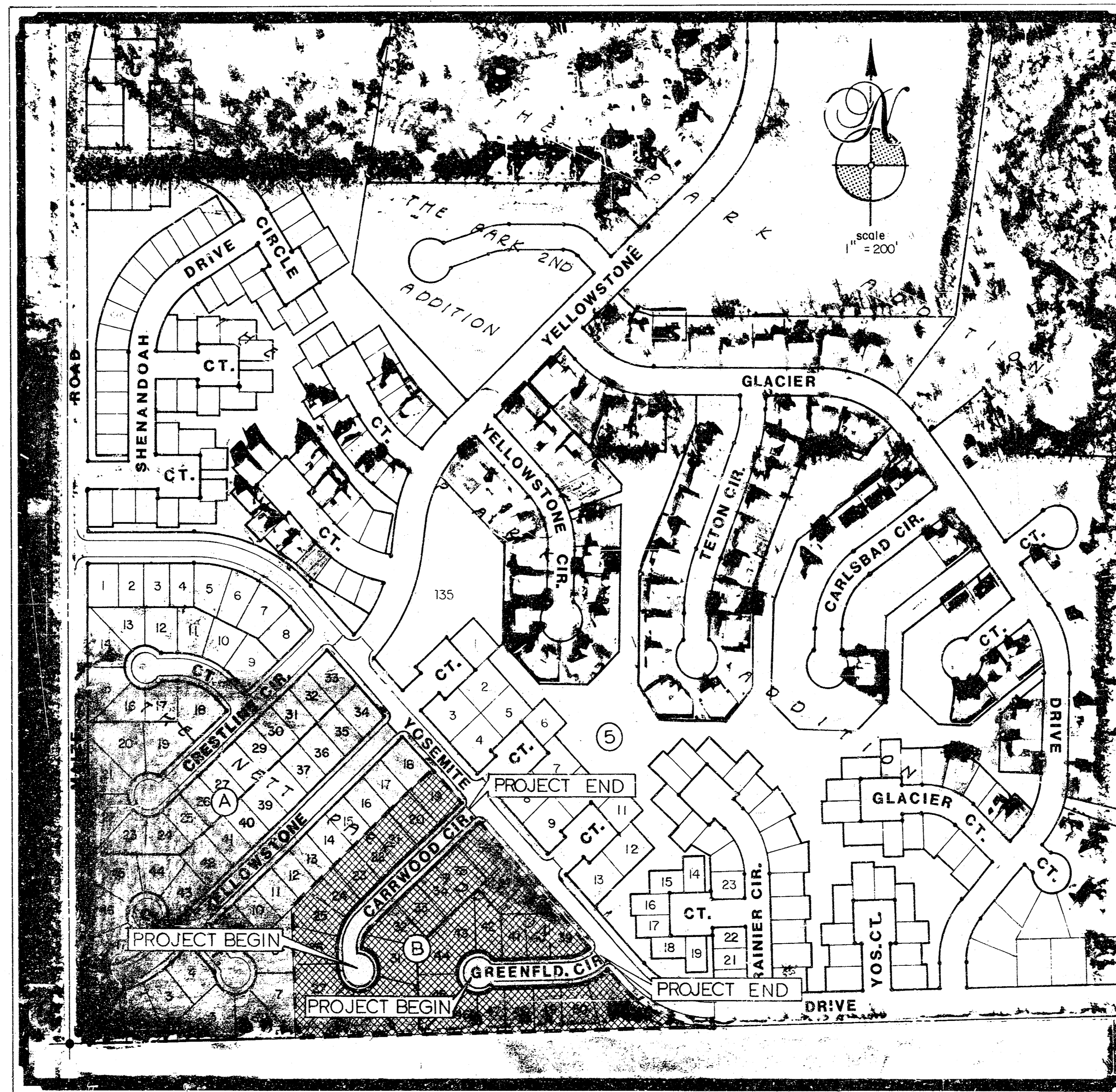

PHASE ONE

☒ BENEFIT DISTRICT

THE CITY of WICHITA, KANSAS

MICHAEL E. LINDEBAK
CITY ENGINEER

INDEX of SHEETS

TITLE SHEET.....	1
TYPICAL SECTION.....	2
PLAN SHEETS.....	3-4
CROSS SECTIONS.....	5-7

BAUGHMAN COMPANY, P.A.				
SURVEYING & ENGINEERING				
315262-7271 • 315 ELLIS • WICHITA, KANSAS 67211				
Design:	Drawn:	Approved:	Date:	Scale:
N.B. Wooten	R.J.P.		April, 1987	1" = 20'

TYPICAL 35' PAVEMENT DETAILS

TRANSVERSE SECTION

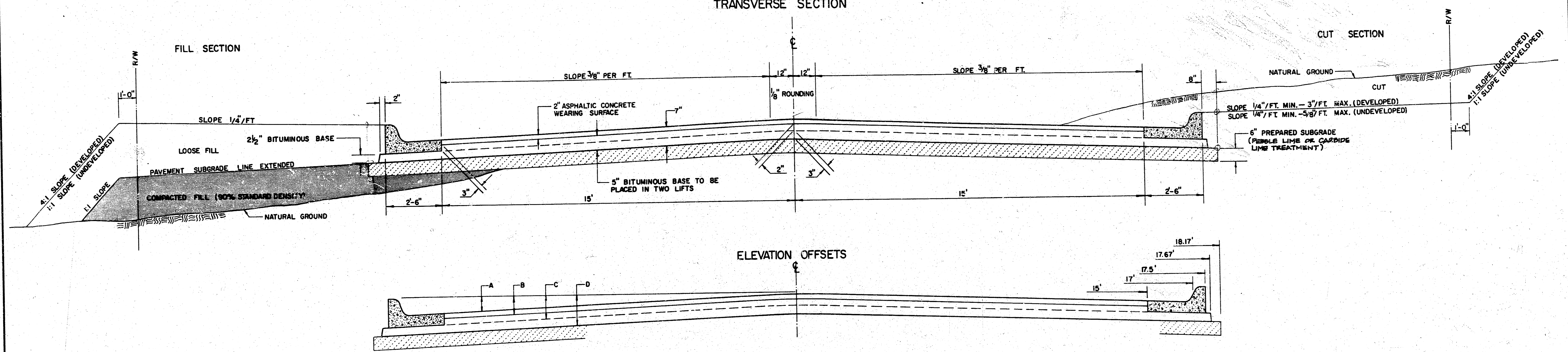

ELEVATION OFFSETS

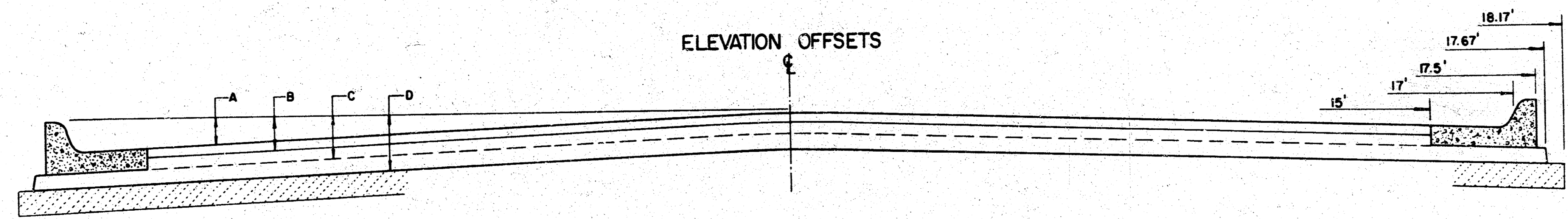

	DISTANCE FROM CENTERLINE (LT. & RT.)												
	0'	2'	4'	6'	8.5'	10'	12'	14'	15'	17'	17.5'	17.67'	18.17'
A: TOP OF CURBS TO TOP OF SURFACE LIFT	0.04	0.08	0.14	0.21	0.29	0.33	0.39	0.46	0.49	—	—	—	—
B: TOP OF CURBS TO TOP OF UPPER BASE LIFT	0.21	0.25	0.31	0.37	0.45	0.50	0.56	0.62	0.65	—	—	—	—
C: TOP OF CURBS TO TOP OF LOWER BASE LIFT	0.37	0.43	0.50	0.57	0.67	0.72	0.79	0.87	0.90	0.98	1.00	1.00	—
D: TOP OF CURBS TO TOP OF SUBGRADE	0.62	0.67	0.74	0.81	0.90	0.95	1.02	1.08	1.12	1.19	1.21	1.21	1.23

COMBINED CURB & GUTTER

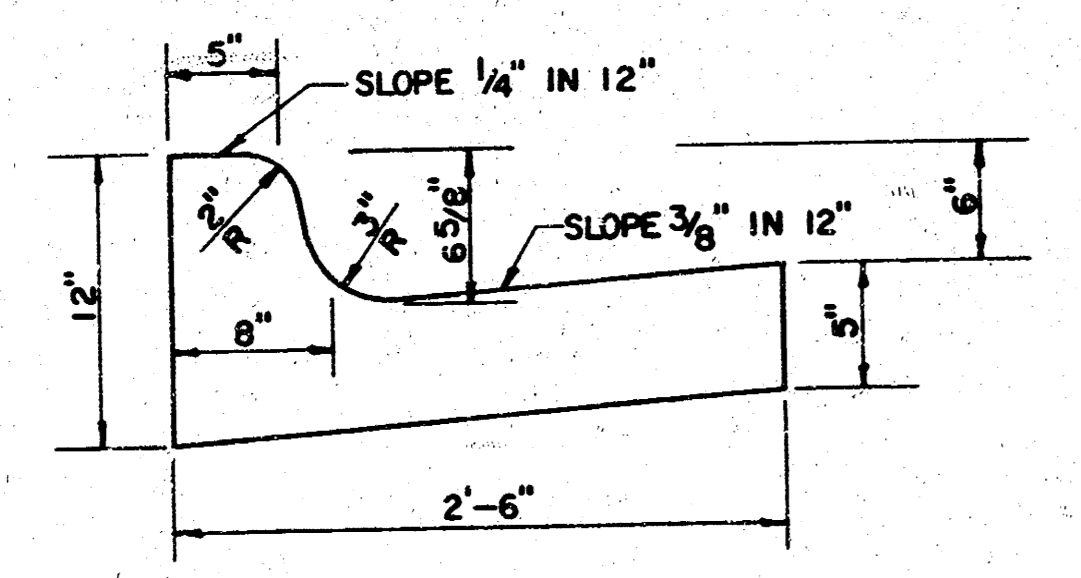

ROLL TYPE COMBINED CURB & GUTTER

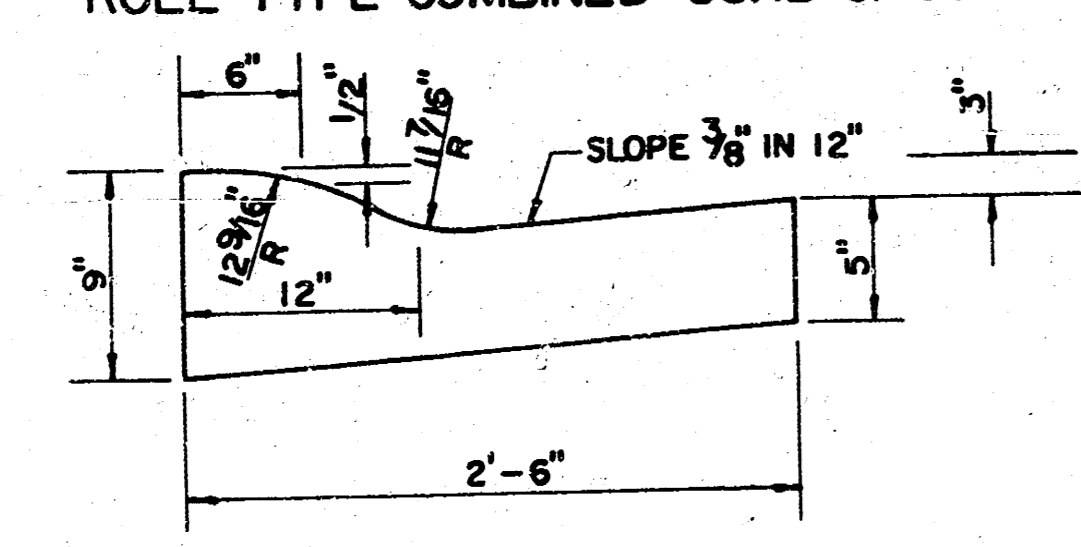

TRANSVERSE CONSTRUCTION JOINTS

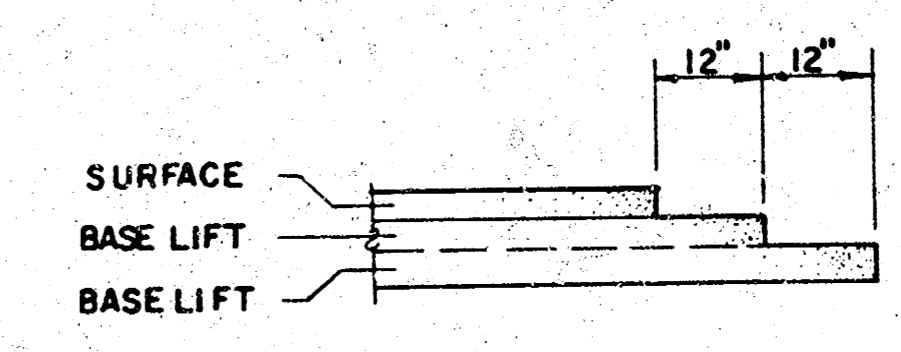

TRANSVERSE CONSTRUCTION JOINTS SHALL BE CONSTRUCTED IN FLEXIBLE BASE PAVEMENTS AT LOCATIONS WHERE PAVEMENT JOINS EXISTING FLEXIBLE BASE PAVEMENT AS SHOWN BY THE DETAIL. ALL COSTS ASSOCIATED WITH THE CONSTRUCTION OF THE TRANSVERSE JOINT SHALL BE INCLUDED IN THE BID PRICE FOR SQUARE YARDS 7\"/>

GENERAL NOTES

- 1) THE ASPHALTIC CONCRETE PAVEMENT BETWEEN THE COMBINED CURB AND GUTTER SHALL BE PAID AS SQUARE YARDS OF 7\"/>
- 2) THE BITUMINOUS BASE UNDER AND BEHIND THE COMBINED CURB AND GUTTER SHALL BE PAID AS SQUARE YARDS OF 2 1/2\"/>
- 3) A TACK COAT OF EMULSIFIED ASPHALT (SC-1H OR CSS-1H) SHALL BE APPLIED AT AN APPROXIMATE RATE OF 0.05 GALLONS PER SQUARE YARD BETWEEN EACH LIFT OF ASPHALTIC MATERIAL.
- 4) BITUMINOUS BASE AND ASPHALTIC CONCRETE WEARING SURFACE SHALL BE PLACED WITH A LAYDOWN MACHINE HAVING AUTOMATIC CONTROLS FOR LINE AND GRADE.
- 5) CONSTRUCTION JOINTS IN EACH LIFT SHALL BE STAGGERED A MINIMUM DISTANCE OF ONE (1) FOOT FROM JOINTS IN PRECEDING LIFTS AND PLACED SO THAT A JOINT WILL BE CONSTRUCTED ON THE CENTERLINE OF THE TOP LIFT.
- 6) CONTRACTOR TO BID ONLY ONE SUBGRADE TREATMENT ALTERNATE WHEN ALTERNATES ARE PROVIDED IN THE PROPOSAL AND CONTRACT. THE ALTERNATE CHOSEN BY THE SUCCESSFUL BIDDER SHALL BE USED IN CONSTRUCTING THIS PROJECT.

7 INCH RESIDENTIAL ASPHALTIC CONCRETE PAVEMENT WITH 5 INCH BITUMINOUS BASE
CITY OF WICHITA, KANSAS
 PROJECT NUMBER
 472-76-245-81614-000-000-001

2/7

- PROJECT BENCH MARKS**
- Square set in top of curb, south side of Yosemite, near the S.E. corner of lot 41, block 9, The Nett Park Addition (see plan sheet 2). Elevation = 135.19
 - City disc at Maine Road and 27th Street South, 25 feet east and 4 feet south of quarter section corner. Elevation = 145.54 City Datum
 - City disc at the SE Corner, NW 1/4 of Section 5-28-14. Elevation = 128.38 City Datum

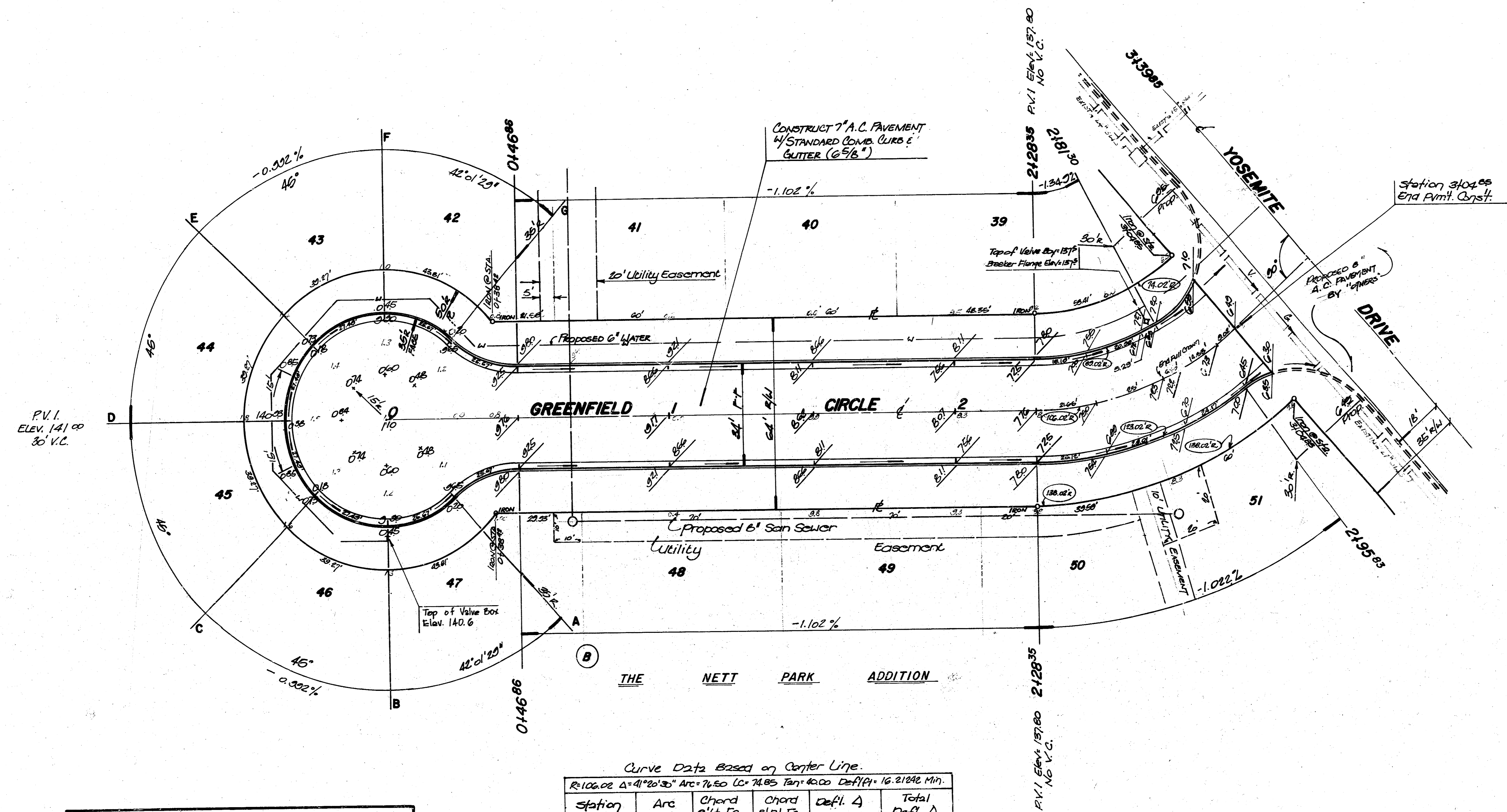
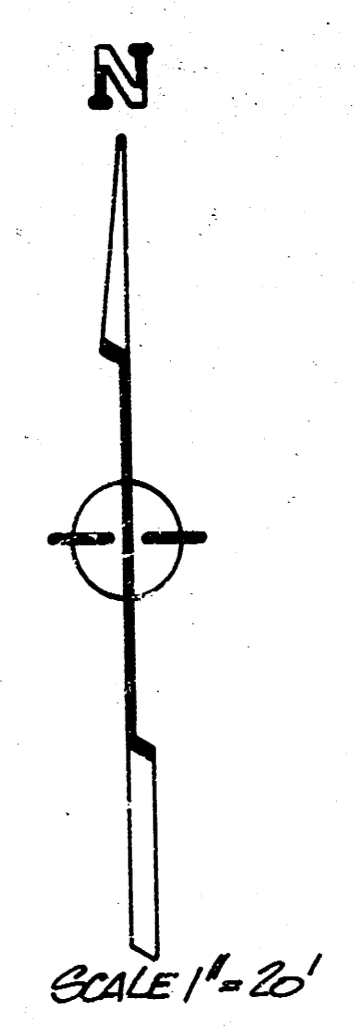

Earthwork Summary
 Excavation 2853.0 cy. Loose Fill 27 cy.
 +10% 285.0 cy.
 Total 3144.5 cy. No Compacted Fill
 Subgrade Manipulation 3863.0 sq.

Curve Data Based on Center Line.

Station	Arc	Chord B't. P.C.	Chord B't. P.T.	Defl. Δ	Total Defl. Δ
2128+00	—	—	—	—	—
2150	21.65	16.51	26.71	5°31'00"	5°31'00"
2175	25	19.06	32.82	6°45'15"	12°36'15"
2195	6.30	4.81	—	1°42'08"	14°18'27"
2195+33	14.53	—	26.70	3°25'34"	18°14'01"
3104+00	3.02	17.36	11.15	2°26'14"	20°40'15"

472-76-245-81614-000-000-001
GREENFIELD CIRCLE
 STA. 0+00 to STA. 3+04.85

BAUGHMAN COMPANY, P.A.
 SURVEYING & ENGINEERING
 316-262-7271 • 315 ELLIS • WICHITA, KANSAS 67211

Prepared: N.B. Woodson
 Checked: A.J.P./c.s.
 Date: April, 1987
 Scale: 1"=20'

Sheet: 3
 of: 7 3/7

- PROJECT RECON-MARKS
- 1) Square cut in top of curb, south side of Yosemite, near the S.E. corner of lot 31, block B, The West Park Addition (see plan sheet 2). Elevation = 125.15
 - 2) City disc at Main Road and 27th Street South, 25 feet east and 4 feet south of quarter section corner. Elevation = 149.84 City Datum
 - 3) City disc at the SE corner, NW 1/4 of Section 5-28-1W. Elevation = 129.38 City Datum

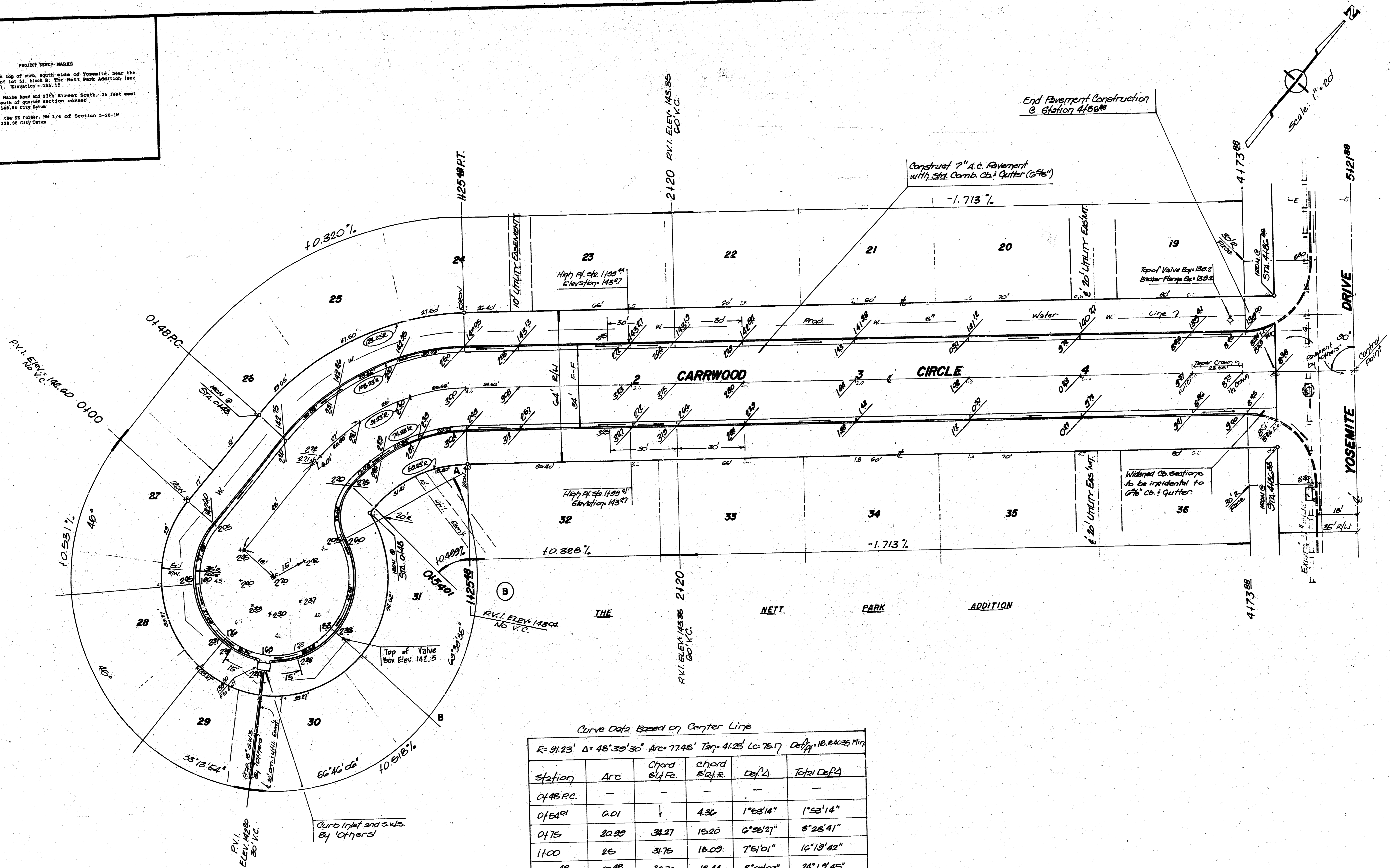

Curve Data Based on Center Line

$R=91.23'$ $\Delta=48^{\circ}30'30''$ $Arc=77.45'$ $Tan=41.25'$ $Lo=76.17'$ $Defl_{1/2}=18.84035$ Min

Station	Arc	Chord	Chord	Defl A	Total Defl A
		by FC	by R.R.		
0+48 P.C.	-	-	-	-	-
0+54.01	0.01	↓	4.36	1°53'14"	1°53'14"
0+75	20.99	34.27	15.20	6°55'27"	8°26'41"
1+00	25	31.75	18.00	7°51'01"	16°17'42"
1+25.48 P.T.	25.48	32.36	18.44	8°03'03"	24°19'45"

- LEGEND
- IRON
 - LOT LINE
 - WATER LINE
 - SANITARY SEWER
 - STORM W. SEWER
 - K&E LINES

472-76-245-81614-000-000-001
CARRWOOD CIRCLE
 STA. 0+00 to STA. 4+68.88

B BAUGHMAN COMPANY, P.A.
 SURVEYING & ENGINEERING
 315 262-7271 • 315 ELLIS • WICHITA, KANSAS 67211

Prepared by: N.S. Noodin
 Drawn by: R.J.P.C.B.
 Checked by: TCR
 Date: April, 1987
 Scale: 1" = 20'

Sheet 4 of 7

140

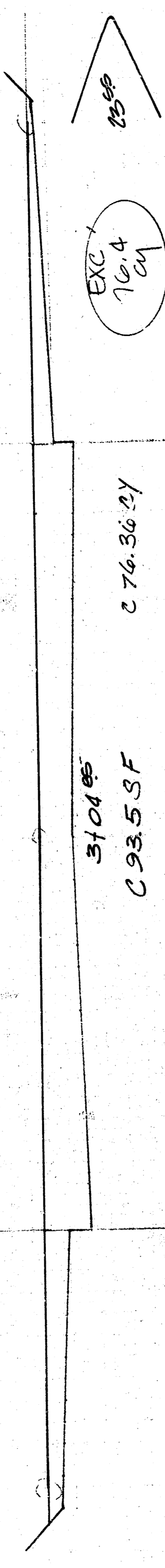

140

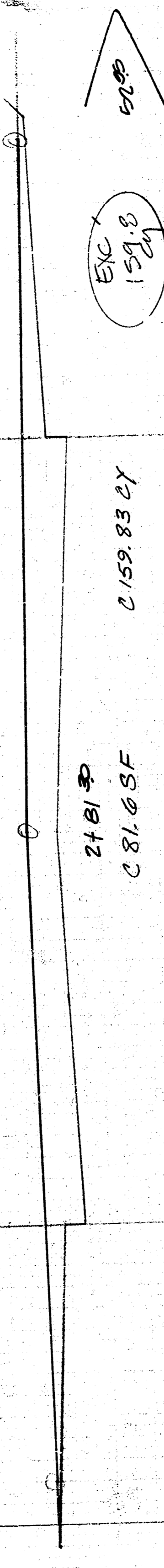

140

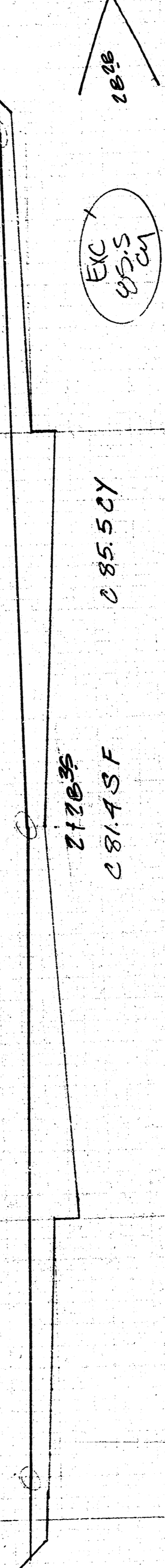

140

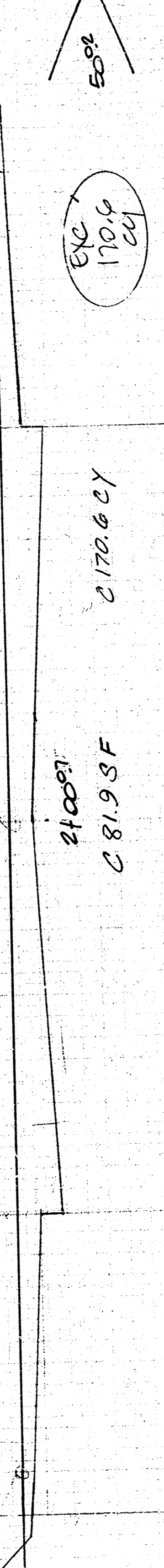

140

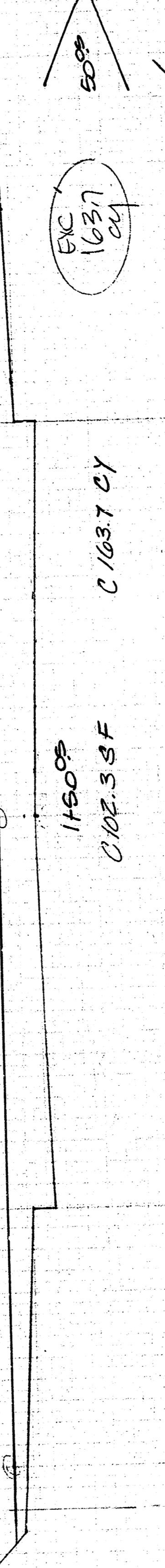

140

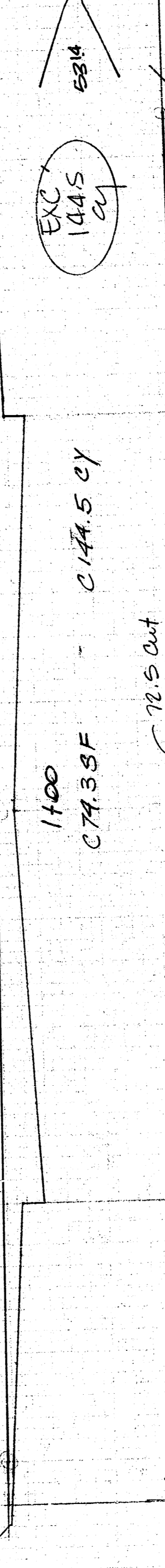

140

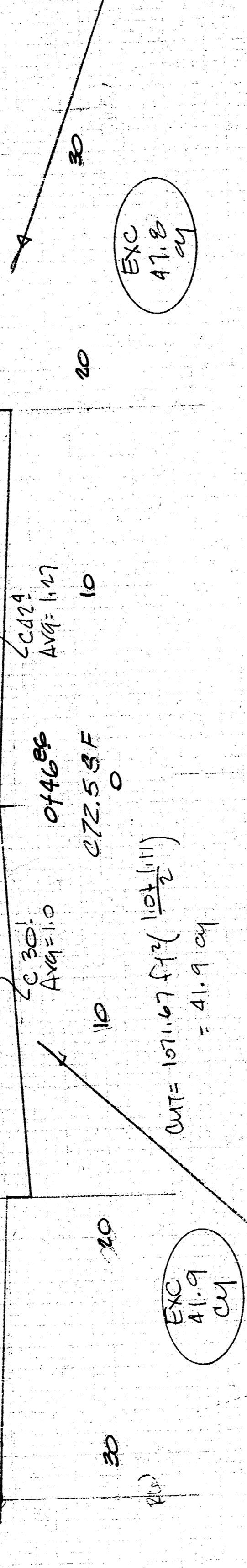

140

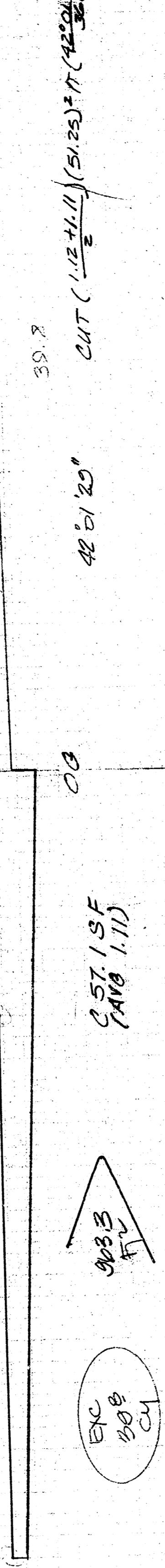

140

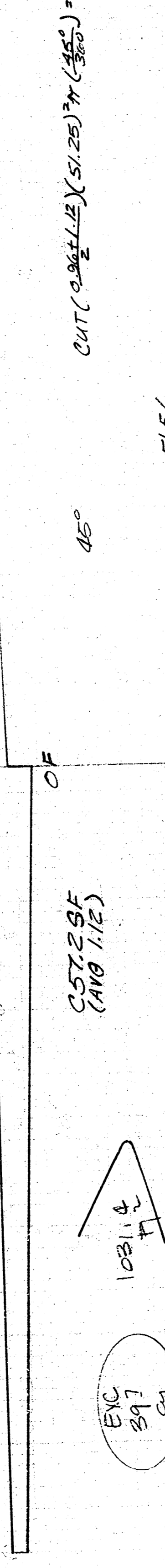

140

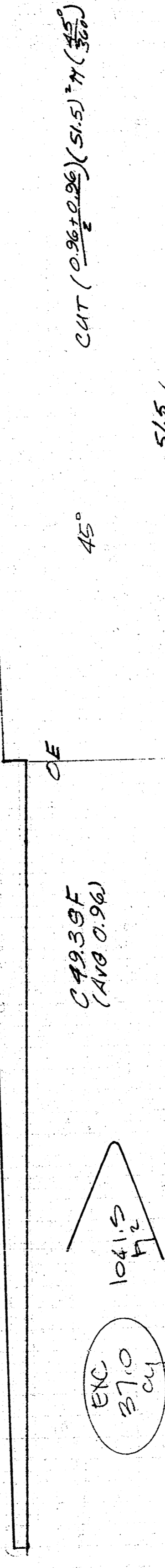

140

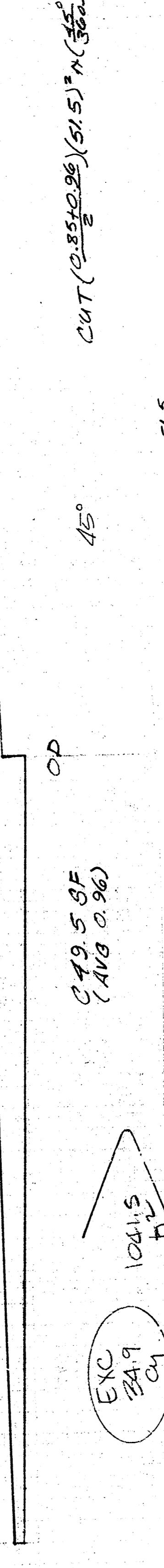

140

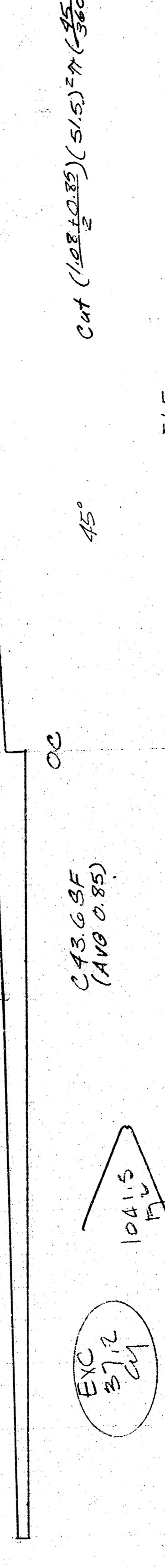

140

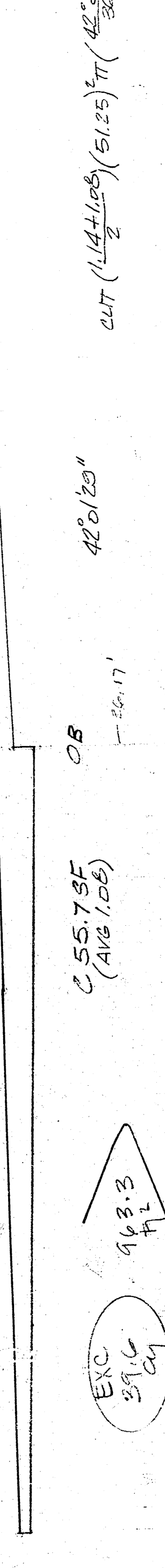

140

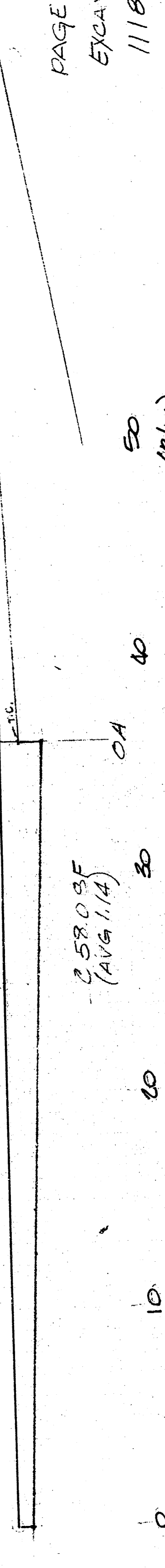

140

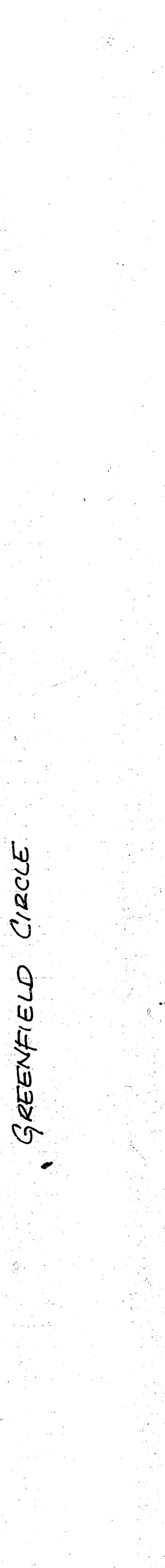

PAGE TOTALS
 EXCAVATION 1118.40 CUBIC YARDS

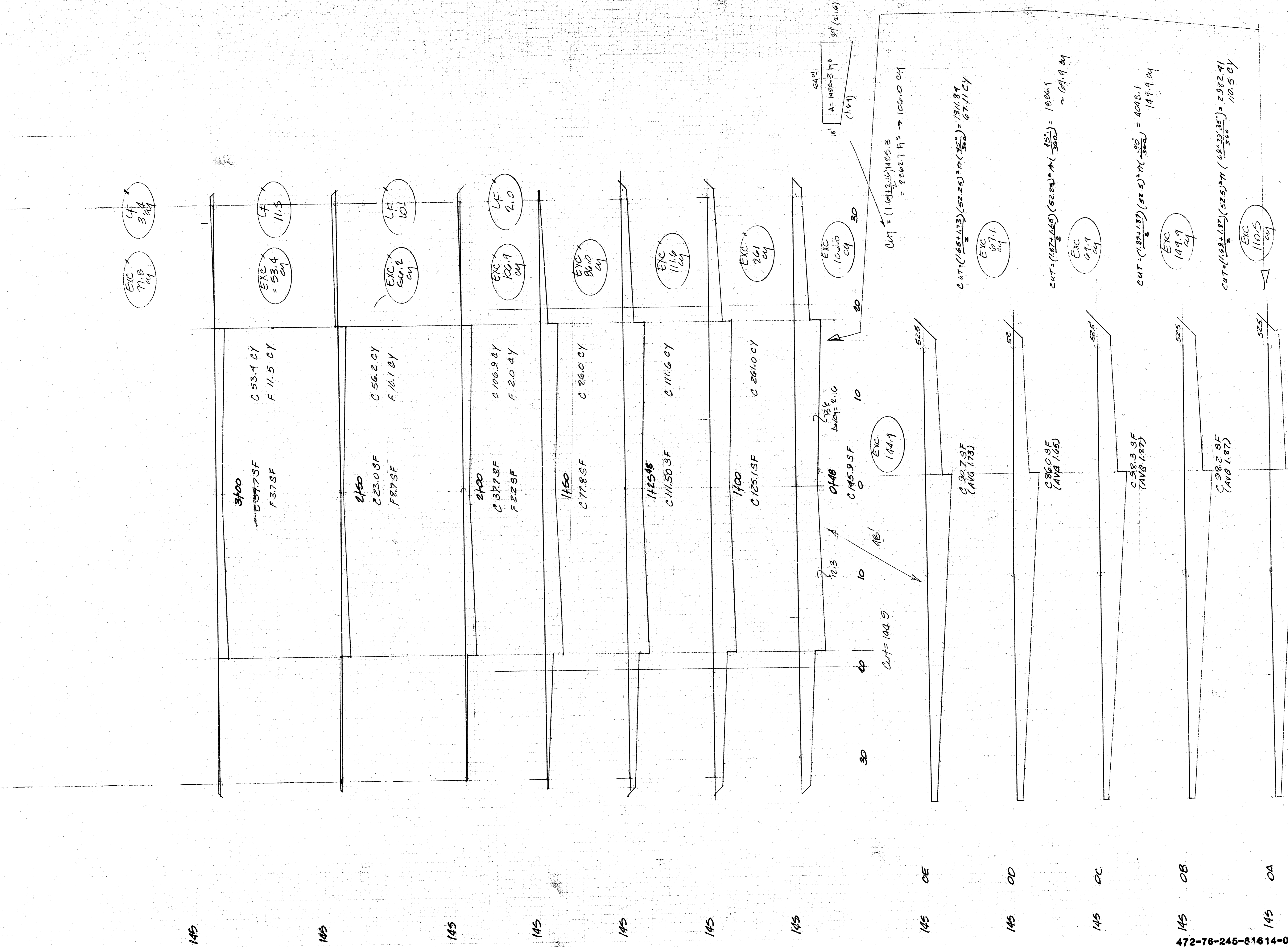

EXC 71.8
CY

LF 3.4
CY

EXC 53.4
CY

LF 11.5
CY

EXC 50.2
CY

LF 10
CY

EXC 100.9
CY

LF 2.0
CY

EXC 80.0
CY

EXC 111.6
CY

EXC 201
CY

EXC 100.0
CY

EXC 144.1
CY

EXC 107.1
CY

EXC 07.9
CY

EXC 149.9
CY

EXC 110.5
CY

PAGE TOTALS
EXC 1101.2
LF 87.0

EMBLEMORE TOTALS
EXC 1058.4
LF 27.0
CY

67

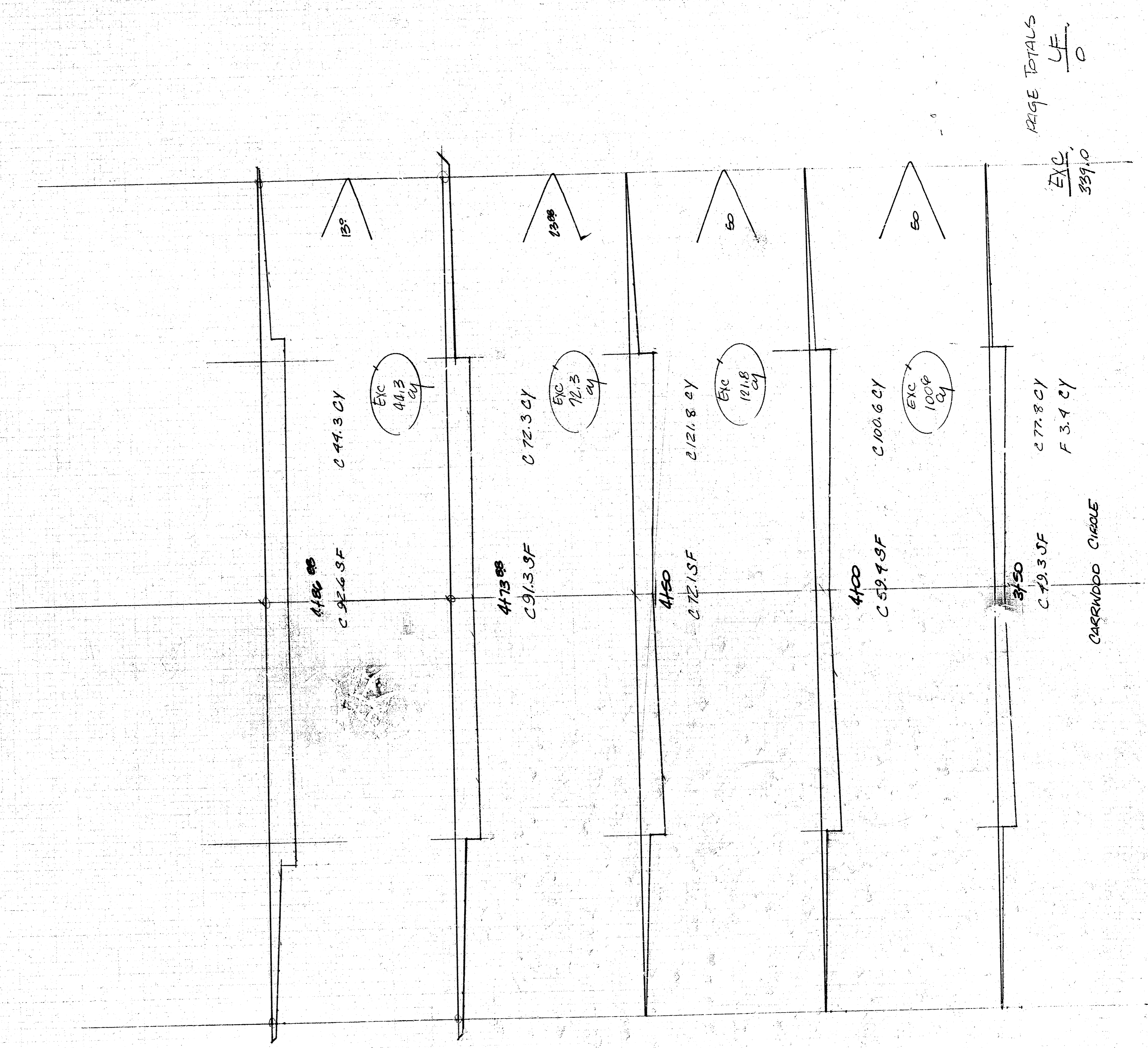

EXC
 3391.0
 RANGE TOTALS
 LF
 0

142

145

145

145

145

472-76-245-81614-000-000-001

7/7