

1942
 NEWYORK AVE. — N.L. MATHEWSON LANE TO S.L. CENTRAL
 30-C.I.

NOTE: REBUILD RETURN WITH
 15' R. PUT IN SIDE RR. INT. ON
 BOTH S.W. + S.E. COR.

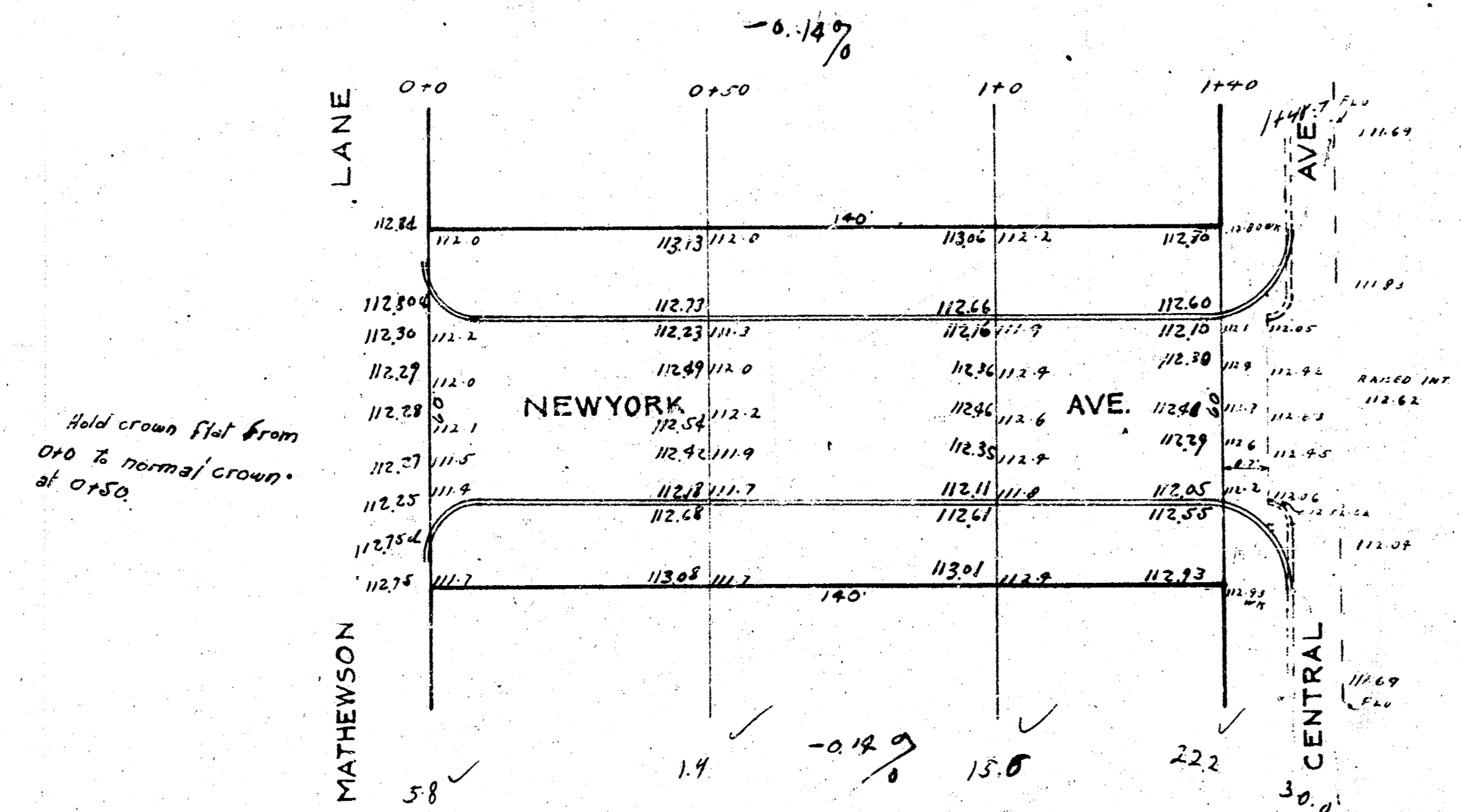

B.M. 112.51 H. W. HURST ON LUG S.E. COR. N.Y. AVE + CENTRAL