

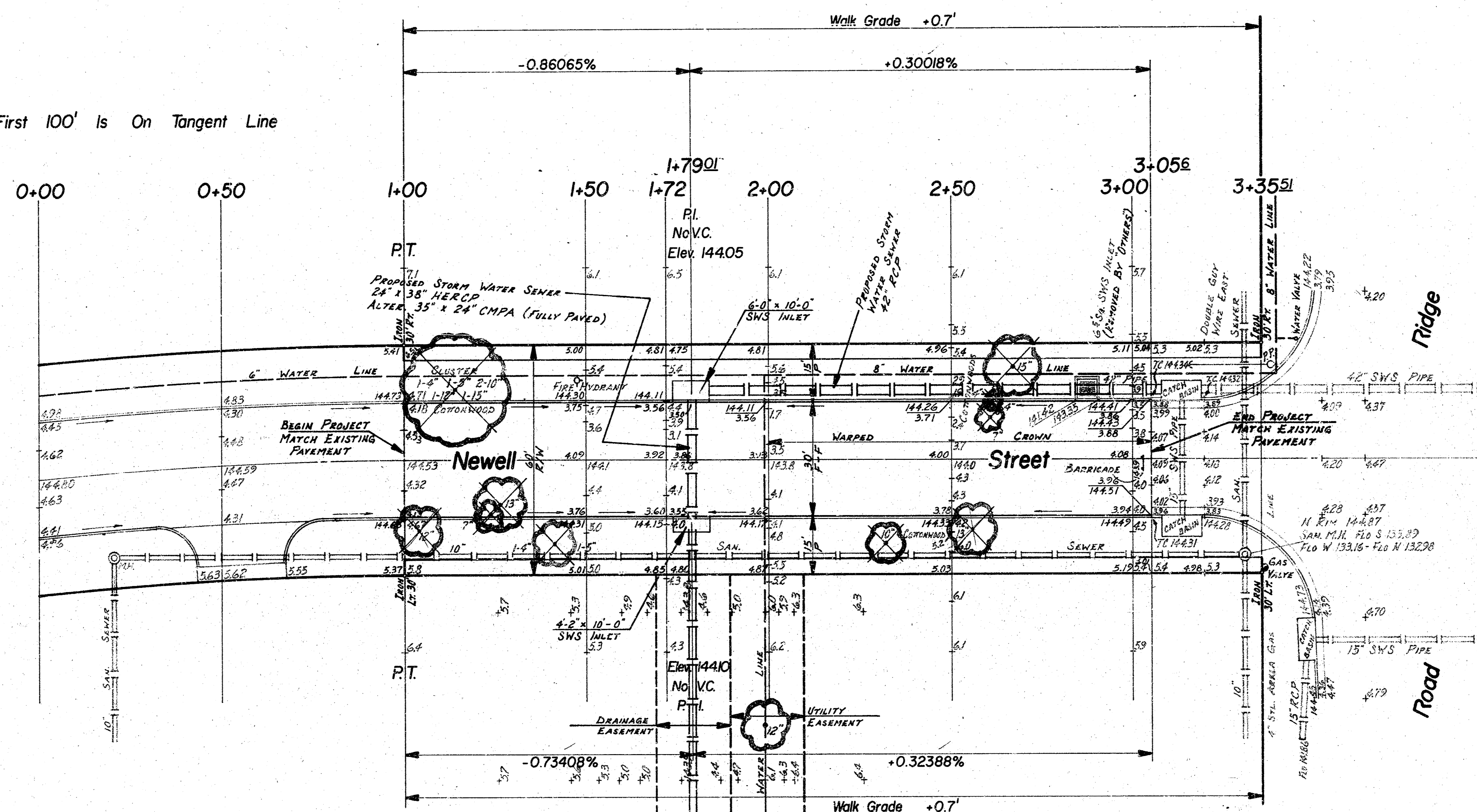

BM 14763 SW Cor. Conc. Porch #502 Summitlawn  
 BM 14839 SE Cor. Conc. Porch #503 Acadia Lane

Baseline For Acadia Lane Is Centerline  
 Baseline For Newell Street Is On Centerline Except First 100' Is On Tangent Line

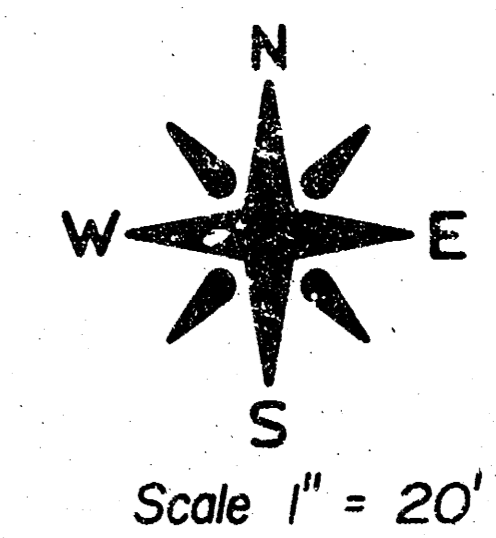

- GENERAL NOTES
1. PAVING CONTRACTOR TO COORDINATE CONSTRUCTION WITH DRAINAGE CONSTRUCTION.
  2. COST OF REMOVING BARRICADE TO BE INCIDENTAL TO PROJECT.
  3. WALK IS NOT TO BE CONSTRUCTED ON THIS PROJECT.

USE #6 BARS THRU-OUT UNLESS NOTED

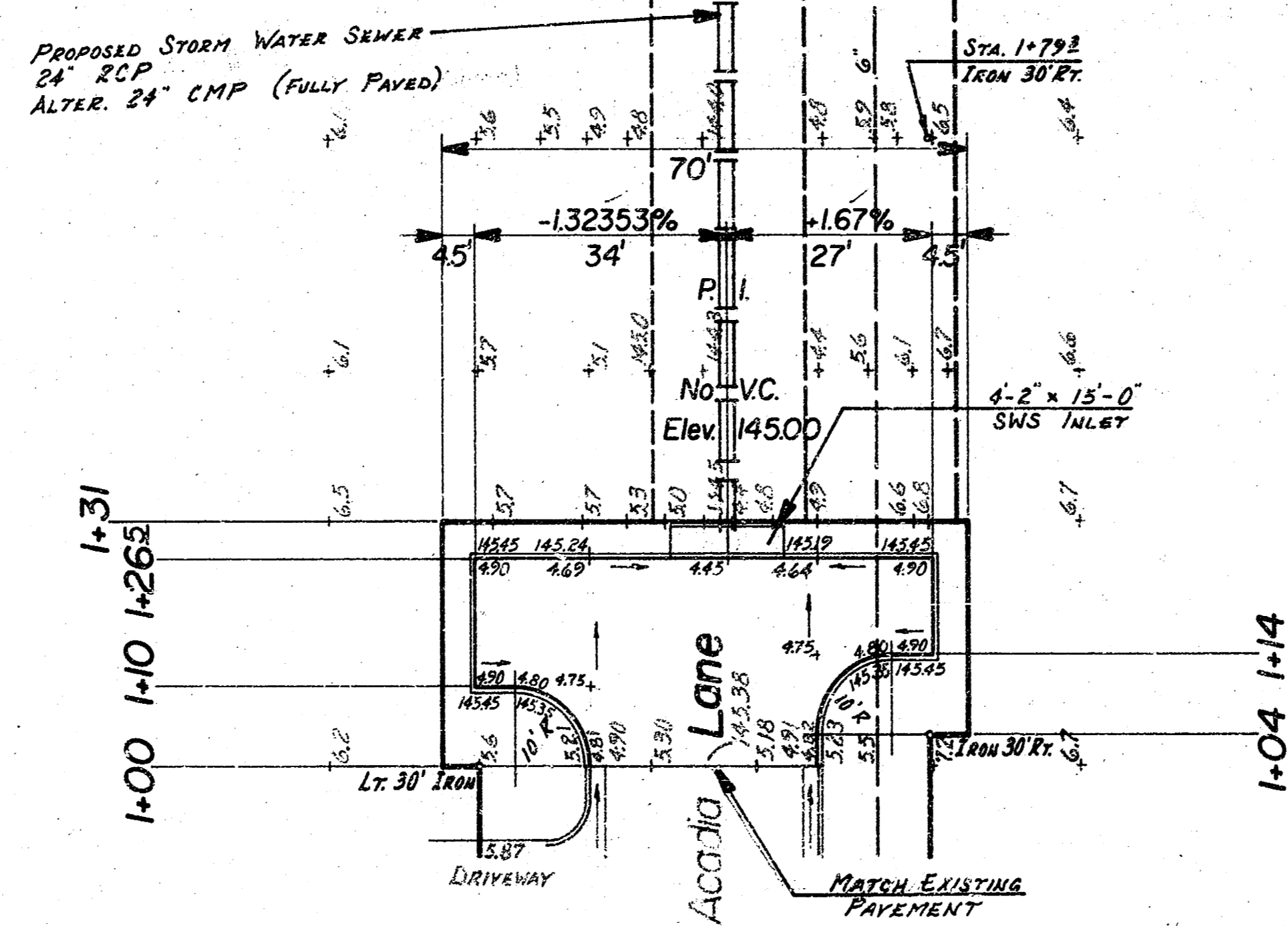
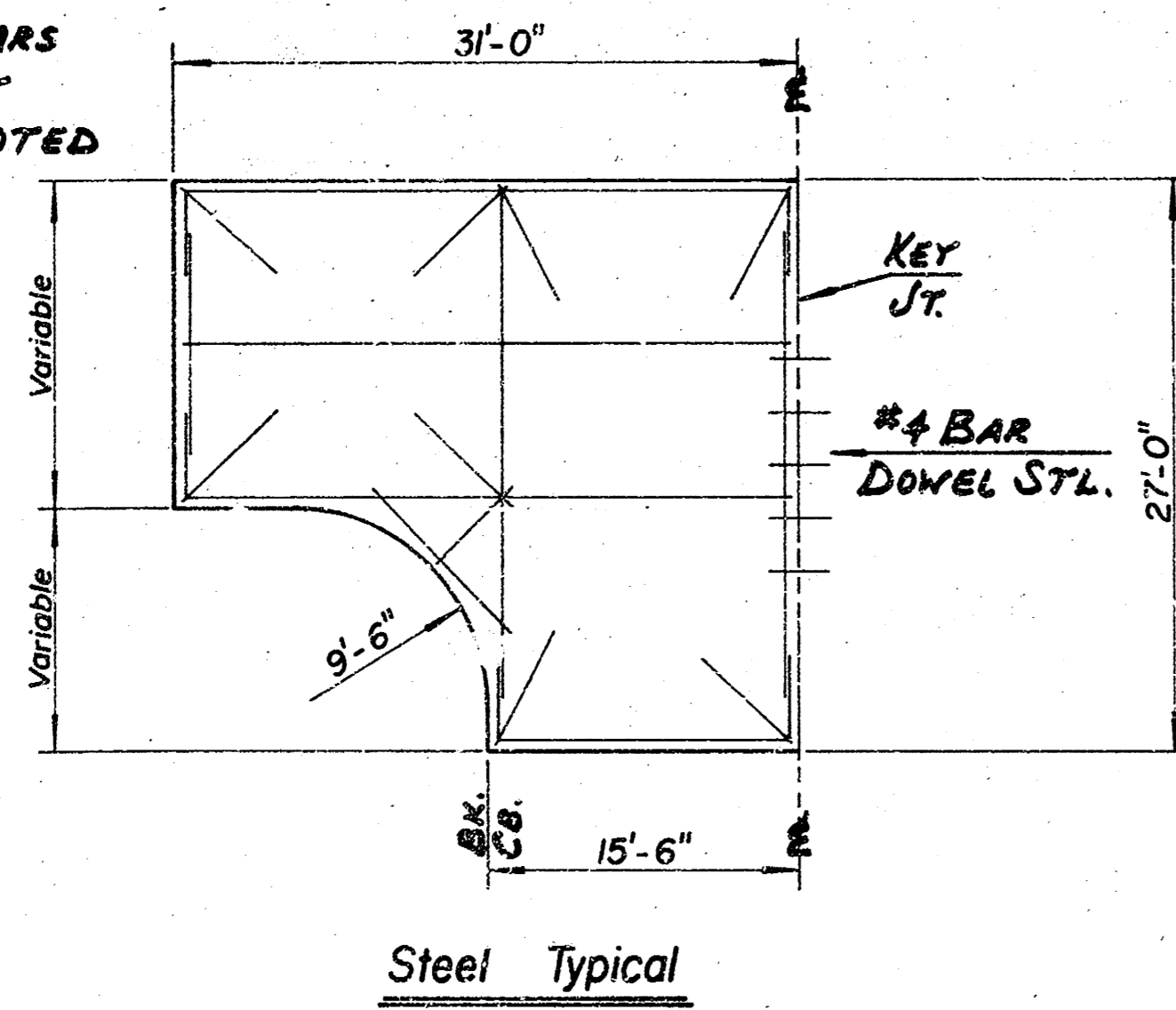

EARTHWORK		PROPERTY	
Excavation	255.5 Cu.Yds.	Compacted Fill	13.7 Cu.Yds.
+10%	25.6 Cu.Yds.	+10%	1.4 Cu.Yds.
<b>TOTAL</b>	<b>281.1 Cu.Yds.</b>	<b>TOTAL</b>	<b>15.1 Cu.Yds.</b>
		MANIPULATION	220.1 Sq.Yds.

NOTE: REMOVE TREES AS NOTED  
 TWUS: EXCEPT FOR TREES WHICH, IN THE OPINION OF THE ENGINEER, CAN AND SHOULD BE SAVED.

TYPE OF SUBGRADE TREATMENT SHALL BE DETERMINED BY THE FIELD ENGINEER. SUB-GRADE AND BASE COURSE SHALL BE 12\"/>

Newell Street From A Point 74.79 Ft. East Of The W.L. Lot 11, Blk. A, Central Heights Second Addition To The W.L. Ridge Road; Also Acadia Lane From The N.L. Lot 16, Blk. L, Meadowview Estates To & Including Cul-De-Sac  
 R. W. Linn City Engineer  
 Proj. No. 472 76 245 80393 000 000 001  
 Date:  
 Sheet 2 Of 3

FILMED FROM THE BEST AVAILABLE COPY.....