

B.M. 124.71 - RR Spike in Elm Tree 75' E. of Salina on NS of N River Blud

SCALE 1" = 20'

ERC.

PROP.	2.2
12.5	56
3.5	6.0
4.1	77.5
6.3	+10%
5.9	12.8
13.5	
45.7	
107.6	
59.3	in. VOS.

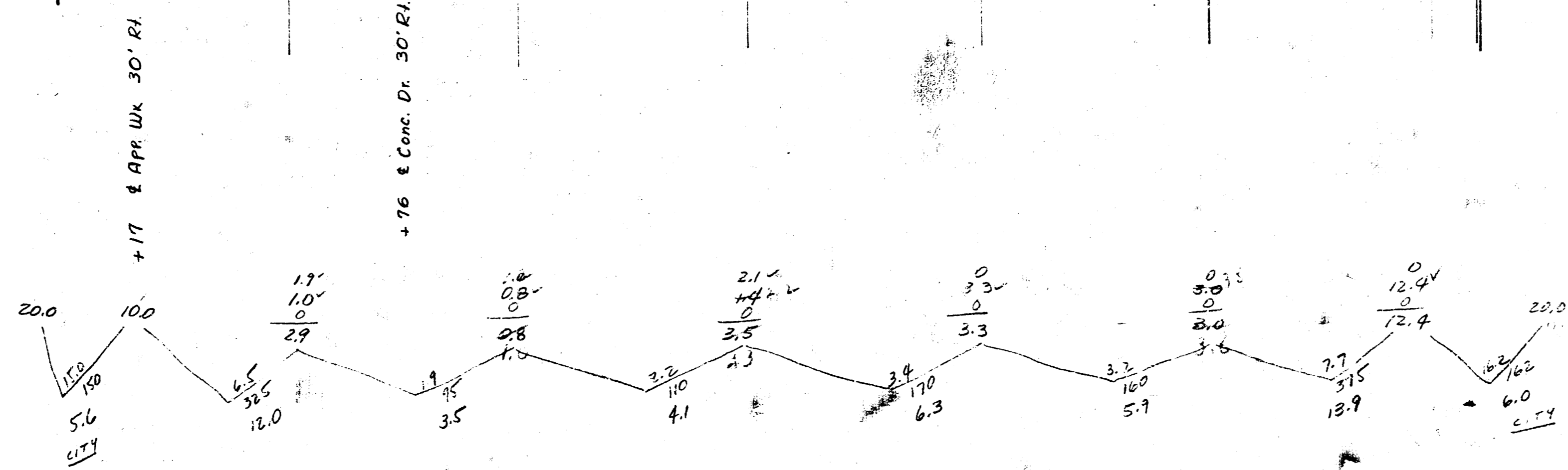
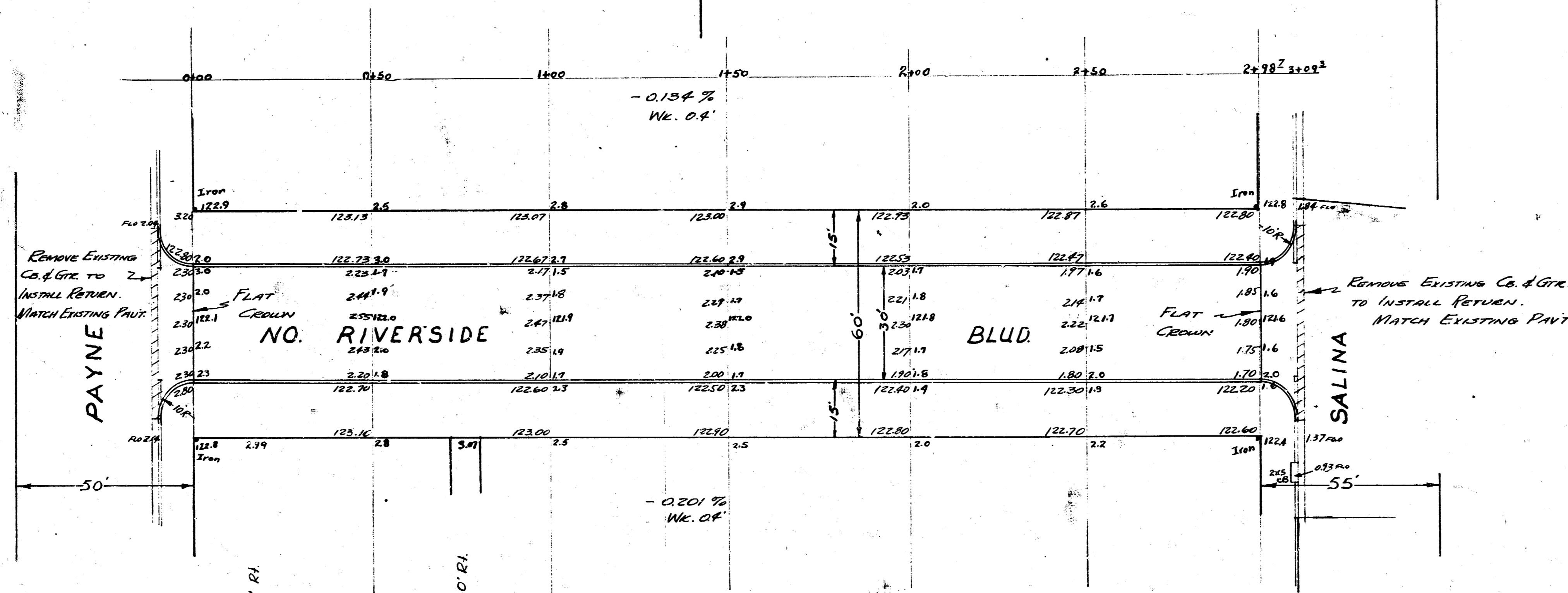

NO. RIVERSIDE BLUD
 W.L. Salina to EL Payne
 30" Conc. Cb.
 City of Wichita Kansas
 L.K. White City Engineer
 1951 - Proj. No. C11-119

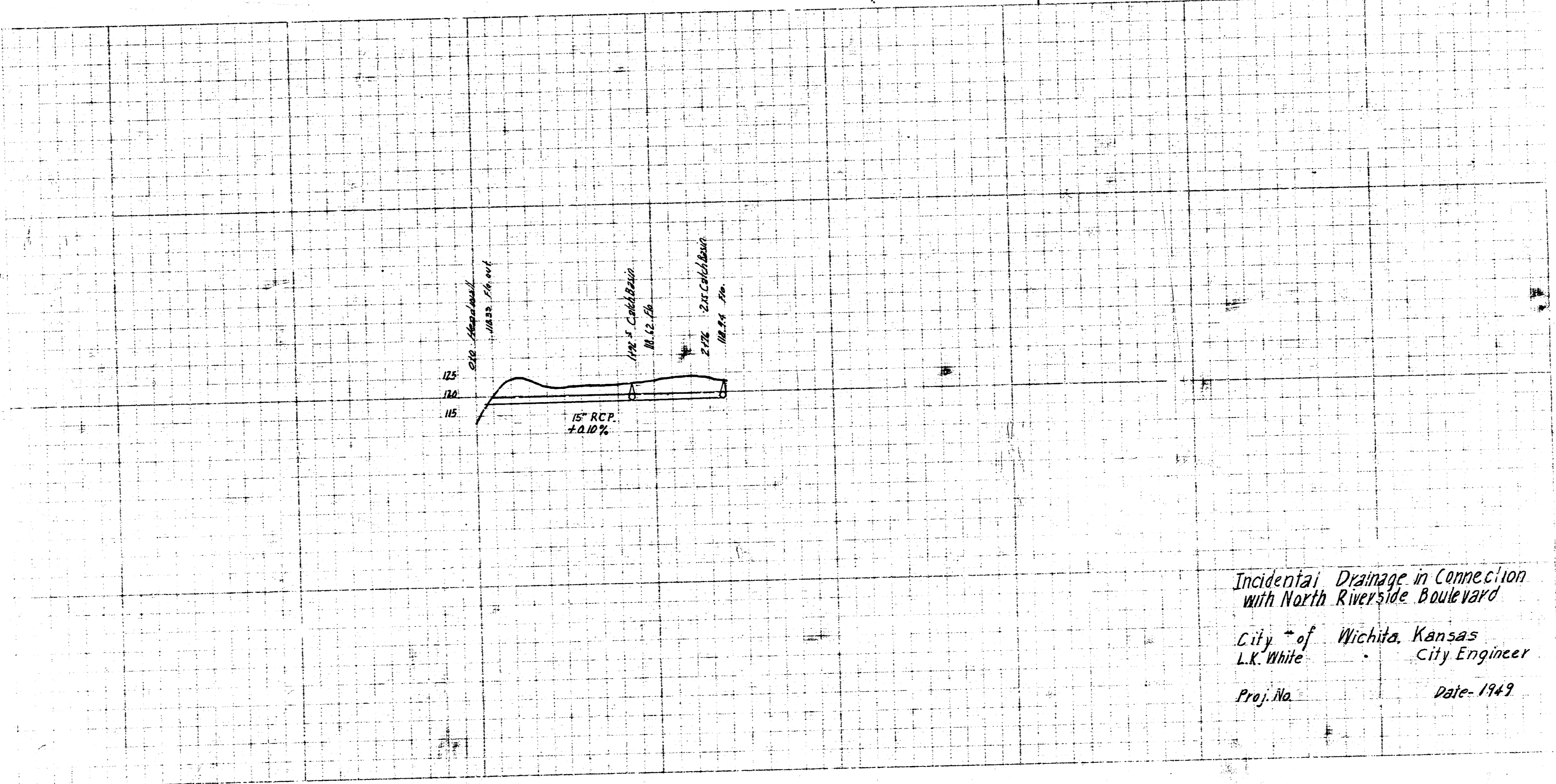
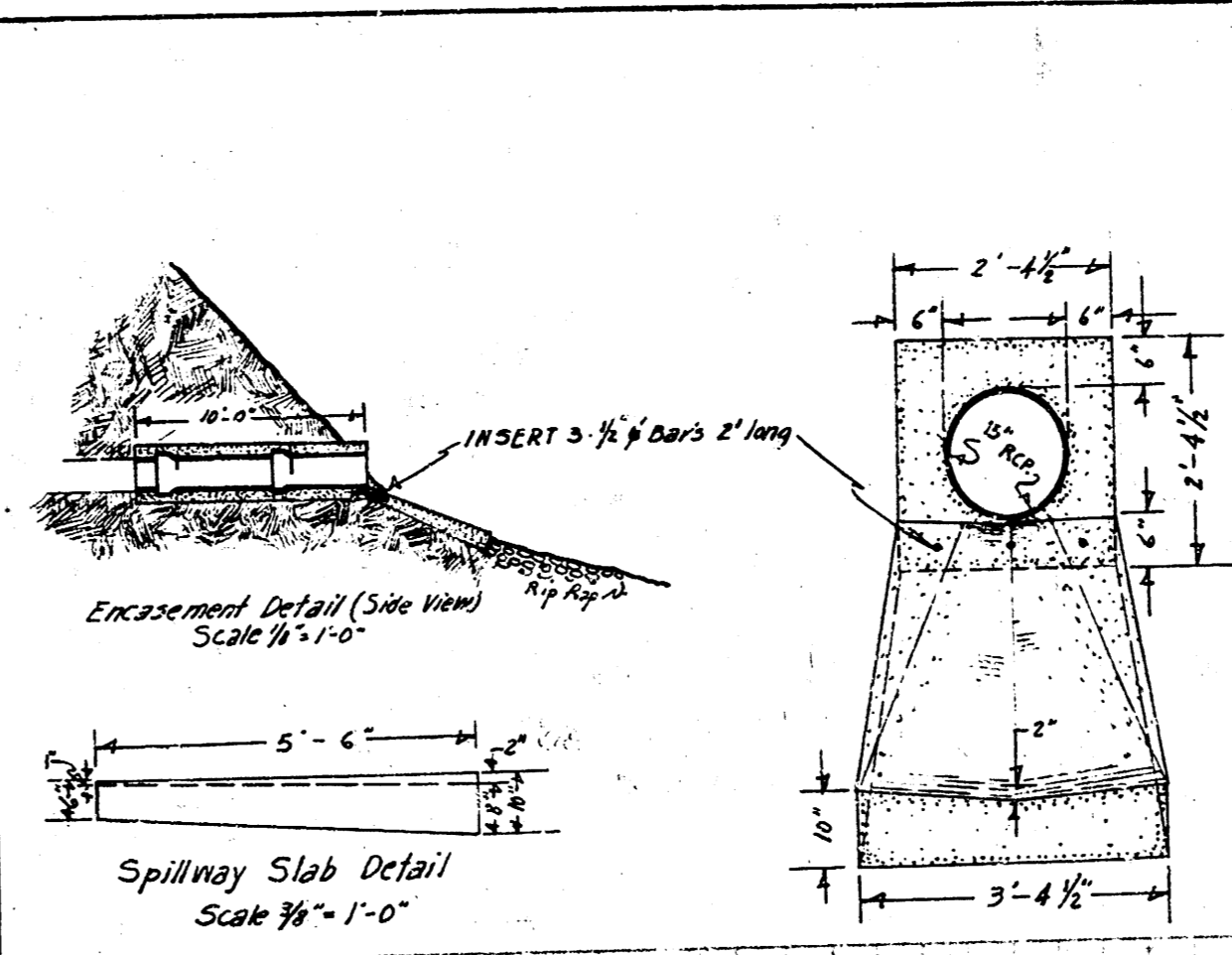
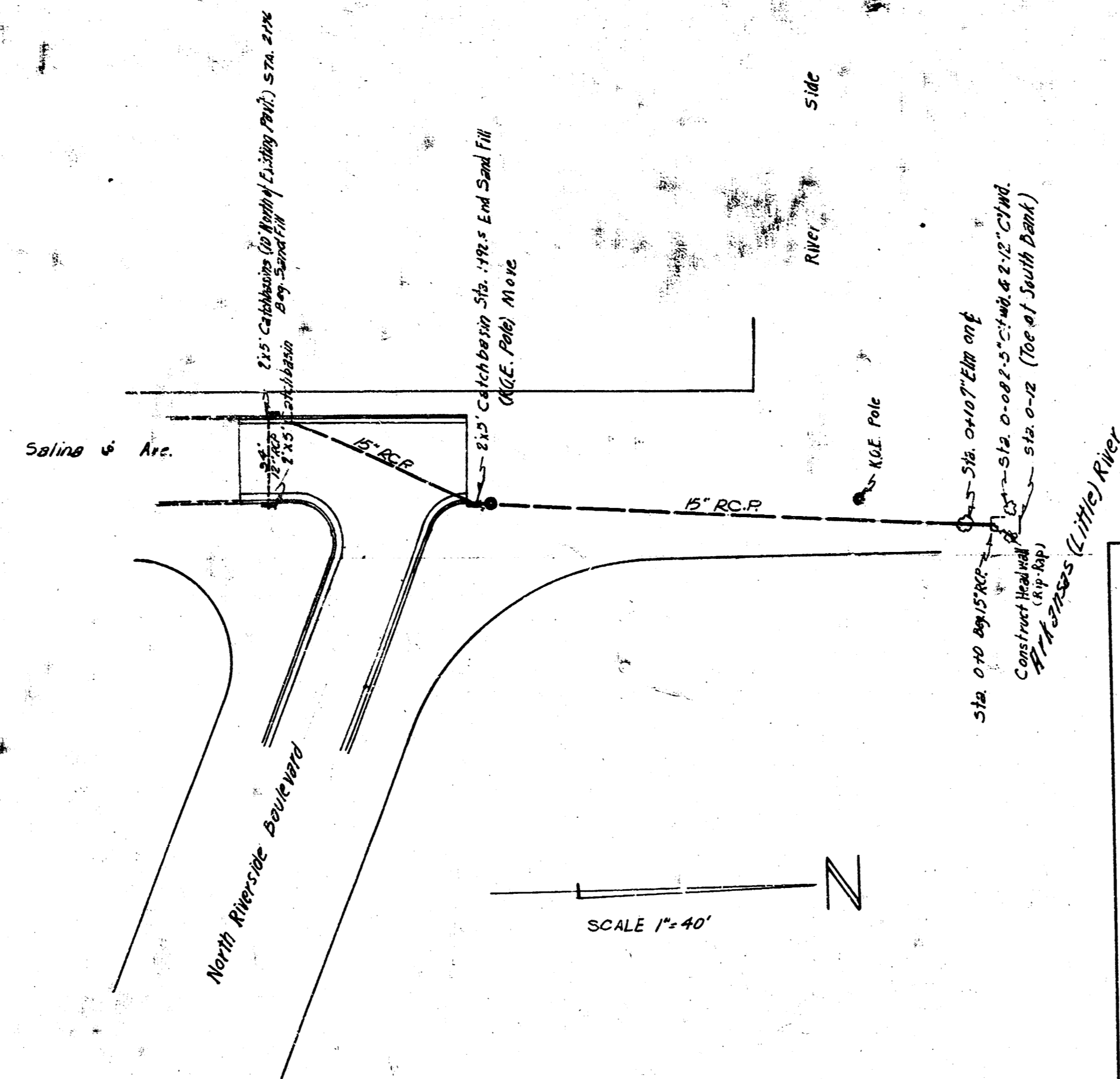

Incidental Drainage in Connection
with North Riverside Boulevard
City of Wichita, Kansas
L.K. White City Engineer
Proj. No. Date- 1949

B.M. 12265 6" in Globe Nend E. curb Burns, S.S. 20th
 B.M. 12471 R.R. spike in large Elm N.S. North Riverside Blvd. 75' E. of Salina

Stationing on Center line



$$\begin{array}{r} 206.1 \\ 194.5 \\ 172.1 \\ 110.0 \\ 74.3 \\ 27.9 \\ 46.1 \\ 11.2 \\ 0.4 \\ 4.1 \\ 23.0 \\ 15.9 \\ 3.1 \\ 12.7 \\ \hline 1041.8 \\ +1076 \\ \hline 1146.54.945 \end{array}$$

$$\begin{array}{r} 4.7 \\ 48.5 \\ 14.5 \\ 2.3 \\ \hline 59.7 \\ +1076 \\ \hline 1146.54.945 \end{array}$$

Curve Data

Station	Chord on Deflection	Radius	Chord of
on E. Side	South	on South	South
Station	Chord on Deflection	Radius	Chord of
on W. Side	North	on North	North
0+60 FT			
0+75			
1+00			
1+25			
1+56.2 P.C.			
2+33.3 P.T.			
2+50	163	29' 13"	17'
3+00	489	1' 56.52"	1000' 51"
3+50	489	3' 24.31"	51'
4+00 P.C.	489	4' 21"	31'

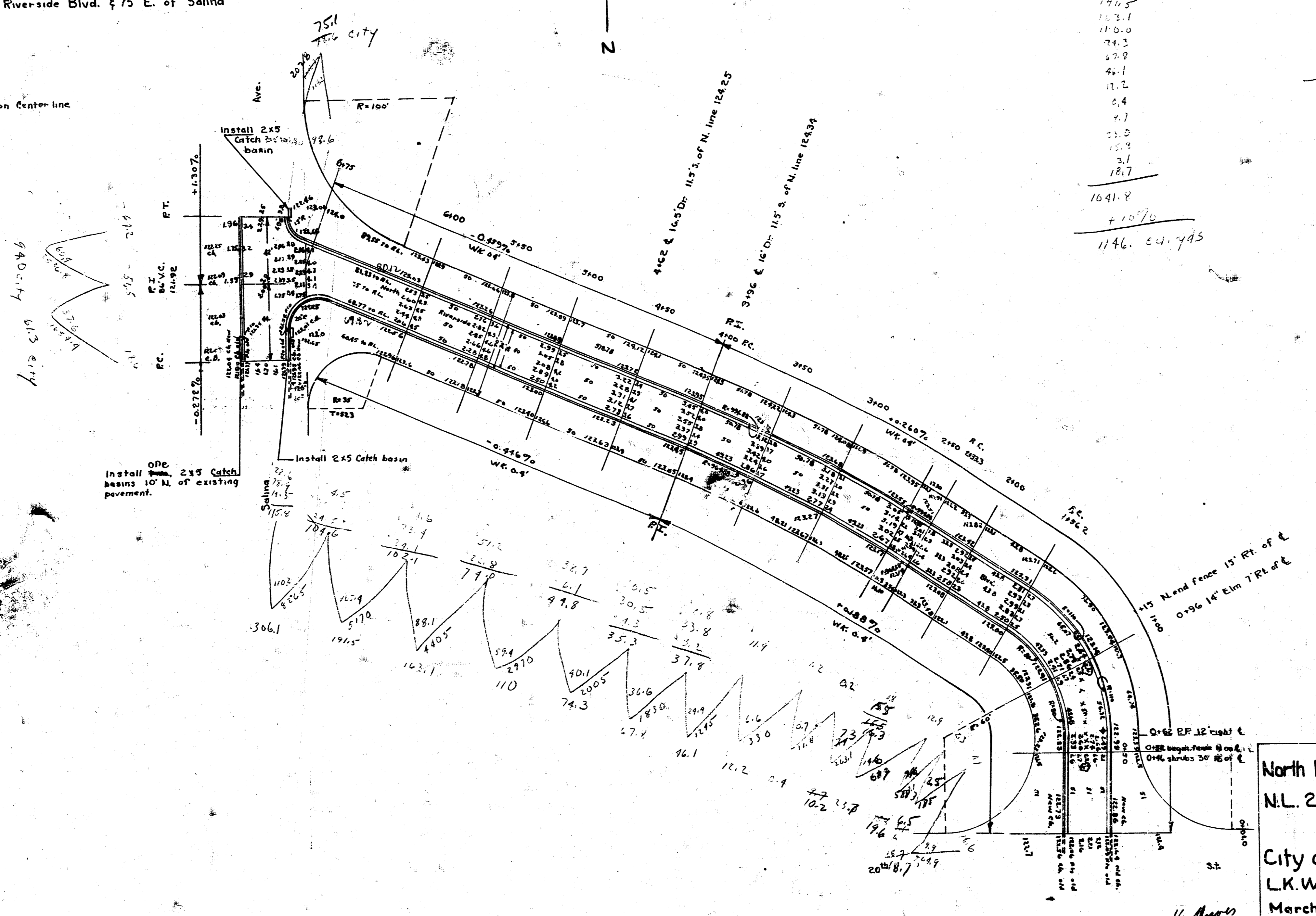

North Riverside Blvd.
 N.L. 20th - E.L. Salina
 26'-2'-30" A.C.
 City of Wichita, Kansas
 L.K. White City Engineer
 March 1949 Proj. C-19-32
 SCALE 1"=40'

4 12 2 12