

B.M. "R" IN RITCHIE TOP OF CURB N END RADIUS N.E. 26th & OAK 92.2'
 B.M. STEP BENCH E.S. MULBURY TREE N.W. CO. S.W. 25th APPROX & SYCAMORE SQ. 100.2'
 BASELINE = E OAK STREET GOING NORTH

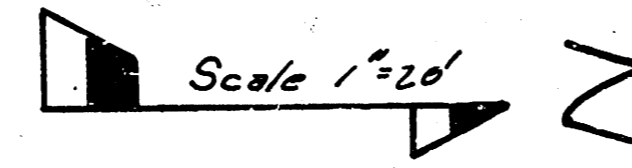

SOUTH

SOUTH

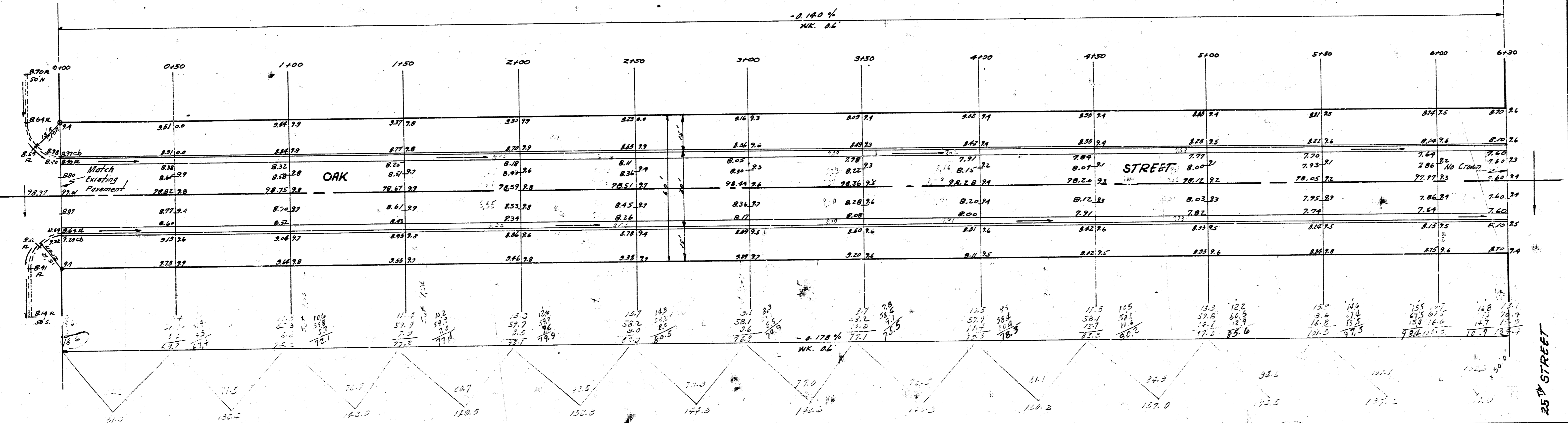

EXCAVATION		
CITY	PROP	1873.7
+ 10%	+ 10%	187.6
TOTAL	TOTAL	2061.3

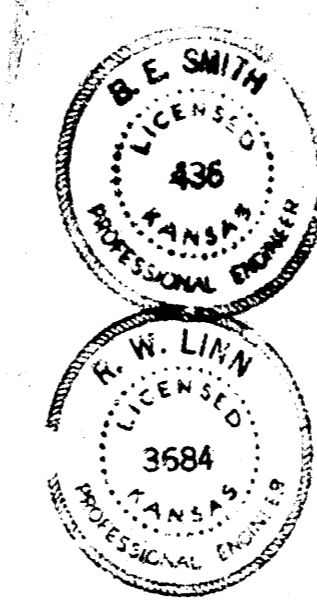

OAK STREET
 N.W. 26th St. S.W. - S.W. 25th St. S.W.
 26-2-30 A.C.
 CITY OF WICHITA, KANSAS
 B.E. SMITH CITY ENGINEER
 DATE JULY 1958 PROJ. NO. C15-94

11-1784
 11-1784
 11-1784

25th STREET

26th STREET