

SPEUCE
 NL INDUSTRIAL TO E. L. MADISON

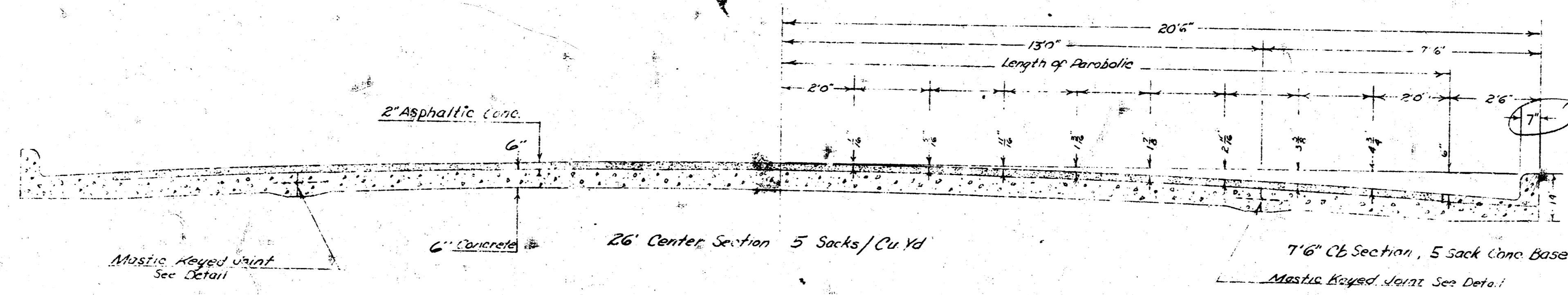

TYPICAL SECTION

Scale $\frac{1}{2}'' = 1'$

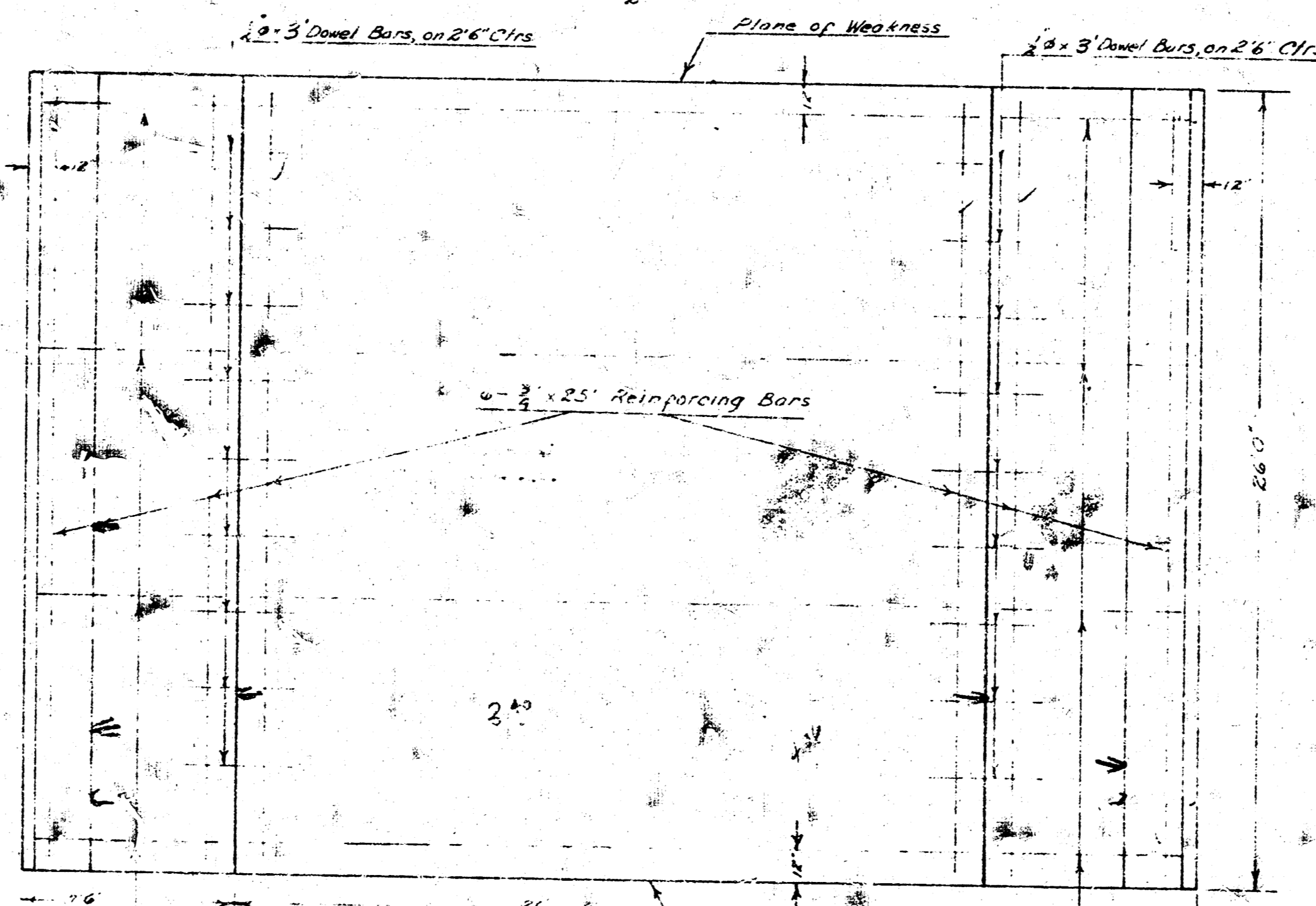
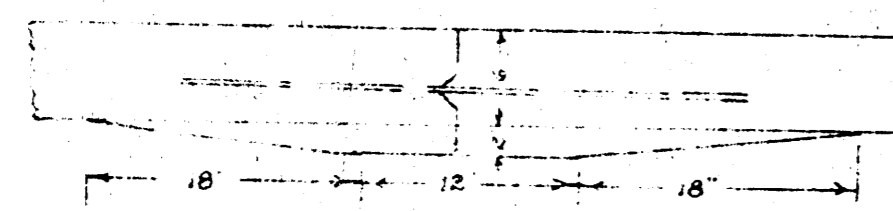

STEEL PATTERN

Scale $\frac{1}{4}'' = 1'$

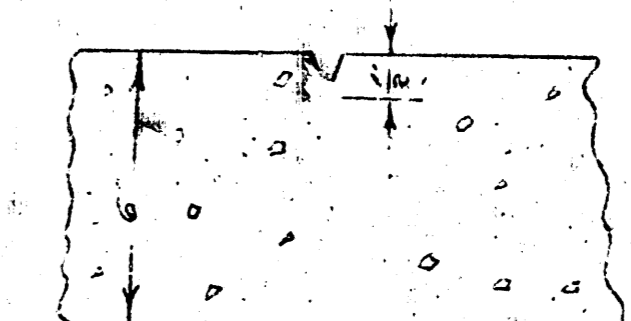

BM. 9507 60° SPRUCE W.S. RR/WY FENCE POST E WASSALL & W.S. AT C.S.F. R/WY

NOTE: STATIONING IS ON E

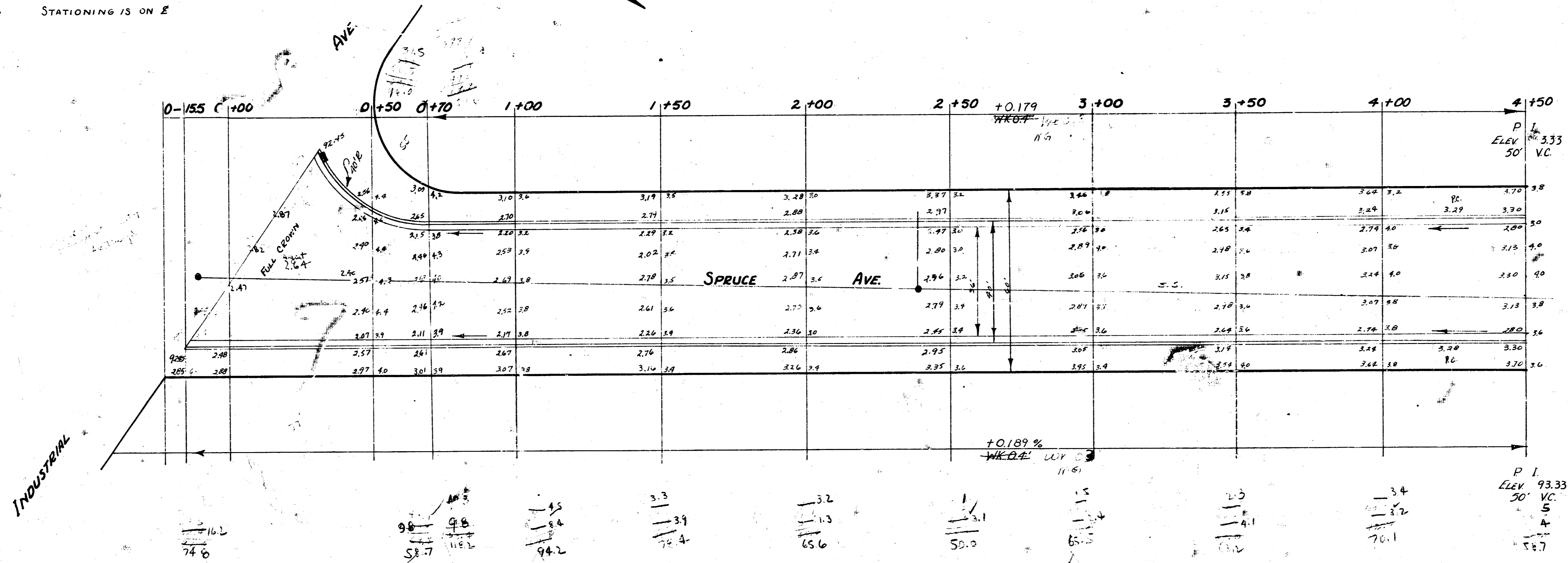

1
2

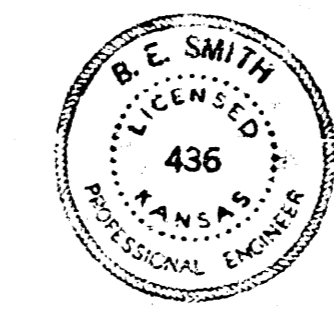

SPRUCE AVE.
N.L. INDUSTRIAL TO EL. MADISON
36'-2'-40 AC.
CITY OF WICHITA KANSAS
L.K. WHITE CITY ENGINEER
SEPT. 1952 PROJ. NO. C-12-119

