

B.M. 11876 7' in A.I. Co. 25 Center W. W. N.W. Cor. 2nd & Spruce
 B.M. 11822 7' in Gable W. End N.W. S.W. Cor. 1st & Spruce

PROP.
 30.8
 38.0
 15.7
 18.3
 43.1
 44.0
 43.3
 41.1
 40.0
 38.9
 37.4
 16.1
 12.0
 28.7
 49.8
 +12.0
 410.4 cu yds

City
 5.9
 6.1
 12.0
 +10%
 Total 13.2 cu yds.

NOTE TO FIELD ENGINEER: Check Fb. every 10' on W.S. SPRUCE & only remove & replace Cb. if necessary to insure drainage to North Sta. 0+50 to 5+80. New grades on plan.

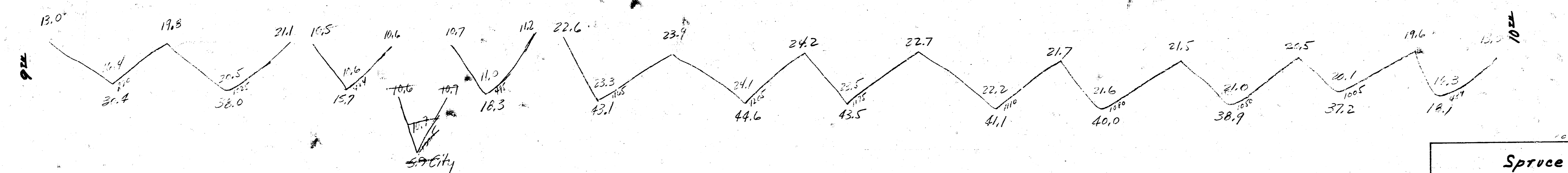
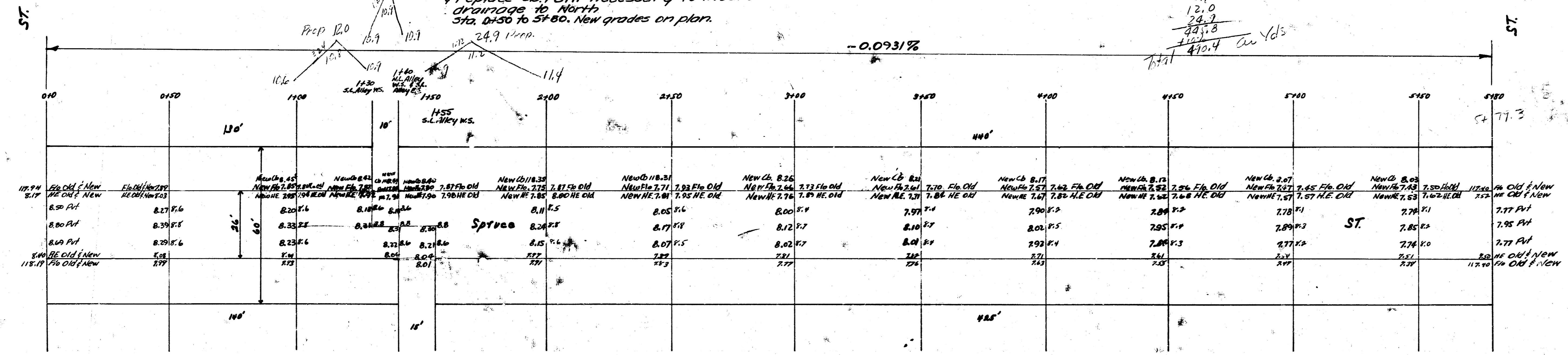

Spruce ST
 N.L. 9" — S.L. 10"
 24' Conc.
 City of Wichita, Kansas
 L.H. White City Engineer
 May 1948 Project 018-54

