

BM 9860 SE cor. conc. porch Ho. NW cor. R. of Spruce.

4.0
1.5
3.7
4.1
5.0
2.3
2.6
16.9

7.10% $\frac{369}{410.2}$

City 34.1
4.10% $\frac{3.3}{37.2}$

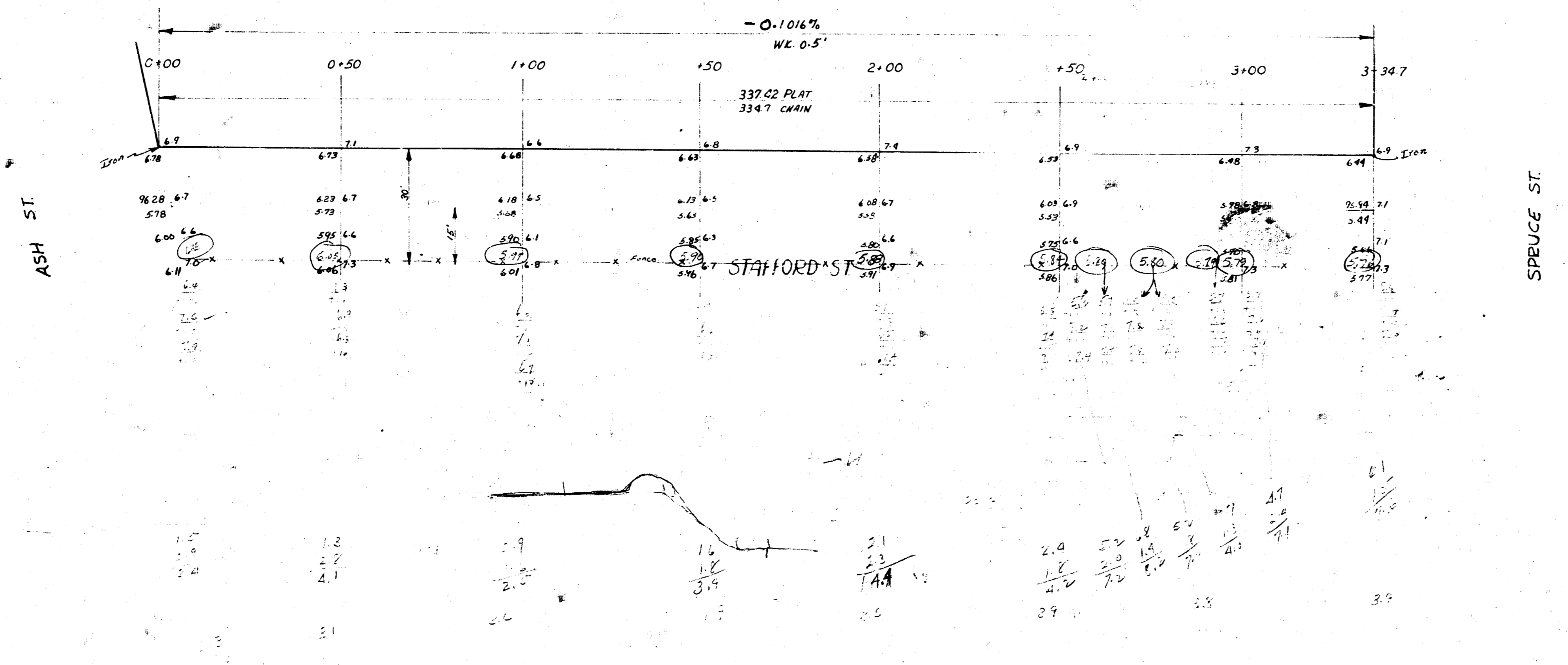

N 1/2 STAFFORD
EL ASH WL SPRUCE
15" CONC. & CB.
CITY OF WICHITA, KANS.
LK WHITE CITY ENGINEER
AUGUST, 1950 CIO-94