

B.M. 49.06 "10" IN MUELLER F.H.V.D. N.W. COR. STAFFORD & GROVE
 B.M. 79.32 "10" ON CONC. STEP No. 2220 S. GREEN
 B.M. 91.95 "10" ON CONC. STEP No. 2232 S. GREEN
 B.M. 100.13 "10" ON CONC. PAVEN. No. 2226 S. GREEN
 STA. 0' OFFSET FROM H.C.

STA. ON CURVE	NE. CORNER	CHORD	CHORD BEARING	CHORD DIST.	CHORD BEARING	TOTAL DEFL.
0+00	52.31'	50.0	58.92	10 01' 52"	37 02' 50"	50'
1+00	52.31'	50.0	58.92	8 00' 52"	4 01' 50"	50'
2+00	52.31'	50.0	58.92	5 59' 52"	1 59' 50"	50'
3+00	52.31'	50.0	58.92	4 00' 52"	0 01' 50"	50'
4+00	52.31'	50.0	58.92	2 01' 52"	14 02' 50"	50'
5+00	52.31'	50.0	58.92	0 02' 52"	28 03' 50"	50'
6+00	52.31'	50.0	58.92	11 59' 52"	42 04' 50"	50'
7+00	52.31'	50.0	58.92	13 58' 52"	56 05' 50"	50'
8+00	52.31'	50.0	58.92	15 57' 52"	70 06' 50"	50'
9+00	52.31'	50.0	58.92	17 56' 52"	84 07' 50"	50'
10+00	52.31'	50.0	58.92	19 55' 52"	98 08' 50"	50'

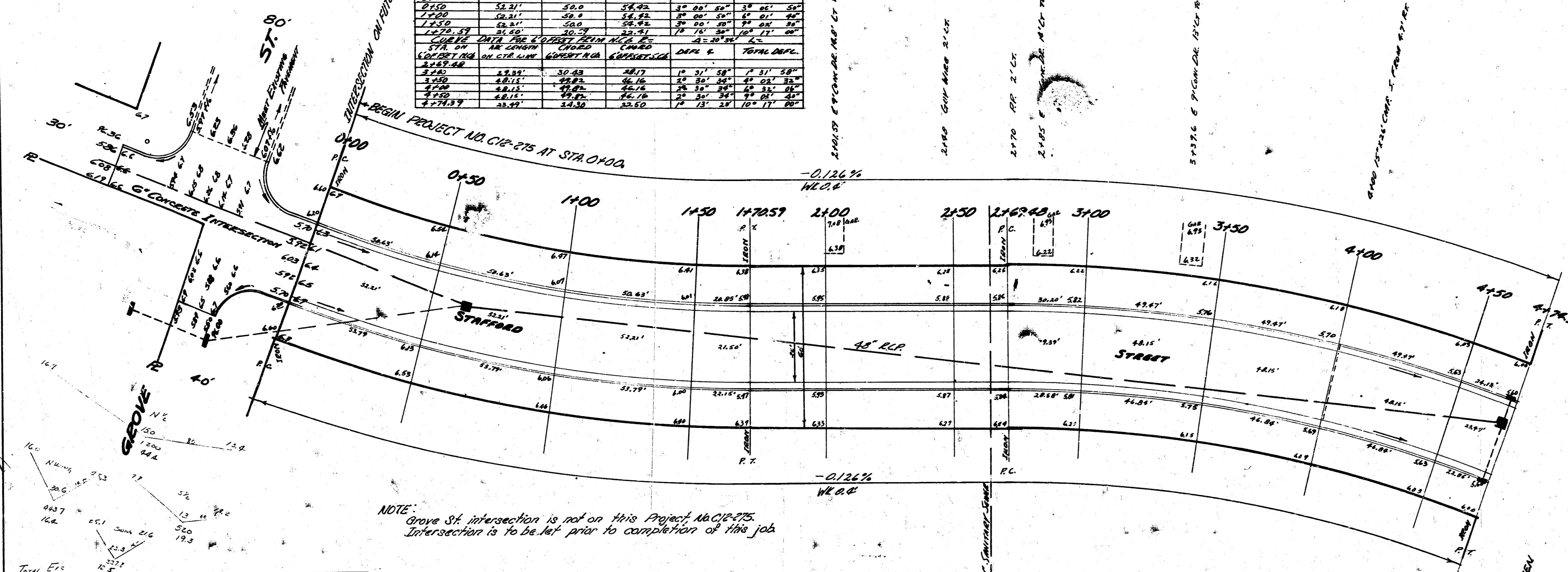

NOTE: Grove St. intersection is not on this Project No. C12-275.
 Intersection is to be let prior to completion of this job.

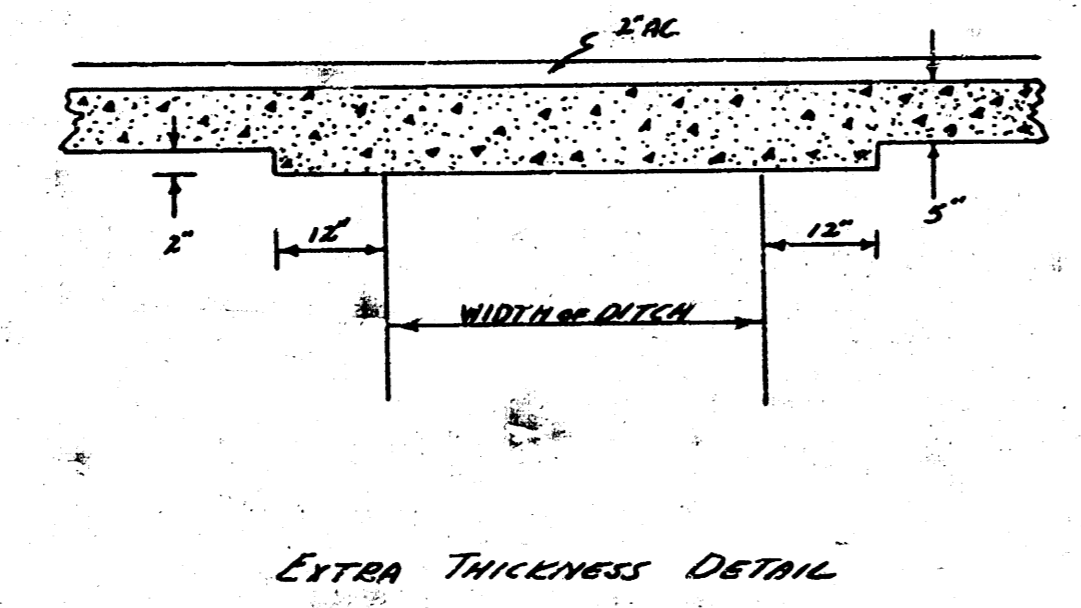
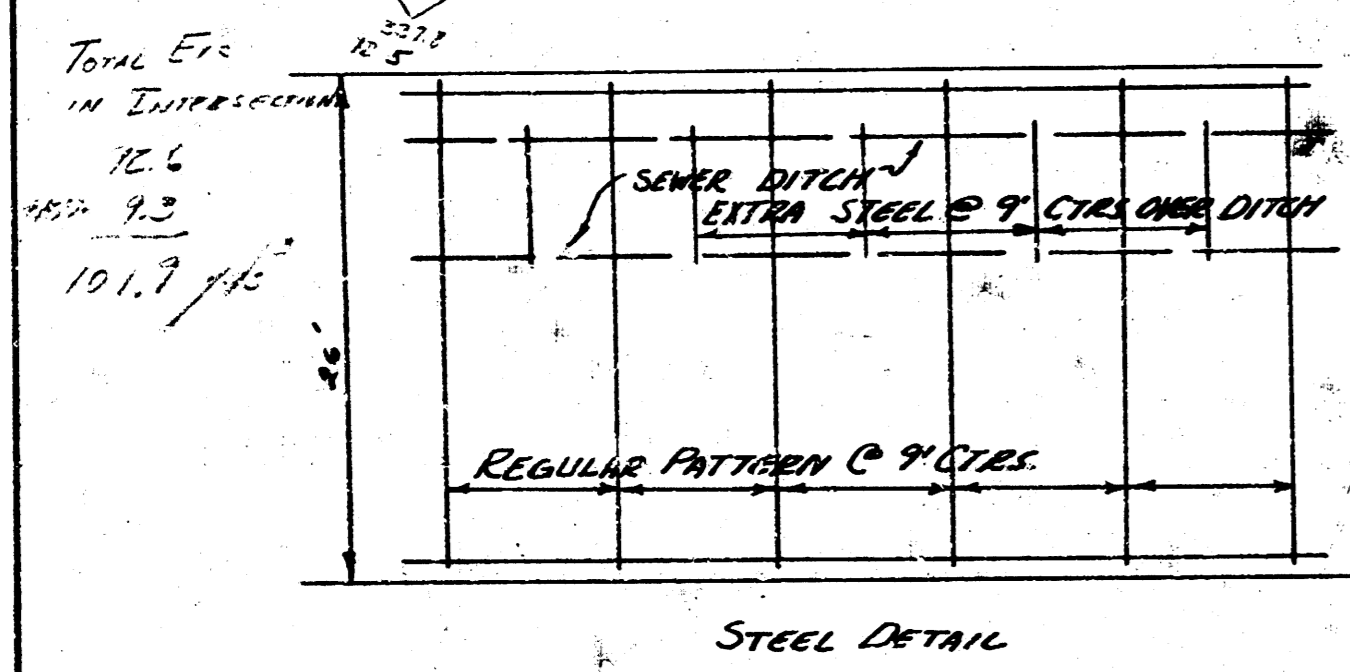

BE. SMITH
 CIVIL ENGINEER
 436
 WICHITA, KANSAS
 STAFFORD ST
 EL. GROVE TO EL. VOLUTIA
 26-2-30 AC.
 INTERSECTION OF STAFFORD & GROVE
 6\"/>

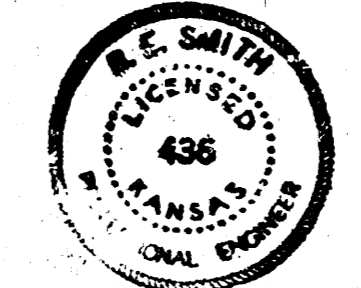

1"=20'

SURVEYED BY
 CHECKED BY

