

B.M. 104.68 "X" in base of post S.E. cor. Geo. Wash & Stumer
Station 1+00.00

Excavation
 P.11 247
 220.4
 220.4
 220.4
 220.4

Scale
 1" = 10'
 1/4" = 1'

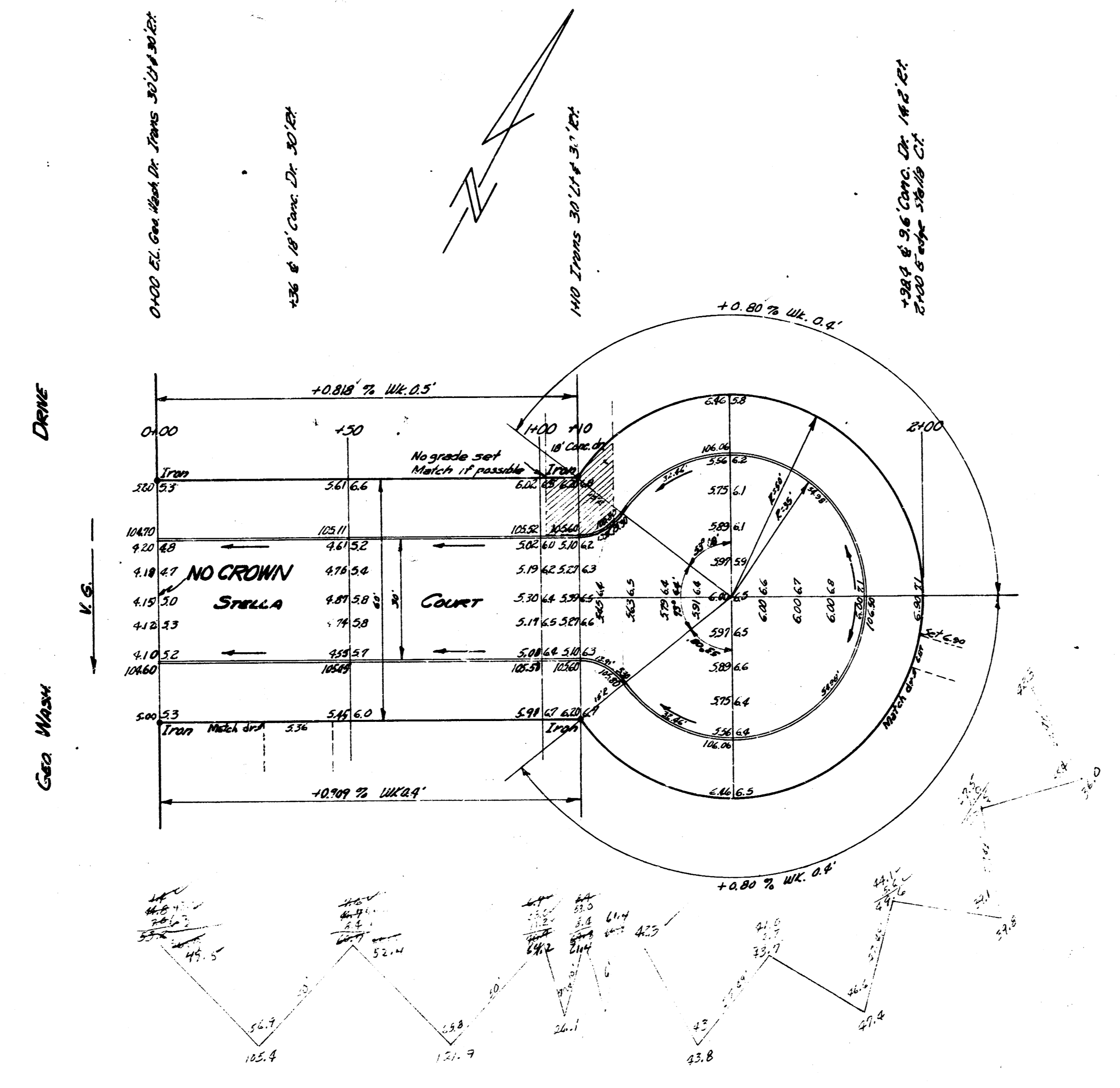

STELLA CT.
 30' CONC. & CB.
 CITY OF WICHITA KANSAS
 B.E. SMITH CITY ENGINEER
 SEPT 1935 PROJ. NO. C14-110

