

CITY OF WICHITA, KANSAS
 MICHAEL E. LINDEBAK, P.E., CITY ENGINEER
STREET IMPROVEMENTS
 FOR
STONEGATE ESTATES

SHEET NO.	TOTAL SHEETS
1	13

CITY OF WICHITA PROJECT NO. 472-76-245-80001-000-000-039

INDEX OF SHEETS

1. TITLE SHEET
2. PLAN
3. TYPICAL 37" PAVEMENT DETAILS
4. TYPICAL 35" PAVEMENT DETAILS
5. TYPICAL 29" PAVEMENT DETAILS
6. VALLEYVIEW PAVING PLAN
- 7.-10. JENSEN 118TH ST. PAVING PLANS
- 11.-12. 18TH ST. COURT PAVING PLANS
13. STANDARD ENTRANCE DRIVES

PROJECT SURVEY CONTROL

- PROJECT DATUM - CITY OF WICHITA DATUM
- DATUM BENCH MARK - CITY OF WICHITA DISC., 39.3' SOUTH AND 56.0' EAST OF INTERSECTION OF CENTERLINE MAIZE ROAD AND CENTERLINE 13TH STREET NORTH. ELEV. = 159.318
- BENCH MARK - STANDARD DISC ON NORTHEAST CORNER RCBC, 82' WEST AND 35' NORTH OF THE SOUTHEAST CORNER OF THE NORTHWEST 1/4 OF SECTION 8, T27S, R1W. ELEV. = 156.84
- BENCH MARK - CHISELED "X" ON TOP OF CURB OF NORTH RETURN AT THE SOUTHEAST CORNER VALLEYVIEW AND 17TH STREET NORTH. ELEV. = 156.19
- BENCH MARK - CITY STANDARD DISC, 11' SOUTH AND 43' EAST OF THE SOUTHWEST CORNER OF THE NORTHWEST 1/4 OF SECTION 8, T27S, R1W. ELEV. = 161.04
- BENCH MARK - CHISELED "X" IN SOUTHWEST CORNER OF DRAIN INLET APPROXIMATELY 500' NORTH OF RCBC AT THE SOUTHEAST CORNER OF THE NORTHWEST 1/4 OF SECTION 8, T27S, R1W. ELEV. = 152.33
- BENCH MARK - 1/2" X 4" - 0" REBAR 5' EAST AND 10' SOUTH OF THE NORTHEAST CORNER OF LOT 33, BLOCK 4, STONEGATE ESTATES. ELEV. = 156.93
- BENCH MARK - 1/2" X 4" - 0" REBAR 70' AND 5' WEST OF THE SOUTHWEST CORNER OF LOT 35, BLOCK 6, STONEGATE ESTATES. ELEV. = 156.71
- BENCH MARK - 1/2" X 4" - 0" REBAR 10' EAST AND 10' SOUTH OF THE NORTHEAST CORNER OF LOT 24, BLOCK 4, STONEGATE ESTATES. ELEV. = 154.36
- BENCH MARK - 1/2" X 4" - 0" REBAR 60' NORTH AND 5' EAST OF THE NORTHWEST CORNER OF LOT 13, BLOCK 5, STONEGATE ESTATES. ELEV. = 155.05

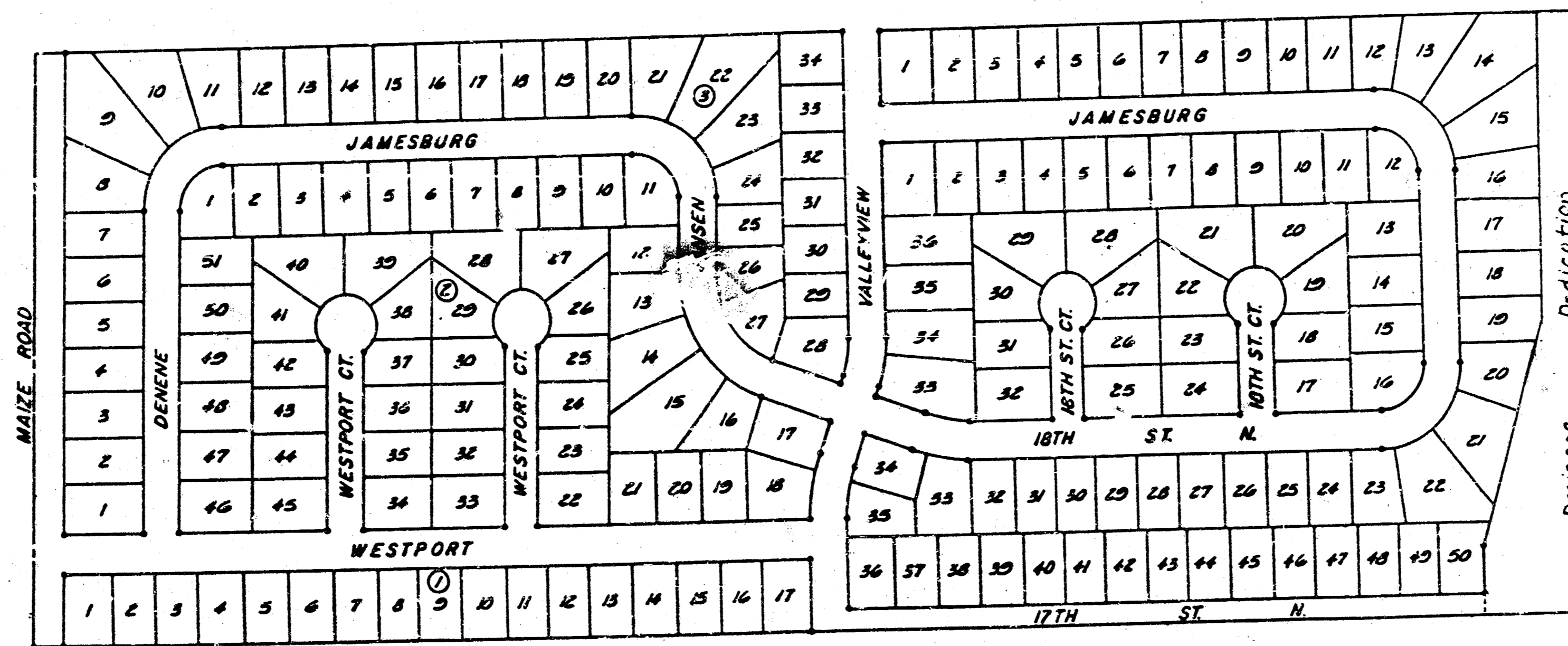

NOTE TO CONTRACTOR

This project will be constructed under the supervision of the CITY ENGINEER and conforming to the SPECIFICATIONS of the CITY OF WICHITA. The CONTRACTOR will pay the City of Wichita for all costs of plan review, inspection and booking per contract.

APPROVED AS NOTED
 By CITY ENGINEER OF WICHITA

- Sanitary Sewers _____
 - Storm Sewers _____
 - Driveway Approaches _____
 - Water Mains _____
- V.R.H. 3/3/88

FEBRUARY, 1983

PLANS PREPARED BY
PROFESSIONAL ENGINEERING CONSULTANTS, P.A.
 ENGINEERS
 WICHITA, KANSAS

AS BUILT AUG., 1988

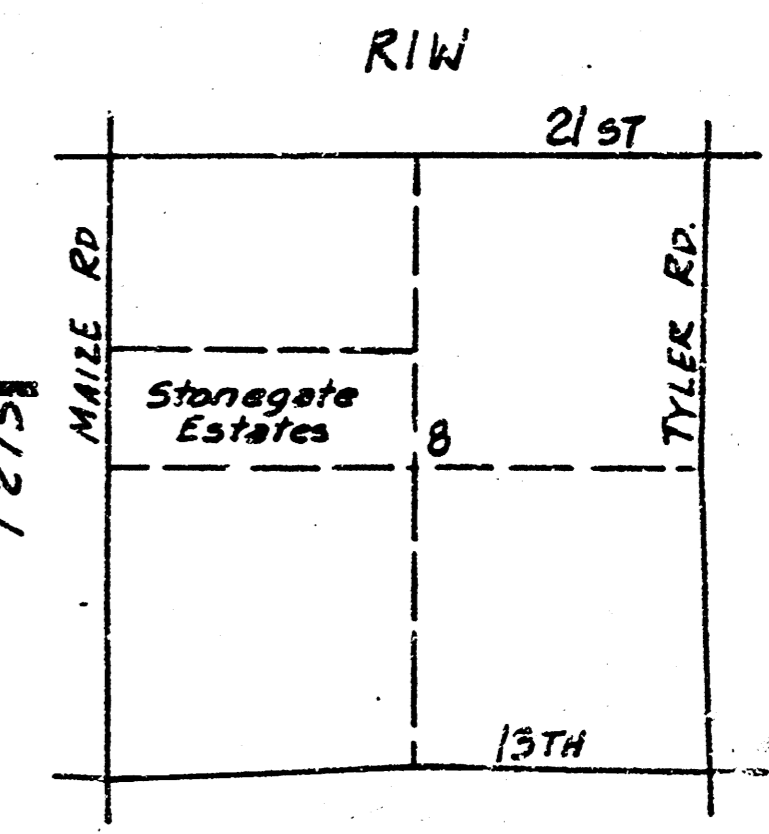
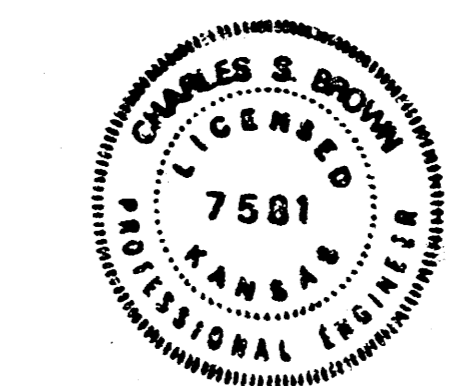

VICINITY MAP

GENERAL NOTES

- UTILITY SERVICE LINES, POLES, VALVE BOXES, METERS, AND ETCETERA ARE TO BE ADJUSTED AS NECESSARY BY OTHERS PRIOR TO OPENING CONSTRUCTION UNLESS THE PLANS SPECIFICALLY CALL FOR THEIR ADJUSTMENT BY THE CONTRACTOR. EXISTING UTILITIES AND THEIR LOCATION, AS SHOWN ON THE PLANS, REPRESENT THE BEST INFORMATION OBTAINABLE FOR DESIGN. LOCATION INFORMATION HAS BEEN OBTAINED FROM THE VARIOUS UTILITY COMPANIES AND IS EITHER FROM COMPANY RECORD DRAWINGS OR COMPANY PROVIDED FIELD LOCATIONS. THE PLAN LOCATIONS SHOWN ARE NOT GUARANTEED. ADDITIONAL EXISTING UTILITIES MAY ALSO BE ENCOUNTERED. THE CONTRACTOR WILL BE REQUIRED TO WORK AROUND EXISTING UTILITIES WITHIN THE RIGHT-OF-WAY WHICH DO NOT CONFLICT WITH PROPOSED CONSTRUCTION.
- CONTRACTOR SHALL SATISFY HIMSELF OF SUB-SURFACE CONDITIONS PRIOR TO CONSTRUCTION.
- TREES AND SHRUBS IN PUBLIC RIGHT-OF-WAY WHICH ARE IN DIRECT CONFLICT WITH PROPOSED NEW CONSTRUCTION SHALL BE REMOVED BY THE CONTRACTOR WITH THE ENGINEER'S APPROVAL. TREES AND SHRUBS WHICH ARE NOT IN DIRECT CONFLICT WITH PROPOSED NEW CONSTRUCTION SHALL BE SAVED AND PROTECTED FROM DAMAGE.
- THE CONTRACTOR SHALL SEED, FERTILIZE, AND MULCH ALL DISTURBED AREAS WITHIN THE DRAINAGE DEDICATION AND THE DRAINAGE EASEMENT LOCATED BETWEEN LOTS 20 AND 21, BLOCK 4.
- ALL MATERIALS AND CONSTRUCTION METHODS SHALL BE IN ACCORDANCE WITH CITY OF WICHITA STANDARD SPECIFICATIONS, LATEST EDITION, UNLESS OTHERWISE NOTED ON THE PLANS.
- ALL BARRICADES, SIGNS, LIGHTS AND OTHER PROTECTIVE DEVICES SHALL BE INSTALLED AND MAINTAINED IN CONFORMITY WITH THE LATEST EDITION OF THE CITY OF WICHITA BARRICADE MANUAL AS ADOPTED BY THE TRAFFIC ENGINEERING DIVISION OF THE DEPARTMENT OF OPERATIONS AND MAINTENANCE.
- THE CONTRACTOR SHALL SATISFY HIMSELF OF ALL QUANTITIES REQUIRED TO CONSTRUCT THE IMPROVEMENTS IN ACCORDANCE WITH THE INTENT OF THE PLANS AND SPECIFICATIONS. THE CONTRACTOR SHALL SUBMIT A "LUMP SUM" BID TO MR. RANDALL VOTH, 1831 WOODROW AVE., WICHITA, KS. 67203, SAID LUMP SUM SHALL BE FULL COMPENSATION FOR ALL MATERIALS, LABOR, TOOLS, EQUIPMENT, AND INCIDENTALS TO COMPLETE THE WORK.
- A SAW CUT OF AT LEAST ONE-HALF THE DEPTH OF EXISTING SURFACE COURSES OR ONE-FOURTH THE DEPTH OF THE EXISTING TOTAL PAVEMENT THICKNESS SHALL BE PROVIDED AT LOCATIONS WHERE PROPOSED CONSTRUCTION ABUTS AN EXISTING SURFACE COURSE OR PAVEMENT FOR WHICH PARTIAL REMOVAL OF THAT SURFACE OR PAVEMENT IS REQUIRED. SAWED JOINT TO FACILITATE REMOVAL WITHIN THREE (3) FEET OF EXISTING JOINTS WILL NOT BE PERMITTED AND FOR SUCH INSTANCES THE LIMITS OF REMOVAL SHALL EXTEND TO THE EXISTING JOINT. SUCH SAW CUTS WILL NOT BE PAID FOR DIRECTLY AND THIS COST SHALL BE CONSIDERED SUBSIDIARY TO REMOVAL OF THE SURFACE OR PAVEMENT.
- THIS PROJECT INCLUDES A CERTAIN AMOUNT OF ROLL TYPE CURB CONSTRUCTION. ROLL CURBS SHALL BE DEPRESSED THROUGH ALL DRIVEWAY OPENINGS WHEN SUCH DRIVES ARE CONSTRUCTED AS A PART OF THE PROJECT.
- LIMITS OF EARTHWORK SHALL MATCH EXISTING GROUND ELEVATIONS AT THE RIGHT-OF-WAY LINE UNLESS OTHERWISE NOTED ON THE PLANS WITH A NEW FINISHED GRADE ELEVATION. WHEN A NEW FINISHED GRADE ELEVATION IS SHOWN, THE EARTHWORK SHALL EXTEND ONE FOOT BEYOND THE RIGHT-OF-WAY LINE AND THEN SLOPED UP OR DOWN USING PERMISSIBLE SLOPES TO MATCH THE EXISTING GROUND SURFACE.

FILMED FROM THE BEST AVAILABLE COPY

STONEGATE ESTATES

WICHITA, SEDGWICK COUNTY, KANSAS

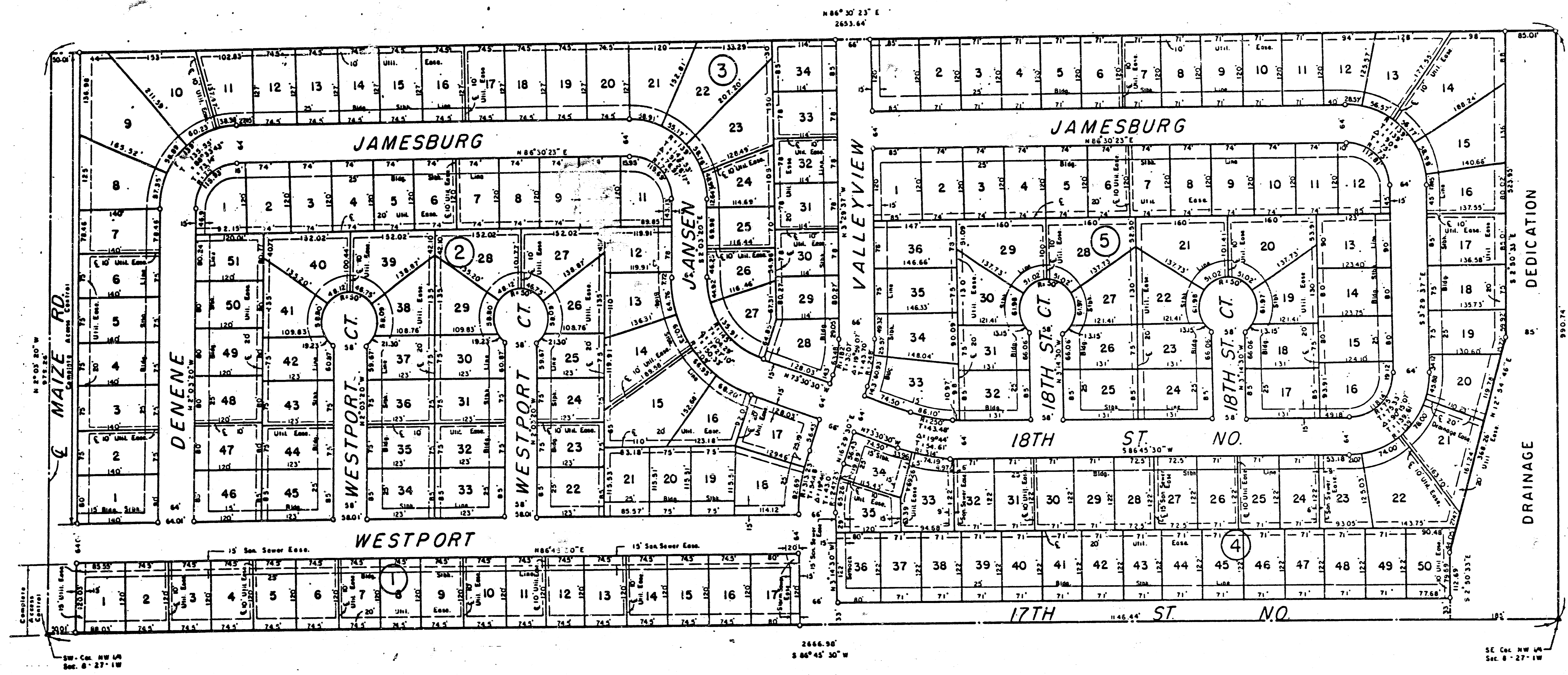
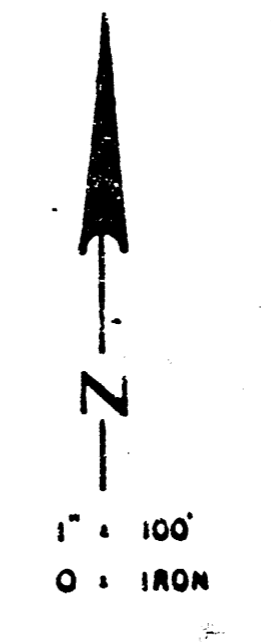

CHART OF MINIMUM PAD ELEVATIONS
CITY OF WICHITA

BLOCK	LOT	MEAN SEA LEVEL DATUM	CITY OF WICHITA DATUM
4	14	1342.0	154.8
4	15	1341.9	154.5
4	16	1341.8	153.4
4	17	1341.7	154.3
4	18	1341.6	154.2
4	19	1341.6	154.2
4	20	1341.5	154.1
4	21	1341.4	154.0
4	22	1341.3	153.9
4	50	1341.2	153.8



FILMED FROM THE BEST AVAILABLE COPY.....

PROJECT NO.	SHEET NO.	TOTAL SHEETS
472-76-145-60001-000-000-039	6	13

CAUTION!
Buried Cables
Contact K&E
SW Bell
Cablevision

Scale: 1"=20'

Curve Data (Arc)
Δ=19°59'07"
D=26°38'57"
R=215.00'
T=37.98'
L=74.93'

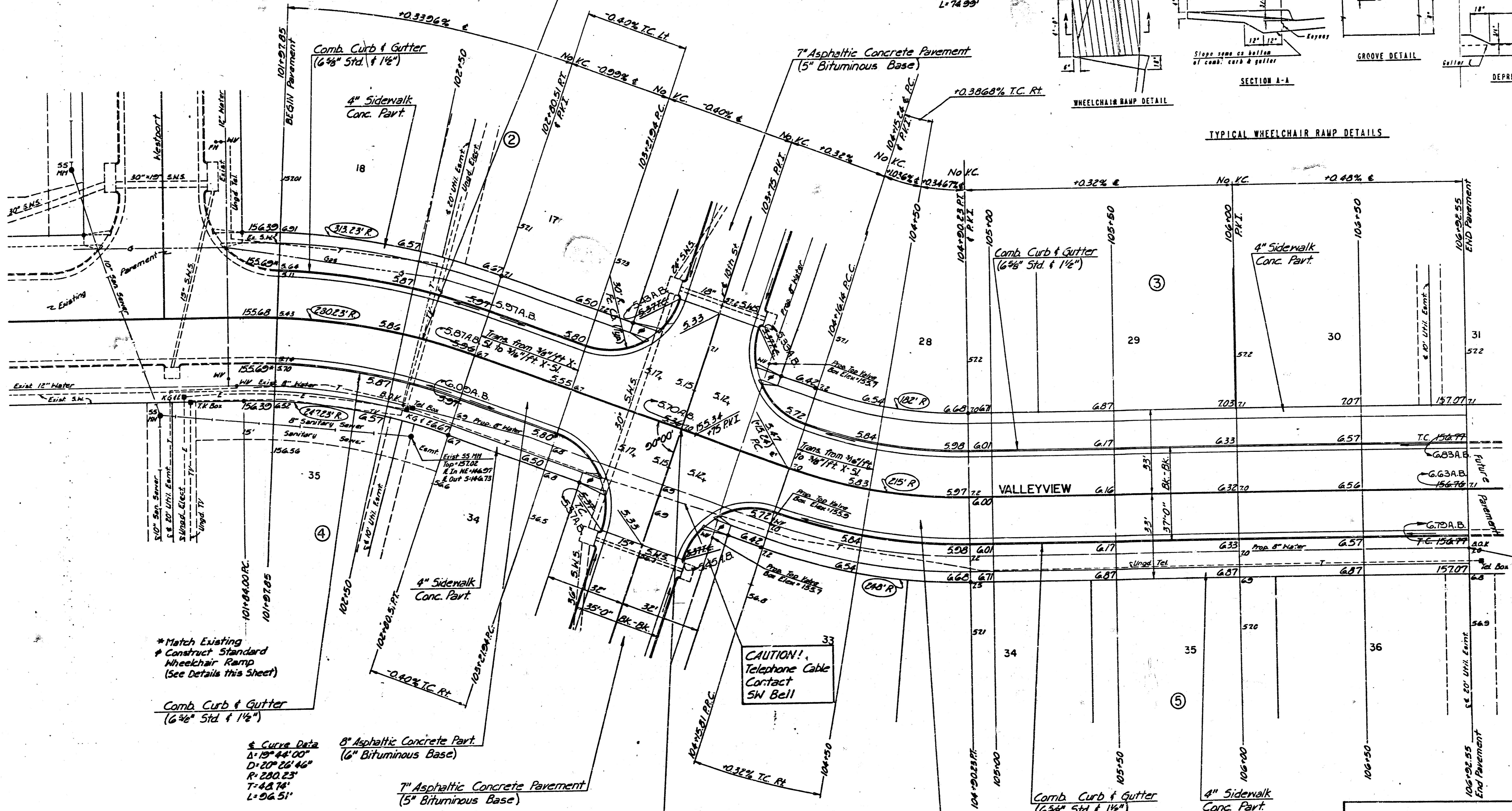
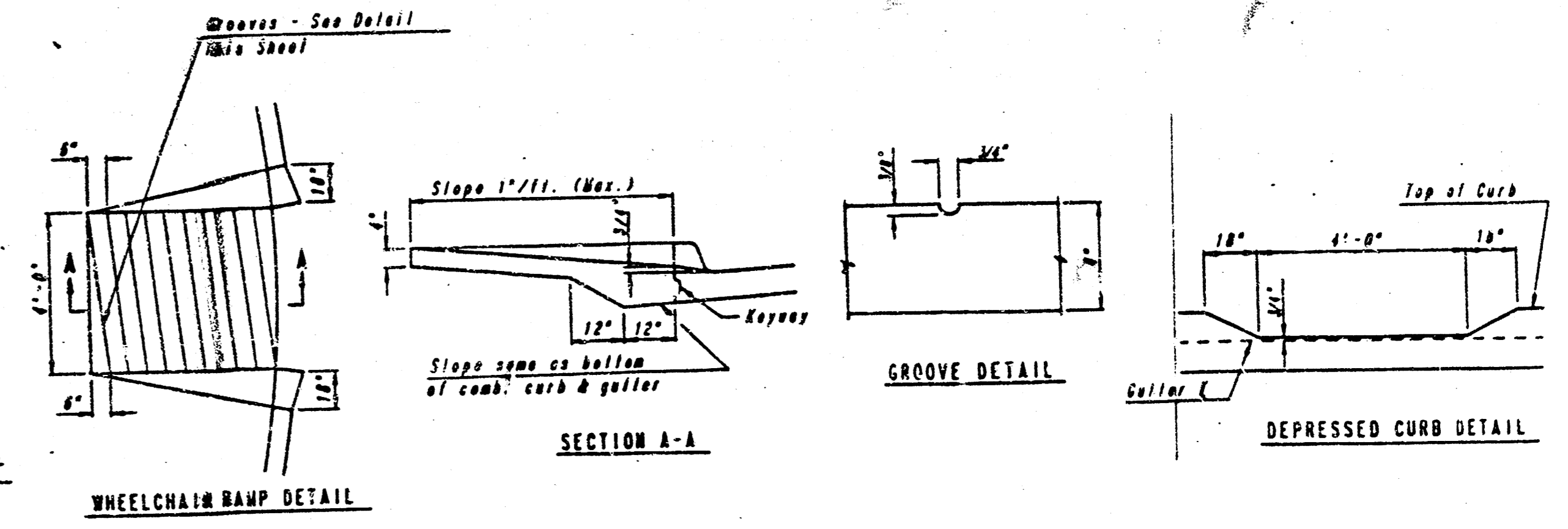

* Match Existing
* Construct Standard
Wheelchair Ramp
(See Details this Sheet)

Comb Curb & Gutter
(6 3/8" Std. & 1 1/2")

Curve Data
Δ=19°44'00"
D=20°26'46"
R=280.23'
T=48.74'
L=96.51'

8" Asphaltic Concrete Part.
(6" Bituminous Base)

7" Asphaltic Concrete Pavement
(5" Bituminous Base)

CAUTION!
Telephone Cable
Contact SW Bell

Sta. 103+60.34 & Valleyview =
Sta. 41+02.32 & 18th St.

8" Asphaltic Concrete Pavement
(6" Bituminous Base)

Note: See spot elevations for
proposed walk grades.

AS BUILT, AUG., 1988
VALLEYVIEW
STA. 101+97.85 TO STA. 106+92.55

PROFESSIONAL ENGINEERING CONSULTANTS, P.A.
ENGINEERS
WICHITA, KANSAS

Designed by CSB GDD
Checked by BS
Drawn by BS
Date Feb., 1988
Job No. 87599-7

FILMED FROM THE BEST
AVAILABLE COPY.....

PROJECT NO.	SHEET NO.	TOTAL SHEETS
472-76-245-80001-000-000-030	7	13

CAUTION!
Underground Electric
Contact K&E

Scale: 1"=20'

Curve Data (Arc)
 $\Delta = 71^\circ 27' 10''$
 $D = 32^\circ 22' 14''$
 $R = 172.00'$
 $T = 127.51'$
 $L = 220.73'$

Sta. 41+00.52 @ 18th St.
Sta. 103+68.94 @ Valleyview

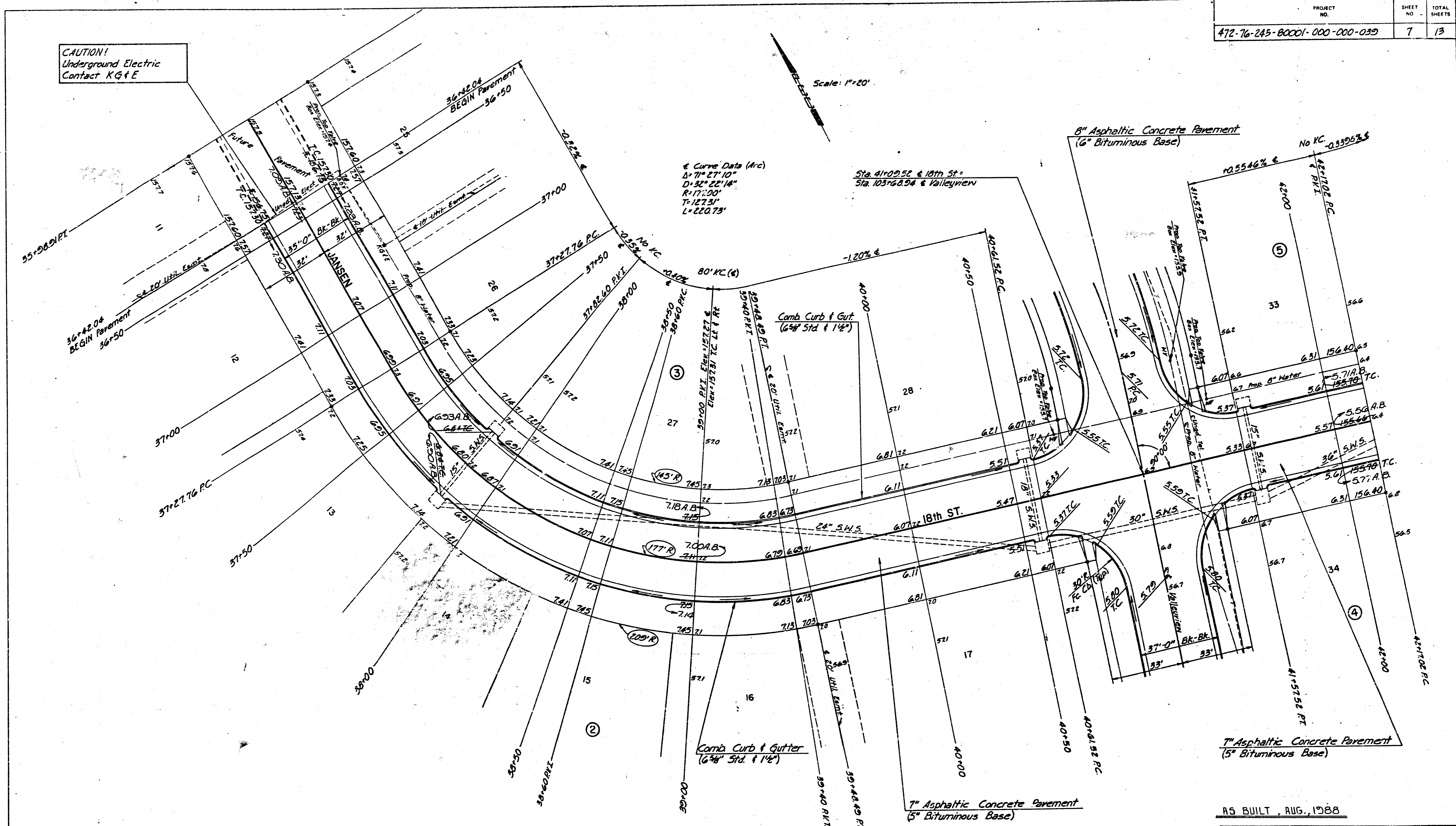

AS BUILT, AUG., 1988

JANSEN / 18th ST. !!
STA. 36+42.04 TO STA. 42+17.02

PROFESSIONAL ENGINEERING CONSULTANTS, P.A.		
ENGINEERS WICHITA, KANSAS		
Designed by	Checked by	Date
CSB-GDD	BS	Feb. 1988
Drawn by	Job No.	
BS	87592-1	

FILMED FROM THE BEST
AVAILABLE COPY.....

PROJECT NO.	SHEET NO.	TOTAL SHEETS
472-76-245-80001-000-000-039	9	13

Scale: 1"=20'

Curve Data (A.C.)
 $\Delta = 10^\circ 44' 00''$
 $D = 20^\circ 10' 04''$
 $R = 282.00'$
 $T = 49.05'$
 $L = 97.12'$

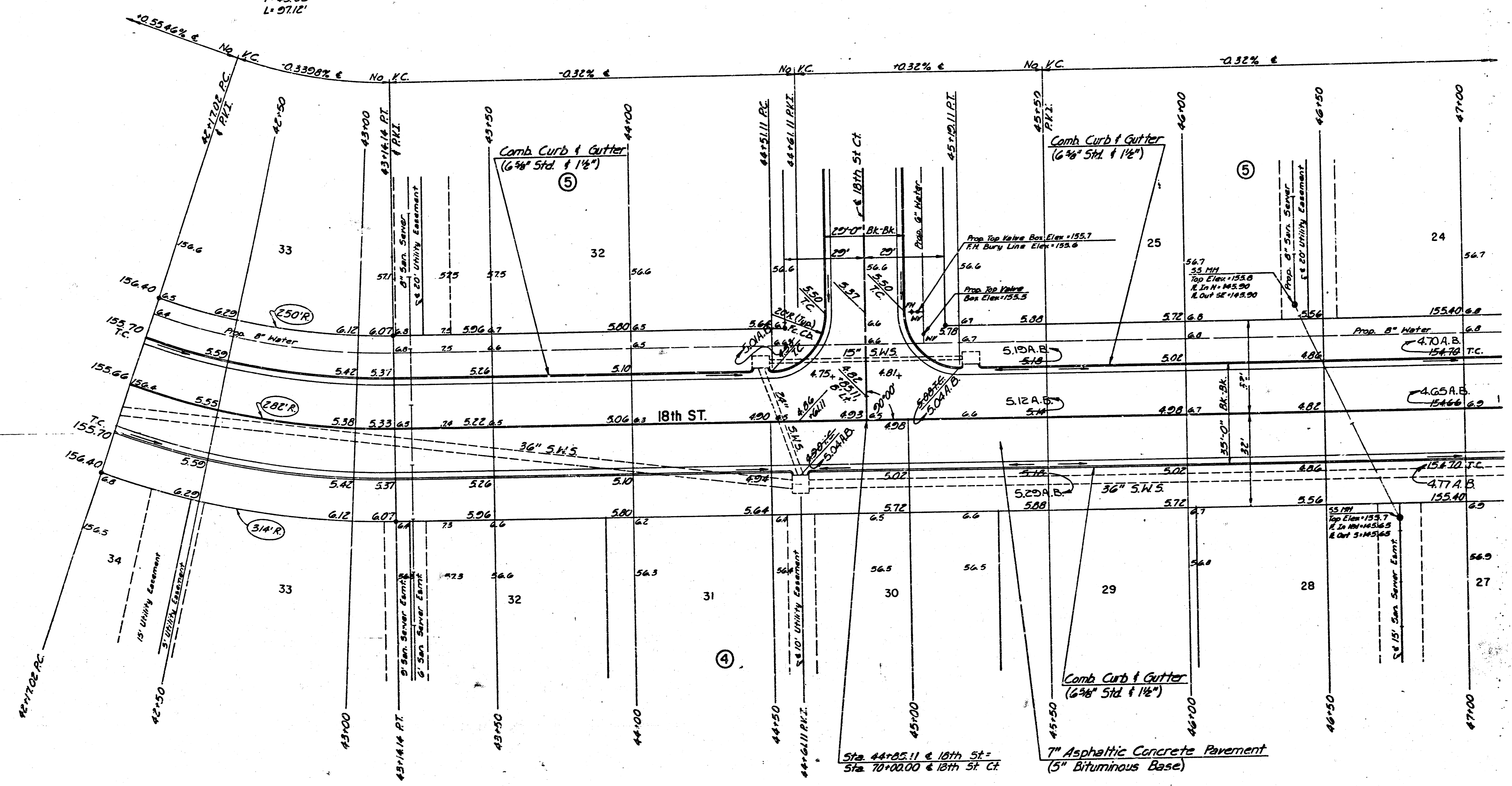

AS BUILT AUG., 1988

Note: See spot elevations for proposed walk grades.

18th ST. N.
 STA. 42+17.02 TO STA. 47+00.00

PROFESSIONAL ENGINEERING CONSULTANTS, P.A.
 ENGINEERS
 WICHITA, KANSAS

Designed by	CSB, GDD	Checked by	
Drawn by	BS	Date	Feb., 1988
		Job No.	87599-1

FILMED FROM THE BEST AVAILABLE COPY

PROJECT NO.	SHEET NO.	TOTAL SHEETS
472-76-245-B0001-000-000-039	9	13

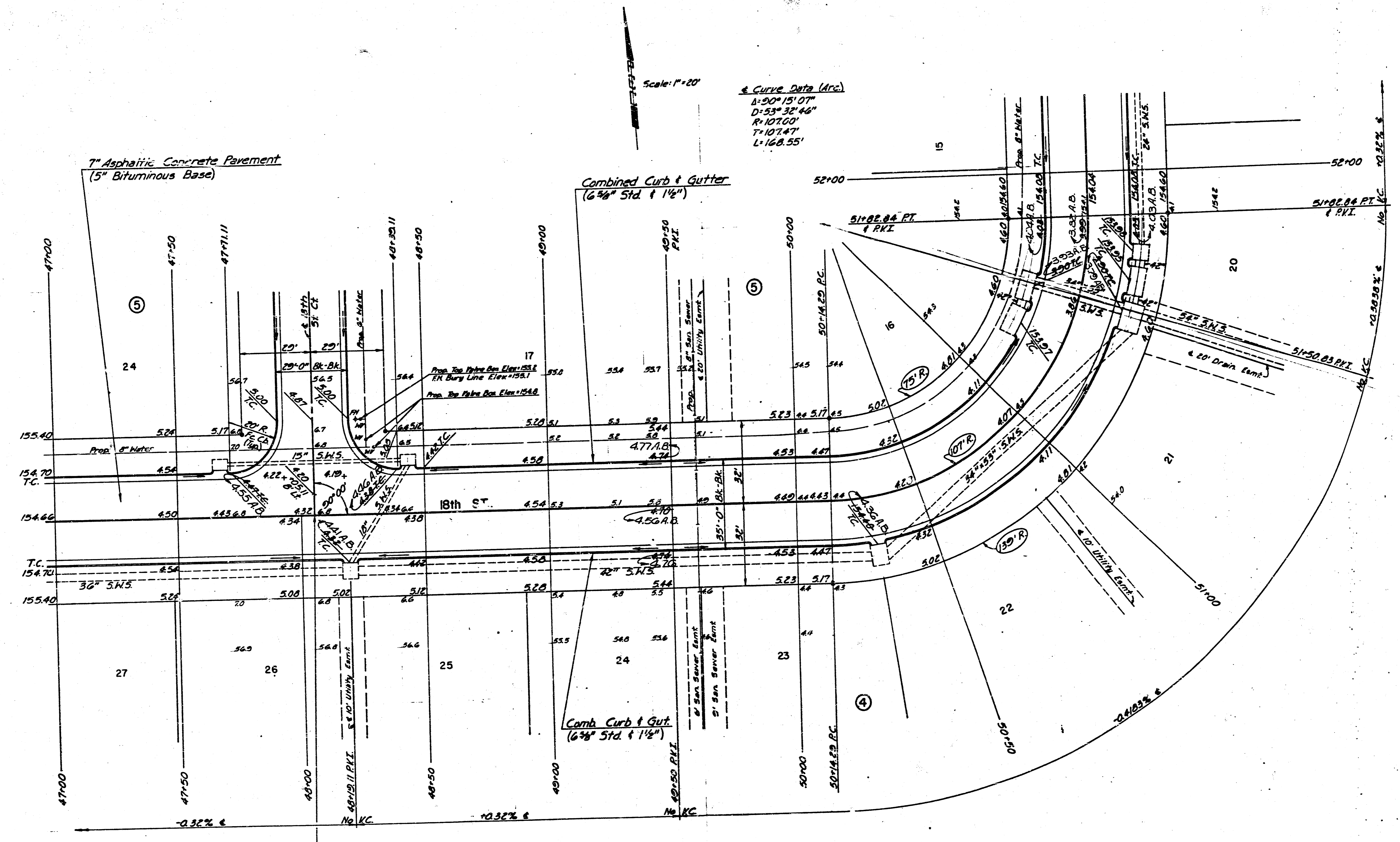

Scale: 1"=20'

Curve Data (Arc)
 $\Delta = 90^{\circ}15'07''$
 $D = 53'32'46''$
 $R = 107.00'$
 $T = 107.47'$
 $L = 168.55'$

7" Asphaltic Concrete Pavement
 (5" Bituminous Base)

Combined Curb & Gutter
 (6" Std. & 1 1/2")

Comb Curb & Gut.
 (6" Std. & 1 1/2")

Sta 48+05.11 & 18th St =
 Sta 50+00.00 & 18th St. Ck

Note: See spot elevations for proposed walk grades.

AS BUILT AUG., 1988

18th ST. N.
 STA. 47+00.00 TO STA. 51+82.84

PROFESSIONAL ENGINEERING CONSULTANTS, P.A.
 ENGINEERS
 WICHITA, KANSAS

Designed by	CSB, GDD	Checked by	
Drawn by	AS	Date	Feb., 1988
		Job No.	87555-1

FILMED FROM THE BEST AVAILABLE COPY

PROJECT NO.	SHEET NO.	TOTAL SHEETS
472-76-245-0001-000-000-039	10	13

Scale: 1"=20'

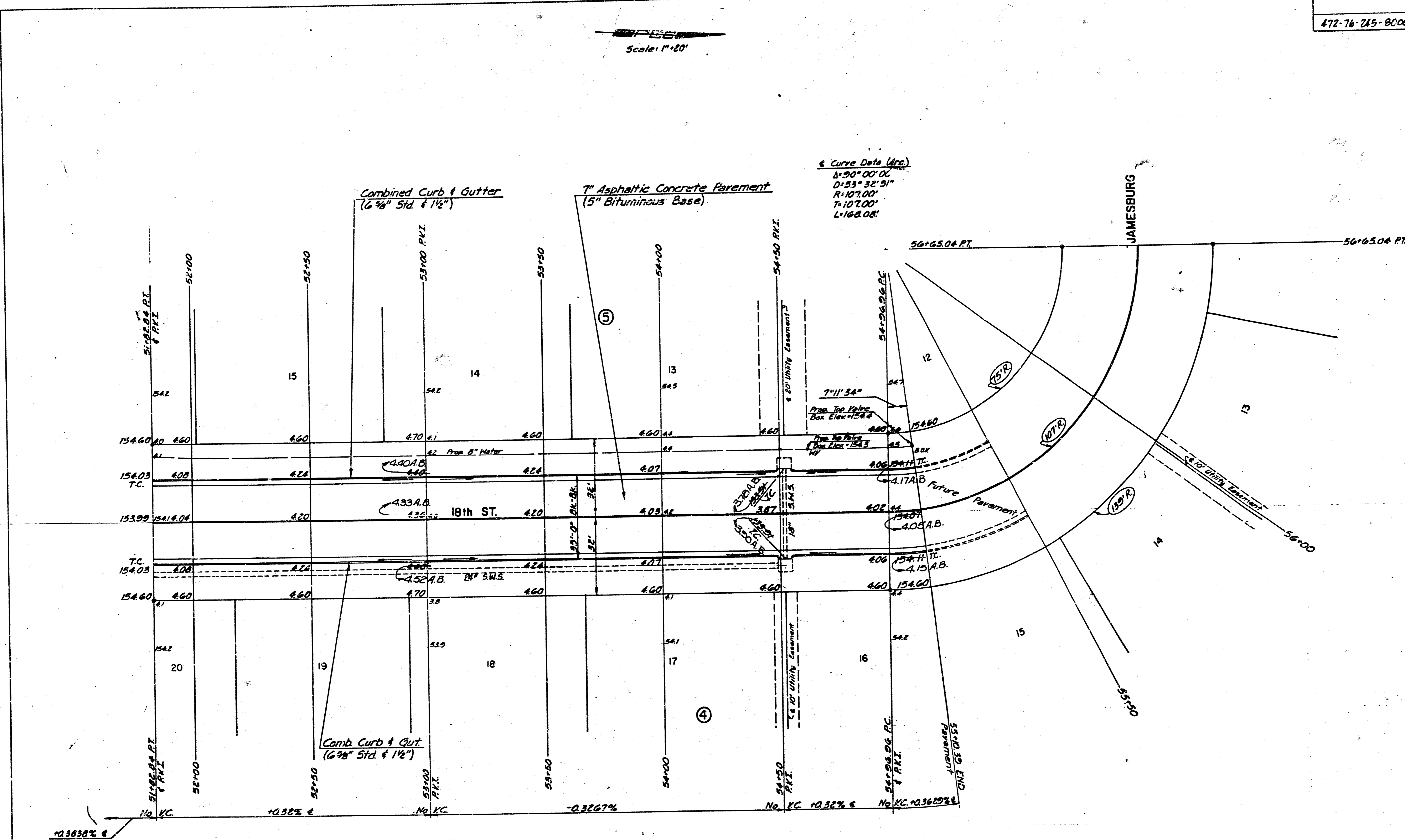

AS BUILT AUG., 1988

Note: See spot elevations for proposed walk grades.

18th St. N.
 STA. 51+82.84 TO STA. 55+10.39

PROFESSIONAL ENGINEERING CONSULTANTS, P.A.
 ENGINEERS
 WICHITA, KANSAS

Designed by	CSB, GDD	Checked by	
Drawn by	BS	Date	Feb, 1988
		Job No.	87339-7

FILMED FROM THE BEST AVAILABLE COPY

PROJECT NO.	SHEET NO.	TOTAL SHEETS
472-76-245-0001-000-000-039	11	13

Scale: 1" = 20'

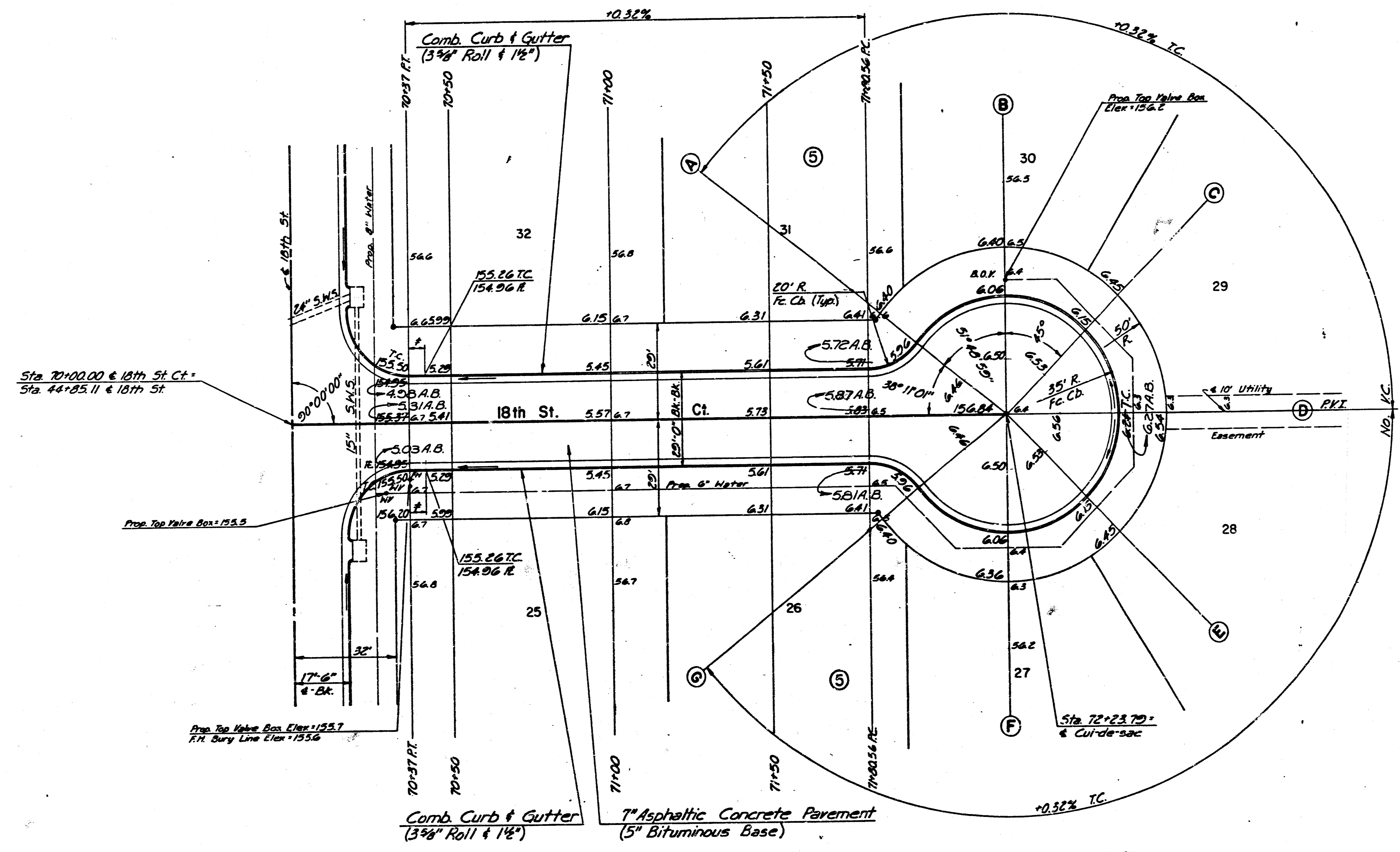

* 5' Transition from Combined Curb & Gutter (6 3/4" & 14") to Combined Curb & Gutter (3 3/4" & 14")
 Note: See spot elevations for proposed walk grades

AS BUILT AUG., 1988

18th St. Ct.
 STA. 70+00.00 TO STA. 72+23.79

PROFESSIONAL ENGINEERING CONSULTANTS, P.A.			
ENGINEERS WICHITA, KANSAS			
Designed by	CSB, GDD	Checked by	
Drawn by	BS	Date	Feb., 1988
		Job No.	87559-1

FILMED FROM THE BEST AVAILABLE COPY

