

BM. 190.31 R' in Ritchie top W. curb Armour at N.L. Stratford

Base Line W.R.

Sta	Asc	Dist	Chord Length	Dist. from	Dist. from	Dist. from
125	15.17	17.87	17.58	0° 00' 00"	0° 00' 00"	0° 00' 00"
130	26.00	26.01	35.78	5° 58' 16"	8° 58' 16"	8° 58' 16"
135	35.60	35.61	35.78	5° 58' 06"	08° 48' 06"	08° 48' 06"
140	44.15	44.16	35.78	5° 58' 06"	08° 48' 06"	08° 48' 06"

Excavation	Comp. Fill
170.0	170.0
110.8 C.Y.	249.4 C.Y.
111.6 100%	249.3 100%
151.3 100% C.Y.	274.3 100% C.Y.

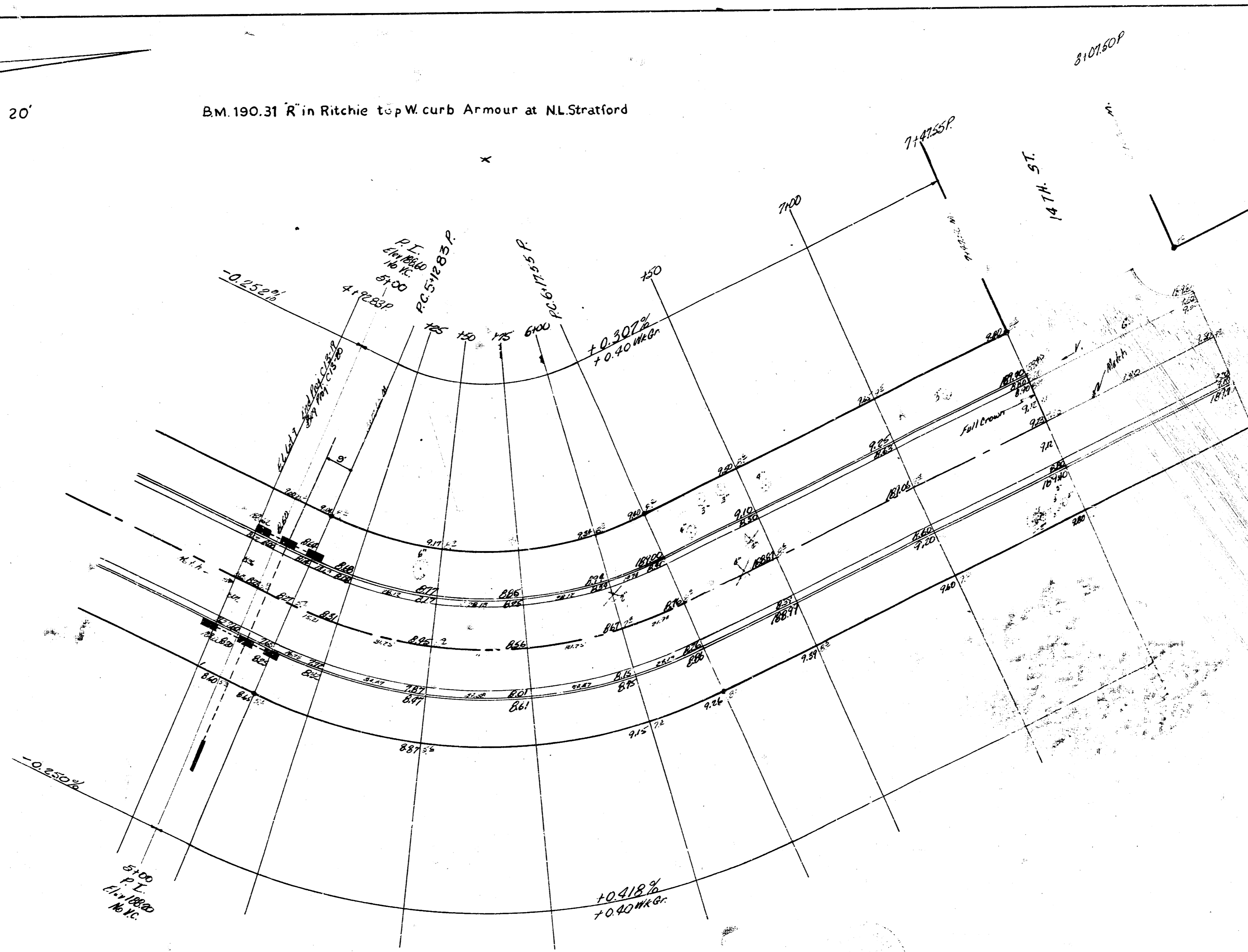

STRATFORD LANE
 E. Lot 9 Blk. A, Replat Blk 6 McEwen 8th Addn. to
 N.L. 14th St.
 26' - 2' - 30" A.C.
 City of Wichita, Kansas
 B.E. Smith City Engineer
 Date SEPT 1963 Proj C13-20

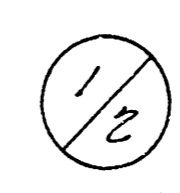

B.M. 190.31 'R' in Ritchie Top W. Co. Armour @ N.L. Stratford

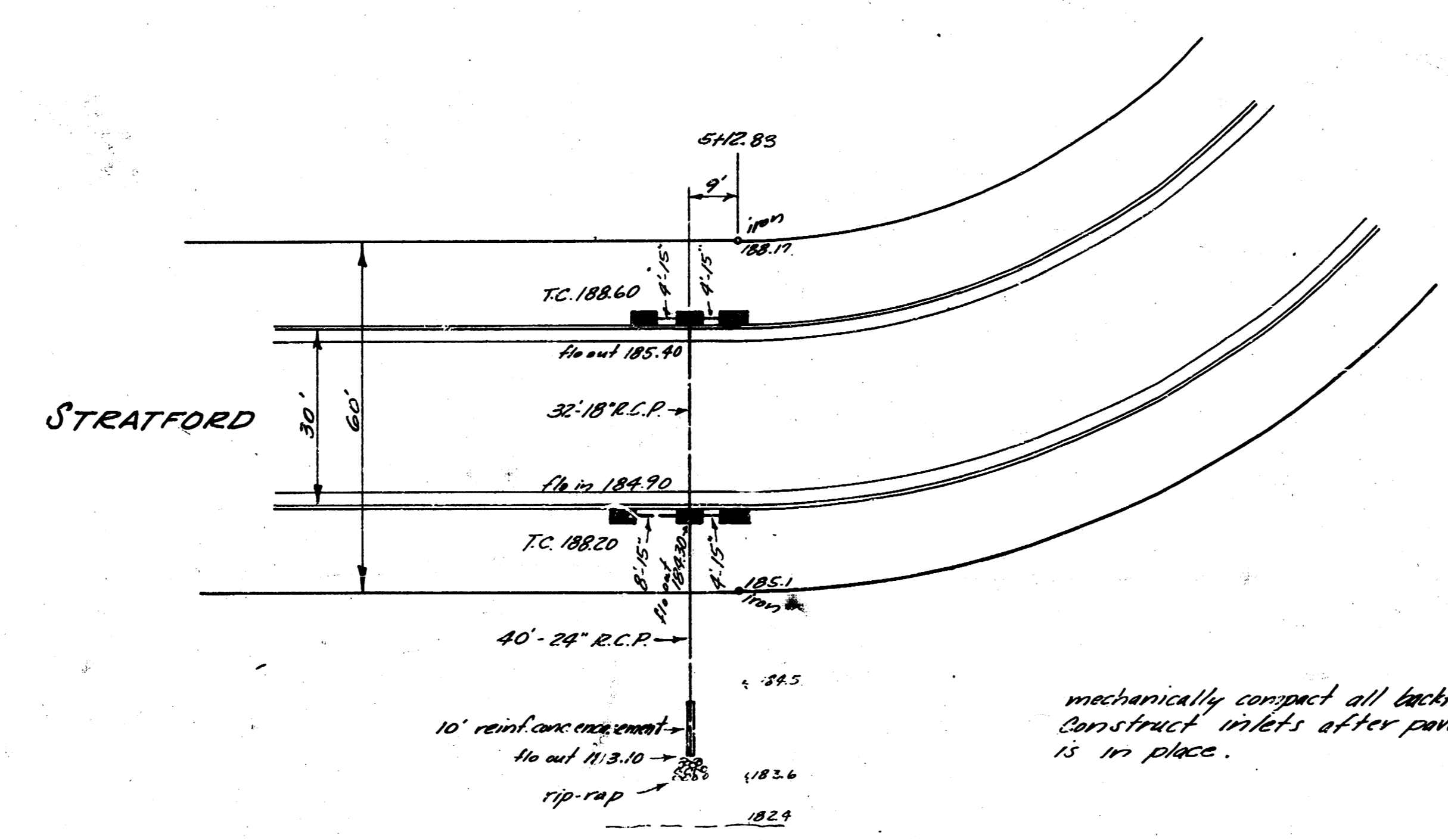
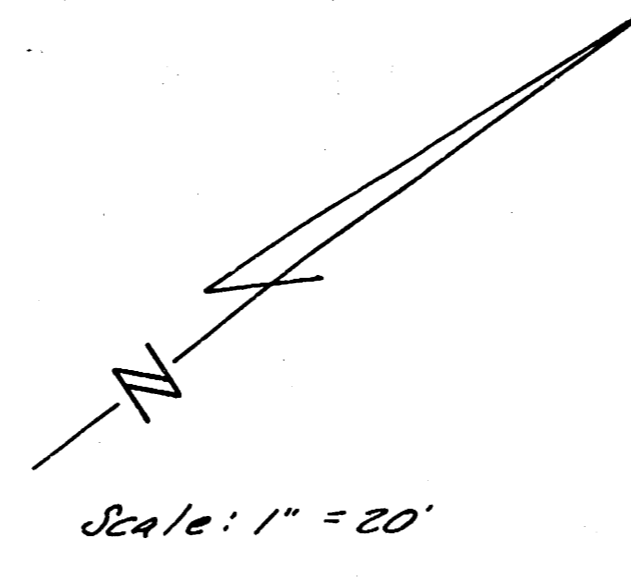

Plans
1/16/63

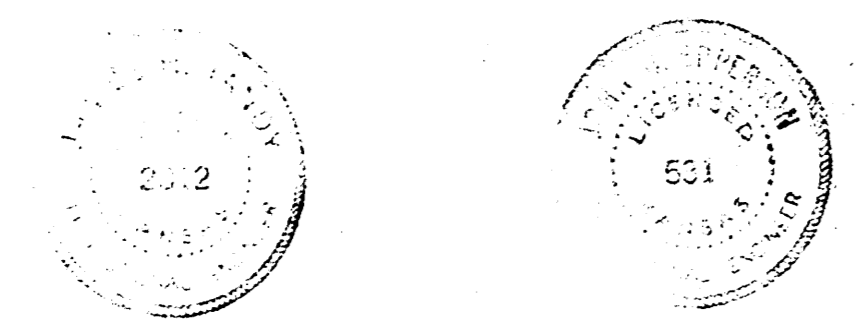

INCIDENTAL DRAINAGE
STRAFORD LANE
E.L. LOT 9, BLK. A, REPLAT OF BLK. G,
M'EWEN 8TH ADDN. TO N.L. 14TH ST.
CITY OF WICHITA, KANSAS
B.E. SMITH CITY ENGINEER
SEPT. 1963 PROJ. C13-20