

Scale 1"=20'  
 3M. 153.83 1/2" cut top E. ab. of Washington, 20' south of N.E. Suncrest  
 3M. 154.50 3/8" cut Arch, east entrance, stable McCallum House & 100' of Washington  
 B. 1/2" line on S.E. Suncrest Street

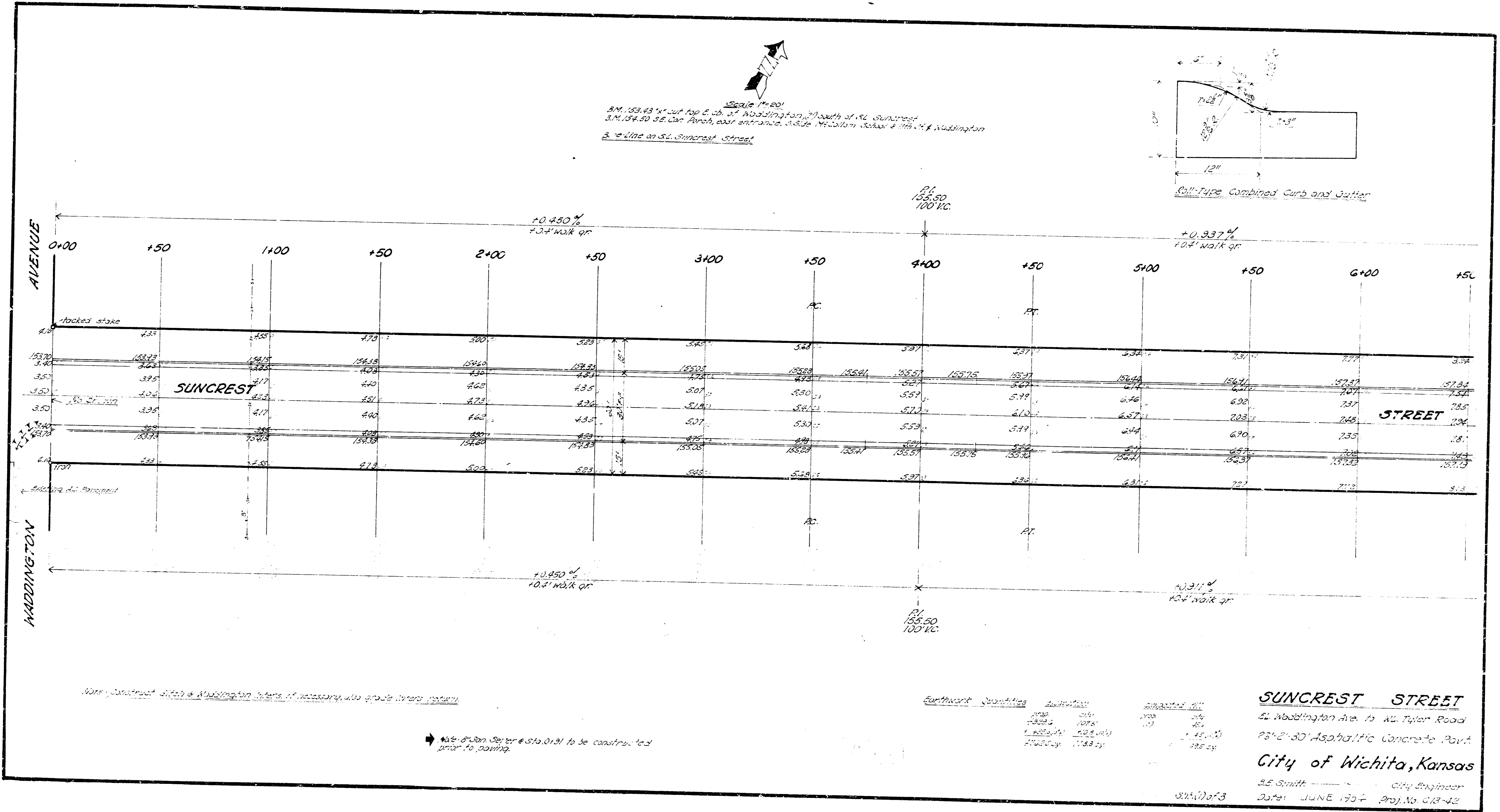
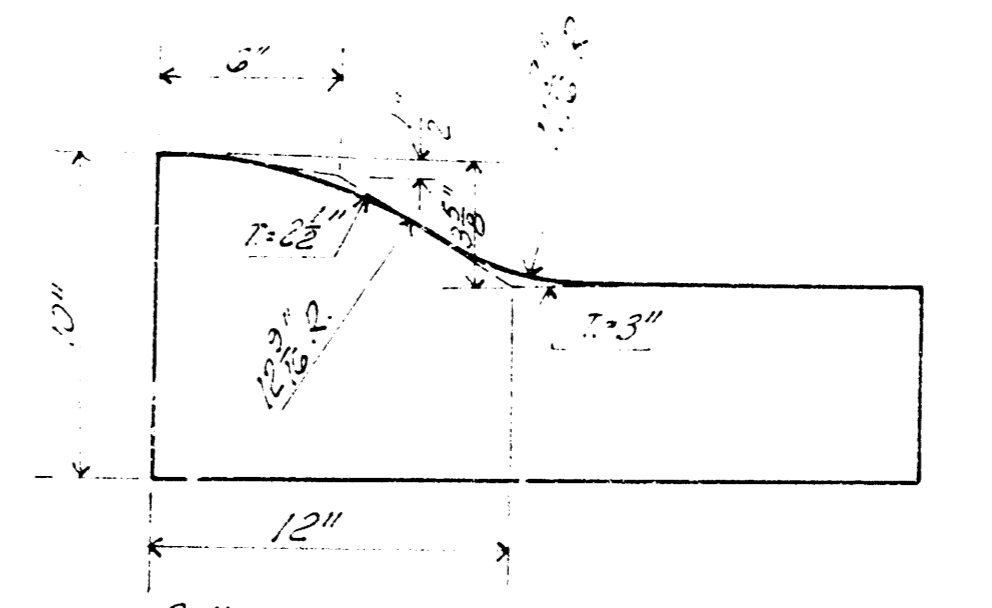

1/2" = 10' (vertical)  
 1/2" = 10' (horizontal)

Note: Construct ditches & Washington ditches if necessary, also grade living roadway.

Use 6" curb sewer @ Sta. 0+91 to be constructed prior to paving.

| Quantity | Description | Unit    | Quantity | Description | Unit    |
|----------|-------------|---------|----------|-------------|---------|
| 1000     | Excavation  | cy      | 1000     | Excavation  | cy      |
| 1000     | Backfill    | cy      | 1000     | Backfill    | cy      |
| 1000     | Gravel      | cy      | 1000     | Gravel      | cy      |
| 1000     | Asphalt     | sq. yd. | 1000     | Asphalt     | sq. yd. |

**SUNCREST STREET**  
 E. Washington Ave. to All Tyler Road  
 8" x 12" Asphalt Concrete Pavt  
 City of Wichita, Kansas  
 J.E. Smith City Engineer  
 Date: JUNE 1954 Proj. No. C.R.-42



Circle Data Based on SR Rad = 888.87 Δ = 29° 10'

| Station | PC    | Curve Length | Chord Length | Substation | Chord  |
|---------|-------|--------------|--------------|------------|--------|
| 10+00   | 10+00 | 0.00         | 0.00         | 10+00      | 0.00   |
| 10+25   | 10+25 | 25.00        | 41.21        | 10+12.50   | 41.21  |
| 10+50   | 10+50 | 50.00        | 81.21        | 10+25.00   | 81.21  |
| 10+75   | 10+75 | 75.00        | 121.21       | 10+37.50   | 121.21 |
| 11+00   | 11+00 | 100.00       | 161.21       | 10+50.00   | 161.21 |
| 11+25   | 11+25 | 125.00       | 201.21       | 10+62.50   | 201.21 |
| 11+50   | 11+50 | 150.00       | 241.21       | 10+75.00   | 241.21 |
| 11+75   | 11+75 | 175.00       | 281.21       | 10+87.50   | 281.21 |
| 12+00   | 12+00 | 200.00       | 321.21       | 11+00.00   | 321.21 |
| 12+25   | 12+25 | 225.00       | 361.21       | 11+12.50   | 361.21 |
| 12+50   | 12+50 | 250.00       | 401.21       | 11+25.00   | 401.21 |
| 12+75   | 12+75 | 275.00       | 441.21       | 11+37.50   | 441.21 |
| 13+00   | 13+00 | 300.00       | 481.21       | 11+50.00   | 481.21 |

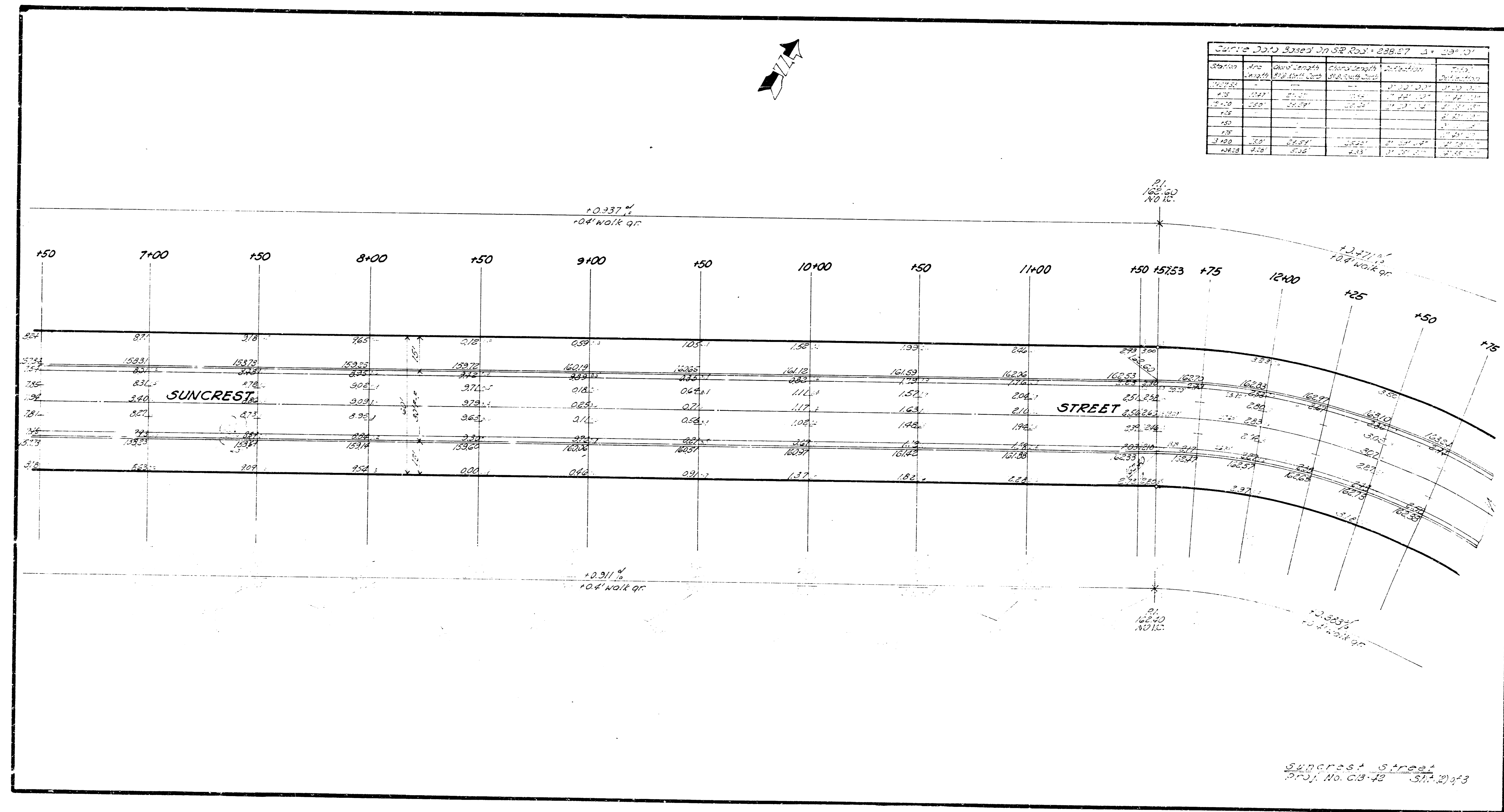

Suncrest Street  
 Proj. No. C-13-72 377.2) 3-83

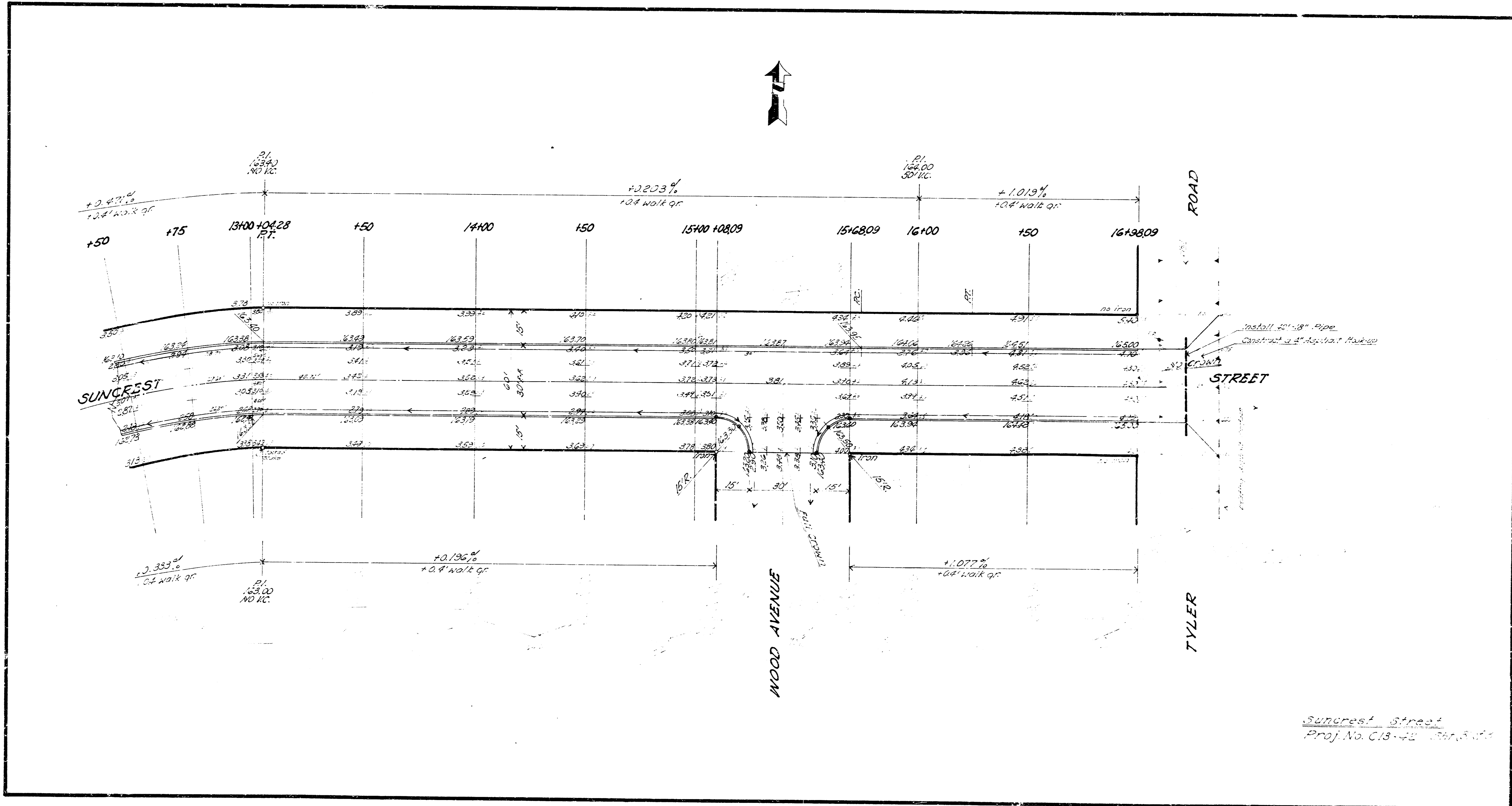

Suncrest Street  
Proj. No. C18-42 Rev. 5/15