

B.M. = 82.53 - CITY STD. 2' S. & 6' E. OF NE COR.
 IDA # 47th ST. S.
 B.M. = 84.25 - NW COR. CONC. PORCH HO. # 4654 S. WASHINGTON.
 B.M. = 82.84 - NE COR. E. HUBGUARD 8' x 3' RCBC E. SIDE I-235.

WASHINGTON SQUARE ADDITION

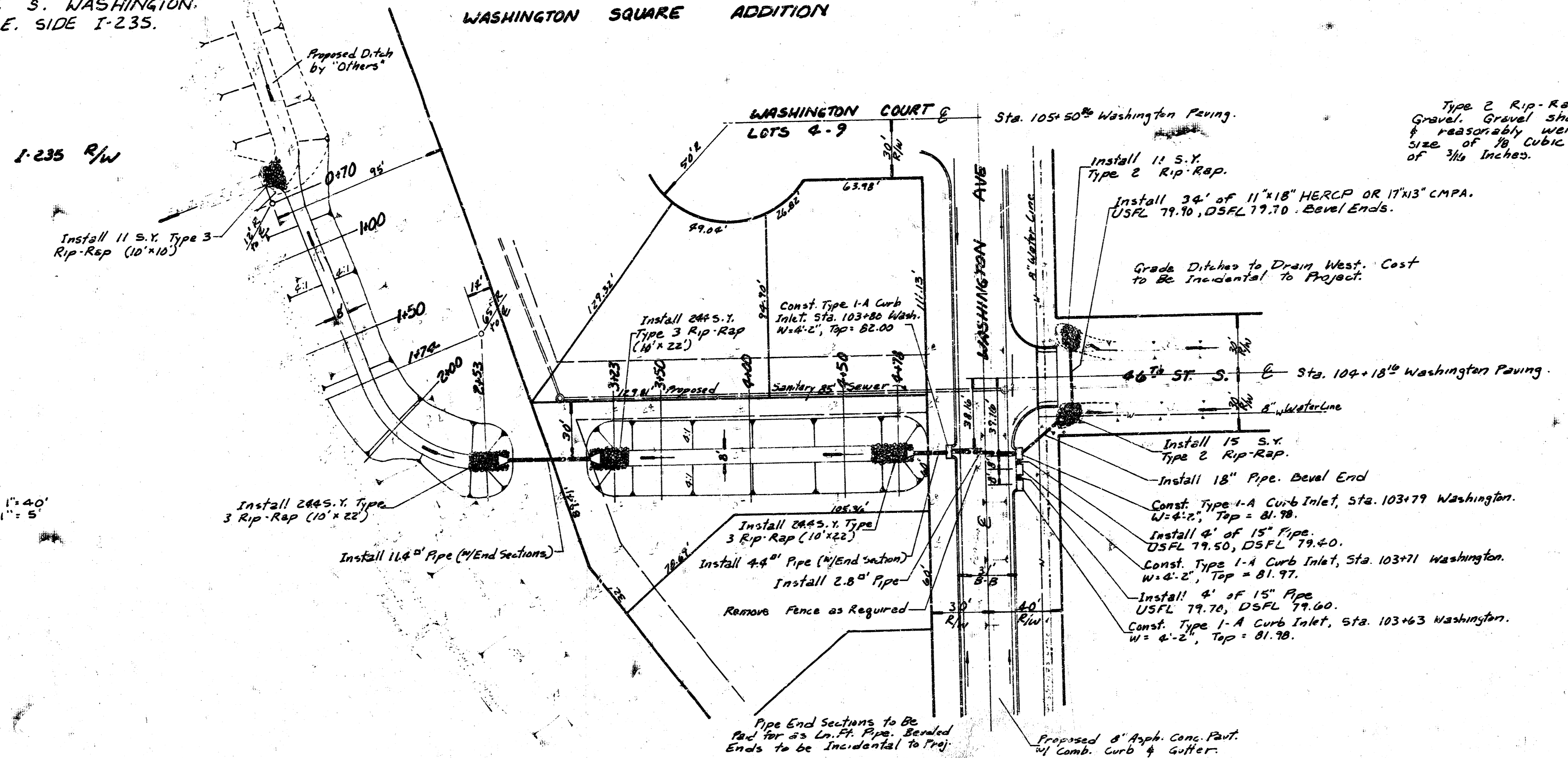

Type 2 Rip-Rap shall be 12" Coarse Gravel. Gravel shall be hard, dense, durable & reasonably well graded with a maximum size of 3/8" cubic foot and a minimum size of 3/16" inches.

SCALE:
 Plan: 1" = 40'
 Profile: Horiz: 1" = 40'
 Vert: 1" = 5'

PLAN
 NOT BOOK

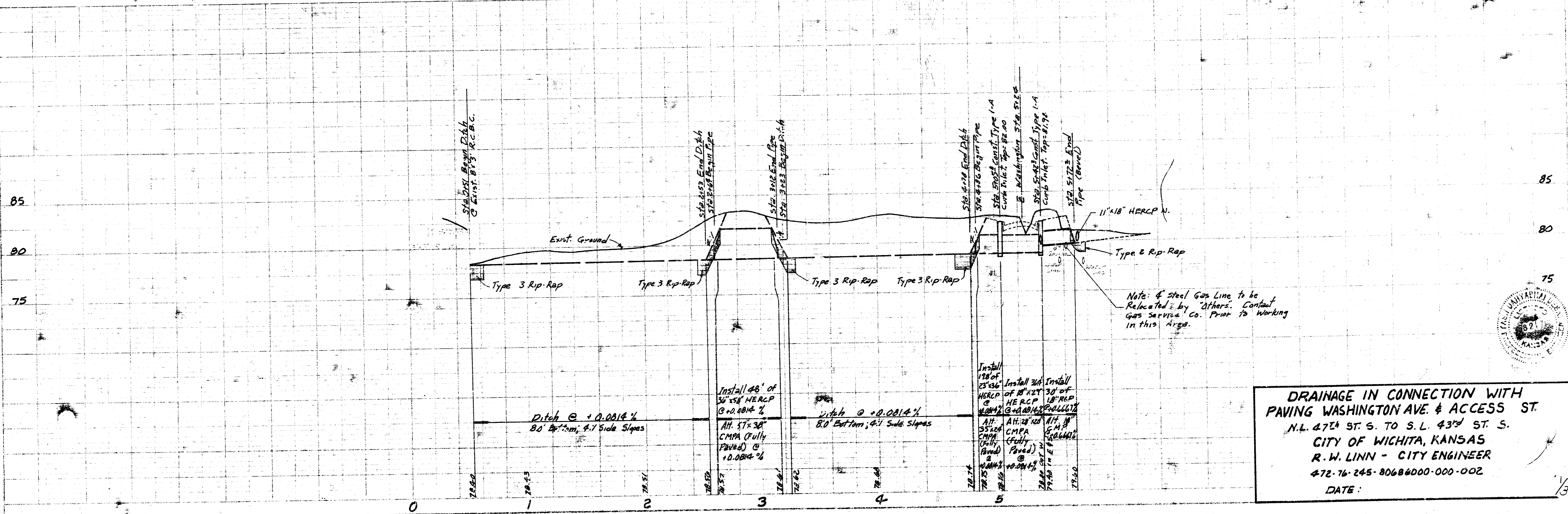

DRAINAGE IN CONNECTION WITH PAVING WASHINGTON AVE. & ACCESS ST.
 N.L. 47th ST. S. TO S.L. 43rd ST. S.
 CITY OF WICHITA, KANSAS
 R. W. LINN - CITY ENGINEER
 472-76-245-8068@000-000-002
 DATE:



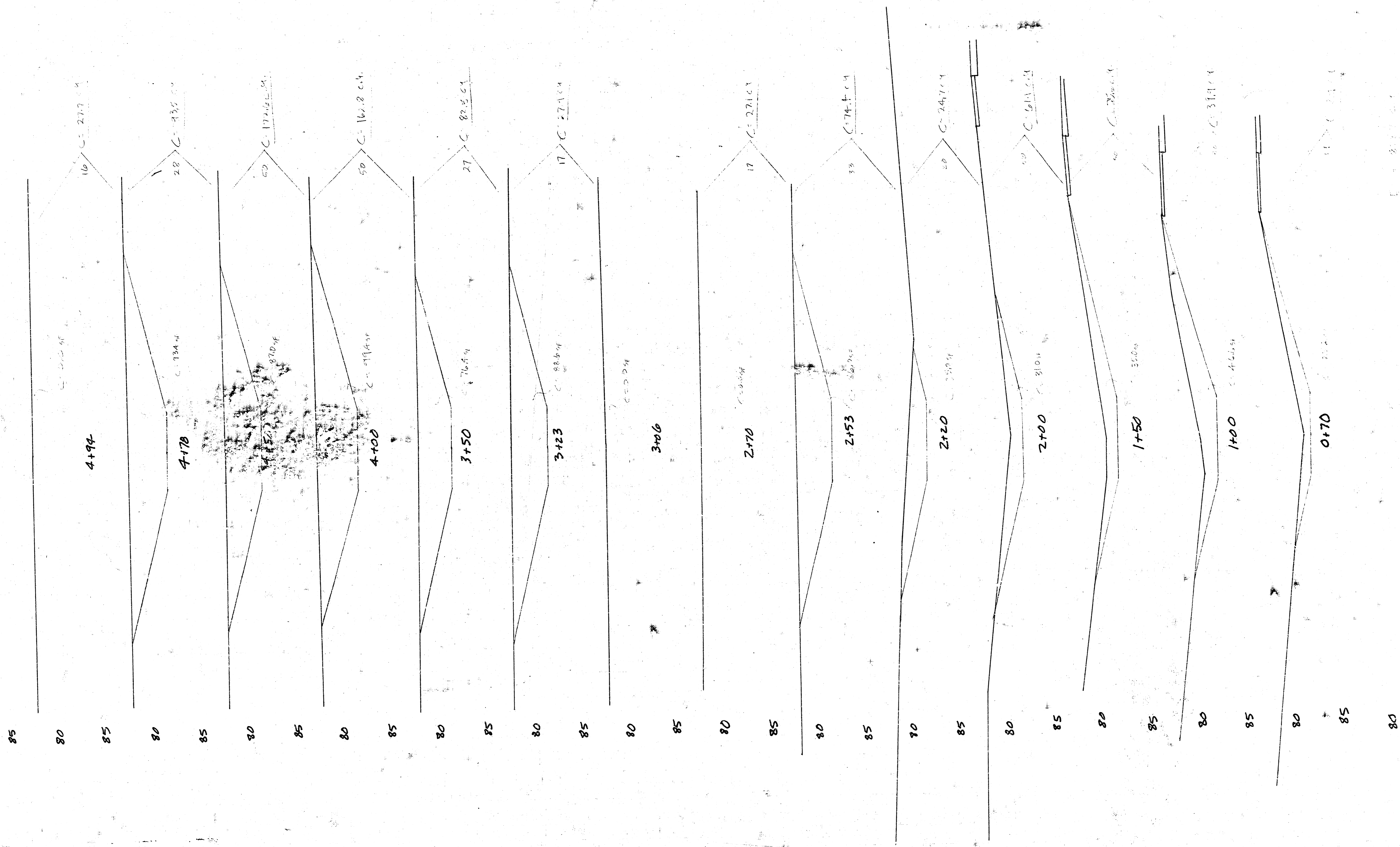

30 25 20 15 10 5 0 5 10 15 20 25 30

DRAINAGE IN CONNECTION WITH
 PAVING WASHINGTON AVE. & ACCESS ST.
 N.L. 47th ST. S TO S.L. 43rd ST S.
 472 76 245 80486000 000 002

FILMED FROM THE BEST
 AVAILABLE COPY

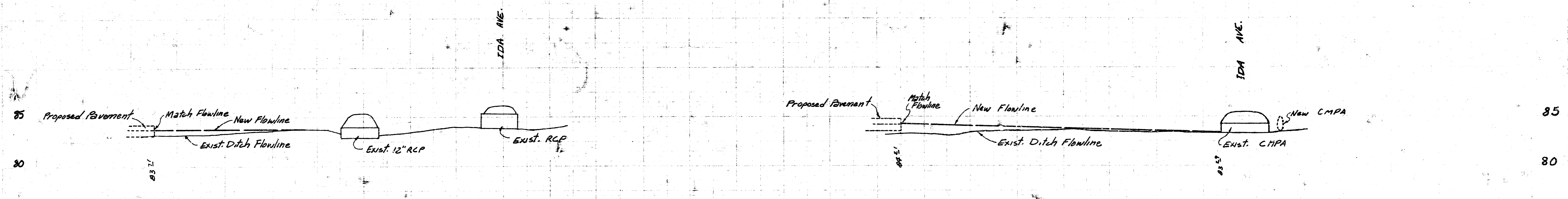
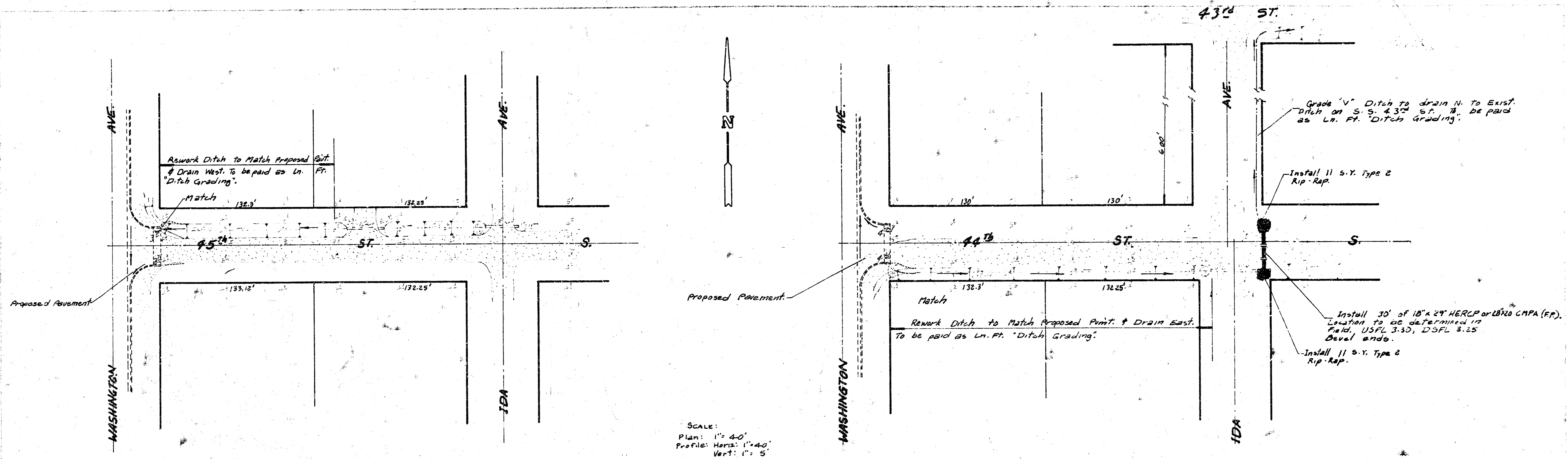

DRAINAGE IN CONNECTION WITH PAVING
 WASHINGTON AVE. & ACCESS ST.
 N.L. 47th ST. S. TO S.L. 43rd ST. S.
 412 76245 80686000 00 @ 002