

B.M. #1 129.72 Step Bench P.P. & Meridian & 25<sup>th</sup> St.  
 B.M. #2 129.06 Spike N.E. S. P.P. Approx. 150' W. & 114' S. of Intersection Richmond & Wilson  
 B.M. #3 128.99 N.W. Cor. Conc. Porch Ho. N.E. Cor. Hulstead & 25<sup>th</sup> St.

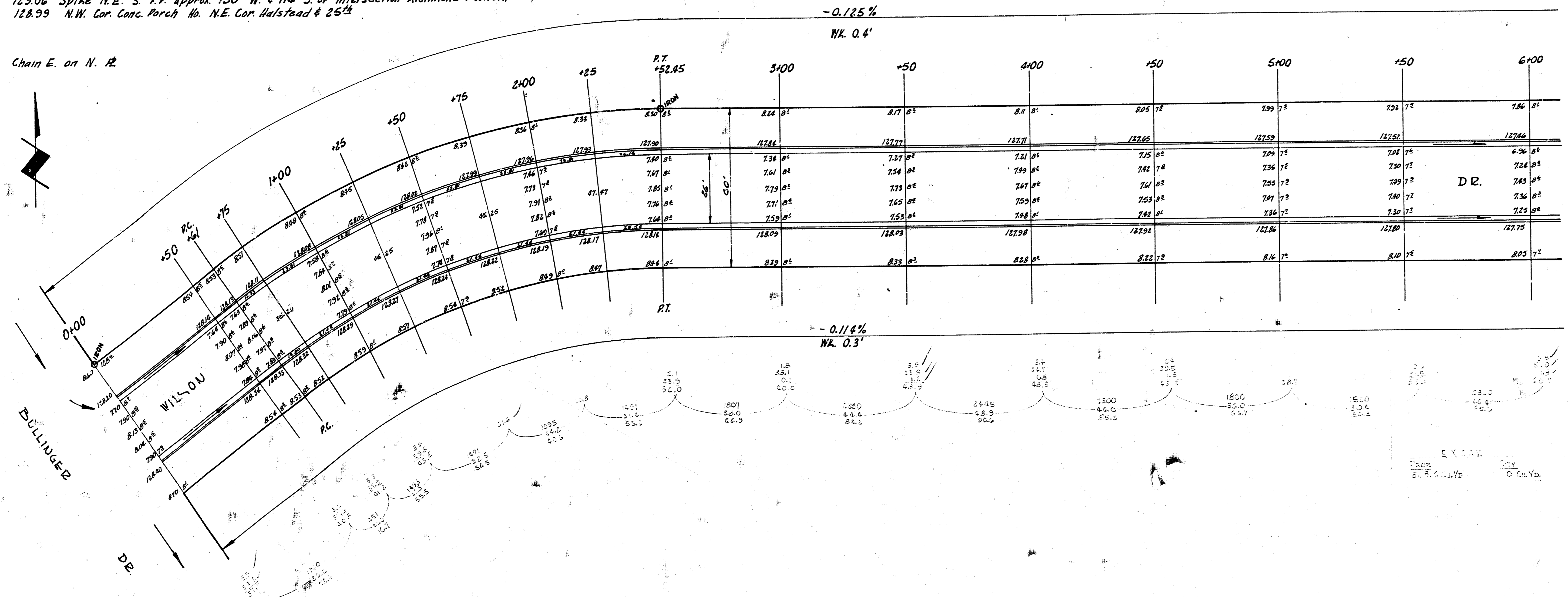

CURVE DATA BET. STA 0+01 & STA 2+52.85  
 STA ON N. R. R=815.67 Δ=34°45'

STA	COORD. LITH. ON S. CR.	COORD. LITH. ON N. CR.	DEFLECTION ANGLE	TOTAL ANGLE DEFLECTION
0+51				
1+75	11.74	13.60	1°16'15"	1°16'15"
1+00	20.95	24.22	2°16'00"	3°32'15"
1+25	20.95	24.22	2°16'00"	5°48'15"
1+50	20.95	24.22	2°16'00"	8°04'15"
1+75	20.95	24.22	2°16'00"	10°20'15"
2+00	20.95	24.22	2°16'00"	12°36'15"
2+25	20.95	24.22	2°16'00"	14°52'15"
2+52.85	28.01	24.64	2°29'24"	17°21'39"



WILSON DRIVE  
 E.L. BULLINGER - N.L. MANHATTAN  
 26-2-30 AC  
 CITY OF WICHITA, KANS.  
 B. E. SMITH CITY ENGINEER  
 SEPT, 1954 PROJ. NO. C14-184

1/3

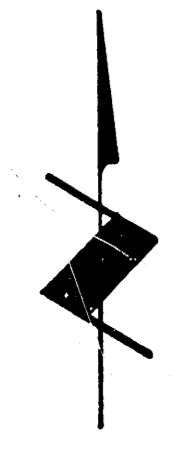

NOTE  
Intersection to be Paved  
on Proj. No. C/14-181

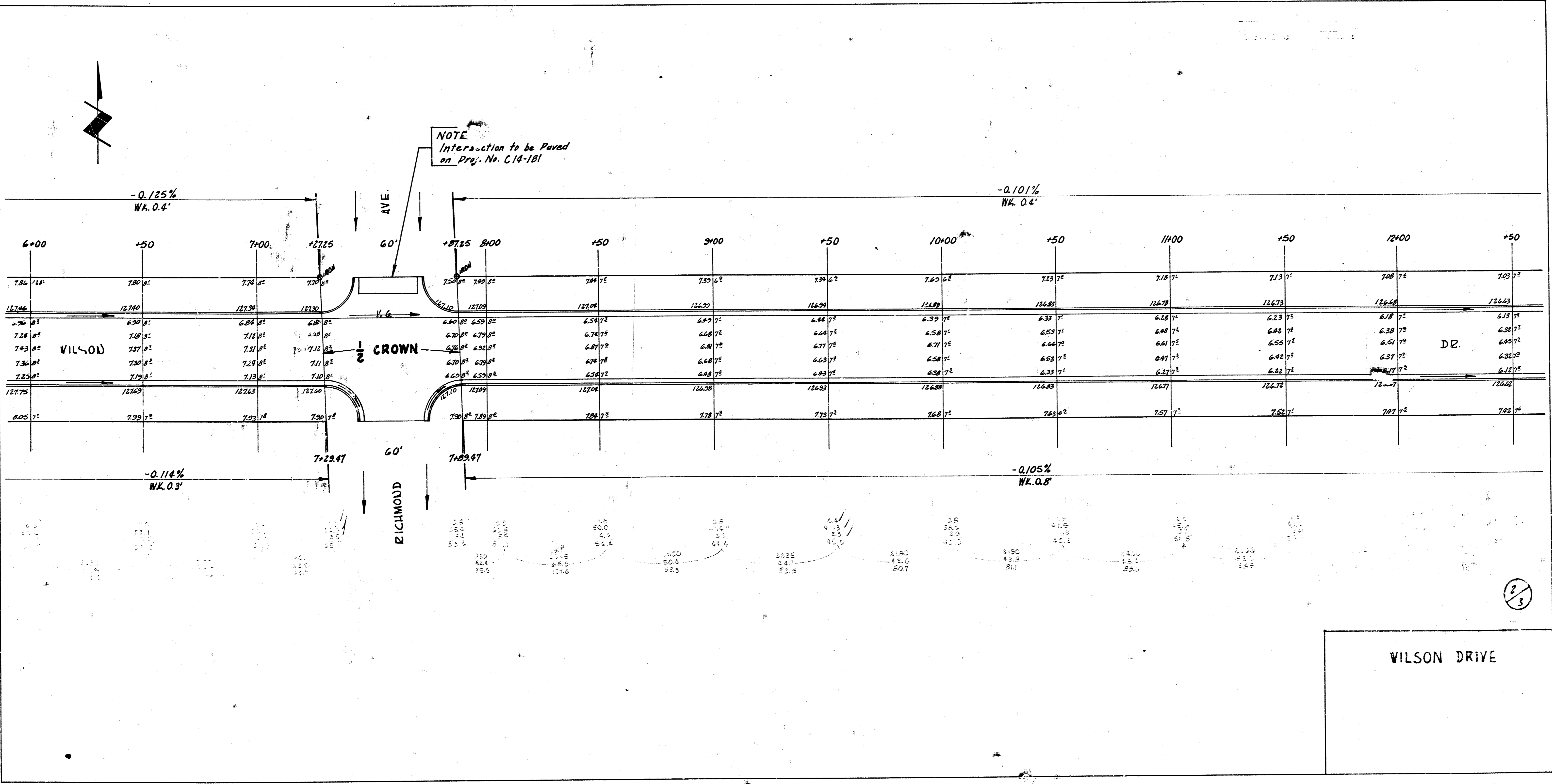

WILSON DRIVE

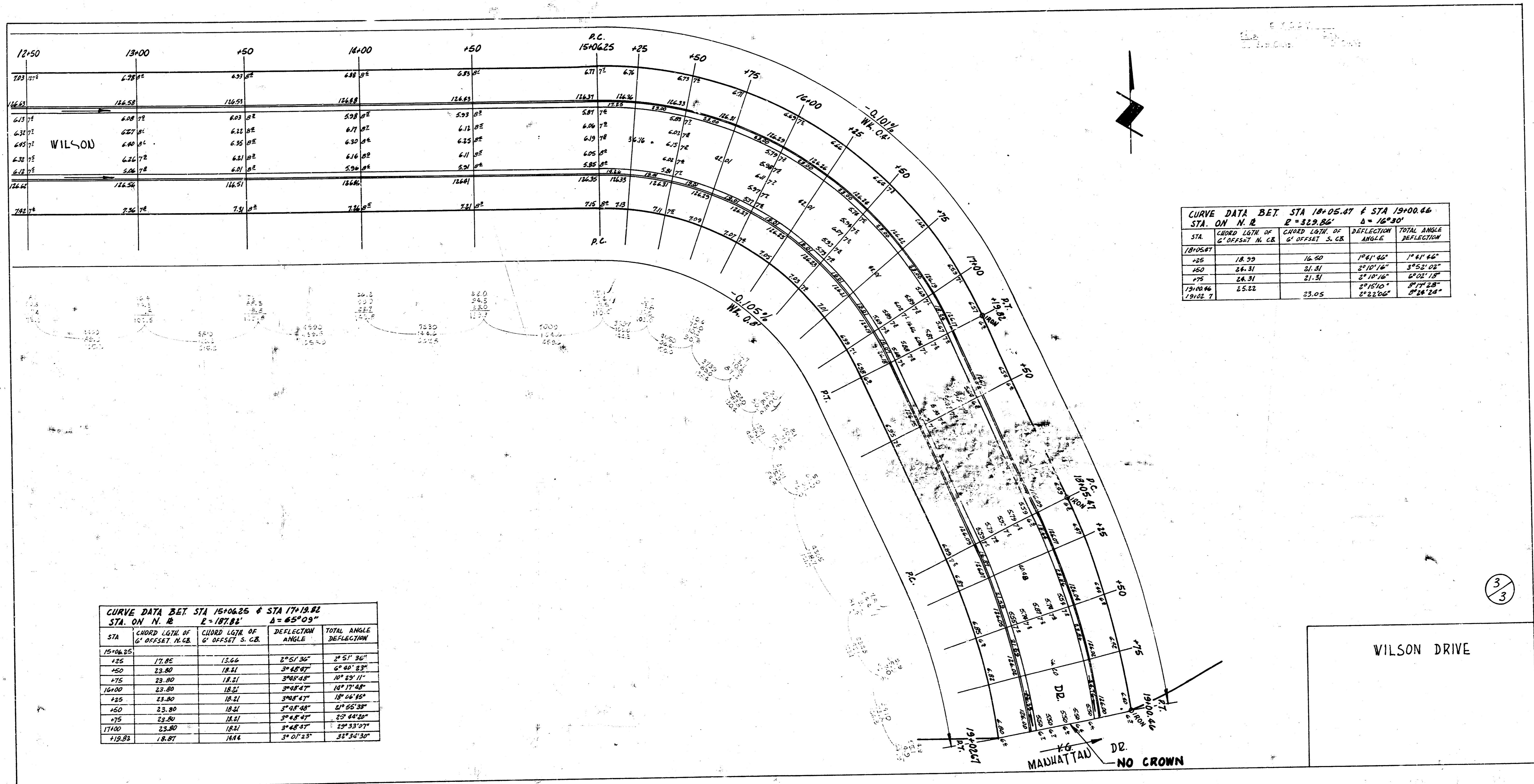

CURVE DATA BET STA 16+05.41 & STA 16+06.46  
STA ON N. 2 E° 32.2' 26" Δ = 16° 30'

STA	CURVED LGTH OF G' OFFSET N. C.R.	CURVED LGTH OF G' OFFSET S. C.R.	DEFLECTION ANGLE	TOTAL ANGLE DEFLECTION
16+05.41				
16+50	18.50	16.50	1° 41' 46"	1° 41' 46"
17+00	24.51	21.51	2° 10' 16"	3° 52' 02"
17+06.46	26.51	21.51	2° 10' 16"	6° 02' 18"
17+06.46	25.52	22.05	2° 15' 10"	8° 17' 28"
17+06.46			2° 22' 06"	10° 39' 34"

CURVE DATA BET STA 15+06.25 & STA 17+10.82  
STA ON N. 2 E° 187' 8" Δ = 65° 09"

STA	CURVED LGTH OF G' OFFSET N. C.R.	CURVED LGTH OF G' OFFSET S. C.R.	DEFLECTION ANGLE	TOTAL ANGLE DEFLECTION
15+06.25				
15+25	17.85	13.66	2° 51' 35"	2° 51' 35"
16+00	23.80	18.81	3° 48' 07"	6° 40' 22"
16+25	23.80	18.81	3° 48' 07"	10° 28' 11"
16+50	23.80	18.81	3° 48' 07"	14° 17' 48"
17+00	23.80	18.81	3° 48' 07"	18° 06' 55"
17+25	23.80	18.81	3° 48' 07"	21° 55' 33"
17+50	23.80	18.81	3° 48' 07"	25° 44' 26"
17+75	23.80	18.81	3° 48' 07"	29° 33' 07"
17+10.82	18.81	14.66	3° 07' 23"	32° 40' 30"

3/3

WILSON DRIVE

NO CROWN