

DEPARTMENT OF PUBLIC IMPROVEMENT AND STREETS
WICHITA, KANSAS

Estimated cost of sewer with Kirkwood tunnel into cost.		Detail of cost of sewer without Kirkwood tunnel.	
9750 ft 4 1/2"	52	48758.00	43395.00
14300 ft 4 1/2"	48	68250.00	60725.00
11675 ft 4 1/2"	40	47618.75	32112.00
12635 ft 3 1/2"	40	50540.00	51250.00
1200 ft 3 1/2"	3 1/2	3900.00	5732.50
with		150	
100 man-holes		3500	
900			
9 man-holes		900	
11,708.75		26,518.75	15,170.00

Total capacity of main 4 1/2" with 24 man-holes 24 hrs -
 Hocking Co. discharge at rate of 3 million gal in 24 hrs - allow for increase of 2 million gal in 24 hrs. with a 1/2 capacity of main a 36,000 gal
 Flats 80 a - 3080
 8.7 2 1/2 D 1000

STREET MAP OF WICHITA KANSAS.

STREET LINES
 INTERURBAN RAILWAY AND STREET RAILWAY LINES
 CITY LIMITS
 CURVE DATA FOR THE MAIN STREET
 DRAWN BY JAMES J. JONES UNDERMANN
 1912
 CONVERSION 1912

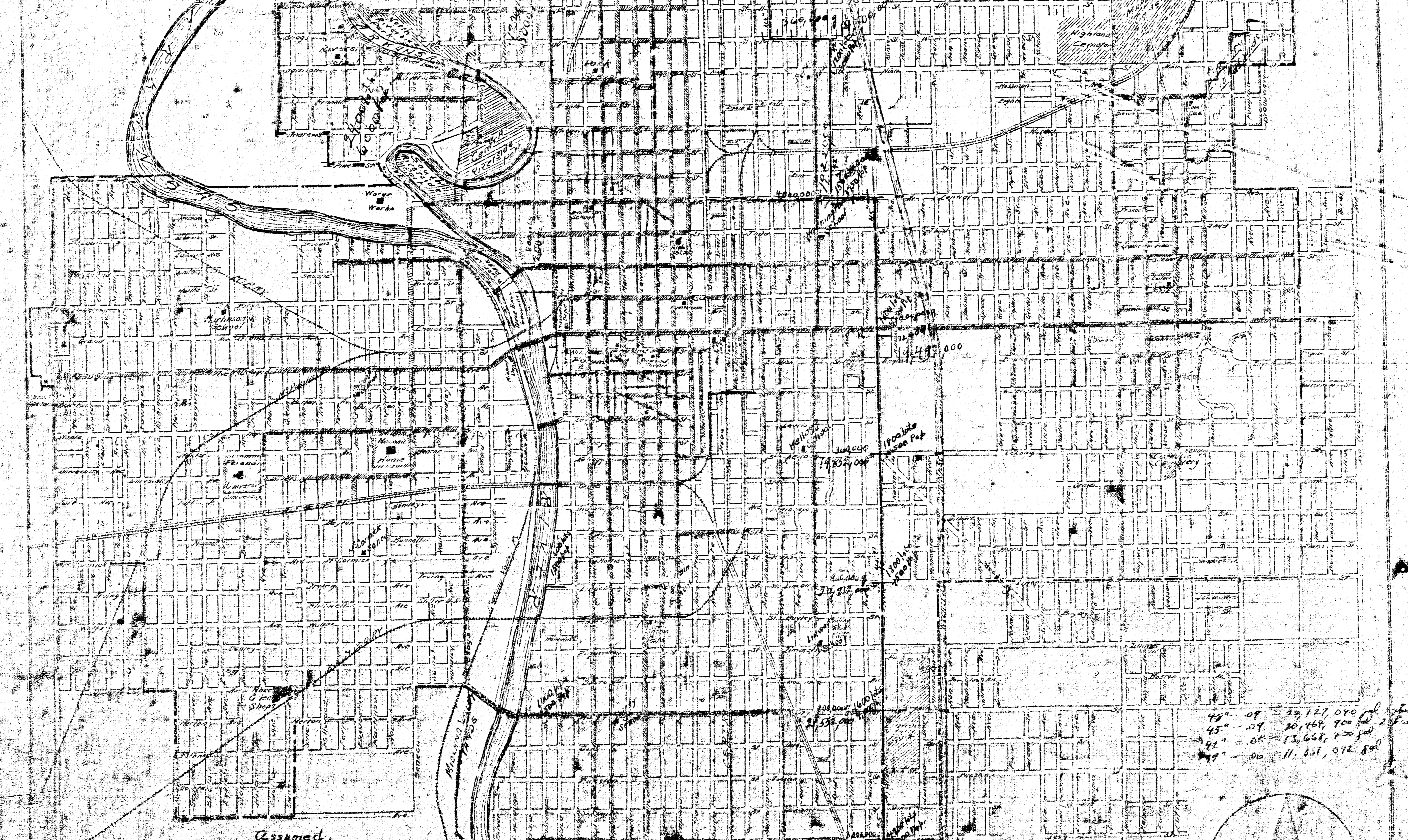

45"	07	29,127,040 gal
45"	09	30,464,900 gal
41"	05	13,628,100 gal
49"	00	11,351,072 gal

Assumed.
 Population - 2 1/2 to 300,000
 Sewage - 100 gal. per capita in 12 hrs.

