

S.W. 1/4 SEC. 27 TWP. 27 R.1.E.

10-58

27

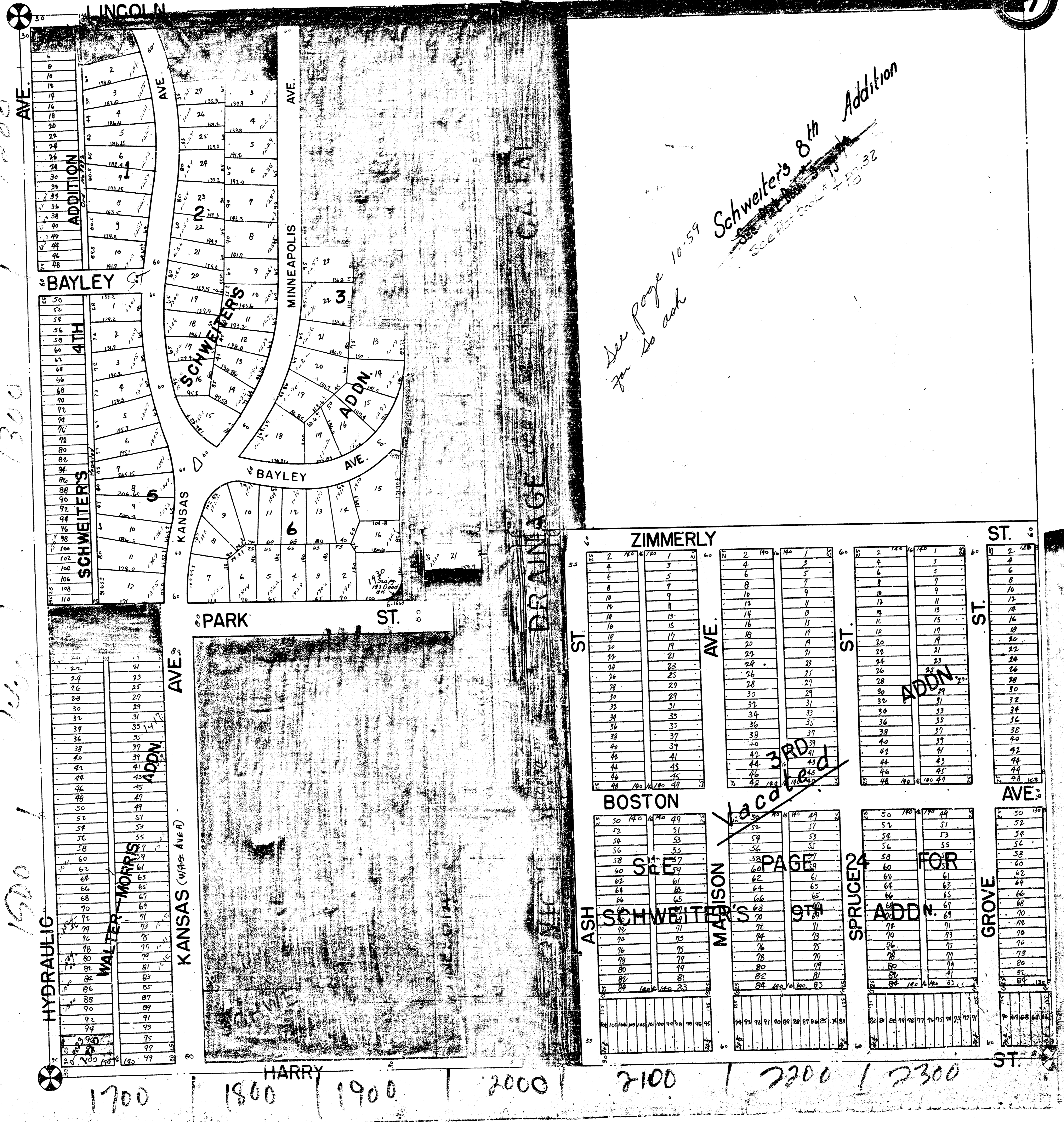

1200
1300
1400
1500
1600
1700

See page 10-59 for 20 ask
Schweiter's 8th Addition
SEE PLAT BOOK # 10-32

3RD & 4TH

MASON'S PAGE 9TH

SPRUCE 24 FOR ADDN.

1700 | 1800 | 1900 | 2000 | 2100 | 2200 | 2300