

TOWNSHIP No. 27 SOUTH OF RANGE No. 1 EAST OF THE 6TH PRINCIPAL MERIDIAN KAN.

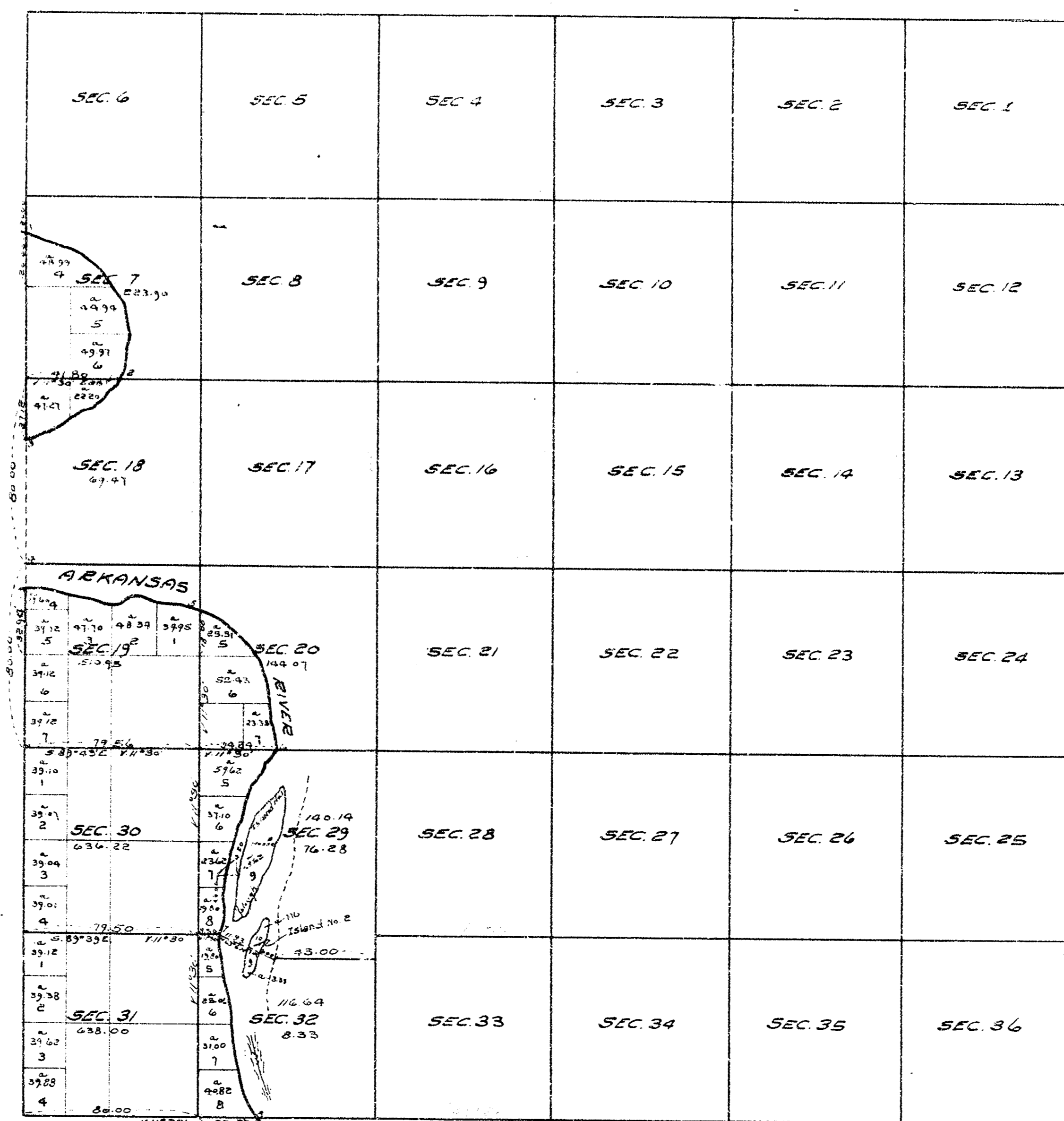

Scale 90 chains to one Inch
Variations of the needle east.

The above Map of Township No. 27 South of Range No. 1 East of the
6TH Principal Meridian, Kansas, is a true copy of the original plat
Surveyor General's Office
Lawrence, Kan. July 22ND 1874 } C.W. BABCOCK,
Surveyor General.

Copied Oct. 28TH 1930
By: ERANSON H. BROWN
County Surveyor.