

N.E. 1/4 SEC. 22, TWP. 27 S., R. 1 W.

Central Aerial
Original Plat in Engineering 211
6-50

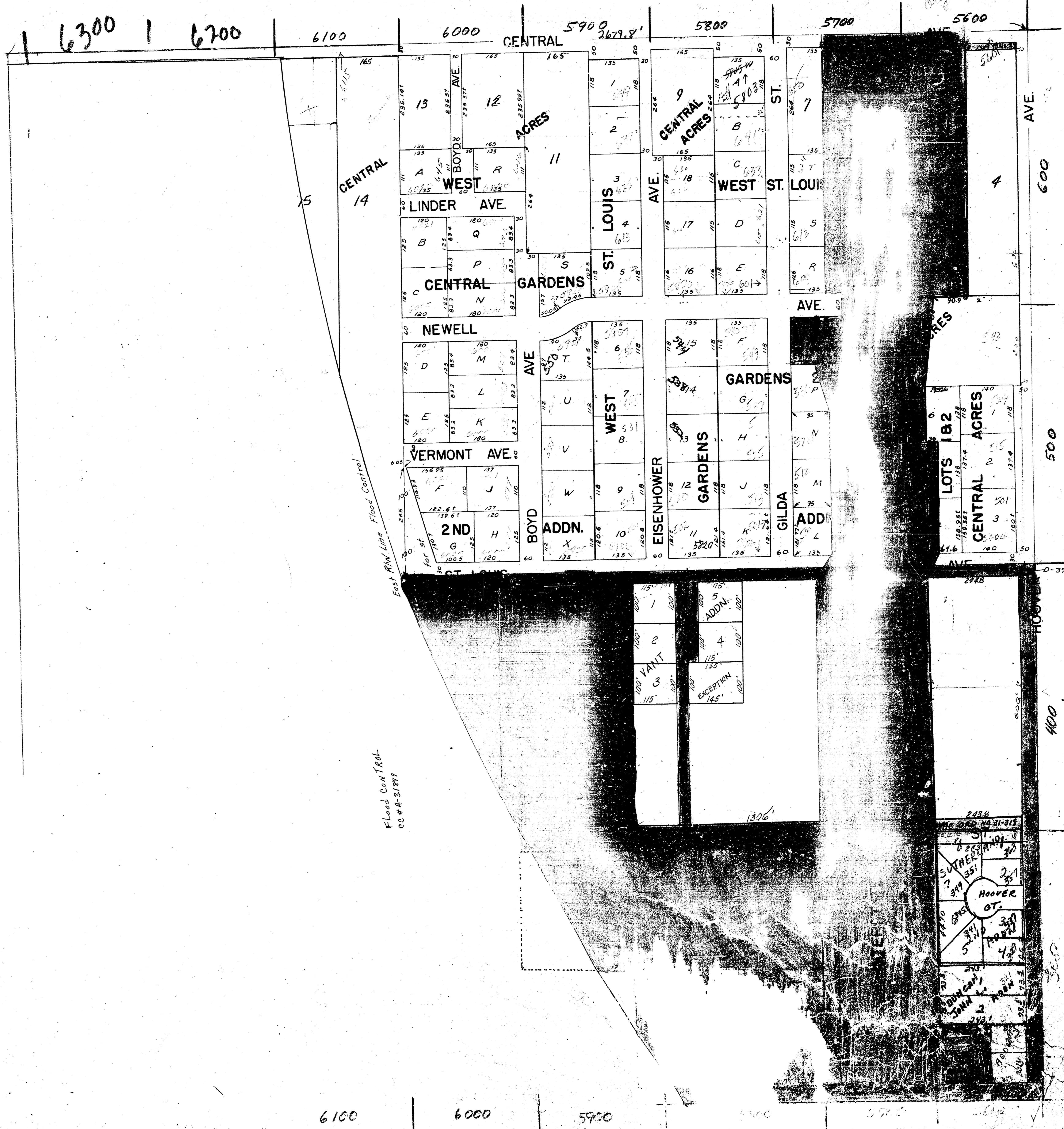

6300

6200

6100

6000

5900

5800

5700

5600

6100

6000

5900

5800

5700

East RR Line Flood Control

Flood Control
CC # 4-2189

2488
 HOOPER ST.
 HOOPER OT.
 314
 315
 316
 317
 318
 319
 320
 321
 322
 323
 324
 325
 326
 327
 328
 329
 330
 331
 332
 333
 334
 335
 336
 337
 338
 339
 340
 341
 342
 343
 344
 345
 346
 347
 348
 349
 350
 351
 352
 353
 354
 355
 356
 357
 358
 359
 360
 361
 362
 363
 364
 365
 366
 367
 368
 369
 370
 371
 372
 373
 374
 375
 376
 377
 378
 379
 380
 381
 382
 383
 384
 385
 386
 387
 388
 389
 390
 391
 392
 393
 394
 395
 396
 397
 398
 399
 400

500

400

300

200