

7-69

S.E. 1/4 SEC. 35, TWP. 27S, R.1W 7-64

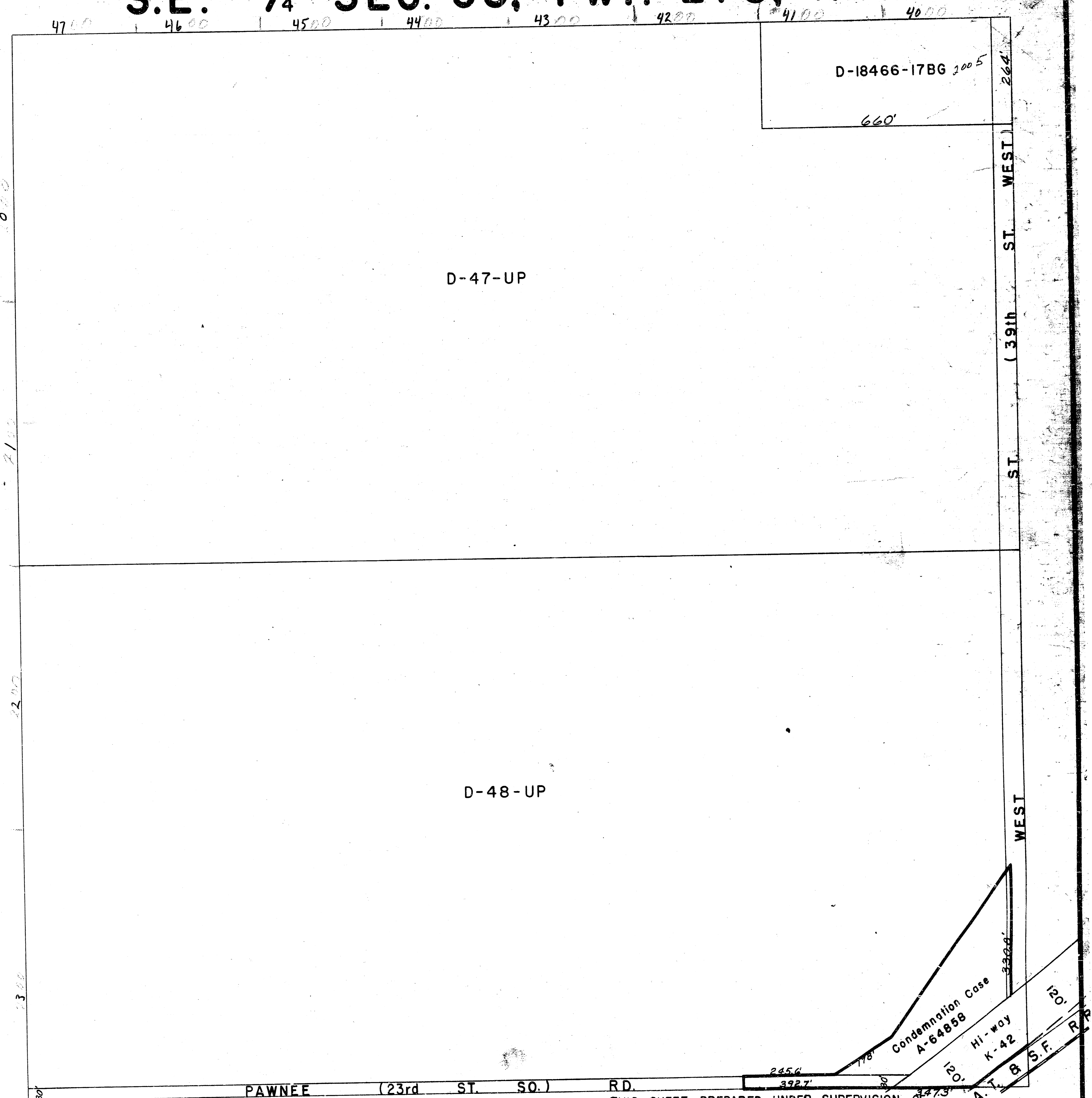

D-18466-17BG 2005

D-47-UP

D-48-UP

PAWNEE (23rd ST. SO.) RD.

ST. WEST (39th ST. WEST)

Condemnation Case A-64858

Hi-way K-42

120' 120' 120' A.T. & S.F. RR

THIS SHEET PREPARED UNDER SUPERVISION OF MARIE WARDEN, SEDGWICK COUNTY CLERK