

S.M. 123.05 U.S. Eng. Monument, NW cor. Central & Hoover

Grade north parking to match existing elevation @ prop. line

Use typical pavement section between stations 0+35 and 1+30.5. Widen section and warp to match existing pavement @ 100 to 0+35. Standard reinforced integral curb to use on this project. Warp std curb to match existing state curb @ 0+50.

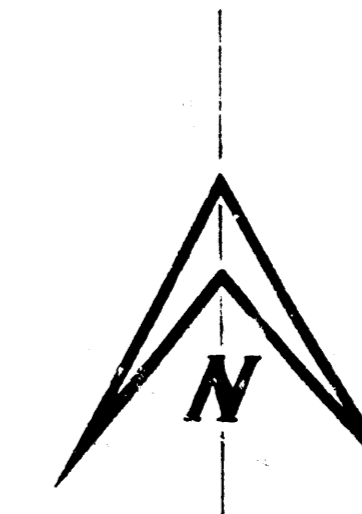
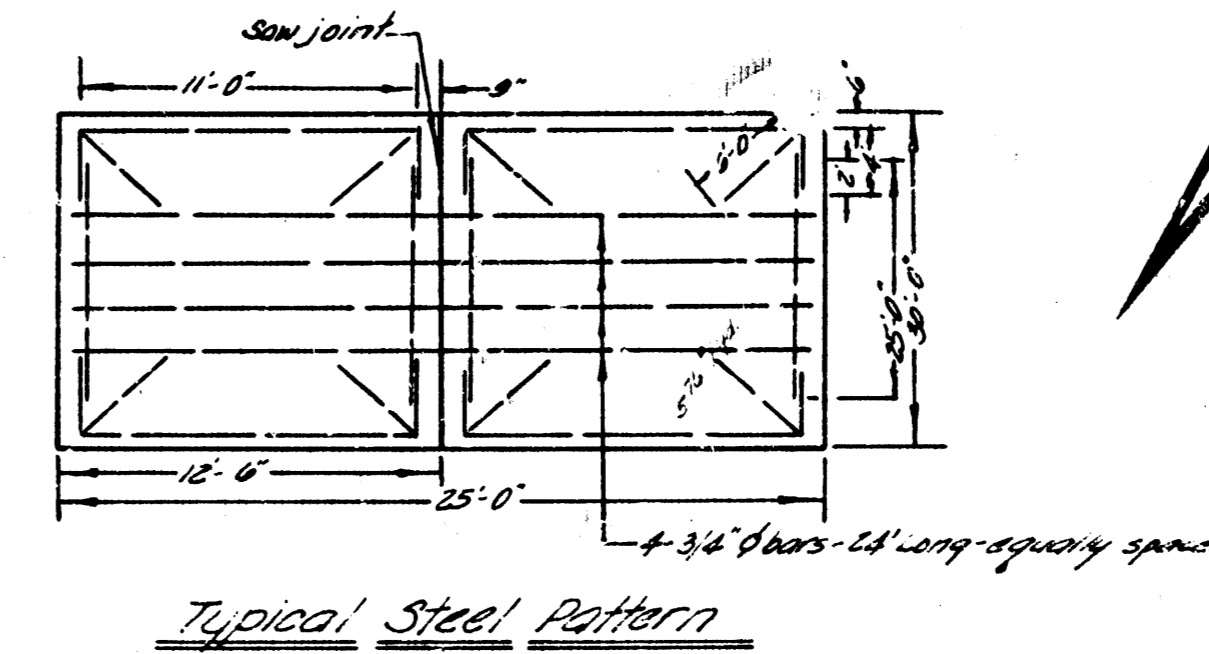

Excavation	Comp. Fill
67.3	1.0
67.1	0.1
730.4	1.1

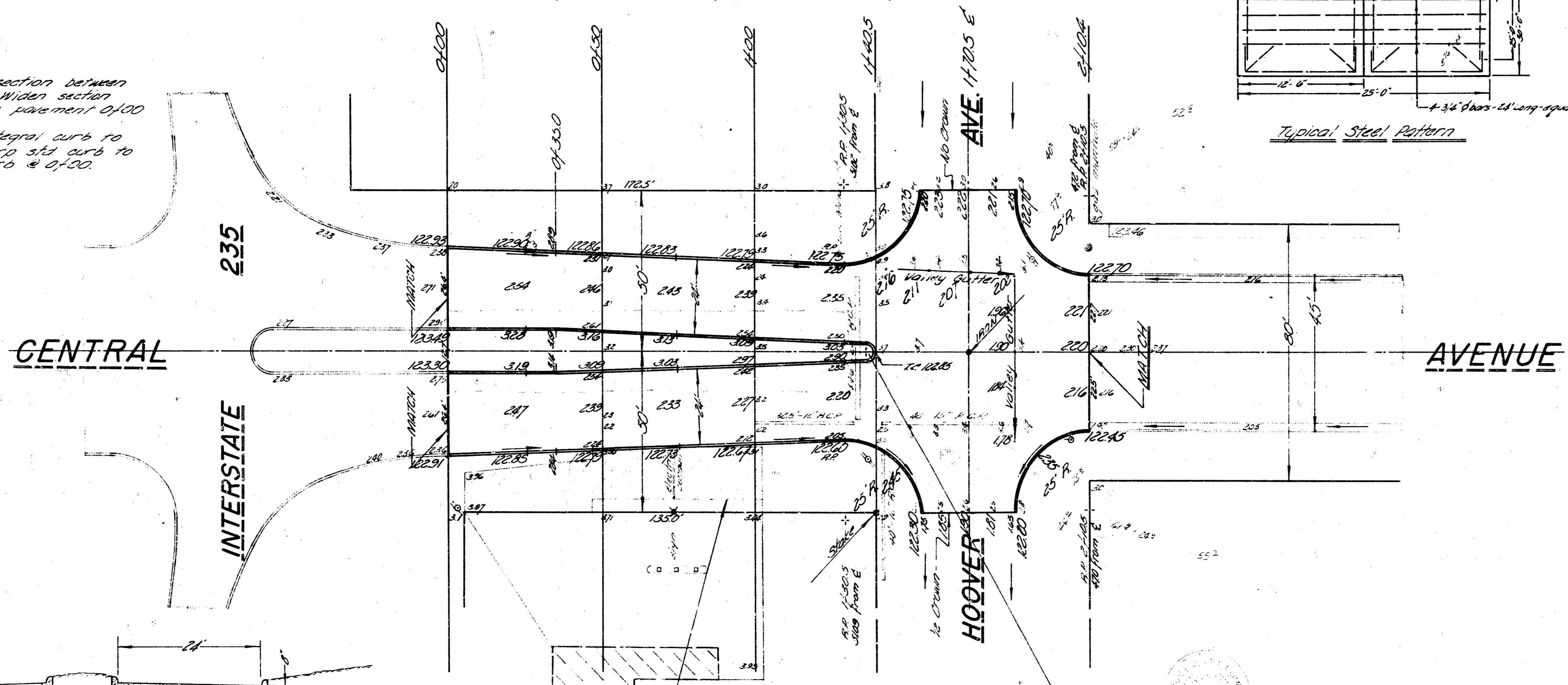
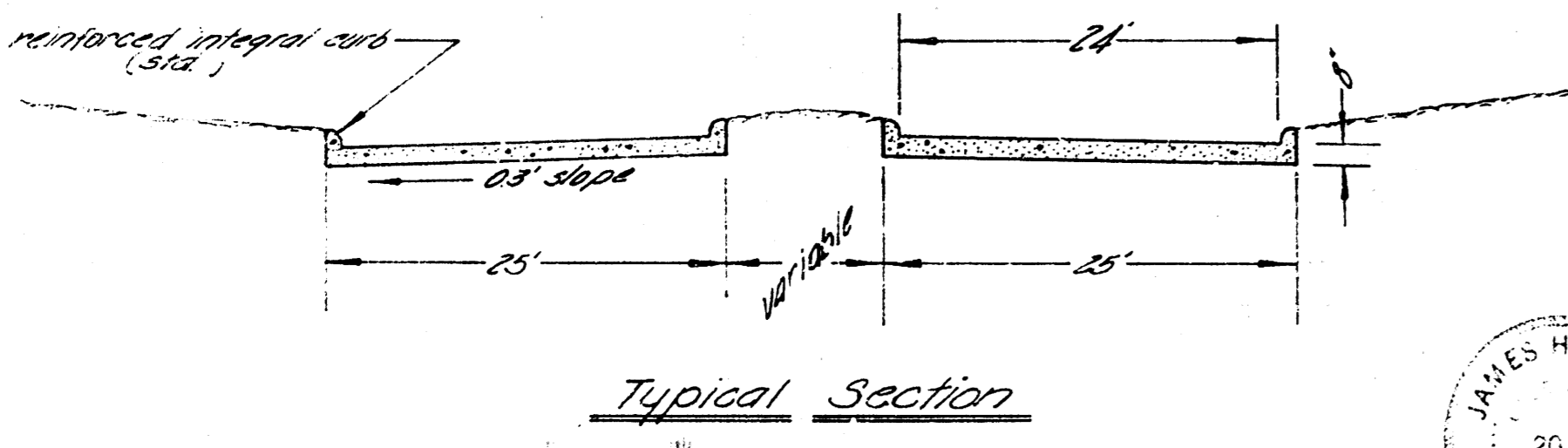

NOTE: Field engineer shall determine if this section of walk needs to be replaced.

175' radius on end of 6' track on R.P. 1+32.75

CENTRAL AVENUE			
210' W. OF E.L. HOOVER TO E.L. HOOVER			
2 - 24' SLABS & CURB			
THICKNESS OF CONCRETE = 8"			
CITY OF WICHITA, KANSAS			
DATE: SEPT. 1961	SURVEY BY: C.H. MILLS	DESIGN BY: J. JONES	PROJECT: C 11 - 40

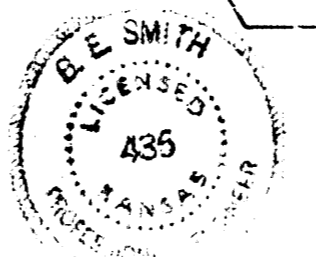

Curb 1/2" wider