

BLAKE ST.

E.L. MILLWOOD AVE. TO & INCLUDING CUL-DE-SAC

CITY OF WICHITA, KANSAS

M.E. LINDEBAK CITY ENGINEER

DATE:

PROJ. NO. 472 76 245 81147 000 000 001

GENERAL NOTES

1. NO MORE THAN THREE THOUSAND SIX HUNDRED TEN (3610) SQUARE FEET OF DRIVEWAY TO BE CONSTRUCTED AS A PART OF THIS PROJECT.
2. DRIVEWAY REMOVE BEHIND THE RIGHT-OF-WAY LINE. AS SHOWN BY THE PLANS, SHALL BE CHARGED TO THE PROJECT'S BENEFIT DISTRICT. ANY WORK BEHIND THE RIGHT-OF-WAY LINE SHALL BE AUTHORIZED ON A PROPERLY EXECUTED DRIVEWAY REQUEST FORM.

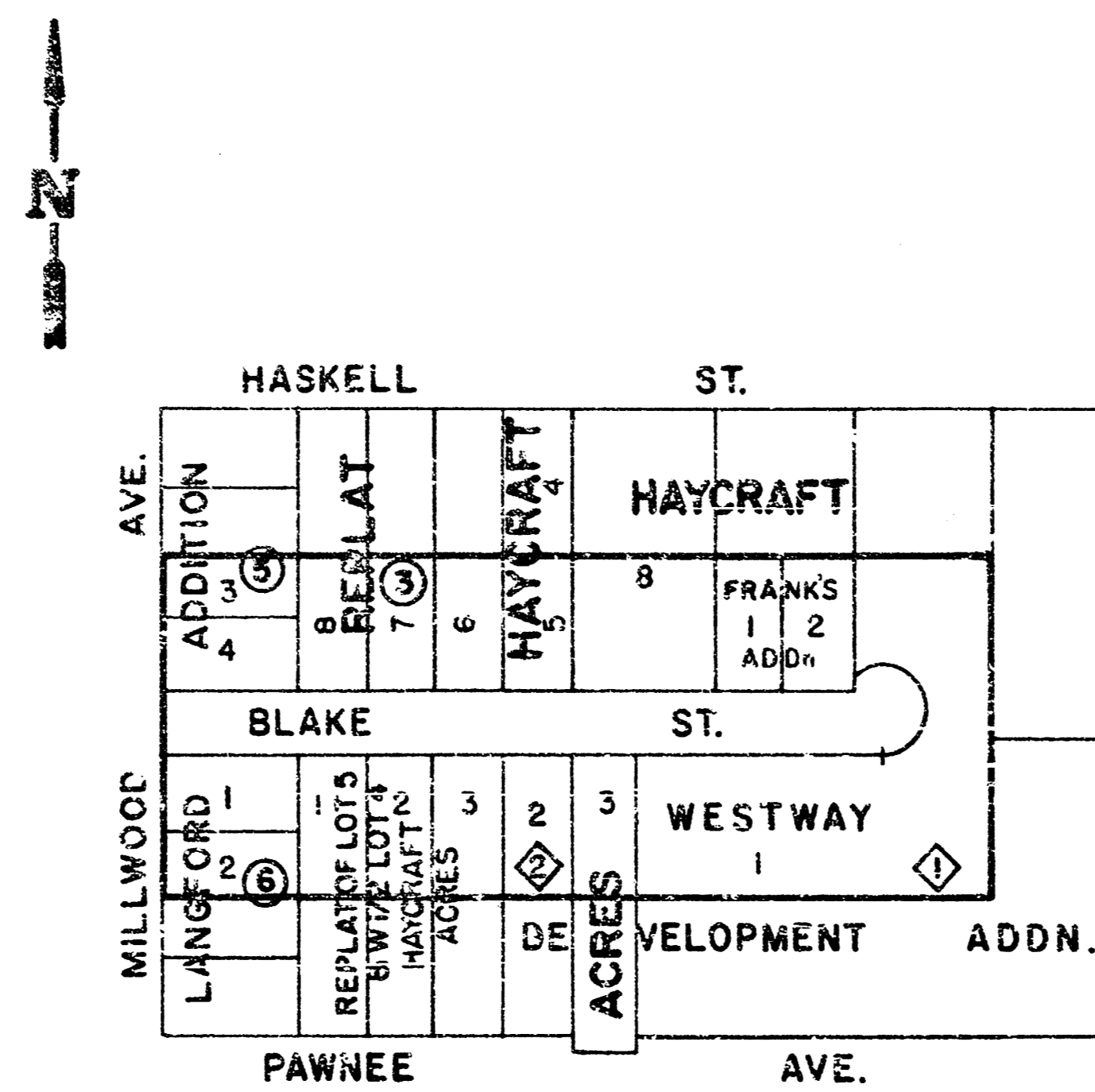

LOCATION MAP
SCALE: 1" = 150'

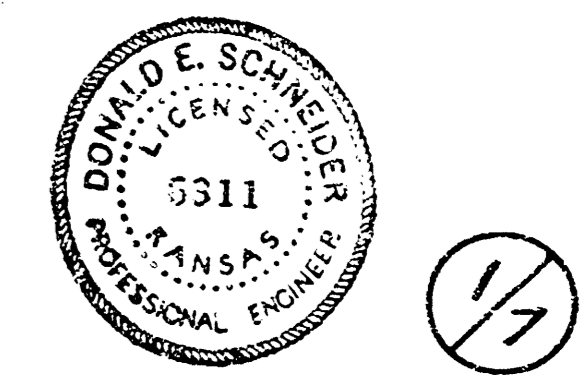

PROJECT DESCRIPTION		
BLAKE ST.		
E.L. MILLWOOD TO & INCLUDING CUL-DE-SAC		
PROJECT NUMBER		
472 76 245 81147 000 000 001		
BOOK NO. MPG 19	APPROVED BY	DATE
DRAWN BY		REVISED
CITY OF WICHITA		
DEPARTMENT OF ENGINEERING		
M.E. LINDEBAK	CITY ENGINEER	SCALE

TYPICAL 31' PAVEMENT DETAILS

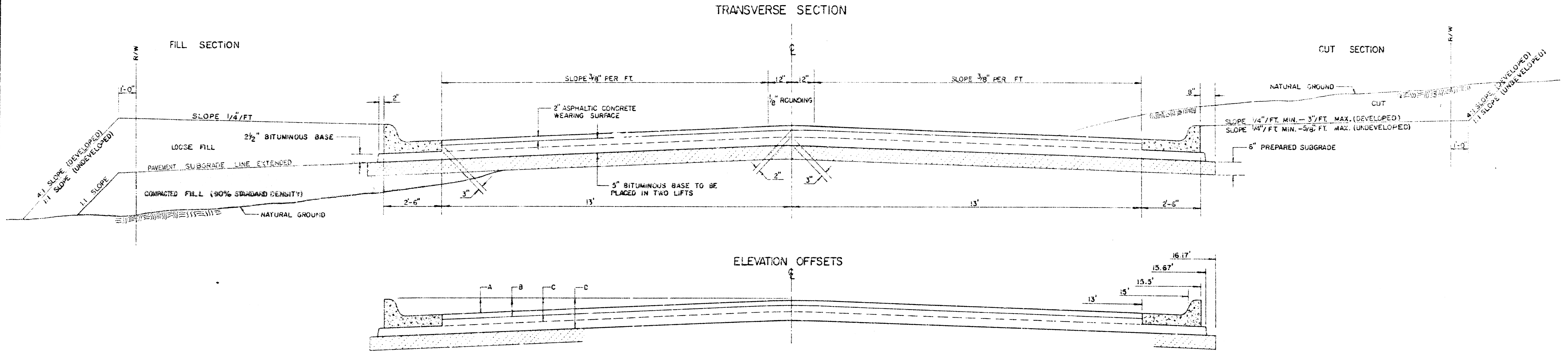

	DISTANCE FROM CENTERLINE (L.T. & RT.)											
	0'	2'	4'	6'	7.5'	10'	12'	13'	15'	15.5'	15.67'	16.17'
A: TOP OF CURBS TO TOP OF SURFACE LIFT	0.10	0.14	0.21	0.27	0.32	0.39	0.46	0.49	—	—	—	—
B: TOP OF CURBS TO TOP OF UPPER BASE LIFT	0.27	0.31	0.38	0.44	0.49	0.56	0.63	0.66	—	—	—	—
C: TOP OF CURBS TO TOP OF LOWER BASE LIFT	0.44	0.49	0.57	0.64	0.70	0.79	0.87	0.90	0.98	1.00	1.00	—
D: TOP OF CURBS TO TOP OF SUBGRADE	0.69	0.73	0.80	0.87	0.93	1.01	1.08	1.12	1.19	1.21	1.21	1.23

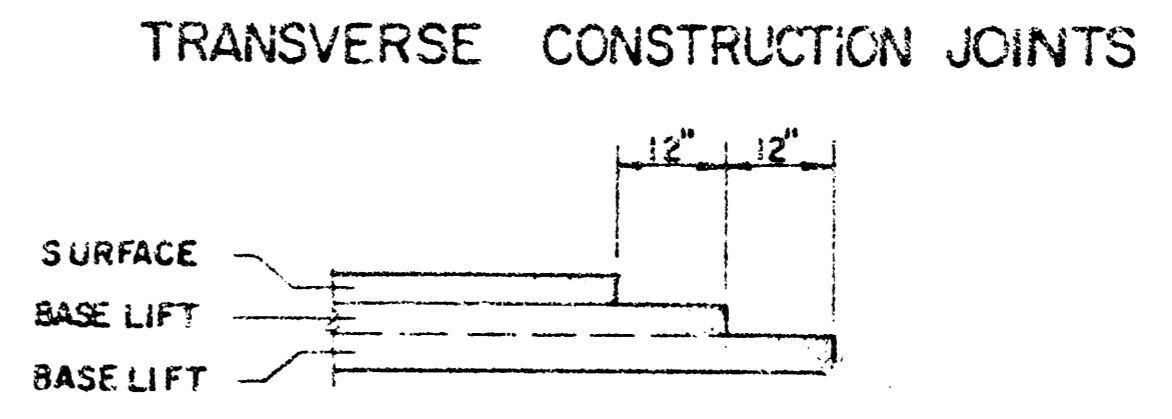
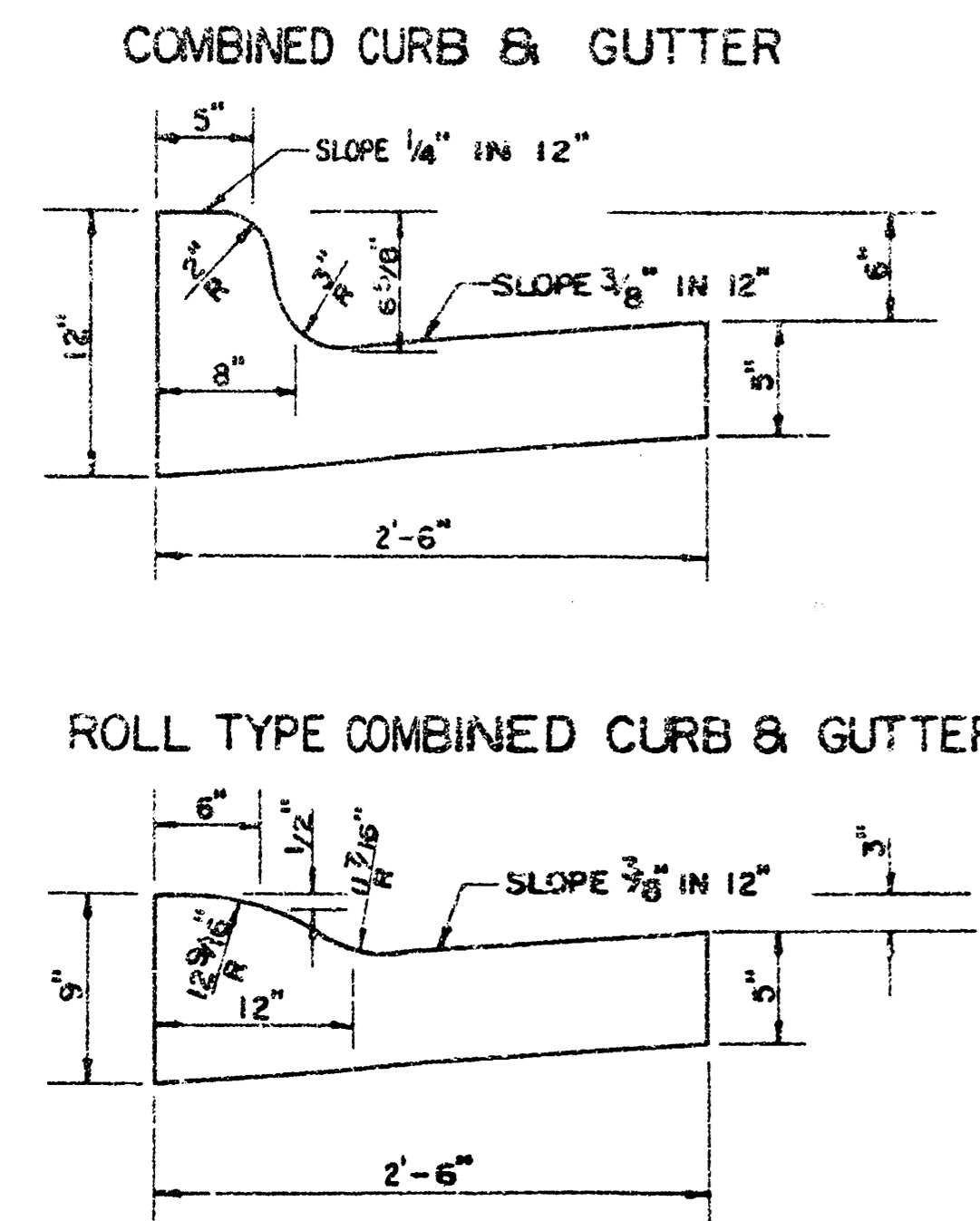

GENERAL NOTES

- 1) THE ASPHALTIC CONCRETE PAVEMENT BETWEEN THE COMBINED CURB AND GUTTER SHALL BE PAID AS SQUARE YARDS OF 7" ASPHALTIC CONCRETE (5" BITUMINOUS BASE).
- 2) THE BITUMINOUS BASE UNDER AND BEHIND THE COMBINED CURB AND GUTTER SHALL BE PAID AS SQUARE YARDS OF 2 1/2" BITUMINOUS BASE.
- 3) A TACK COAT OF EMULSIFIED ASPHALT (SC-1H OR CSS-1H) SHALL BE APPLIED AT AN APPROXIMATE RATE OF 0.05 GALLONS PER SQUARE YARD BETWEEN EACH LIFT OF ASPHALTIC MATERIAL.
- 4) BITUMINOUS BASE AND ASPHALTIC CONCRETE WEARING SURFACE SHALL BE PLACED WITH A LAYDOWN MACHINE HAVING AUTOMATIC CONTROLS FOR LINE AND GRADE.
- 5) CONSTRUCTION JOINTS IN EACH LIFT SHALL BE STAGGERED A MINIMUM DISTANCE OF ONE (1) FOOT FROM JOINTS IN PRECEDING LIFTS AND PLACED SO THAT A JOINT WILL BE CONSTRUCTED ON THE CENTERLINE OF THE TOP LIFT.
- 6) CONTRACTOR TO BID ONLY ONE SUBGRADE TREATMENT ALTERNATE WHEN ALTERNATE ARE PROVIDED IN THE PROPOSAL AND CONTRACT. THE ALTERNATE CHOSEN BY THE SUCCESSFUL BIDDER SHALL BE USED IN CONSTRUCTING THIS PROJECT.

2/7

7 INCH RESIDENTIAL ASPHALTIC CONCRETE
PAVEMENT WITH 5 INCH BITUMINOUS BASE
CITY OF WICHITA, KANSAS
PROJECT NUMBER
472 76 245 81147 000 030 001

B.M. 102.78 S.E. Cor. Conc. Porch 1422 Blake
 B.M. 101.795 In Walk In Front of Apt. #214, Bldg. 2 of Westway Apts.
 B.M. 102.99 S.W. Cor. Conc. Step, House #1518 Blake

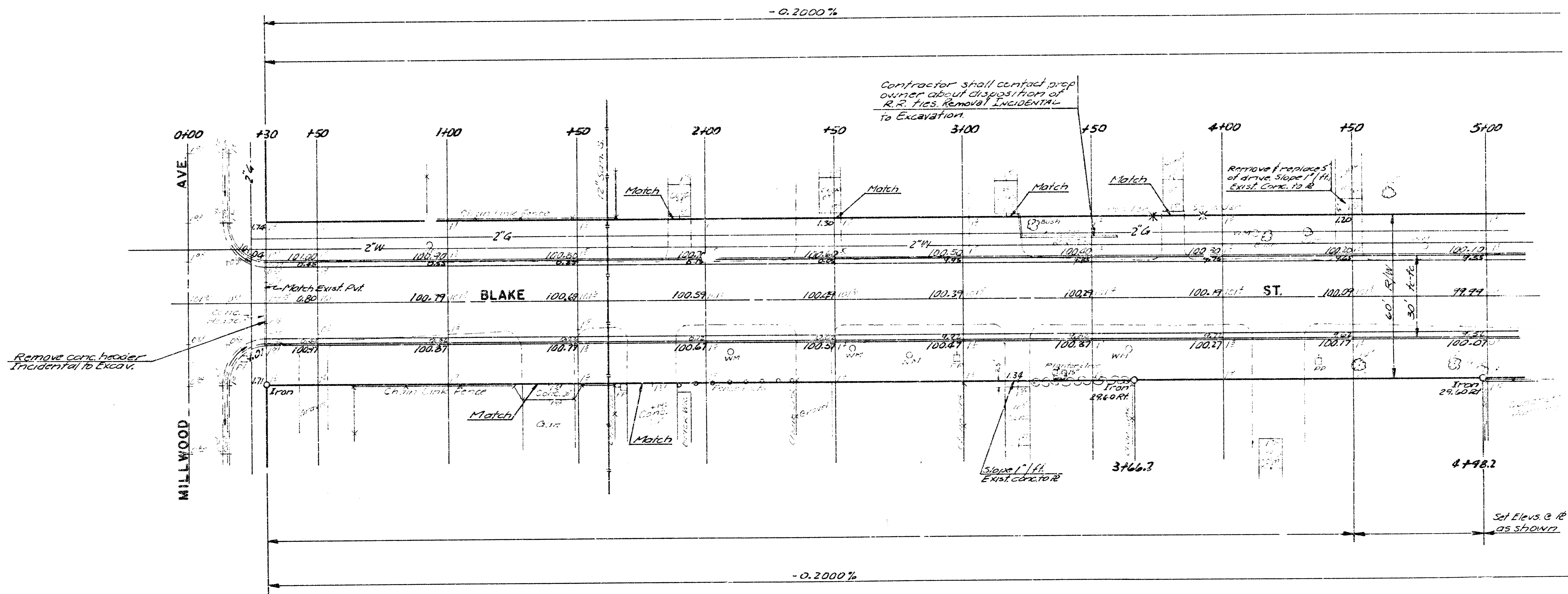
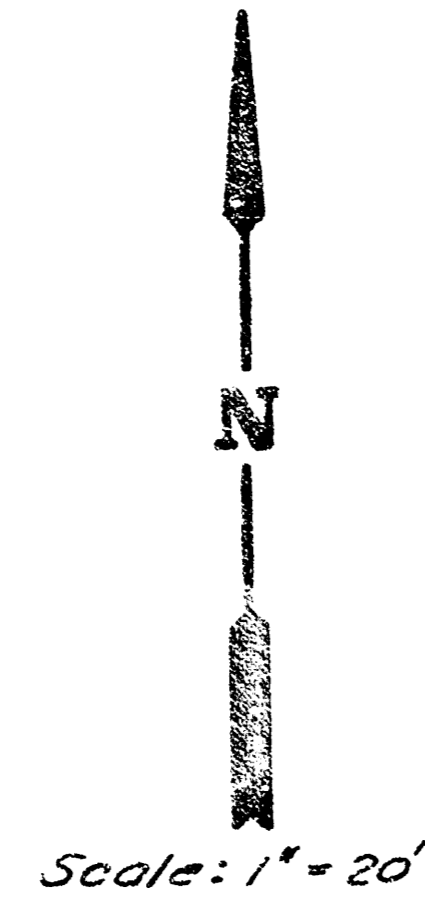

THE CONTRACTOR SHALL BE RESPONSIBLE FOR PRESERVING PROPERTY IRONS. THE CONTRACTOR SHALL BE REQUIRED TO RE-ESTABLISH ANY PROPERTY IRONS WHICH ARE DAMAGED OR DESTROYED BY HIS CONSTRUCTION OPERATIONS. SUCH IRONS SHALL BE RE-ESTABLISHED BY A LICENSED LAND SURVEYOR OR A LICENSED PROFESSIONAL ENGINEER IN ACCORDANCE WITH STATE LAWS.

Earthwork
 Excav
 2165.3 C.Y.
 +10% 216.5
 Total 2381.8 C.Y.

Manipulation 2762.5 S.Y.

3/7

PROJECT DESCRIPTION		
BLAKE ST.		
E.L. MILLWOOD TO & INCLUDING CUL-DE-SAC		
PROJECT NUMBER		
472 76 245 81147 000 000001		
BOOK NO. WPG 12	APPROVED BY	DATE
DRAWN BY		REVISED
CITY OF WICHITA		
DEPARTMENT OF ENGINEERING		
M.E. LINDEB	CITY ENGINEER	SCALE

3/7

B
C = 73.2' 0"
E = 21.6'

C
71.8
AVG 50.3 C.V.

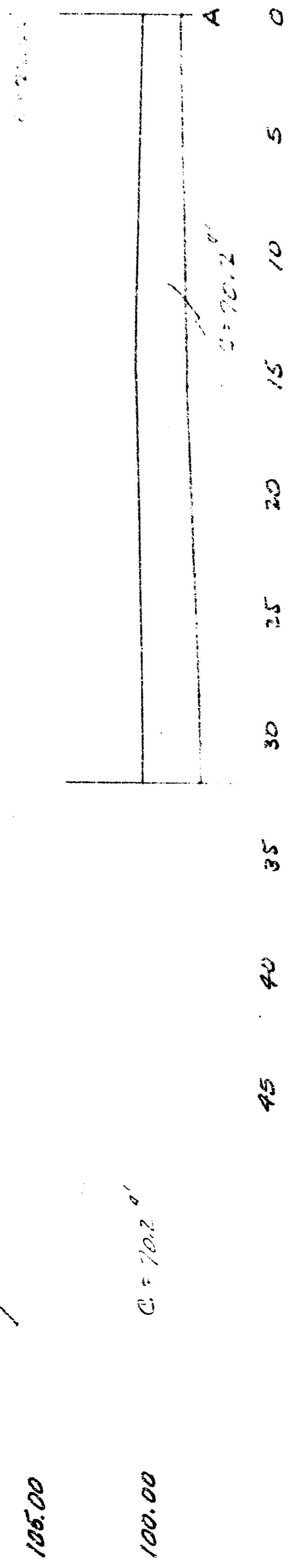

NOTE: FOR BALANCING PURPOSES - ALL EXISTING AND PROPOSED CURVES ARE TO BE TANGENT TO EACH OTHER AT THE CENTER OF GRAVITY - SEE TO 5.67 BEHIND PAGE 10.

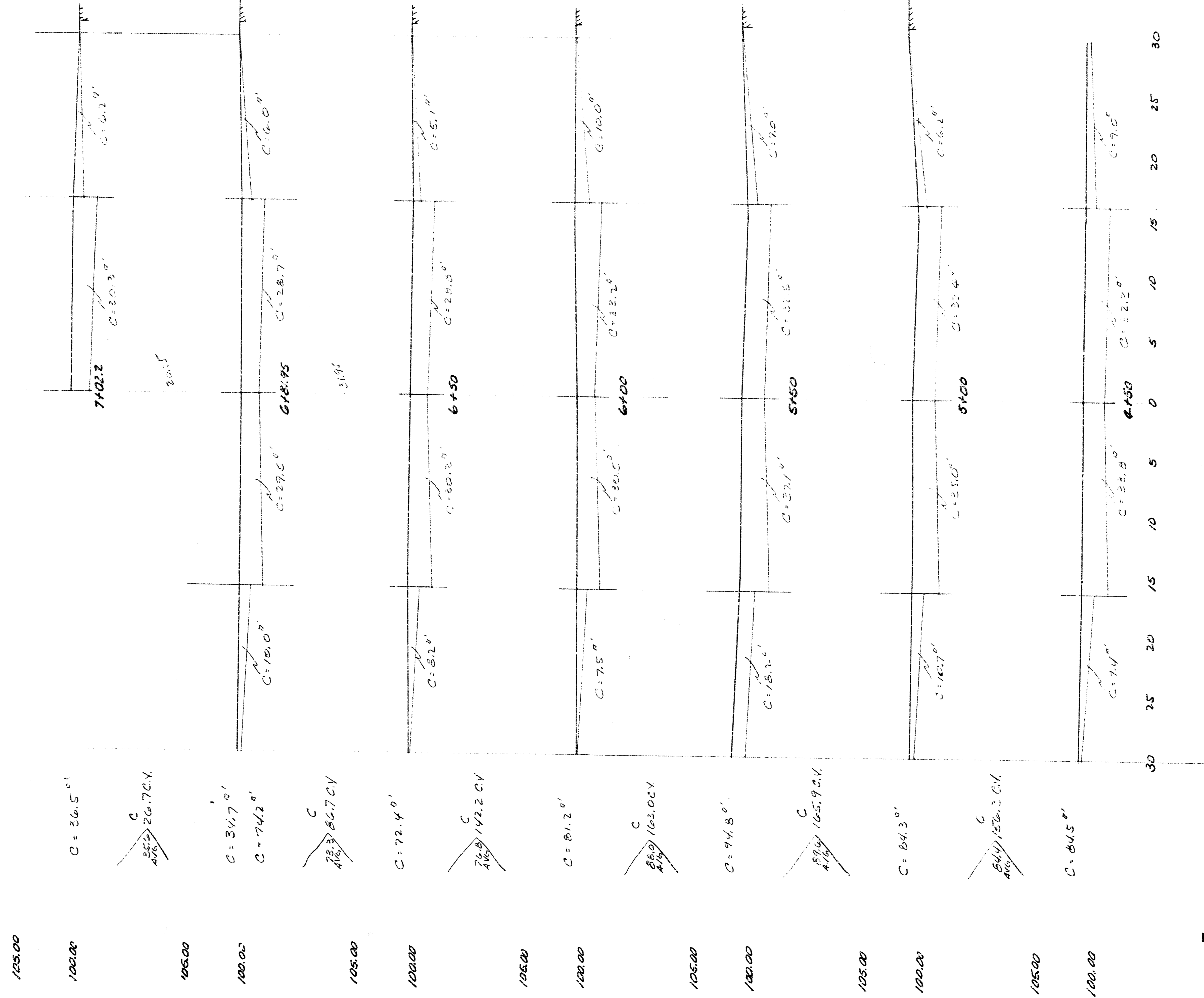

BLAKE ST.
E.L. MILLWOOD TO & INCLUDING CUL-DE-SAC
472 76 245 81147 000 000001

