

BLECKLEY DRIVE
N.L. ARLENE - S.L. 24th ST. NO.
DAKS559097

TYPICAL SECTIONS of 30' ASPHALTIC CONCRETE PAVEMENT

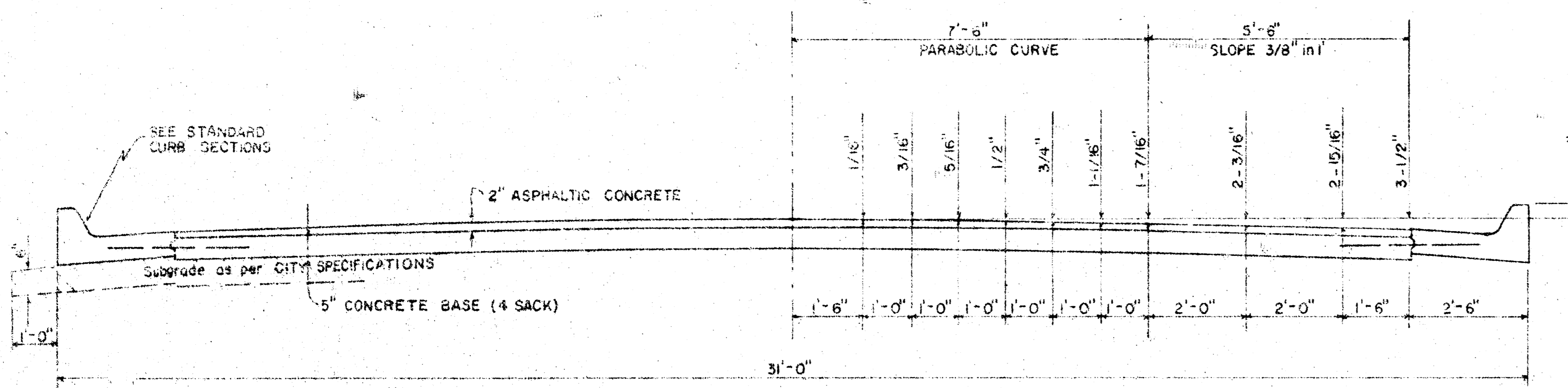

TYPICAL SECTION WITH STANDARD CROWN

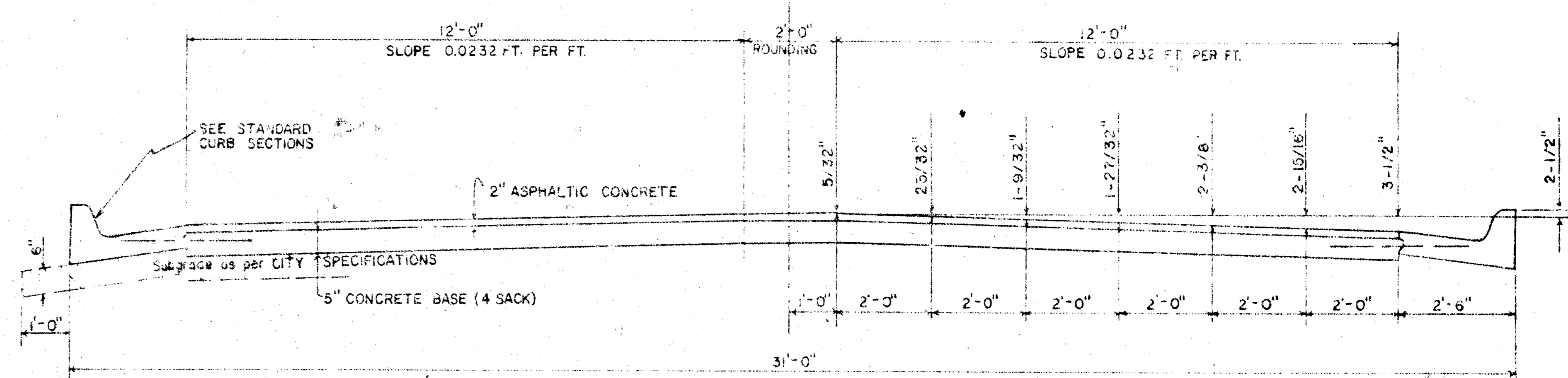

TYPICAL SECTION WITH ALTERNATE CROWN

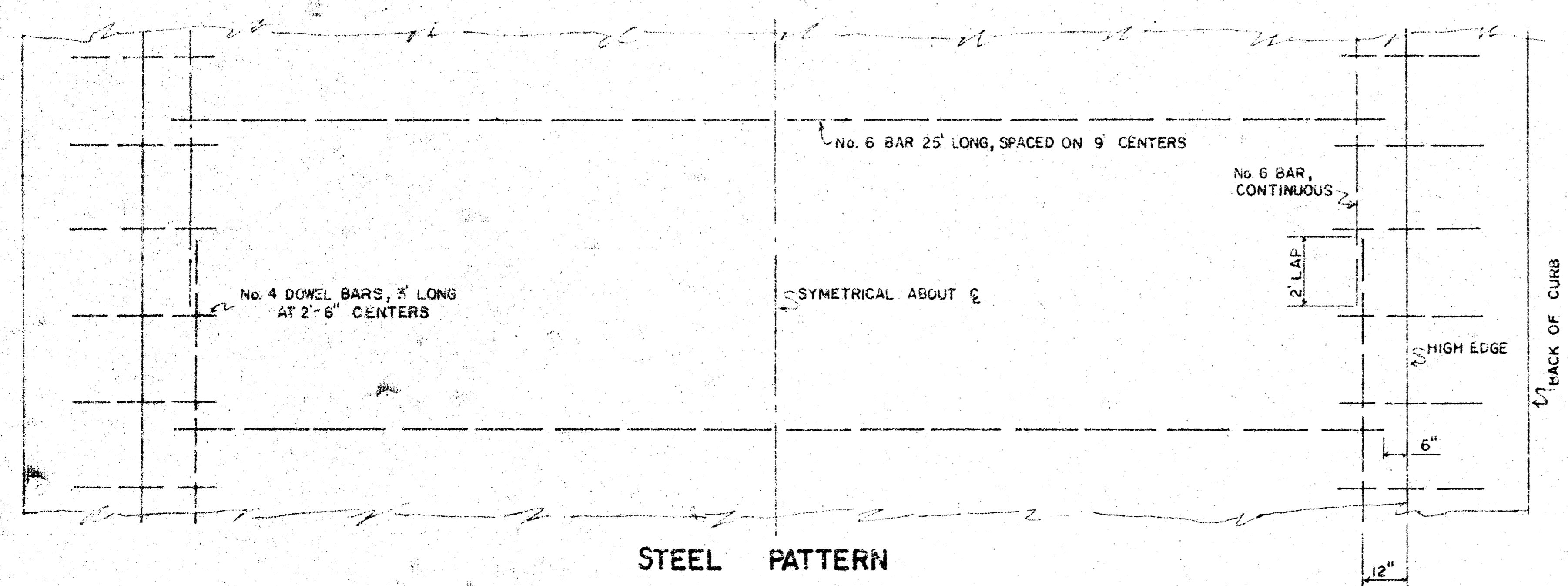

STEEL PATTERN

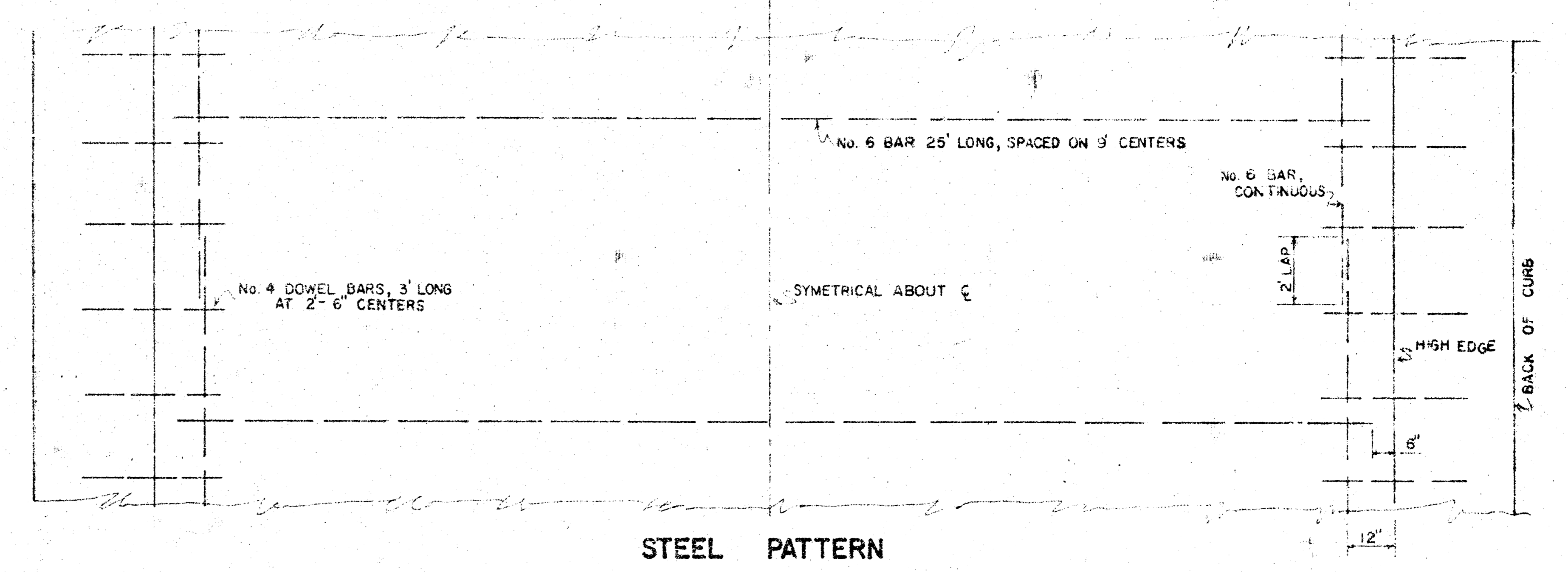

STEEL PATTERN

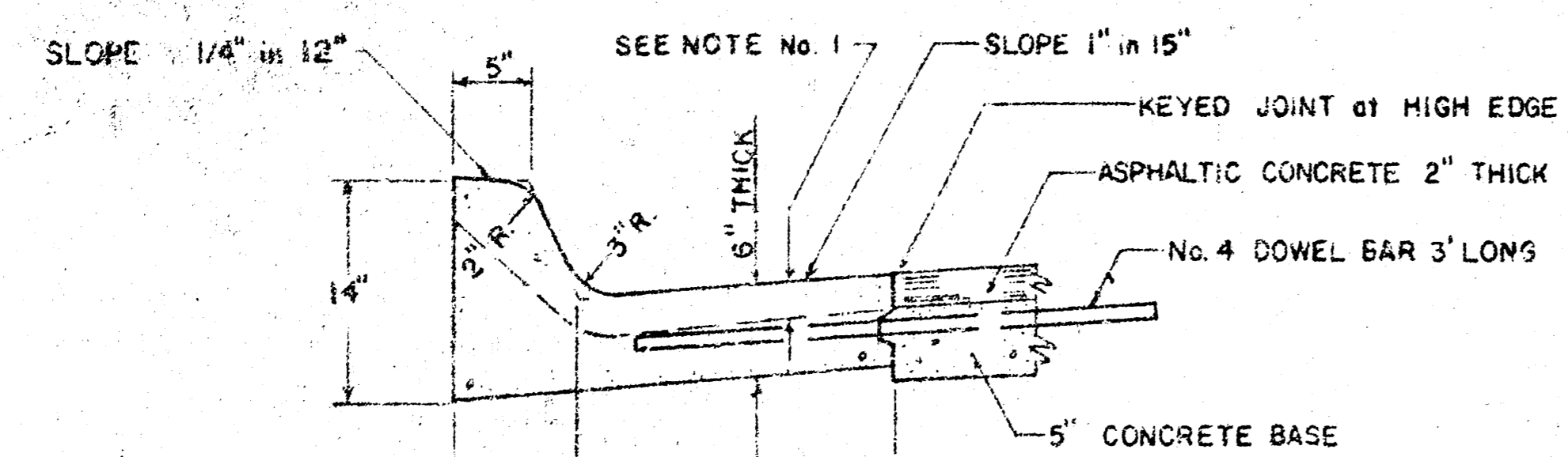

STANDARD SECTION OF COMBINED CURB & GUTTER

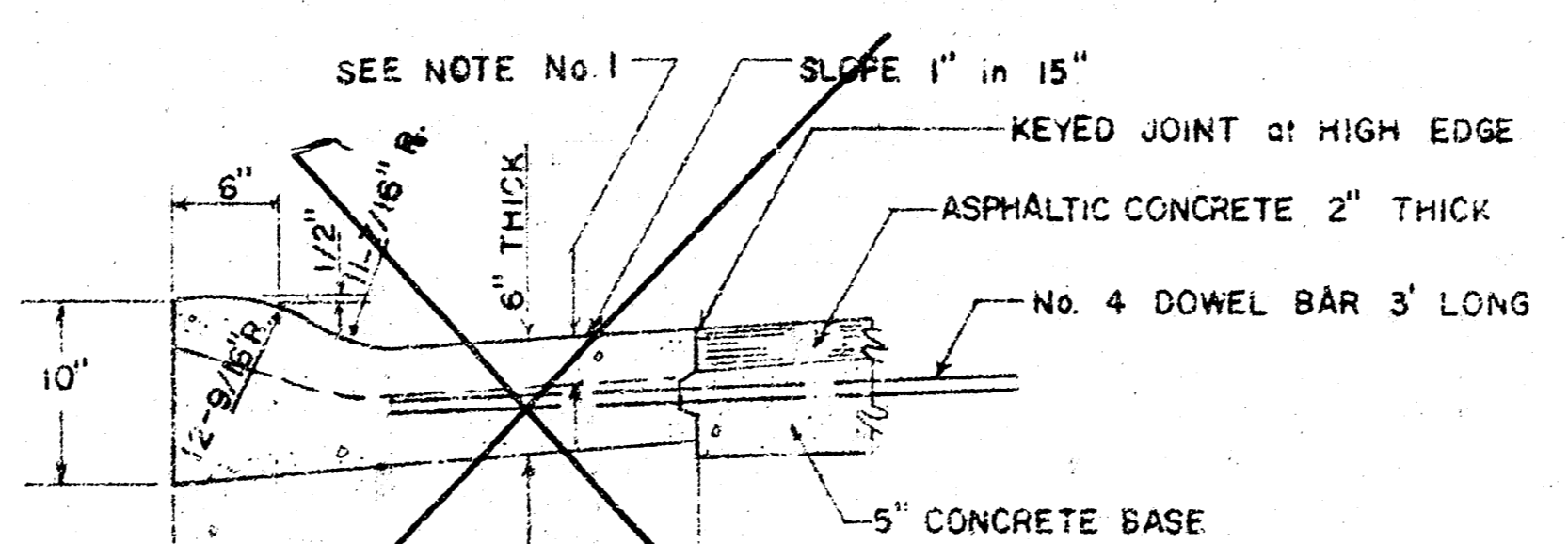

STANDARD SECTION OF ROLL-TYPE CURB & GUTTER

GENERAL NOTES
 1. CONTRACTION JOINTS MAY BE CONSTRUCTED IN COMBINED CURB AND GUTTER BY SAWING WITH AN APPROVED CONCRETE SAW. THE SAW CUT SHALL EXTEND 2-1/2" BELOW THE SURFACE OF THE GUTTER AND CURB. SAWED CONTRACTION JOINTS SHALL HAVE A MAXIMUM SPACING OF 10' AND BE FILLED WITH A SPECIFIED JOINT FILLER, SUCH THAT THE JOINT IN THE GUTTER SECTION WILL BE COMPLETELY FILLED.



CITY OF WICHITA, KANSAS
 Department of Public Works - Engineering Division
 R. W. Linn City Engineer
 Date: *Sept. 1976* Project No. DAKS559097

B.M. 186.37 SW Cor. Conc. Porch Hds. 4914 E. 24th St. N.
 @ - @ Bleckley Dr.

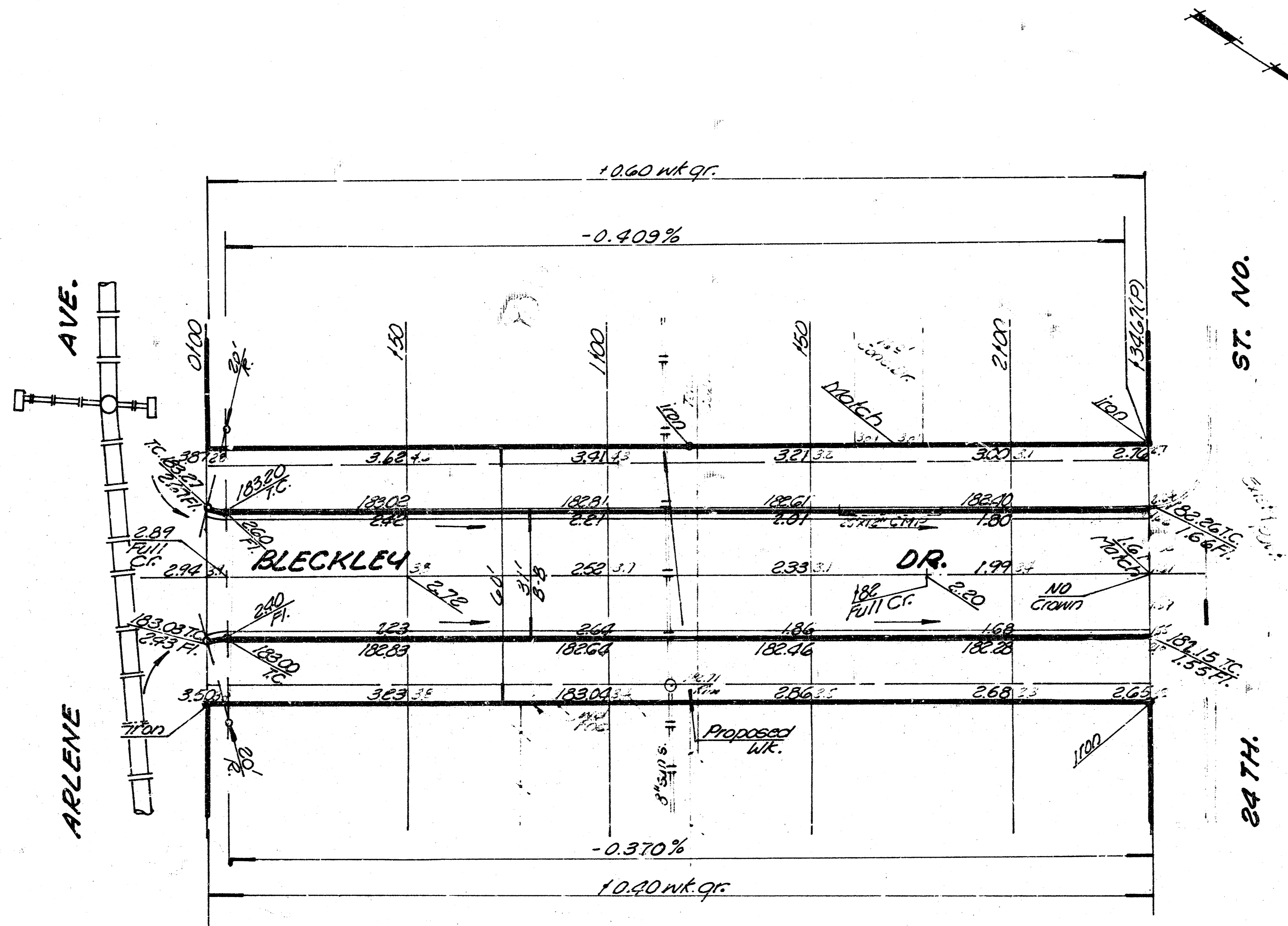

ST. NO.

24 TH.

SUB-GRADE
 TYPE OF SUB-GRADE TREATMENT SHALL BE DETERMINED BY THE FIELD ENGINEER. SUB-GRADE TREATMENT MAY CONSIST OF LIME TREATMENT, CEMENT TREATMENT, SUB-GRADE MODIFICATION, OR ANY COMBINATION OF THESE.

NOTE TO FIELD ENGINEER - CONTRACTOR
 Grade parking and clear right-of-way for proposed sidewalk. Compact fill in sidewalk areas TO BE CONSTRUCTED BY "OTHERS".

CAUTION
UNDERGROUND UTILITIES
 Please check with K & E or Southwestern Bell Telephone Co. for Location

Earthwork

Prop.	Excav.	Fill	City
	333.3	3.3	
110%	334	0.3	
	367.8 c4.	3.6 c4.	

860 34 Manipulation

BLECKLEY DR.
 N.E. Arlene Ave. to St. 24th St. No.
 26'-2'30" Asph. Conc. Pavt.
CITY OF WICHITA, KS.
 R.W. Linn City Engineer
 Date: Sept. 76 Proj. No. DAKS559097

Survey 5/29
 Plans 5/29
 Exp. 5/29
 Checked

FILMED FROM THE BEST AVAILABLE COPY