

B.M. 157.10 - E. Rock Road & Bluestem Lane East
 B.M. 153.70 - City St. Rock Road - Mt. Vernon 32' E. & 42' W. of 1/4 Sec. Line

NOTE: THE CONTRACTOR FOR THIS PROJECT SHALL BE RESPONSIBLE FOR OBTAINING ALL NECESSARY PERMITS AND APPROVALS FROM THE CITY OF WICHITA, KANSAS, AND THE KANSAS DEPARTMENT OF TRANSPORTATION AND HIGHWAYS. THE CONTRACTOR SHALL BE RESPONSIBLE FOR OBTAINING ALL NECESSARY PERMITS AND APPROVALS FROM THE CITY OF WICHITA, KANSAS, AND THE KANSAS DEPARTMENT OF TRANSPORTATION AND HIGHWAYS. THE CONTRACTOR SHALL BE RESPONSIBLE FOR OBTAINING ALL NECESSARY PERMITS AND APPROVALS FROM THE CITY OF WICHITA, KANSAS, AND THE KANSAS DEPARTMENT OF TRANSPORTATION AND HIGHWAYS.

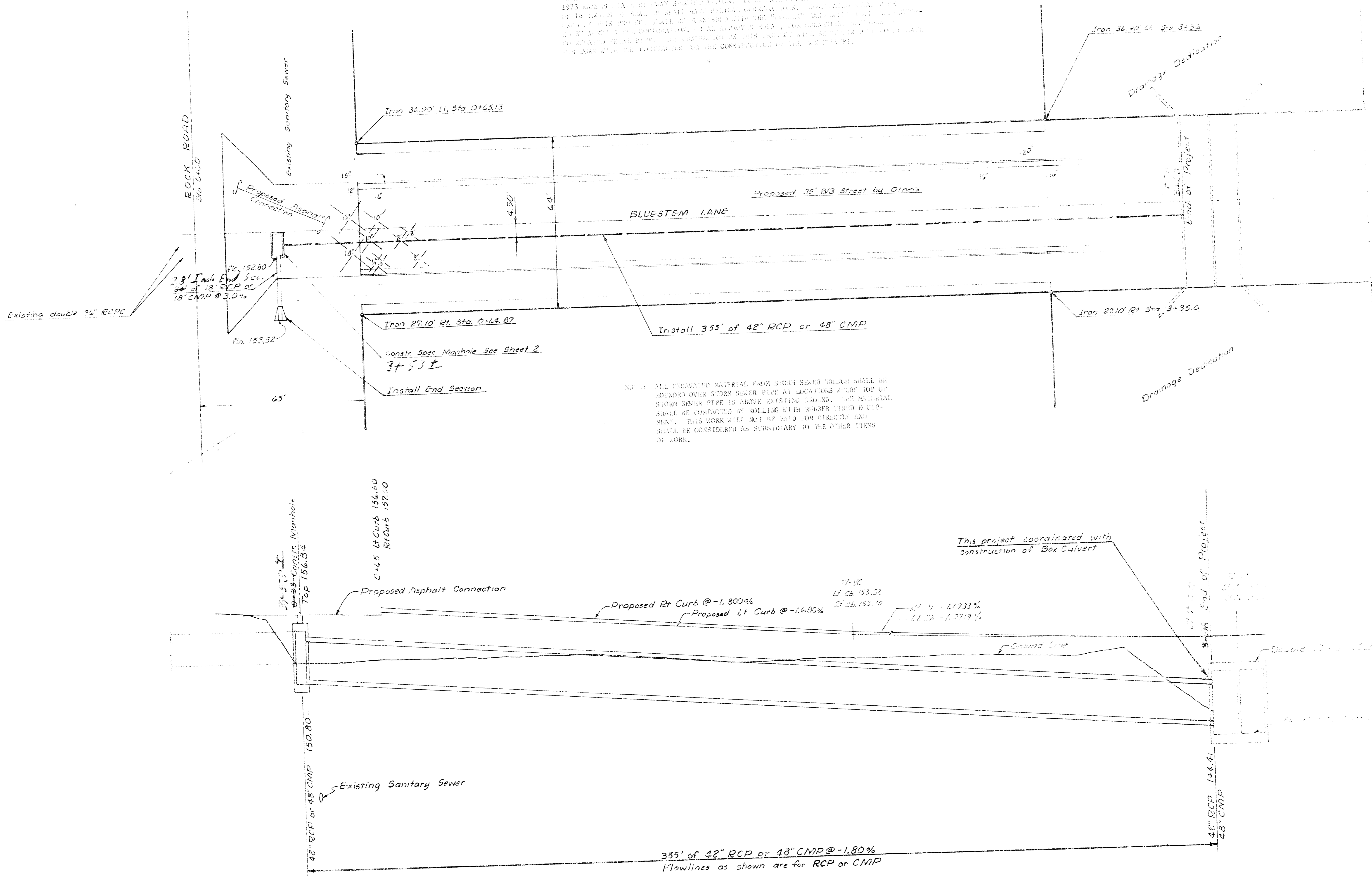

145.10

160
155
150
145
140

145.25

147.75

145.90

4

DRAINAGE IN CONNECTION WITH
 ALIGNMENT OF BLUESTEM LANE
 FROM E. ROCK ROAD TO E. L.
 CEDAR LAKES BLVD. 208' LONG.
 CITY OF WICHITA, KANSAS
 R. W. LINN, CITY ENGINEER
 Project No. DRKO 073071
 DATE _____

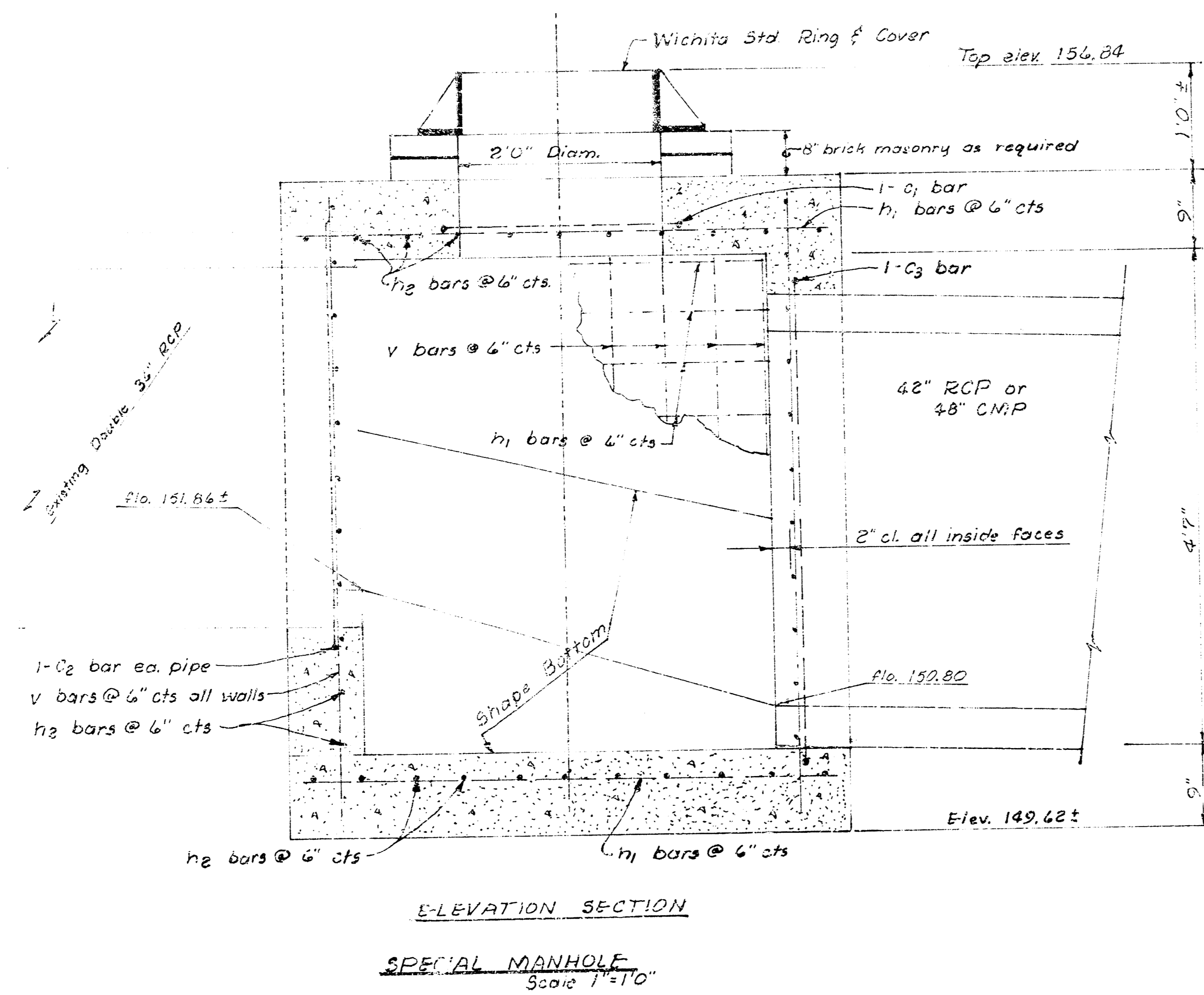
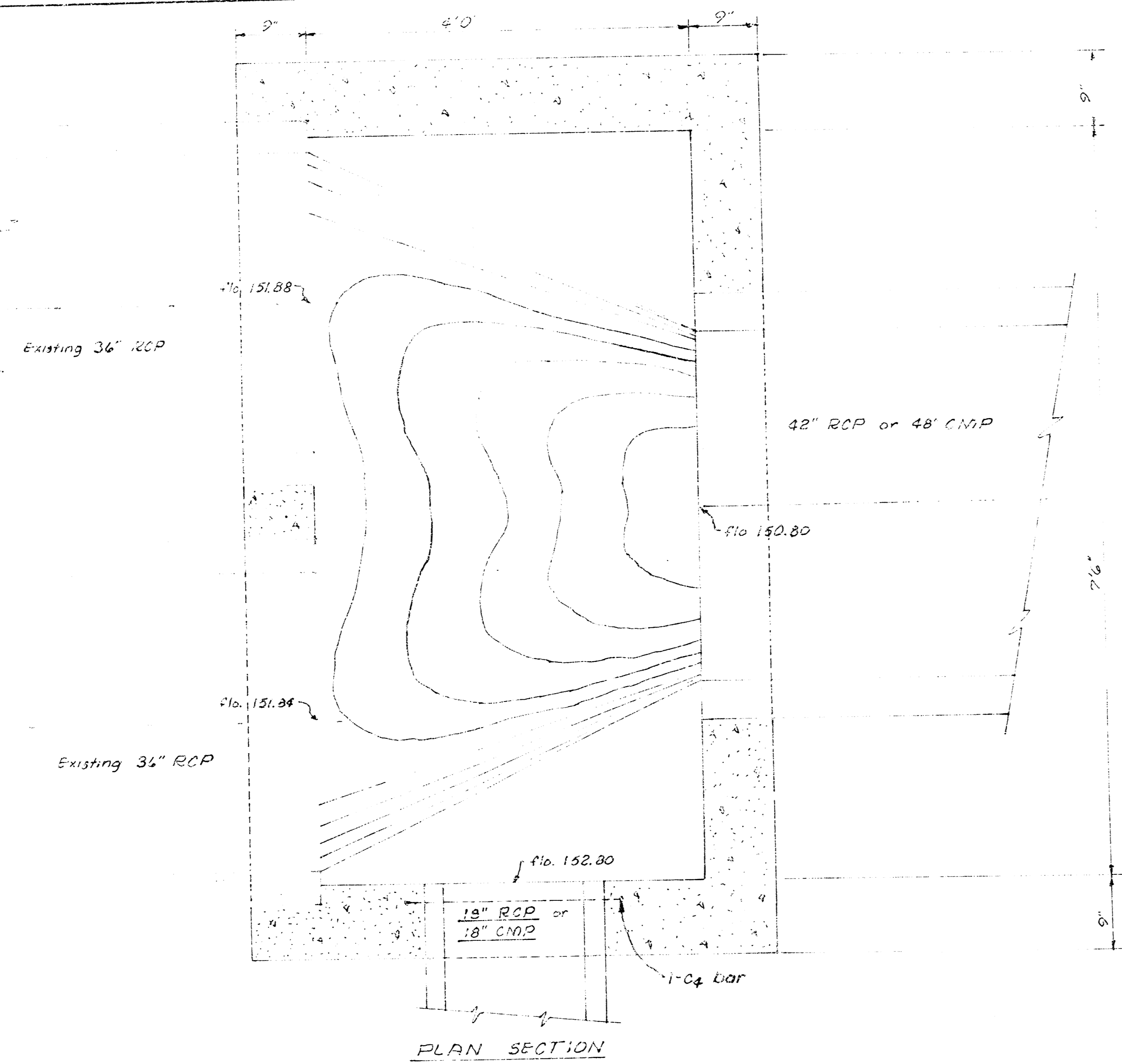

REBAR SCHEDULE

Type	Size	Number	Length	Diameter	Weight
V	#4	54	5'2"	-	307 lbs
h1	#4	58	5'2"	-	300
h2	#4	44	6'6"	-	250
01	#4	1	3'0"	2'4"	6
02	#4	2	14'1"	3'0"	19
03	#4	1	15'11"	4'7"	11
04	#4	1	8'7"	2'3"	6

Concrete: 4.05 C.Y. (Does not include shape bottom)
 Rebars: 699 lbs.
 NOTE: Cut bars to clear pipes & opening by 2"

