

B.M. 53.73 R.R. Spike S.S. N.P. SE 27th & Bluff Ave.
 S.M. 123.17 Thin Gray Fine Sand S.W. 28th & Bluff.
 Stationing from South to North along A. Bluff Ave.

SCALE 1"=20'

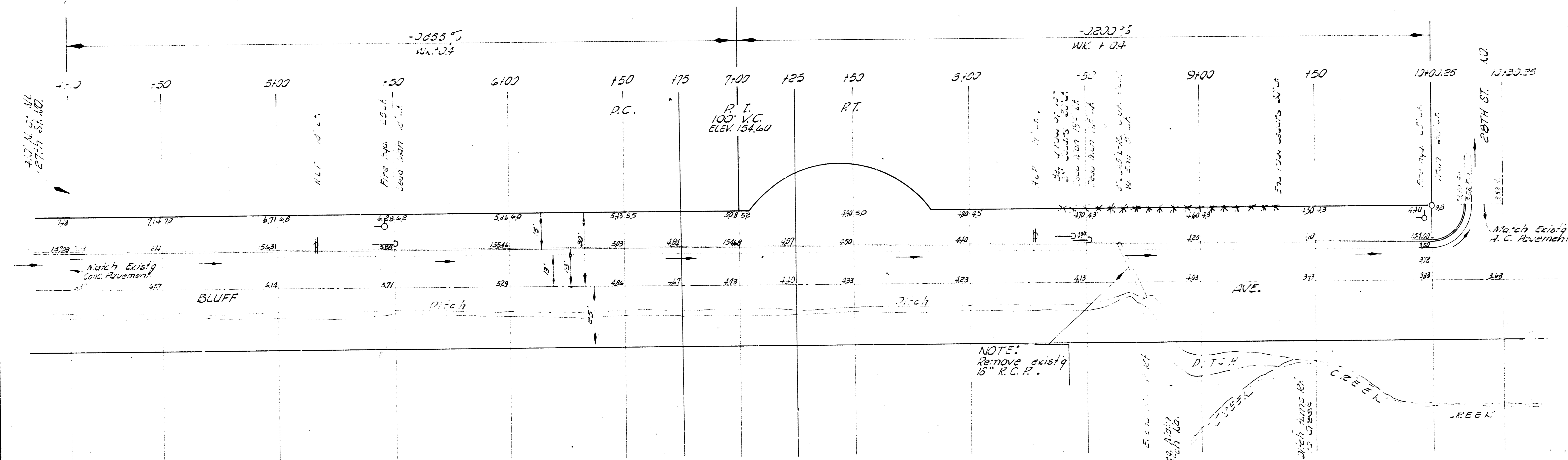

NOTE TO FIELD ENGINEER:
 Re A-sec. from Sta 4+10 to
 Sta. 2+50 before construction.

EXCAVATION	
CITY	PROP
98.9	437.3
13.9	45.7
218.8	503.0

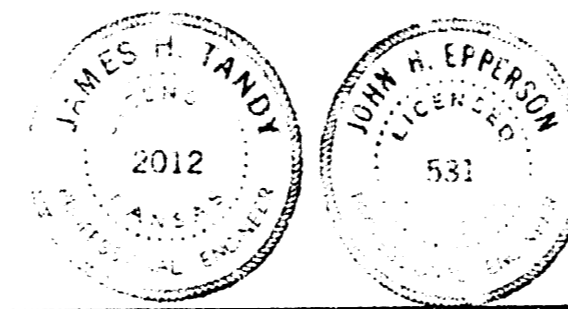

BLUFF AVE.
 40' W. of W. 27th St. to E. 28th St. W.
 13-2-15 A.C. West Side
 CITY OF WICHITA, KANSAS
 B E SMITH CITY ENGINEER
 SEPT. 1958, PROJ. NO. C18-27

1/3