

B.M. 163.3 R.R. Spike S.S. H.P. SE 27th & Bluff.  
 Base = e Bluff Ave. North of 27th St.

1" = 50'

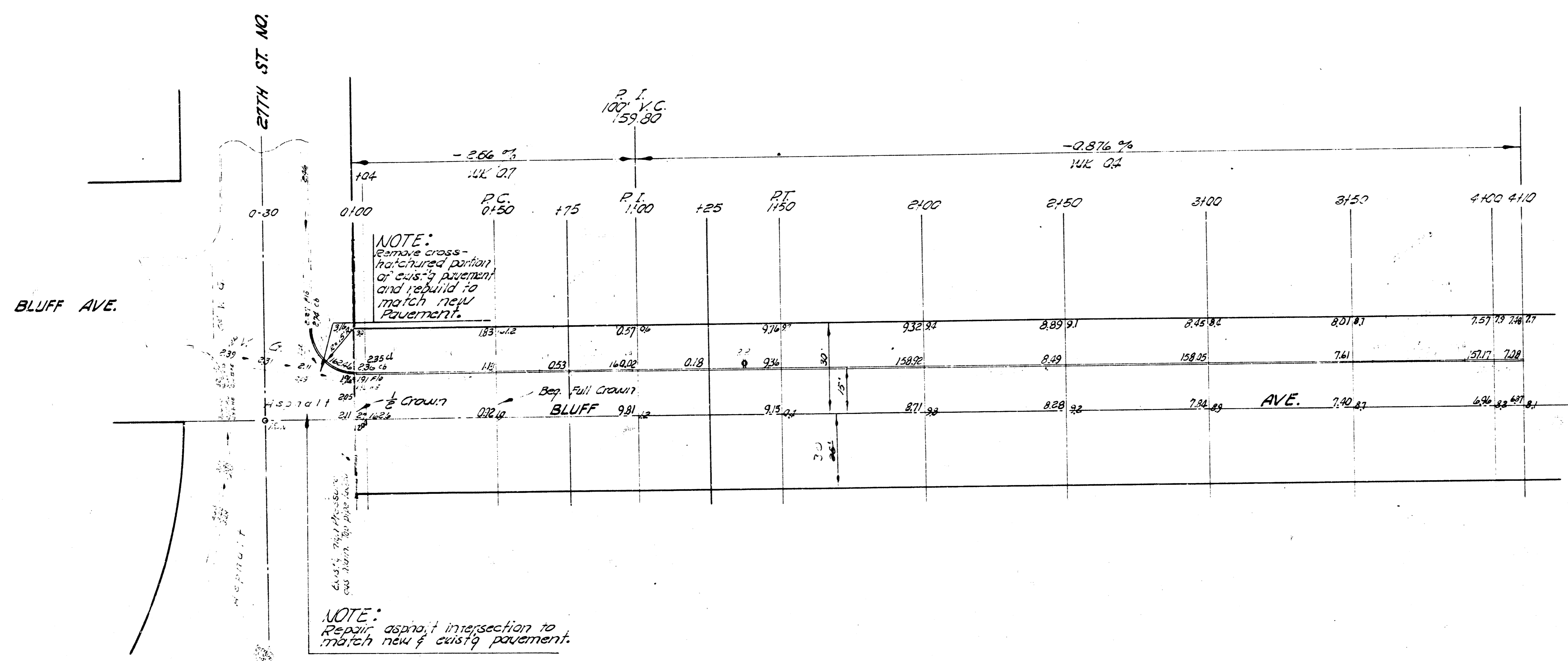

ESTIMATED QUANTITIES	
715	Sq Yds & Conc. Pavt
435	Lin. Ft. Rein. int. cb
2175	lbs. Rein. Steel
595	Sq. Yds. Excavation
10	Sq. Yds. Pavt. removal
5	Tons Asphalt
25	Tons sand, Re-surfacing

**NOTE:**  
 No drive-way quantities  
 estimated.

**BLUFF AVE.**  
 NL 27TH ST. TO 410' N. OF NL 27TH  
 15' CONC. & CB WEST SIDE  
 CITY OF WICHITA, KANSAS  
 B. E. SMITH CITY ENGINEER  
 JULY 1958, PRIVATE CONTRACT

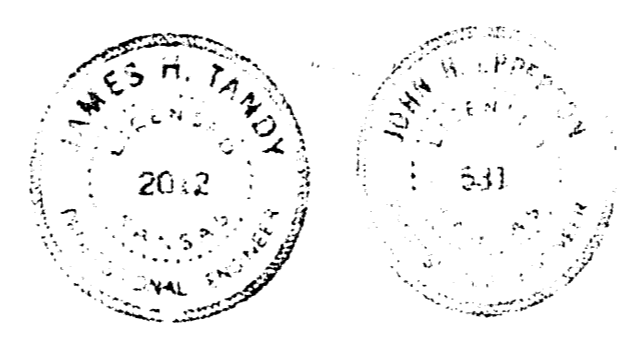

2