

BM 14243 OLIVER & HARRY CITY OF WICHITA BM DISC W end N HUBGUARD to NEW RCBC  
 150' E of OLIVER on HARRY  
 BM 14980 SE CORNER CONCRETE PORCH S APARTMENT SW HARRY & BLECKLEY  
 BM 14780 SW CORNER CONCRETE PORCH APARTMENT 1406 BLECKLEY DR  
 BM 14665 NW CORNER LOWER CONCRETE STEP APARTMENT 1501 BATTIN

NOTE: Post line is 6" dia (concrete)  
 NOTE: Field Engr to take cross sections Sta 3+50 thru 5+38.6' prior to construction.

NOTE: See Engineering Manual for details on the use of the "Access Control" symbol and the "Access Control" symbol.

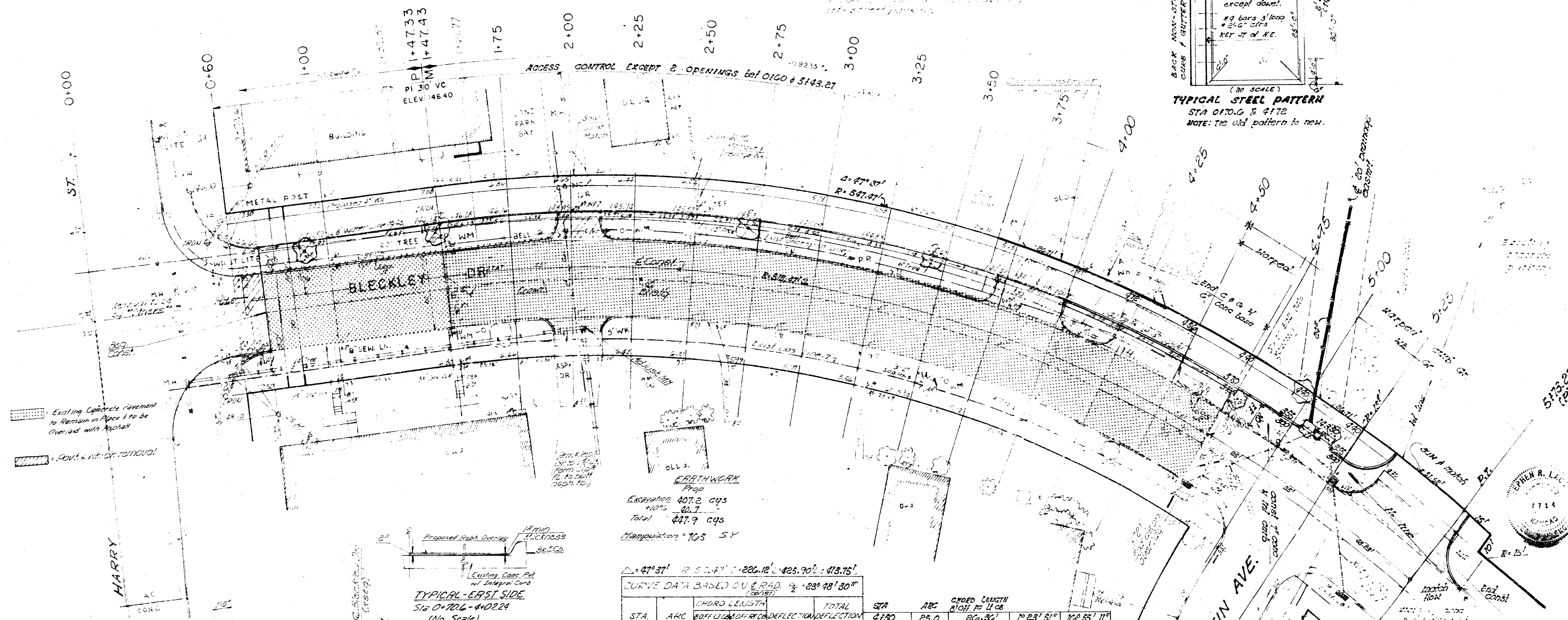
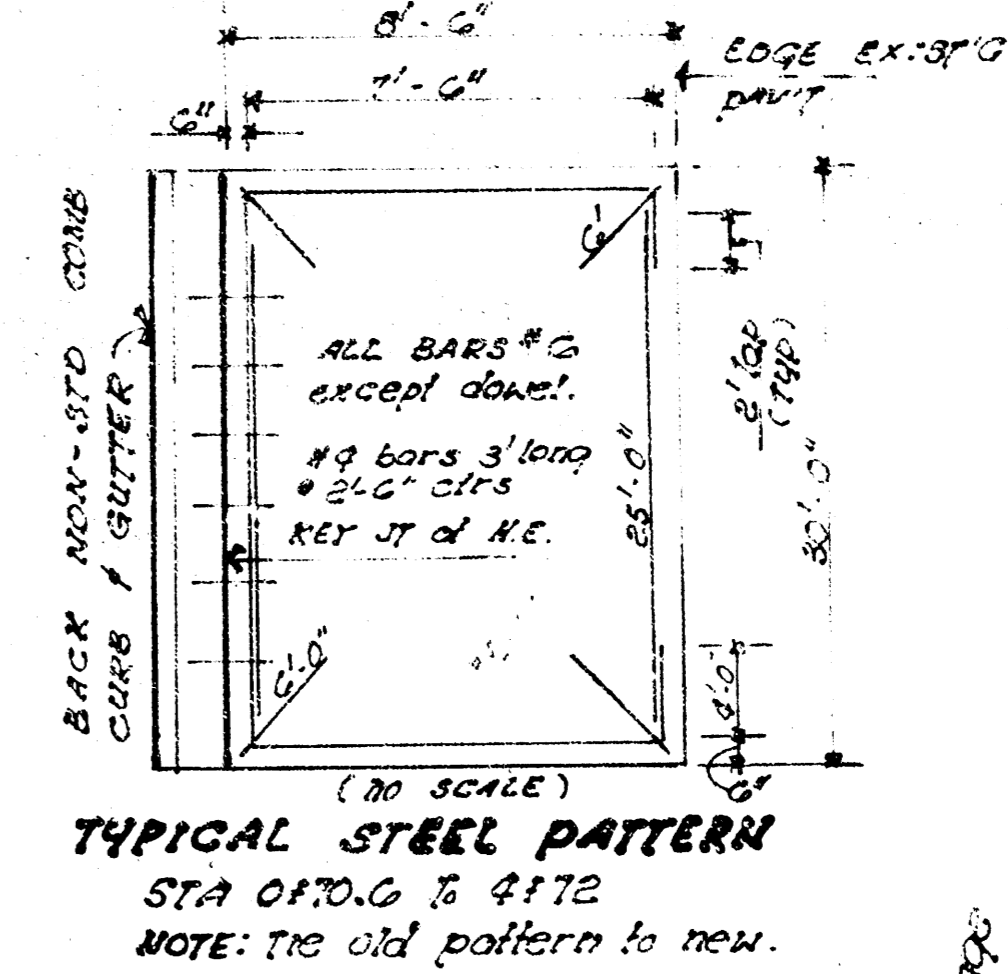

**EARTHWORK**  
 Prop  
 Excavation 407.2 cys  
 +10% 40.7  
 Total 447.9 cys  
 Manipulation 705 SY

Δ = 47°37' R 524.1' = 226.12' Δ 26.90' Δ 13.75'

CURVE DATA BASED ON RAD. R = 231° 48' 30"

STA.	ARC	CHORD LENGTH	DEFLECTION	TOTAL	STA.	ARC	CHORD LENGTH	DEFLECTION	TOTAL
1+47.33	14.44	15.23	15.25	0° 20' 30"	0° 00' 00"	2+50	25.0	25.00	1° 23' 51"
1+61.77	14.44	15.23	15.25	0° 20' 30"	0° 40' 00"	2+75	25.0	25.00	2° 47' 42"
1+76.21	14.44	15.23	15.25	0° 20' 30"	1° 00' 00"	3+00	25.0	25.00	4° 11' 33"
1+90.65	14.44	15.23	15.25	0° 20' 30"	1° 20' 00"	3+25	25.0	25.00	5° 35' 24"
2+05.09	14.44	15.23	15.25	0° 20' 30"	1° 40' 00"	3+50	25.0	25.00	7° 00' 15"
2+19.53	14.44	15.23	15.25	0° 20' 30"	2° 00' 00"	3+75	25.0	25.00	8° 24' 06"
2+33.97	14.44	15.23	15.25	0° 20' 30"	2° 20' 00"	4+00	25.0	25.00	9° 47' 57"
2+48.41	14.44	15.23	15.25	0° 20' 30"	2° 40' 00"	4+25	25.0	25.00	11° 11' 48"
2+62.85	14.44	15.23	15.25	0° 20' 30"	3° 00' 00"	4+50	25.0	25.00	12° 35' 39"
2+77.29	14.44	15.23	15.25	0° 20' 30"	3° 20' 00"	4+75	25.0	25.00	13° 59' 30"
2+91.73	14.44	15.23	15.25	0° 20' 30"	3° 40' 00"	5+00	25.0	25.00	15° 23' 21"
3+06.17	14.44	15.23	15.25	0° 20' 30"	4° 00' 00"	5+25	25.0	25.00	16° 47' 12"
3+20.61	14.44	15.23	15.25	0° 20' 30"	4° 20' 00"	5+50	25.0	25.00	18° 11' 03"
3+35.05	14.44	15.23	15.25	0° 20' 30"	4° 40' 00"	5+75	25.0	25.00	19° 34' 54"
3+49.49	14.44	15.23	15.25	0° 20' 30"	5° 00' 00"	6+00	25.0	25.00	20° 58' 45"
3+63.93	14.44	15.23	15.25	0° 20' 30"	5° 20' 00"	6+25	25.0	25.00	22° 22' 36"
3+78.37	14.44	15.23	15.25	0° 20' 30"	5° 40' 00"	6+50	25.0	25.00	23° 46' 27"
3+92.81	14.44	15.23	15.25	0° 20' 30"	6° 00' 00"	6+75	25.0	25.00	25° 10' 18"
4+07.25	14.44	15.23	15.25	0° 20' 30"	6° 20' 00"	7+00	25.0	25.00	26° 34' 09"
4+21.69	14.44	15.23	15.25	0° 20' 30"	6° 40' 00"	7+25	25.0	25.00	27° 57' 00"
4+36.13	14.44	15.23	15.25	0° 20' 30"	7° 00' 00"	7+50	25.0	25.00	29° 20' 51"
4+50.57	14.44	15.23	15.25	0° 20' 30"	7° 20' 00"	7+75	25.0	25.00	30° 44' 42"
4+65.01	14.44	15.23	15.25	0° 20' 30"	7° 40' 00"	8+00	25.0	25.00	32° 08' 33"
4+79.45	14.44	15.23	15.25	0° 20' 30"	8° 00' 00"	8+25	25.0	25.00	33° 32' 24"
4+93.89	14.44	15.23	15.25	0° 20' 30"	8° 20' 00"	8+50	25.0	25.00	34° 56' 15"
5+08.33	14.44	15.23	15.25	0° 20' 30"	8° 40' 00"	8+75	25.0	25.00	36° 20' 06"
5+22.77	14.44	15.23	15.25	0° 20' 30"	9° 00' 00"	9+00	25.0	25.00	37° 43' 57"
5+37.21	14.44	15.23	15.25	0° 20' 30"	9° 20' 00"	9+25	25.0	25.00	39° 07' 48"
5+51.65	14.44	15.23	15.25	0° 20' 30"	9° 40' 00"	9+50	25.0	25.00	40° 31' 39"
5+66.09	14.44	15.23	15.25	0° 20' 30"	10° 00' 00"	9+75	25.0	25.00	41° 55' 30"
5+80.53	14.44	15.23	15.25	0° 20' 30"	10° 20' 00"	10+00	25.0	25.00	43° 19' 21"
5+94.97	14.44	15.23	15.25	0° 20' 30"	10° 40' 00"	10+25	25.0	25.00	44° 43' 12"
6+09.41	14.44	15.23	15.25	0° 20' 30"	11° 00' 00"	10+50	25.0	25.00	46° 07' 03"
6+23.85	14.44	15.23	15.25	0° 20' 30"	11° 20' 00"	10+75	25.0	25.00	47° 30' 54"
6+38.29	14.44	15.23	15.25	0° 20' 30"	11° 40' 00"	11+00	25.0	25.00	48° 54' 45"
6+52.73	14.44	15.23	15.25	0° 20' 30"	12° 00' 00"	11+25	25.0	25.00	50° 18' 36"
6+67.17	14.44	15.23	15.25	0° 20' 30"	12° 20' 00"	11+50	25.0	25.00	51° 42' 27"
6+81.61	14.44	15.23	15.25	0° 20' 30"	12° 40' 00"	11+75	25.0	25.00	53° 06' 18"
6+96.05	14.44	15.23	15.25	0° 20' 30"	13° 00' 00"	12+00	25.0	25.00	54° 30' 09"
7+10.49	14.44	15.23	15.25	0° 20' 30"	13° 20' 00"	12+25	25.0	25.00	55° 53' 50"
7+24.93	14.44	15.23	15.25	0° 20' 30"	13° 40' 00"	12+50	25.0	25.00	57° 17' 41"
7+39.37	14.44	15.23	15.25	0° 20' 30"	14° 00' 00"	12+75	25.0	25.00	58° 41' 32"
7+53.81	14.44	15.23	15.25	0° 20' 30"	14° 20' 00"	13+00	25.0	25.00	60° 05' 23"
7+68.25	14.44	15.23	15.25	0° 20' 30"	14° 40' 00"	13+25	25.0	25.00	61° 29' 14"
7+82.69	14.44	15.23	15.25	0° 20' 30"	15° 00' 00"	13+50	25.0	25.00	62° 53' 05"
7+97.13	14.44	15.23	15.25	0° 20' 30"	15° 20' 00"	13+75	25.0	25.00	64° 16' 56"
8+11.57	14.44	15.23	15.25	0° 20' 30"	15° 40' 00"	14+00	25.0	25.00	65° 40' 47"
8+26.01	14.44	15.23	15.25	0° 20' 30"	16° 00' 00"	14+25	25.0	25.00	67° 04' 38"
8+40.45	14.44	15.23	15.25	0° 20' 30"	16° 20' 00"	14+50	25.0	25.00	68° 28' 29"
8+54.89	14.44	15.23	15.25	0° 20' 30"	16° 40' 00"	14+75	25.0	25.00	69° 52' 20"
8+69.33	14.44	15.23	15.25	0° 20' 30"	17° 00' 00"	15+00	25.0	25.00	71° 16' 11"
8+83.77	14.44	15.23	15.25	0° 20' 30"	17° 20' 00"	15+25	25.0	25.00	72° 39' 52"
8+98.21	14.44	15.23	15.25	0° 20' 30"	17° 40' 00"	15+50	25.0	25.00	74° 03' 43"
9+12.65	14.44	15.23	15.25	0° 20' 30"	18° 00' 00"	15+75	25.0	25.00	75° 27' 34"
9+27.09	14.44	15.23	15.25	0° 20' 30"	18° 20' 00"	16+00	25.0	25.00	76° 51' 25"
9+41.53	14.44	15.23	15.25	0° 20' 30"	18° 40' 00"	16+25	25.0	25.00	78° 15' 16"
9+55.97	14.44	15.23	15.25	0° 20' 30"	19° 00' 00"	16+50	25.0	25.00	79° 39' 07"
9+70.41	14.44	15.23	15.25	0° 20' 30"	19° 20' 00"	16+75	25.0	25.00	81° 02' 58"
9+84.85	14.44	15.23	15.25	0° 20' 30"	19° 40' 00"	17+00	25.0	25.00	82° 26' 49"
9+99.29	14.44	15.23	15.25	0° 20' 30"	20° 00' 00"	17+25	25.0	25.00	83° 50' 40"
10+13.73	14.44	15.23	15.25	0° 20' 30"	20° 20' 00"	17+50	25.0	25.00	85° 14' 31"
10+28.17	14.44	15.23	15.25	0° 20' 30"	20° 40' 00"	17+75	25.0	25.00	86° 38' 22"
10+42.61	14.44	15.23	15.25	0° 20' 30"	21° 00' 00"	18+00	25.0	25.00	88° 02' 13"
10+57.05	14.44	15.23	15.25	0° 20' 30"	21° 20' 00"	18+25	25.0	25.00	89° 26' 04"
10+71.49	14.44	15.23	15.25	0° 20' 30"	21° 40' 00"	18+50	25.0	25.00	90° 49' 55"
10+85.93	14.44	15.23	15.25	0° 20' 30"	22° 00' 00"	18+75	25.0	25.00	92° 13' 46"
11+00.37	14.44	15.23	15.25	0° 20' 30"	22° 20' 00"	19+00	25.0	25.00	93° 37' 37"
11+14.81	14.44	15.23	15.25	0° 20' 30"	22° 40' 00"	19+25	25.0	25.00	95° 01' 28"
11+29.25	14.44	15.23	15.25	0° 20' 30"	23° 00' 00"	19+50	25.0	25.00	96° 25' 19"
11+43.69	14.44	15.23	15.25	0° 20' 30"	23° 20' 00"	19+75	25.0	25.00	97° 49' 10"
11+58.13	14.44	15.23	15.25	0° 20' 30"	23° 40' 00"	20+00	25.0	25.00	99° 13' 01"
11+72.57	14.44	15.23	15.25	0° 20' 30"	24° 00' 00"	20+25	25.0	25.00	100° 36' 52"
11+87.01	14.44	15.23	15.25	0° 20' 30"	24° 20' 00"	20+50	25.0	25.00	102° 00' 43"
12+01.45	14.44	15.23	15.25	0° 20' 30"	24° 40' 00"	20+75	25.0	25.00	103° 24' 34"
12+15.89	14.44	15.23	15.25	0° 20' 30"	25° 00' 00"	21+00	25.0	25.00	104° 48' 25"
12+30.33	14.44	15.23	15.25	0° 20' 30"	25° 20' 00"	21+25	25.0	25.00	106° 12' 16"
12+44.77	14.44	15.23	15.25	0° 20' 30"	25° 40' 00"	21+50	25.0	25.00	107° 36' 07"
12+59.21	14.44	15.23	15.25	0° 20' 30"	26° 00' 00"	21+75	25.0	25.00	109° 00' 08"
12+73.65	14.44	15.23	15.25	0° 20' 30"	26° 20' 00"	22+00	25.0	25.00	110° 23' 99"
12+88.09	14.44	15.23	15.25	0° 20' 30"	26° 40' 00"	22+25	25.0	25.00	111° 47' 50"
13+02.53	14.44	15.23	15.25	0° 20' 30"	27° 00' 00"	22+50	25.0	25.00	113° 11' 41"
13+16.97	14.44	15.23	15.25	0° 20' 30"	27° 20' 00"	22+75	25.0	25.00	114° 35' 32"
13+31.41	14.44	15.23	15.25	0° 20' 30"	27° 40' 00"	23+00	25.0	25.00	115° 59' 23"
13+45.85	14.44	15.23	15.25	0° 20' 30"	28° 00' 00"	23+25	25.0	25.00	117° 23' 14"
13+60.29	14.44	15.23	15.25	0° 20' 30"	28° 20' 00"	23+50	25.0	25.00	118° 47' 05"
13+74.73	14.44	15.23	15.25	0° 20' 30"	28° 40' 00"	23+75	25.0	25.00	120° 10' 56"
13+89.17	14.44	15.23	15.25	0° 20' 30"					