

BM 10223 G in Globe top curb 2' S of No. end rd. U.E. Bonn & May
 BM 10357 R.R. spike in H.L.R. N.E. Bonn & Dora.

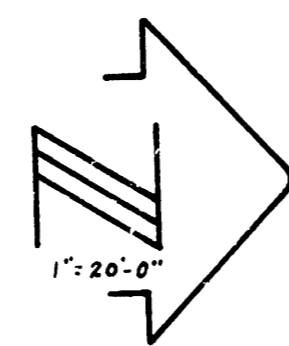

TIES TO IRON & BONN & DORA
 351' N.E. to R.R. spike in H.L.P.
 346' S.E. to fence corner post

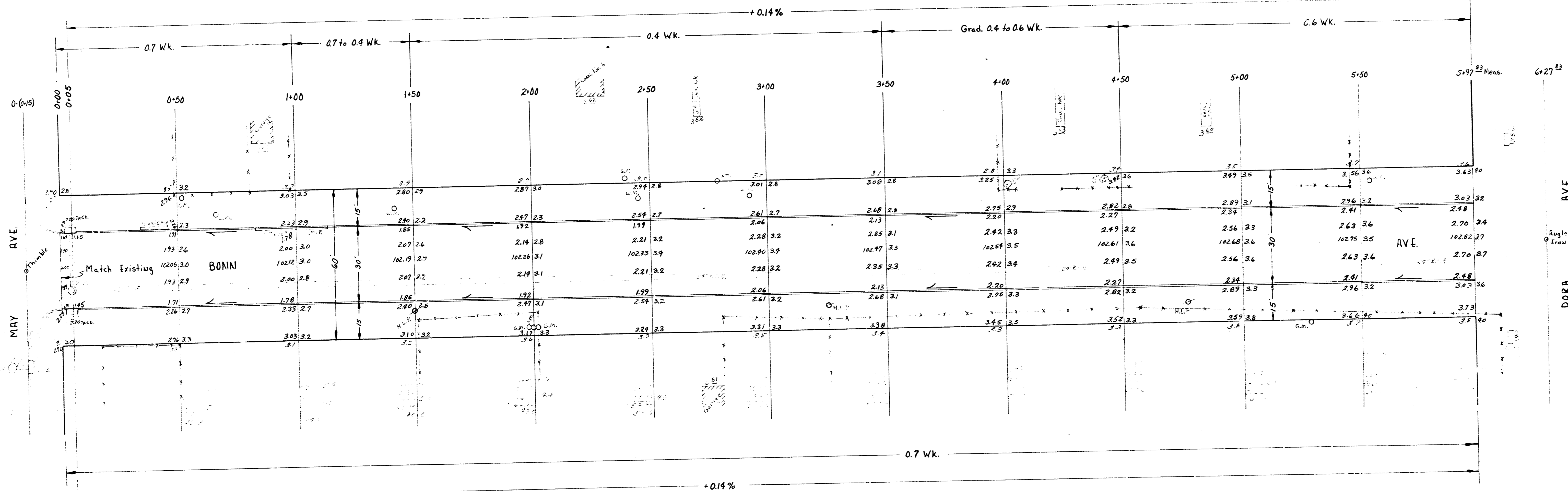

NOTE TO FIELD ENGINEER & CONTRACTOR:

All entrance pipes to be disposed of in accordance with City Dirt Checker.

BONN AVE.
 N.L. MAY to S.L. DORA
 30" CONC. & CB.
 CITY OF WICHITA, KANSAS
 B.E. SMITH CITY ENGINEER
 DATE: SEPT. 1958, PROJ. NO. C18-112