

B.M. 109.04 SW Cor. Conc. Porch House NW Cor. Bonn F. Irving
 Stationing on E

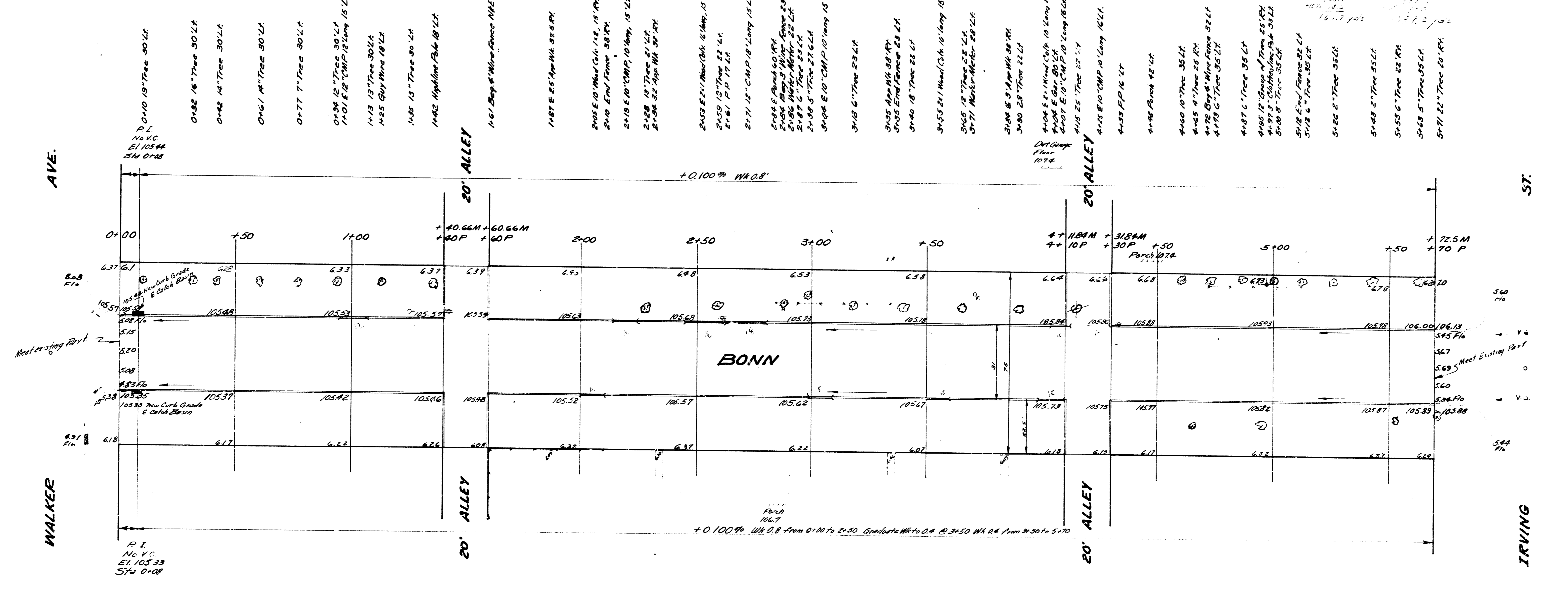

NOTE TO CONTRACTOR
 Entrance pipe to be disposed of in accordance
 with instructions of dirt checker.

BONN
 SL IRVING TO NL WALKER
 30' CONCRETE & CURB
 CITY OF WICHITA KANSAS
 B. C. SMITH CITY ENGINEER
 MARCH 1954 PROJ No C13-223

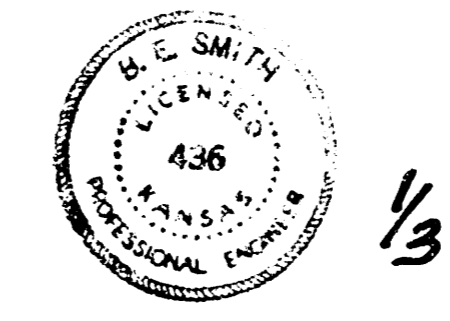

1/3