

PLANS FOR REPAIR
CENTRAL AVE
 E.L. MARKET TO W.L. BROADWAY

- LEGEND**
- TRAFFIC SIGNAL LIGHT
 - ◆ P.S.E. POLE
 - WATER METER
 - ⊙ WATER VALVE
 - MANHOLE
 - TREE
 - COMMERCIAL DRIVE
 - NEW CURB LINE
 - ✕ STAND OR REMOVE

ENGINEERING DEPARTMENT
 CITY OF WICHITA, KANSAS
 P.L. BROCKWAY CITY ENGINEER
 SCALE 1" = 20'
 1944

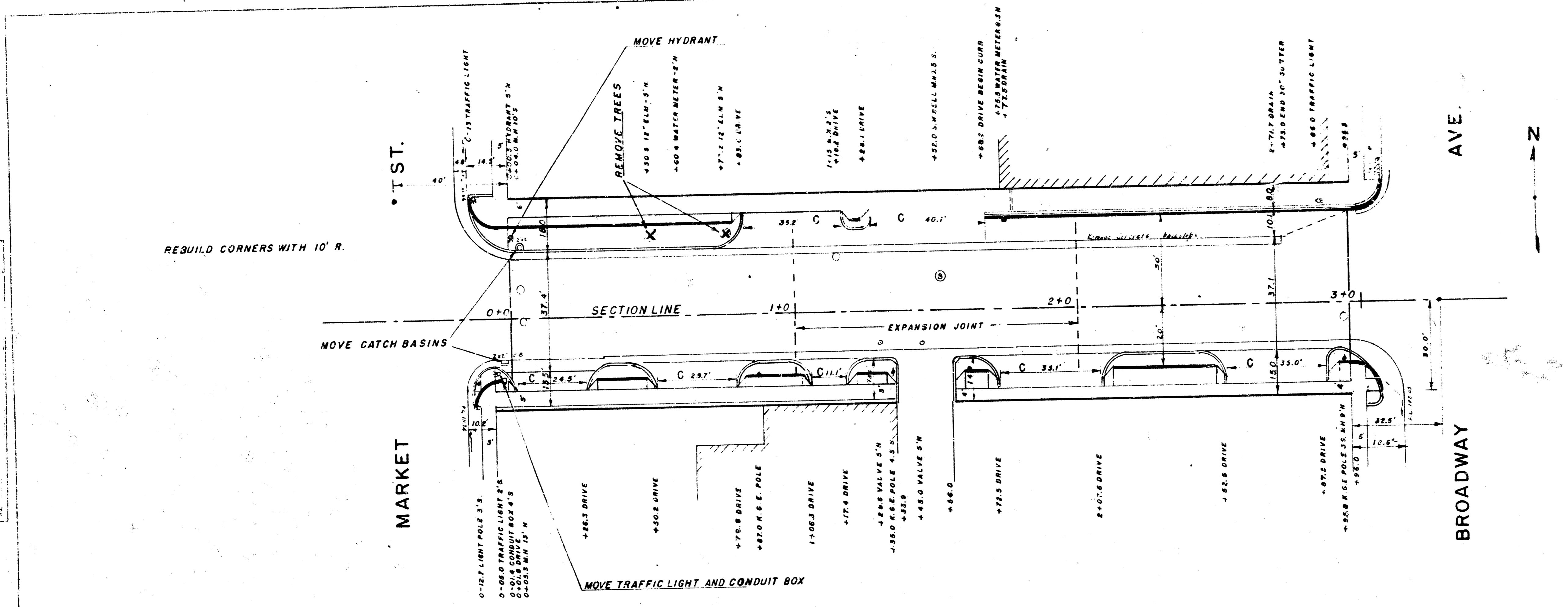

RESUILD CORNERS WITH 10' R.

• T ST.

MARKET

AVE.

BROADWAY



REVISED
 DATE
 BY

PROJECT
 SHEET NO.
 DATE

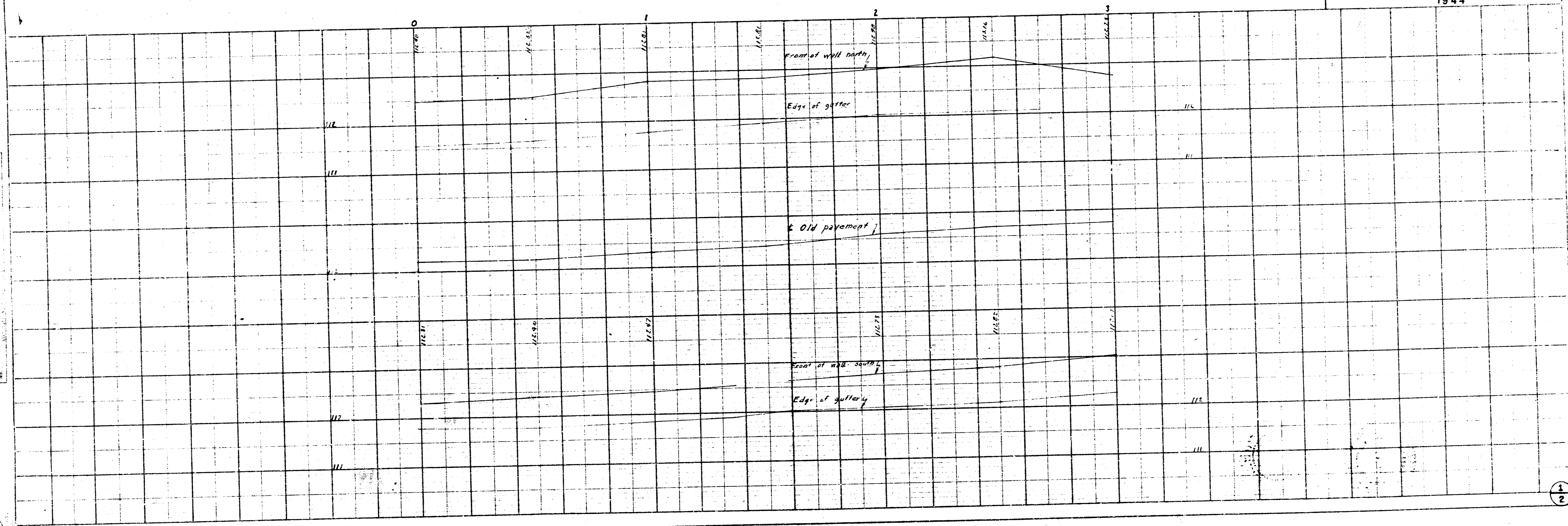

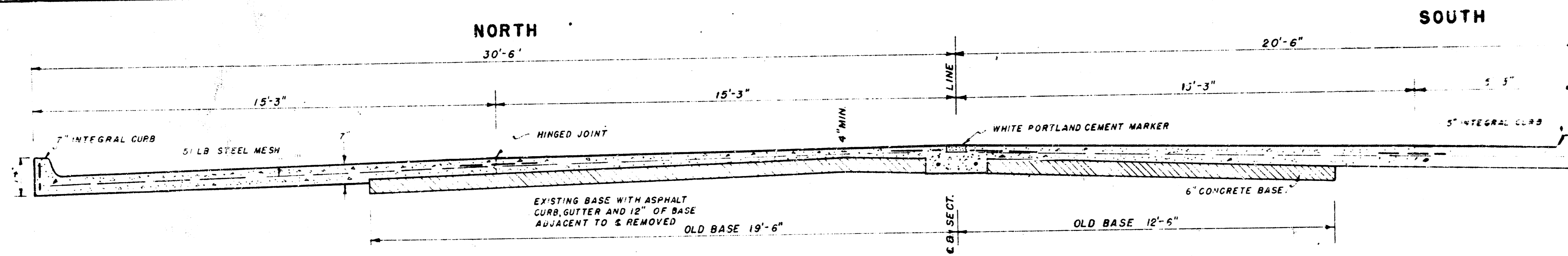

PROPOSED CROSS SECTION

$\frac{1}{2}'' = 1'-0''$

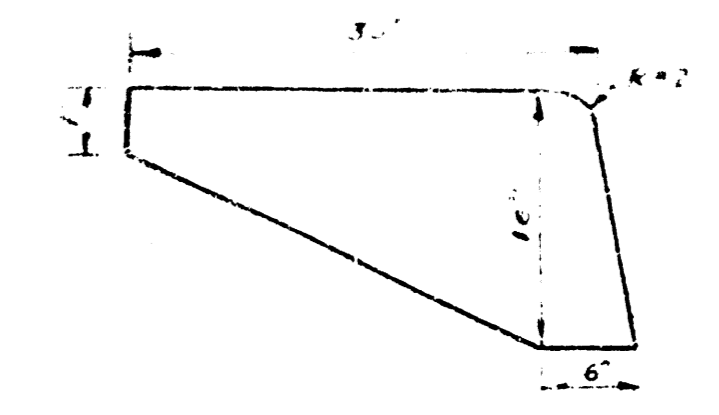

DETAIL OF CURB
STA. 1+68.2 TO 2+96.5
NORTH SIDE

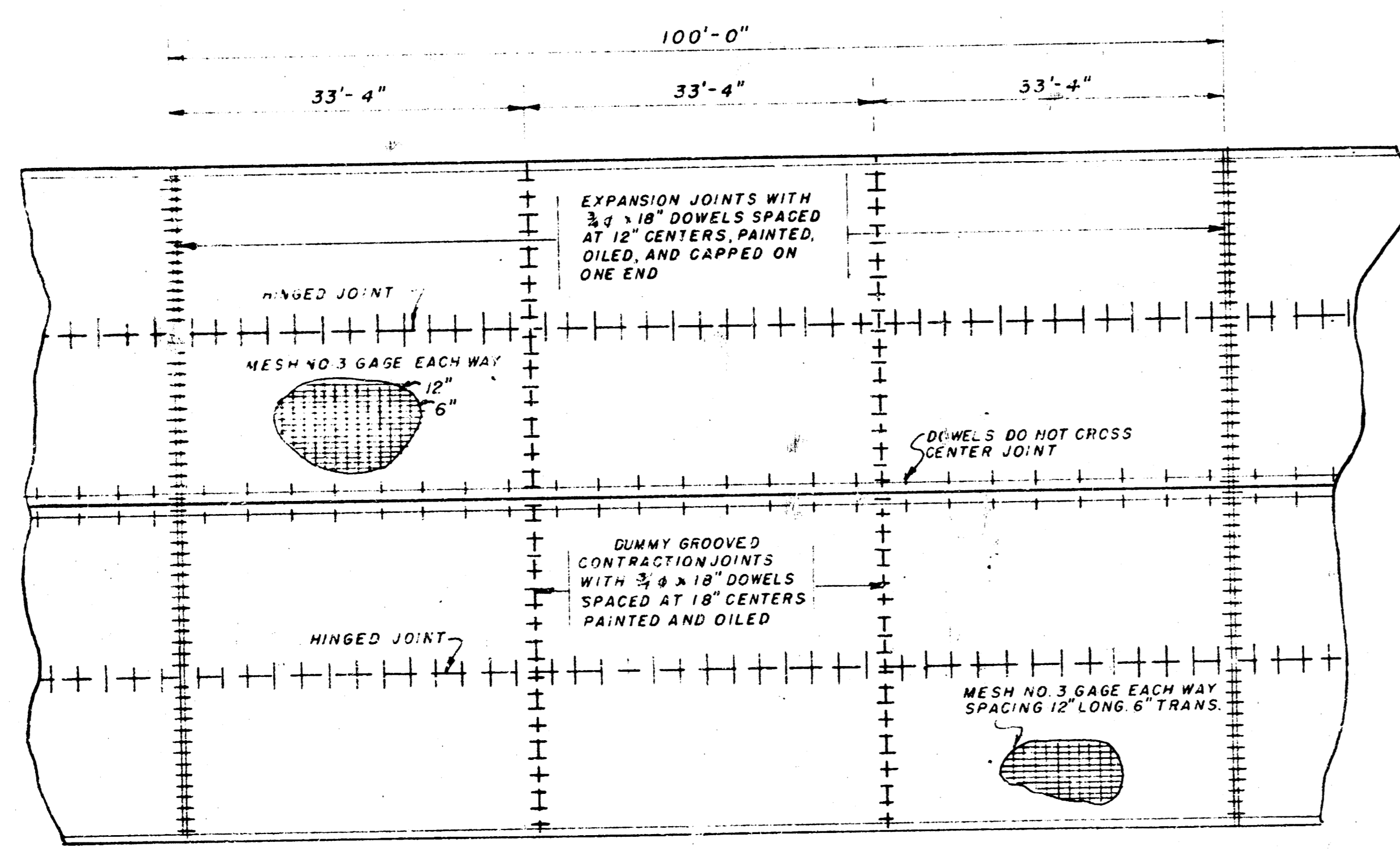

PLAN LAYOUT

$1'' = 10'-0''$

PLANS FOR REPAVING
CENTRAL AVENUE
MARKET ST - BROADWAY AVE

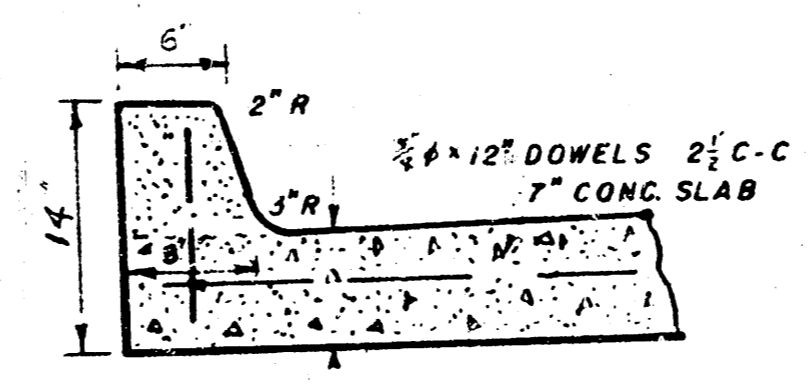

DETAIL OF INTEGRAL CURB

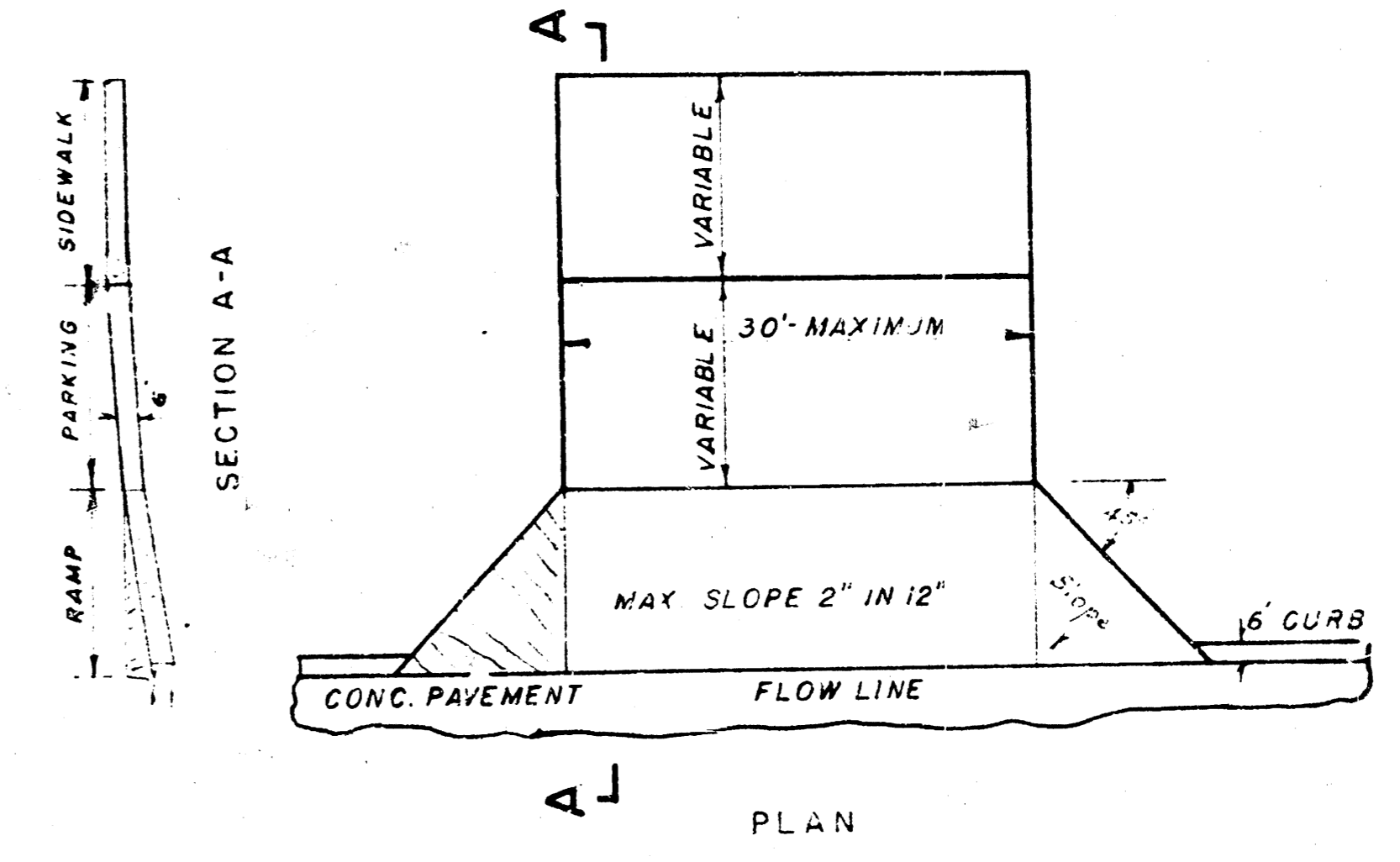

SECTION A-A

COMMERCIAL DRIVEWAY

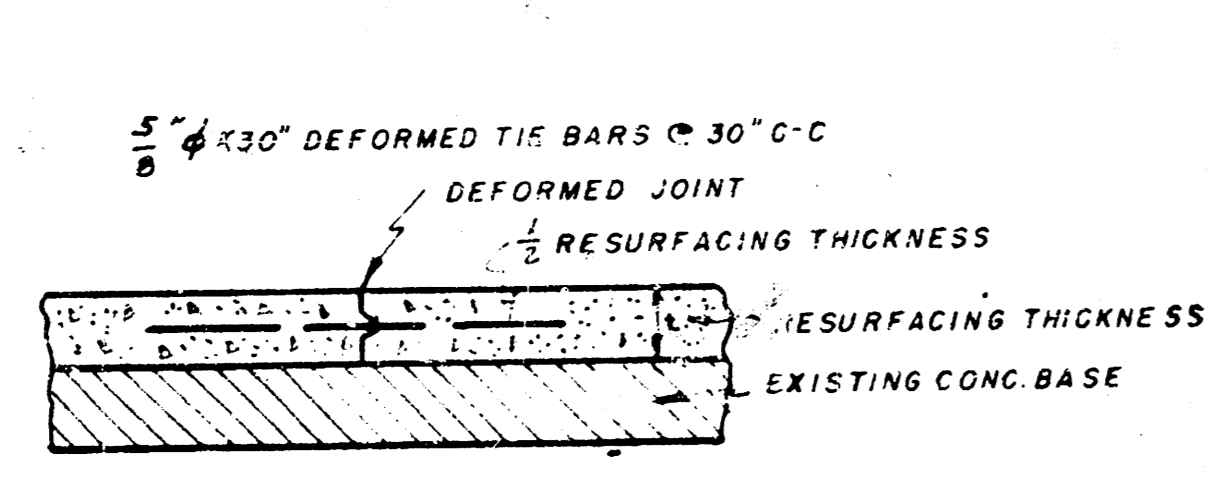

DETAIL OF HINGED JOINT

DURING CONSTRUCTION OF THE FIRST LANE THE TIE BARS SHALL BE BENT 90° ONE END BEING LAID IN THE GROOVE OF THE DEFORMED METAL PLATE AND THE OTHER END EXTENDING INTO THE CONCRETE OF THE FIRST LANE. AFTER REMOVAL OF FORMS THESE BARS SHALL BE STRAIGHTENED SO THAT THEY WILL EXTEND INTO THE CONCRETE OF THE NEXT LANE WHEN IT IS PLACED.

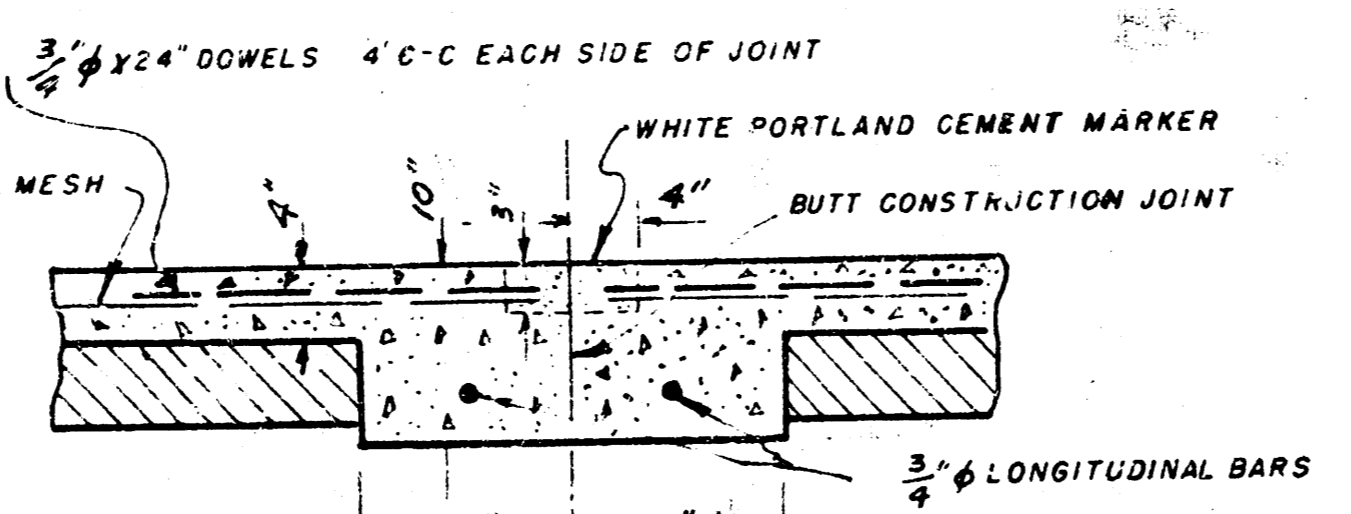

DETAIL OF CENTER JOINT

$\frac{3}{16}'' = 1''$

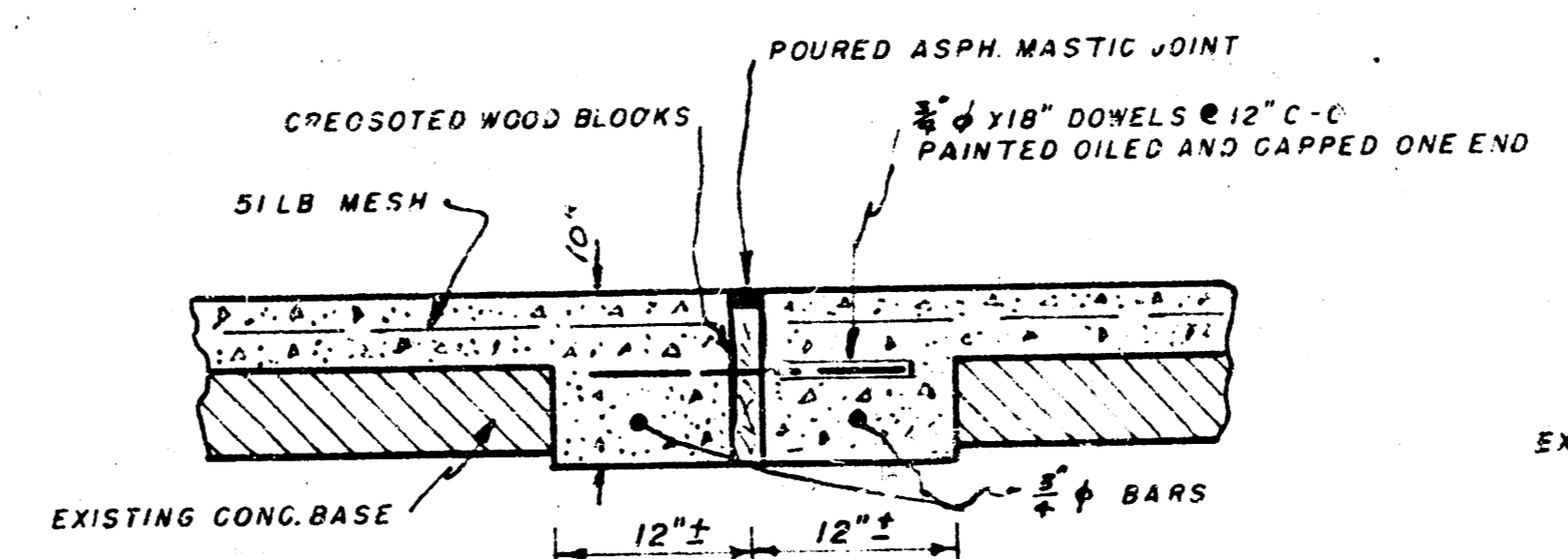

DETAIL OF EXPANSION JOINT

$\frac{3}{16}'' = 1''$

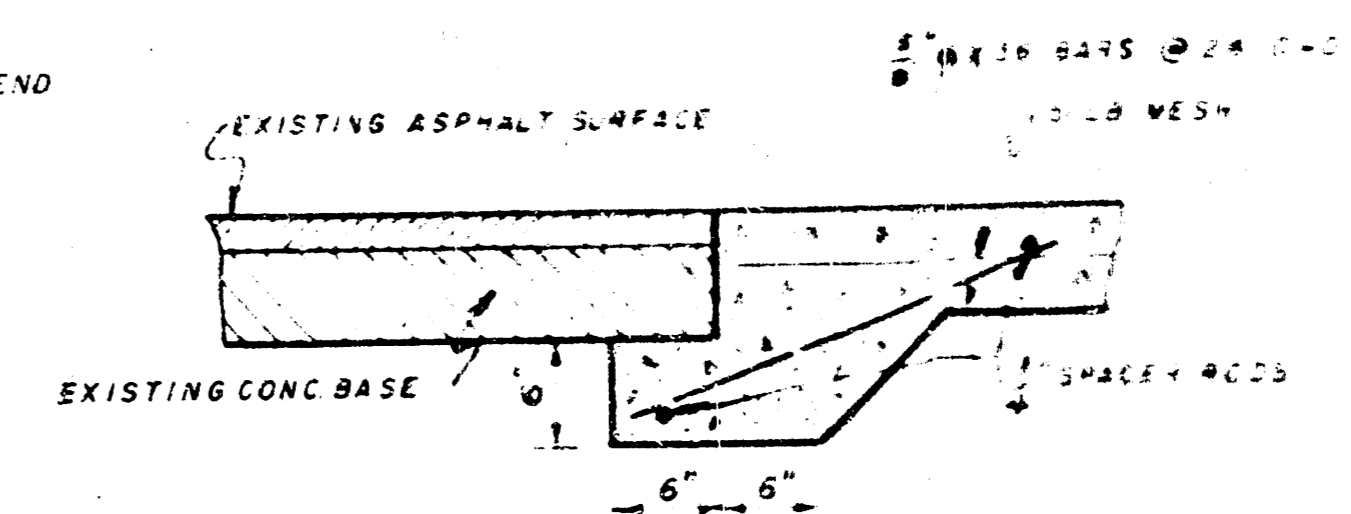

DETAIL OF JOINT BETWEEN NEW AND EXISTING PAVEMENT

$\frac{3}{16}'' = 1''$