

BRUNSWICK AVE. N. L. MAPLE TO S. L. DOUGLAS

GENERAL NOTES

1. DRIVEWAY CONSTRUCTION

NO MORE THAN 11,250 SQUARE FEET OF DRIVEWAY SHALL BE CONSTRUCTED AS A PART OF THIS CONTRACT.

THE REMOVAL AND REPLACEMENT OF EXISTING DRIVEWAYS TO FACILITATE GRADE ADJUSTMENT OUTSIDE OF STREET RIGHT-OF-WAY MAY BE COMPLETED AS SHOWN ON THE PLAN; THIS WORK SHALL BE CHARGED TO THE PROJECT.

MISSING PIECES OF DRIVEWAY OUTSIDE OF STREET RIGHT-OF-WAY MAY BE CONSTRUCTED AS A PART OF THIS CONTRACT; THIS WORK SHALL BE CHARGED DIRECTLY TO THE PROPERTY INVOLVED.

ANY WORK OUTSIDE OF STREET RIGHT-OF-WAY SHALL BE AUTHORIZED ON A PROPERLY EXECUTED DRIVEWAY REQUEST FORM.

2. MAILBOXES WITHIN THE PROJECT LIMITS SHALL BE REMOVED AND REPLACED BY THE CONTRACTOR AS APPROVED BY THE ENGINEER. CONTRACTOR SHALL BE REQUIRED TO MAKE SATISFACTORY PROVISIONS FOR MAIL DELIVERY TO PROPERTIES AFFECTED BY THIS PROJECT DURING CONSTRUCTION.

3. CURB AND GUTTER WITH A WIDENED GUTTER SECTION AT INTERSECTIONS SHALL BE PAID AS COMBINED CURB & GUTTER.

4. THE COST OF REMOVING RAILROAD TIES, CONCRETE CURBS, CONCRETE PADS, OR ANY OTHER ITEM USED AS A HEADWALL FOR CULVERT PIPES, OR BORDERS FOR EXISTING DRIVEWAYS, SHALL BE INCIDENTAL TO PIPE REMOVAL. RAILROAD TIES SHALL BE SALVAGED AND DELIVERED TO THE PROPERTY OWNER. IF THE OWNER DOES NOT WANT THE RAILROAD TIES, THE CONTRACTOR SHALL DISPOSE OF THEM IN AN APPROVED MANNER.

5. DRAIN PIPE SHALL BE 4" PVC PIPE, S.D.R. 23-5.

6. FENCE REMOVAL

EXISTING FENCES WITHIN STREET RIGHT-OF-WAY THAT DO NOT CONFLICT WITH PAVEMENT CONSTRUCTION, AS DETERMINED BY THE ENGINEER, WILL NOT BE REMOVED.

EXISTING FENCES WITHIN STREET RIGHT-OF-WAY THAT ARE IN CONFLICT WITH PAVEMENT CONSTRUCTION, AS DETERMINED BY THE ENGINEER, SHALL BE SALVAGED AND DELIVERED TO THE PROPERTY OWNER. IF THE OWNER DOES NOT WANT THE SALVAGED MATERIAL, IT SHALL BE DISPOSED OF IN AN APPROVED MANNER BY THE CONTRACTOR. THE CONTRACTOR SHALL EXERCISE REASONABLE CARE TO AVOID DAMAGE TO FENCING MATERIALS DURING SALVAGE OPERATIONS IF THE FENCING MATERIAL IS TO BE DELIVERED TO THE PROPERTY OWNER. ALL WORK DEFINED IN THIS PARAGRAPH SHALL BE INCLUDED IN THE FENCE REMOVAL.

BM 141.15 "C" NE CORNER HEADWALL R.C.B. 1152 FT. W OF RIDGE ROAD ON S5 MAPLE.
BM 138.42 NAIL S FL. P.P. N SIDE MAPLE 4TH P.P. W OF RIDGE ROAD.
BM 141.10 CITY SID. DISC. WOODCHUCK & MAPLE, 52 FT. S & 32 FT. W OF CL BOUTH (4' E OF HIGHLINE POLES N-S).
BM 145.88 R.R. SPIKE SE CORNER DOUGLAS & BRUNSWICK V.S. P.P.
BM 142.52 "C" CUT TOP OF N CLAP MEDIAL AT CL BRUNSWICK.

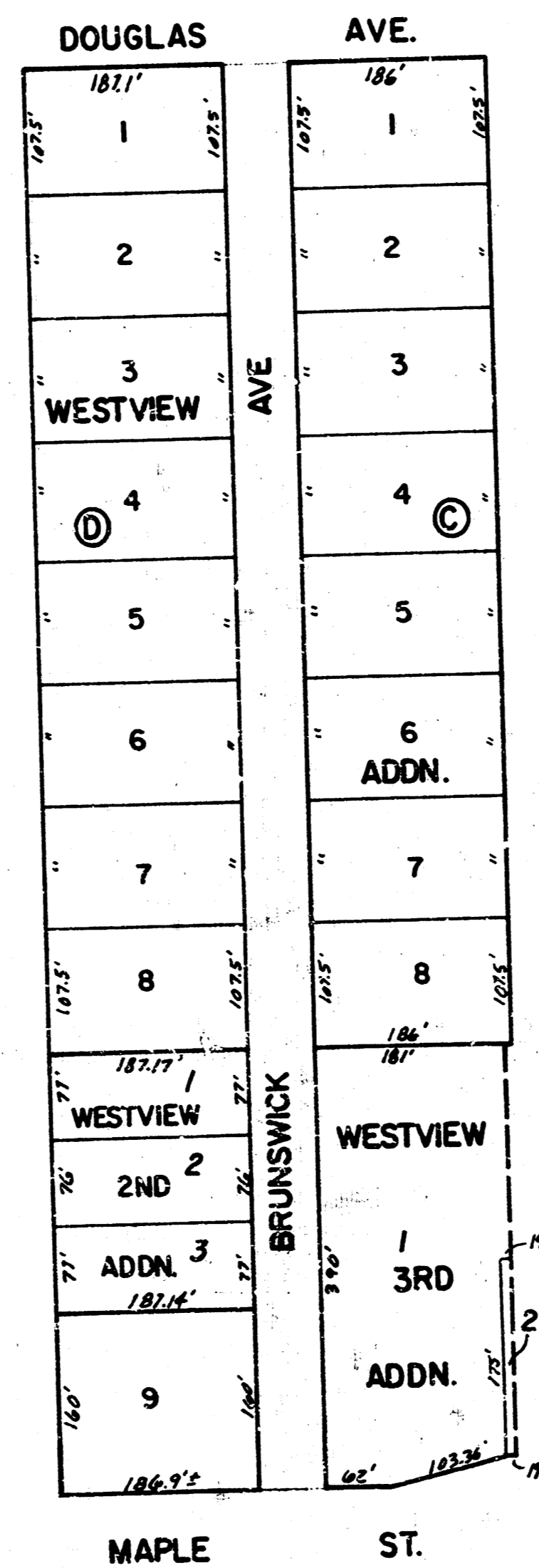

PROJECT DESCRIPTION		
PROJECT NUMBER		
472 76 245 81239 000 000 001		
BOOK NO. LES 26	APPROVED BY	DATE
DRAWN BY K E K	REVISION	1/5
CITY OF WICHITA		
DEPARTMENT OF ENGINEERING		
DIRECTOR OF ENG./CITY ENGINEER		SCALE
R. W. BRUGGEMAN		1" = 20'

TYPICAL 3' PAVEMENT DETAILS BRUNSWICK AVE.

TRANSVERSE SECTION

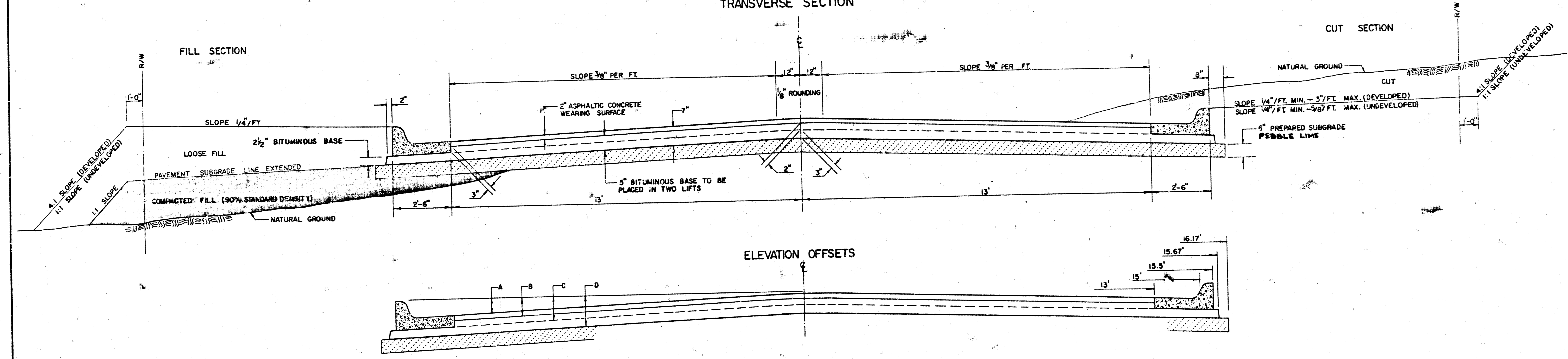

ELEVATION OFFSETS

	DISTANCE FROM CENTERLINE (LT. & RT.)											
	0'	2'	4'	6'	7.5'	10'	12'	13'	15'	15.5'	15.67'	16.17'
A: TOP OF CURBS TO TOP OF SURFACE LIFT	0.10	0.14	0.21	0.27	0.32	0.39	0.46	0.49	—	—	—	—
B: TOP OF CURBS TO TOP OF UPPER BASE LIFT	0.27	0.31	0.38	0.44	0.49	0.56	0.63	0.66	—	—	—	—
C: TOP OF CURBS TO TOP OF LOWER BASE LIFT	0.44	0.49	0.57	0.64	0.70	0.79	0.87	0.90	0.98	1.00	1.00	—
D: TOP OF CURBS TO TOP OF SUBGRADE	0.69	0.73	0.80	0.87	0.93	1.01	1.08	1.12	1.19	1.21	1.21	1.23

COMBINED CURB & GUTTER

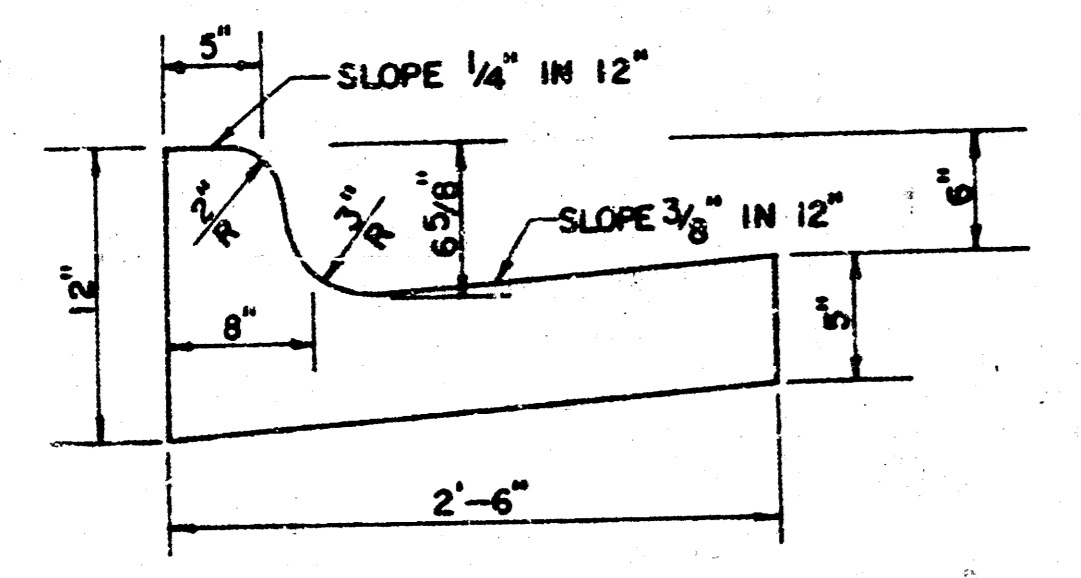

ROLL TYPE COMBINED CURB & GUTTER

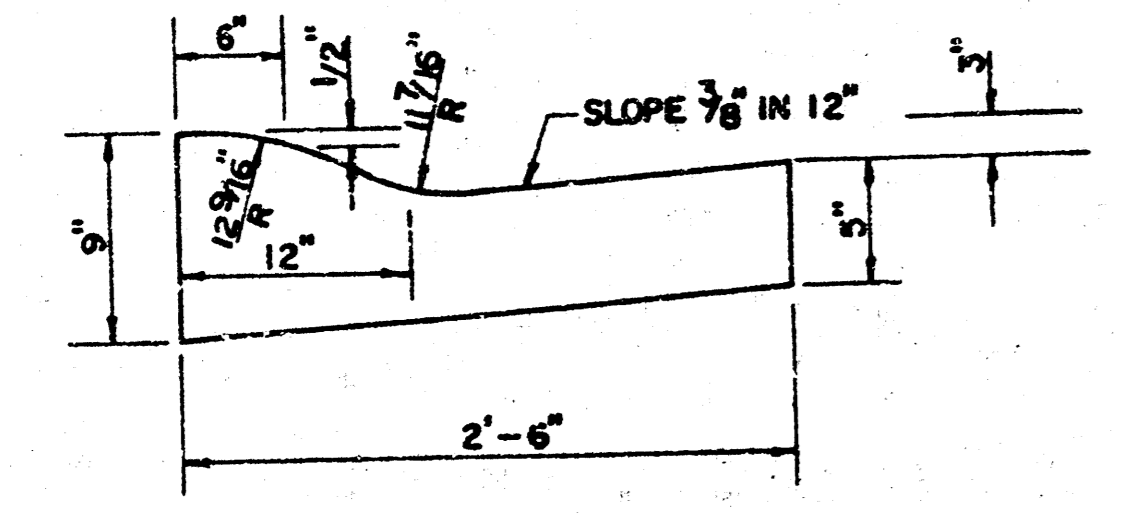

TRANSVERSE CONSTRUCTION JOINTS

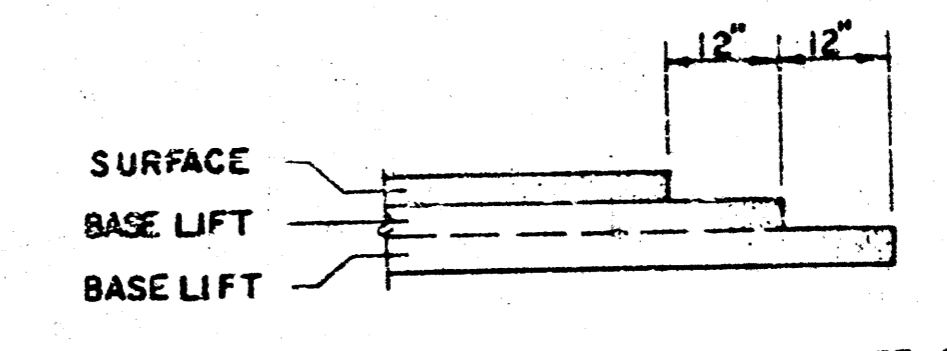

TRANSVERSE CONSTRUCTION JOINTS SHALL BE CONSTRUCTED IN FLEXIBLE BASE PAVEMENTS AT LOCATIONS WHERE PAVEMENT TEMPORARILY ENDS AS SHOWN BY THE DETAIL. THE COST OF CONSTRUCTION JOINTS SHALL BE INCLUDED IN THE BID PRICE FOR SQUARE YARDS 7" ASPHALTIC CONCRETE (5" BITUMINOUS BASE).

GENERAL NOTES

- 1) THE ASPHALTIC CONCRETE PAVEMENT BETWEEN THE COMBINED CURB AND GUTTER SHALL BE PAID AS SQUARE YARDS OF 7" ASPHALTIC CONCRETE (5" BITUMINOUS BASE).
- 2) THE BITUMINOUS BASE UNDER AND BEHIND THE COMBINED CURB AND GUTTER SHALL BE PAID AS SQUARE YARDS OF 2 1/2" BITUMINOUS BASE.
- 3) A TACK COAT OF EMULSIFIED ASPHALT (SC-1H OR CSS-1H) SHALL BE APPLIED AT AN APPROXIMATE RATE OF 0.05 GALLONS PER SQUARE YARD BETWEEN EACH LIFT OF ASPHALTIC MATERIAL.
- 4) BITUMINOUS BASE AND ASPHALTIC CONCRETE WEARING SURFACE SHALL BE PLACED WITH A LAYDOWN MACHINE HAVING AUTOMATIC CONTROLS FOR LINE AND GRADE.
- 5) CONSTRUCTION JOINTS IN EACH LIFT SHALL BE STAGGERED A MINIMUM DISTANCE OF ONE (1) FOOT FROM JOINTS IN PRECEDING LIFTS AND PLACED SO THAT A JOINT WILL BE CONSTRUCTED ON THE CENTERLINE OF THE TOP LIFT.
- 6) CONTRACTORS TO BID ONLY ONE SUBGRADE TREATMENT ALTERNATE WHEN ALTERNATES ARE PROVIDED IN THE PROPOSAL AND CONTRACT. THE ALTERNATE CHOSEN BY THE SUCCESSFUL BIDDER SHALL BE USED IN CONSTRUCTING THIS PROJECT.

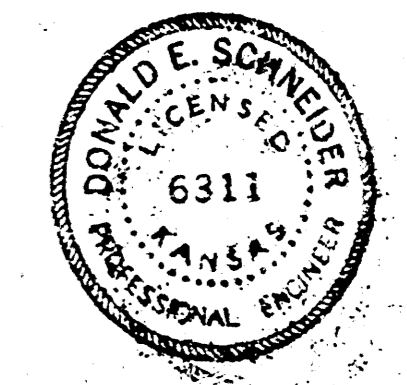

7 INCH RESIDENTIAL ASPHALTIC CONCRETE PAVEMENT WITH 5 INCH BITUMINOUS BASE
CITY OF WICHITA, KANSAS
PROJECT NUMBER 472 76 245 81239 000 000 001

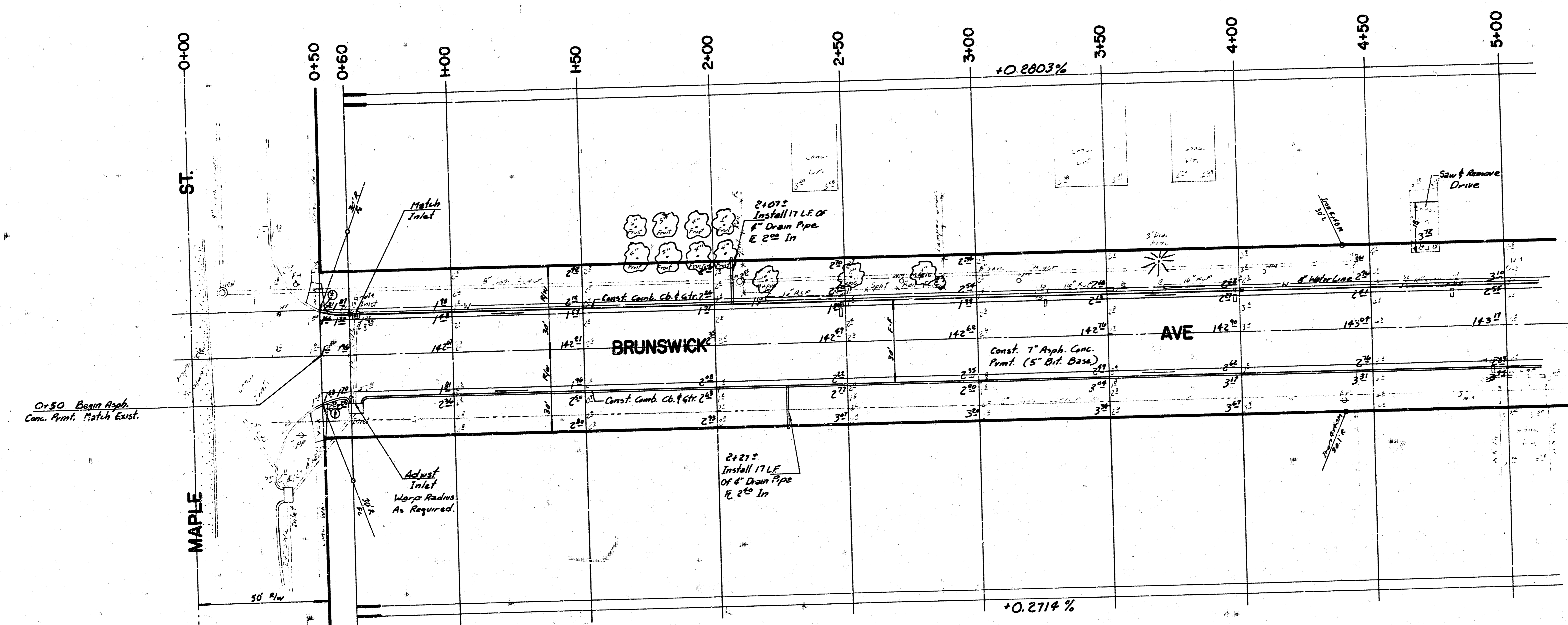
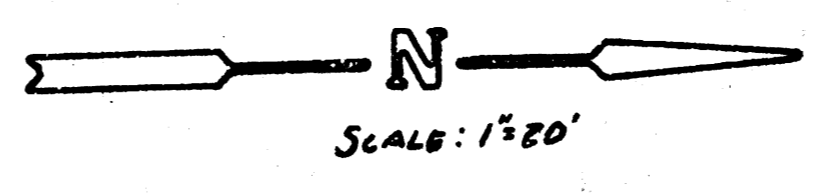

Or 50 Beas. Asphalt.
Conc. Pmnt. Match Exst.

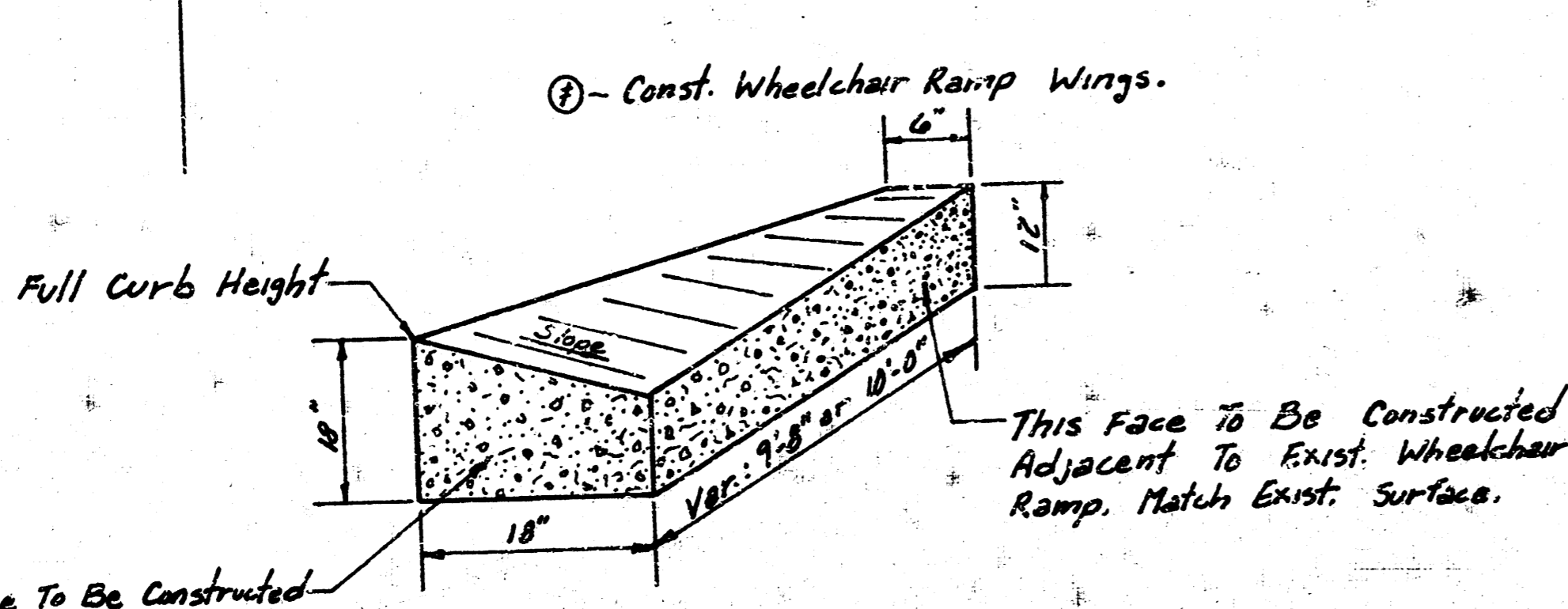

This Face To Be Constructed Adjacent To Back Of Curb. Match Top Of Curb Elev.

WHEELCHAIR RAMP WING DETAILS
 Note: All Cost Associated With Constructing Wheelchair Ramp Wings To Be Subsidiary To Project. Item Will Not Be Bid.

EARTHWORK

EXCAVATION	2,396.1 C.Y.
	239.6 C.Y.
TOTAL	2,635.7 C.Y.

X'-SECTION
 10 %
 TOTAL

THE CONTRACTOR SHALL BE RESPONSIBLE FOR PRESERVING PROPERTY IRONS. THE CONTRACTOR SHALL BE REQUIRED TO RE-ESTABLISH ANY PROPERTY IRONS WHICH ARE DAMAGED OR DESTROYED BY HIS CONSTRUCTION OPERATIONS. SUCH IRONS SHALL BE RE-ESTABLISHED BY A LICENSED LAND SURVEYOR OR A LICENSED PROFESSIONAL ENGINEER IN ACCORDANCE WITH STATE LAWS.

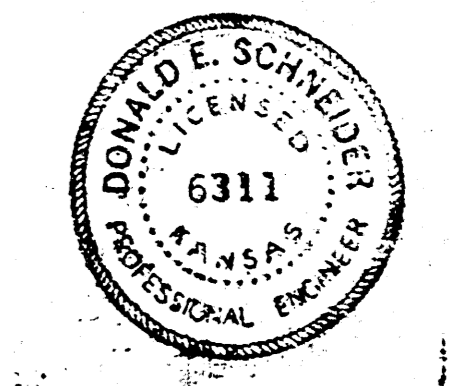

PROJECT DESCRIPTION
BRUNSWICK AVE. 3/7

PROJECT NUMBER
 172 76 245 81239 000 000 001

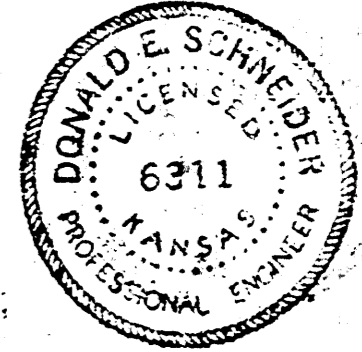
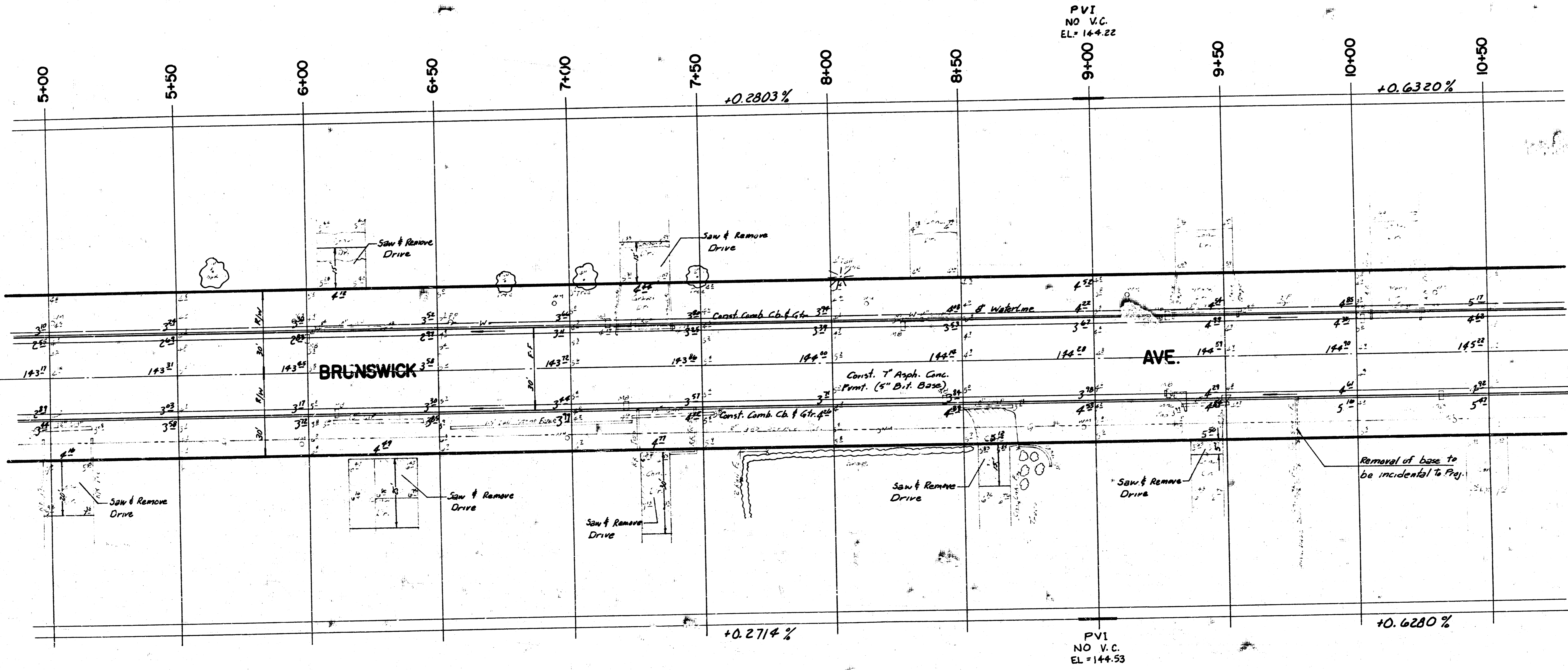
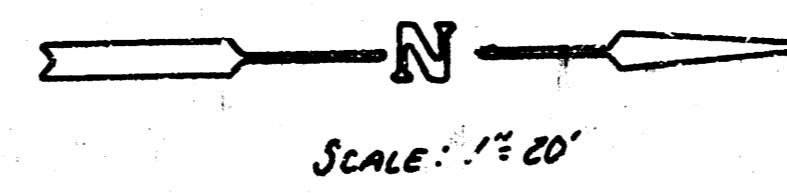

PROJECT DESCRIPTION
BRUNSWICK AVE. 1/7

PROJECT NUMBER
 472 76 245 81239 000 000 001

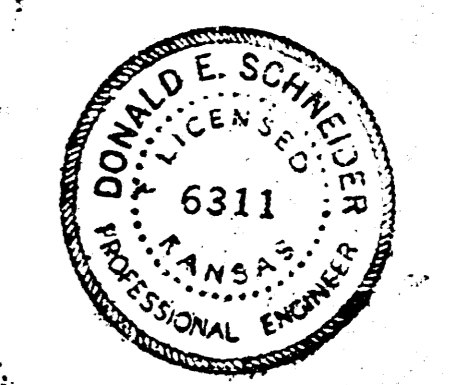
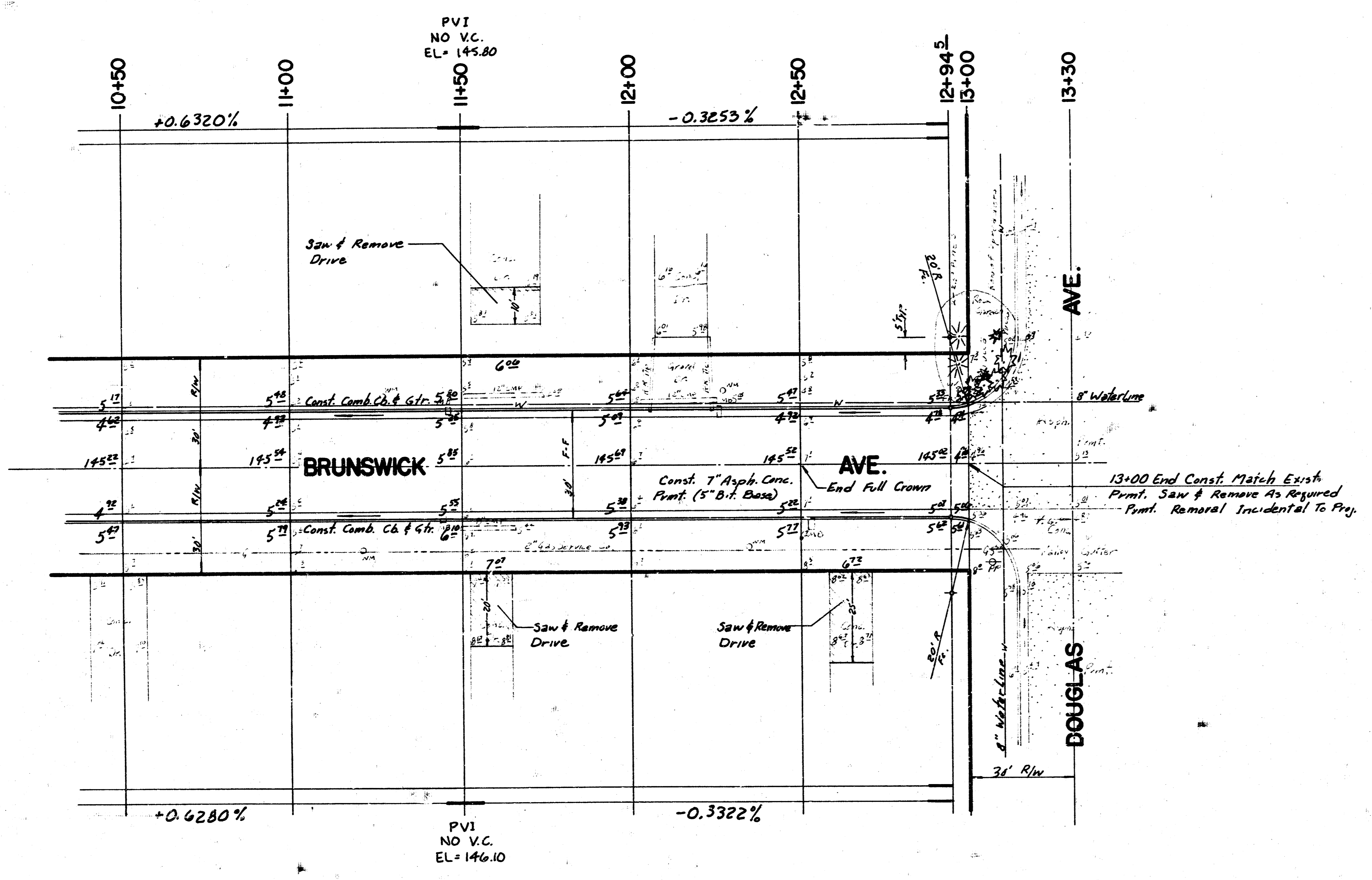
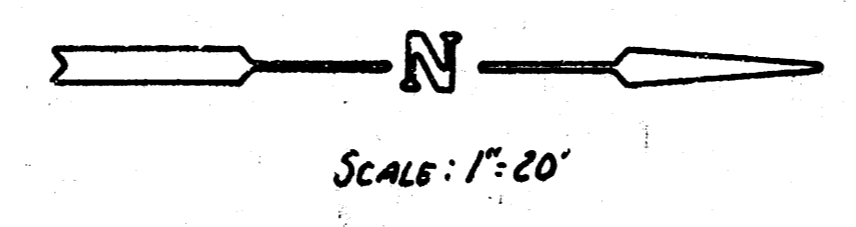

PROJECT DESCRIPTION
BRUNSWICK AVE. 5/7

PROJECT NUMBER
472 76 245 81239 000 000 001

Sheet 1021
1:64000

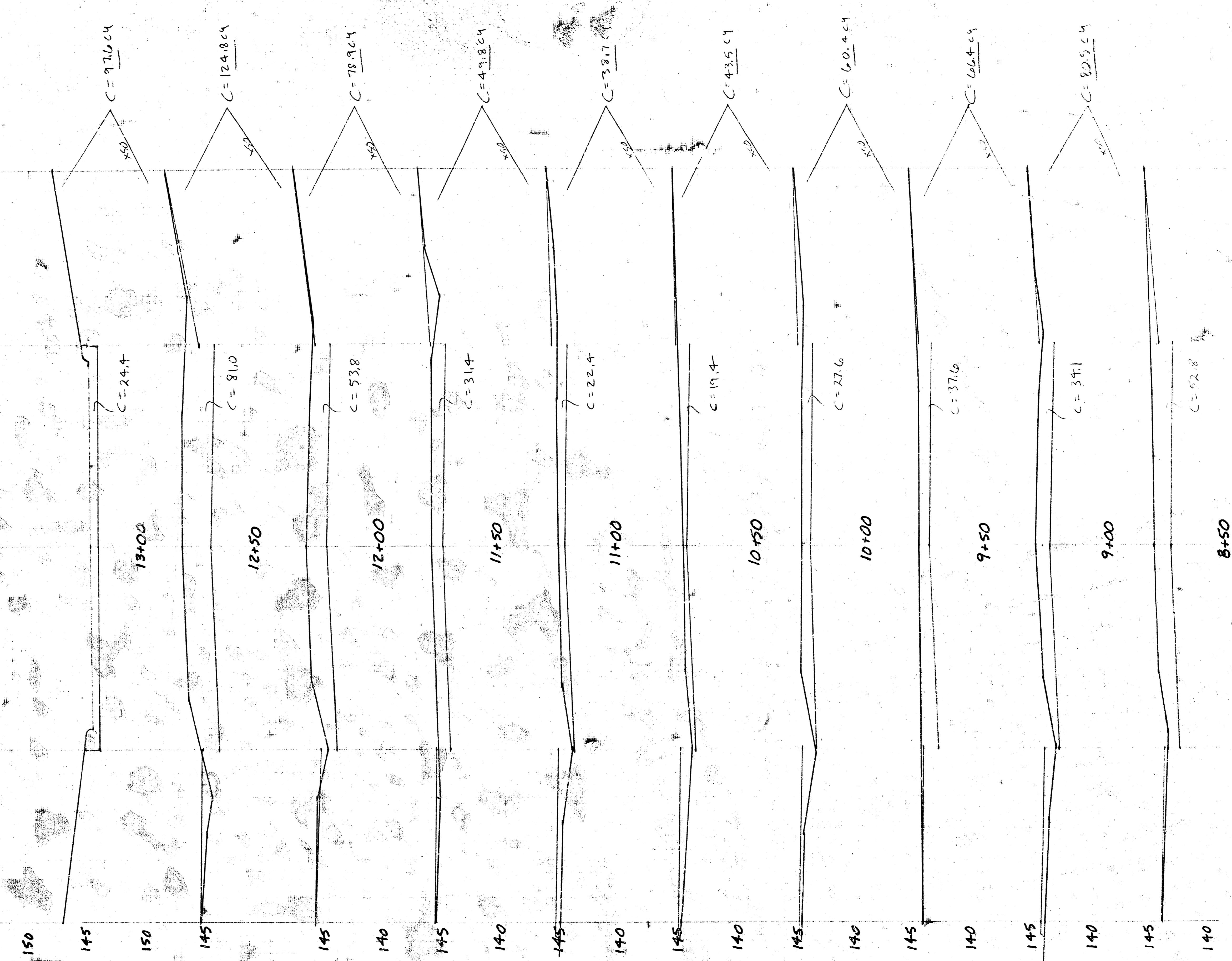

30 35 40 45 50 55 60 65 70 75 80

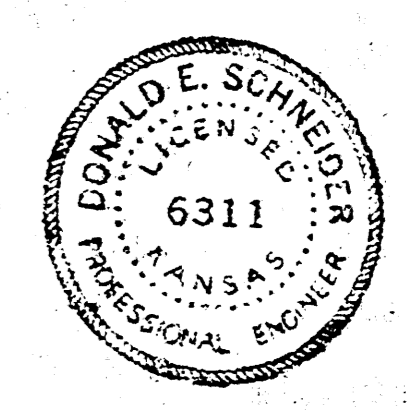

BRUNSWICK AVE.
472 76 245 81239 000000001

10 5 1 2
7/1

FILMED FROM THE BEST
AVAILABLE COPY