

B.M. 123.97 R.R. Spike S. Side P. Pole  
 @ N.W. Corner 21<sup>st</sup> & Hyacinth.

B.M. 127.93 "M" in Muller, Fire Hyd.  
 @ S.E. Corner Hyacinth & Benjamin.

B.M. 127.31 "M" in Muller, Fire Hyd.  
 @ S.E. Corner Benjamin & Bullinger.

NOTE: Loose fill to be removed and  
 compacted. X-Sections shall be taken  
 prior to compaction operations.

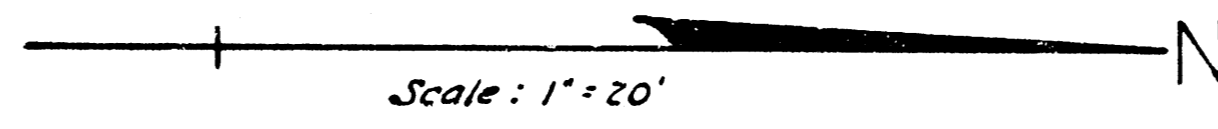

Excess excavation to be used to fill  
 parkings & adjacent low areas.

11/10/24  
 JFG  
 JLM  
 11/10/24

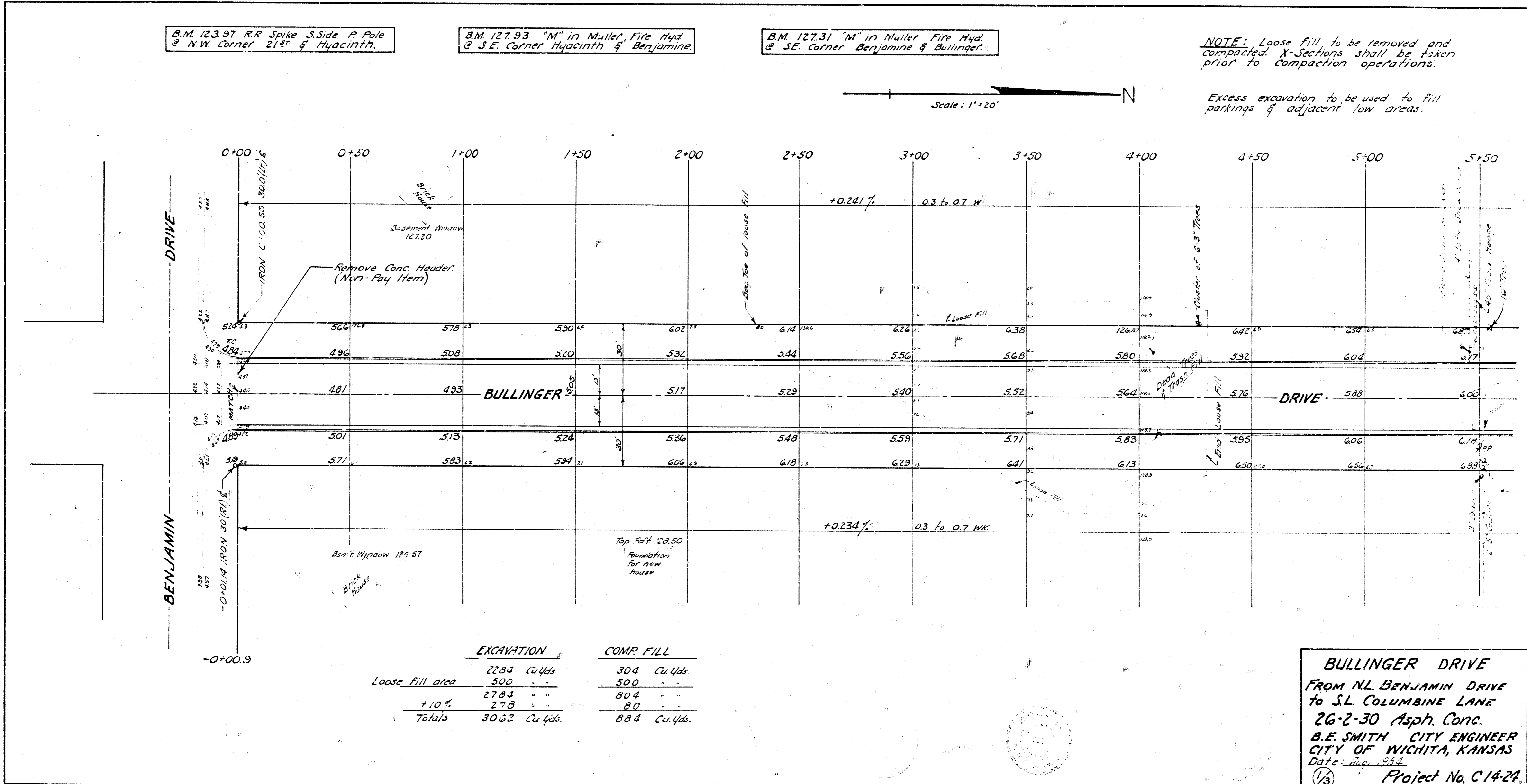

	EXCAVATION	COMP. FILL
Loose fill area	2284 Cu Yds.	304 Cu Yds.
+10%	2783	804
Totals	3062 Cu Yds.	884 Cu Yds.

**BULLINGER DRIVE**  
 FROM N.L. BENJAMIN DRIVE  
 TO S.L. COLUMBINE LANE  
 26-2-30 Asph. Conc.  
 B.E. SMITH, CITY ENGINEER  
 CITY OF WICHITA, KANSAS  
 Date: Aug. 1924  
 (13) Project No. C14-24

