

BM. 1504 S.E. COR. LOWER STEP HQ. 149 N.W. MT. CARMEL & BURTON

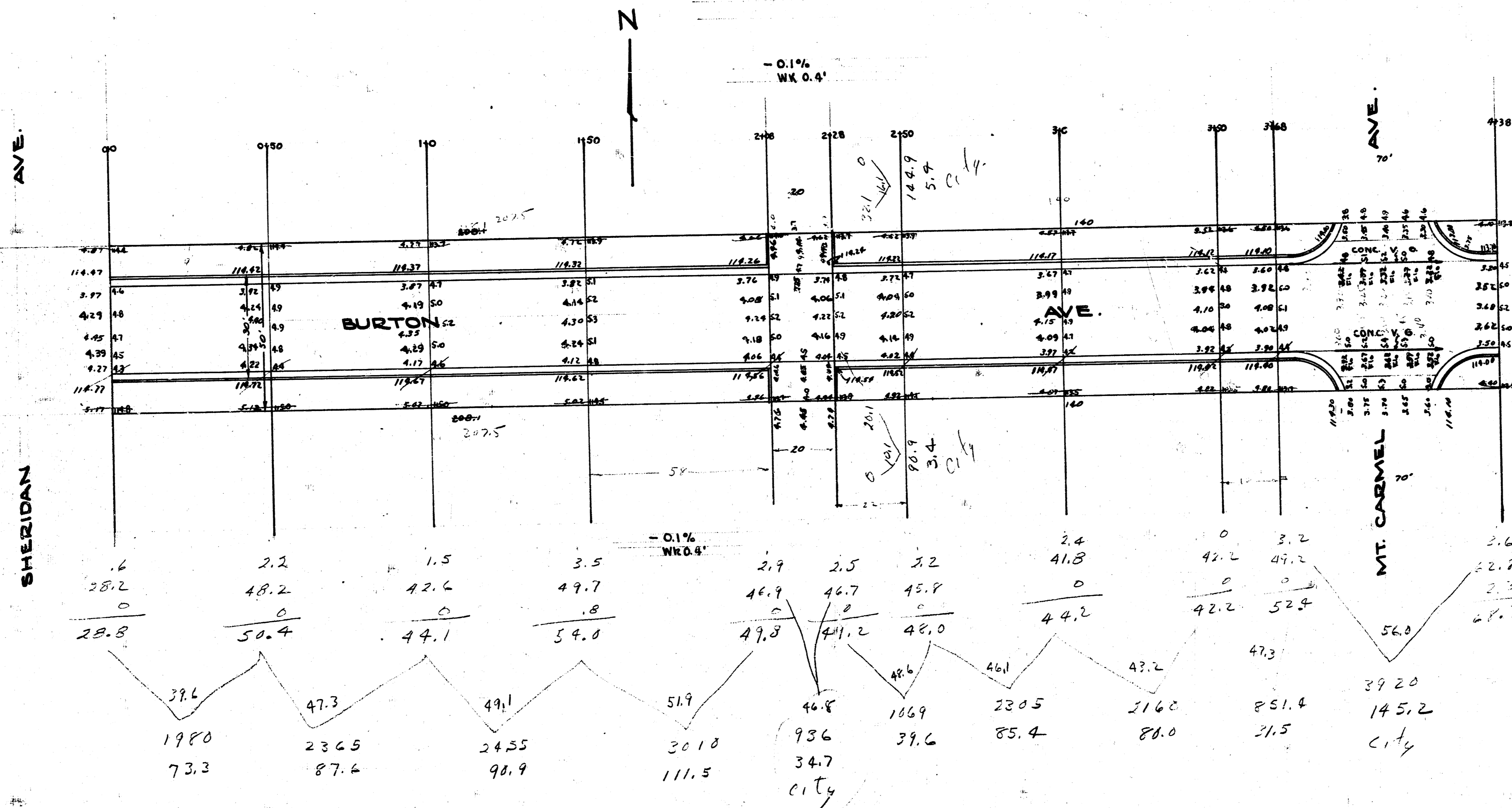

City	Prop.
5.4	73.3
3.4	87.6
34.7	71.7
22.8	111.5
20.0	37.6
145.2	85.4
231.5	21.0
23.2	21.5
254.7	599.8
	60.9
	659.8

Total City	Total Prop.
254.7	659.8
613.9	1275.1
988.6	2354.9

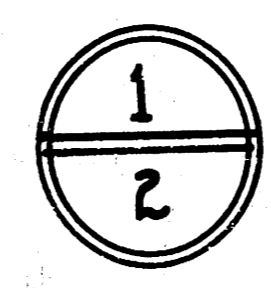

BURTON AVE.
 W. SHERIDAN to E. ST. PAUL.
 26-2-30 ASPH. CONC.
 CITY OF WICHITA, KANS.
 L.K. WHITE CITY ENGINEER
 MARCH 1947

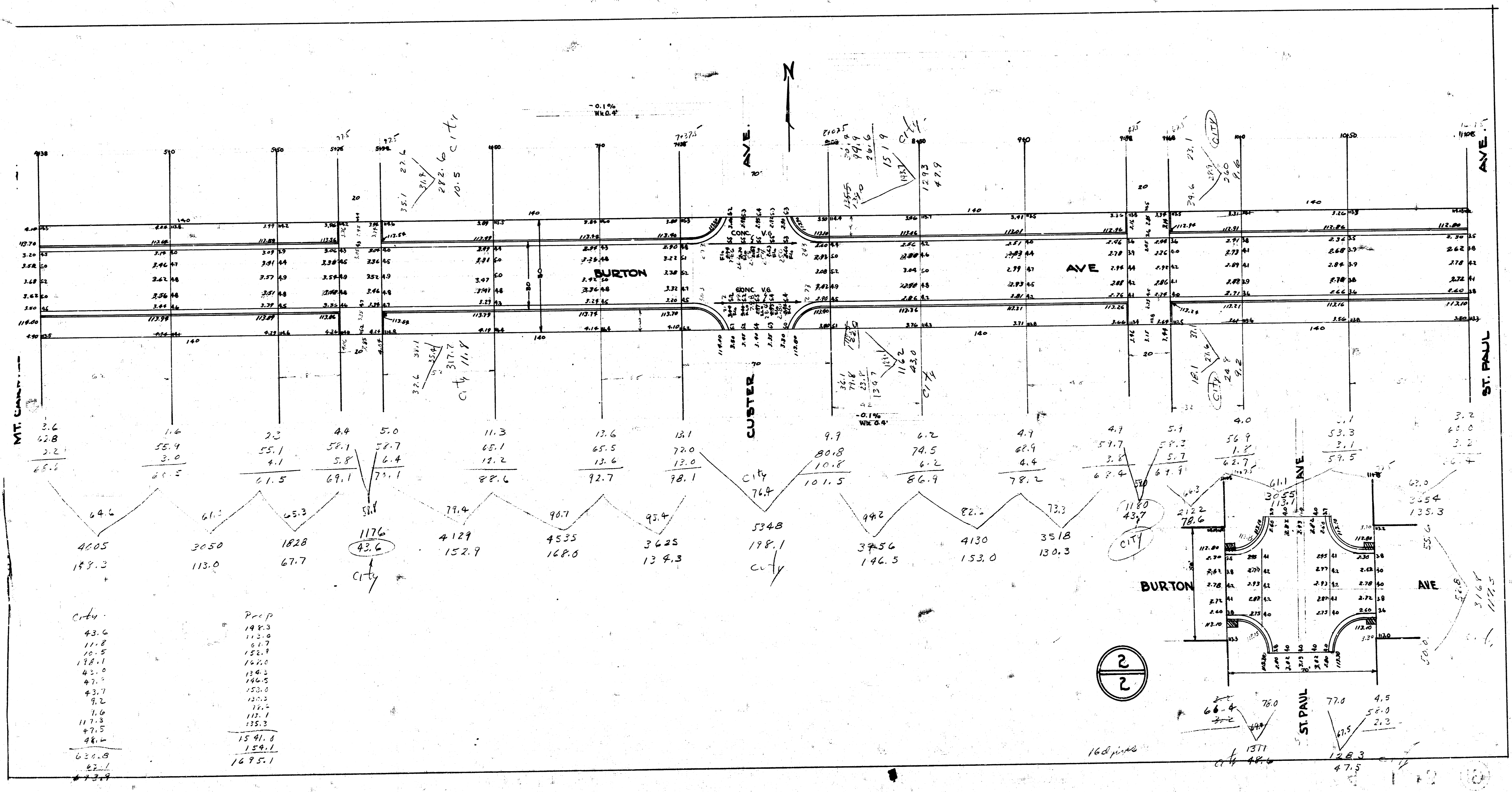

Plan view data table (approximate values):

Station	Width	Area	Notes
438	140	64.6	
510	140	61.5	
590	140	61.5	
596	140	69.1	
596	140	73.1	
600	140	88.6	
700	140	92.7	
708	140	98.1	
737.5	140	101.5	
800	140	86.9	
890	140	78.2	
990	140	73.3	
1095	140	53.3	
1102	140	40.0	

Summary and calculation tables:

City	Area
City	43.6
City	11.8
City	10.5
City	18.1
City	43.0
City	47.5
City	43.7
City	9.2
City	7.6
City	17.3
City	47.5
City	48.4
City	630.8
City	67.1
City	43.4

Prop	Area
Prop	19.3
Prop	112.0
Prop	61.7
Prop	152.9
Prop	142.0
Prop	134.3
Prop	146.5
Prop	153.0
Prop	150.3
Prop	16.5
Prop	112.1
Prop	135.3
Prop	1541.8
Prop	159.1
Prop	1675.1

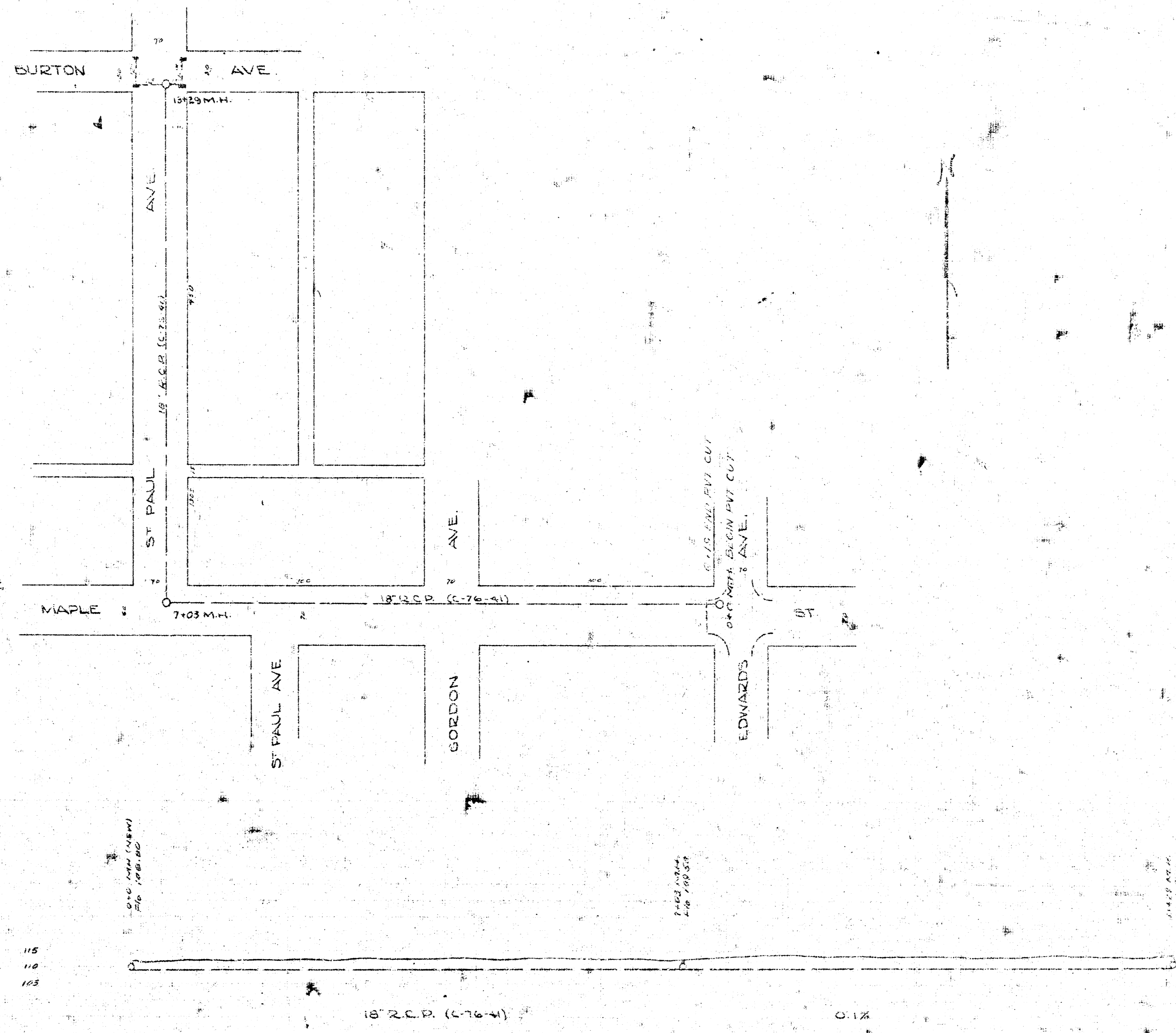

INCIDENTAL DRAINAGE IN CONJUNCTION WITH PAVING BURTON AVE.
 FROM W.L. SHERIDAN TO E.L. ST. PAUL

SW 1325 7th St. 1st 3' NE of Maple & Edwards
 SW 1325 7th St. 1st 3' NE of Maple & Edwards
 St. Paul & Burton

DEPARTMENT OF SERVICE
CITY OF WICHITA, KANSAS
 ENGINEERING DIVISION
 L.K. WHITE - CITY ENGINEER
 STORM WATER SEWER
 Scale 1"=80' APRIL 1947
 INCIDENTAL DRAINAGE - PAVING OF
 BURTON - W.L. SHERIDAN - E.L. ST. PAUL