

NOTE: USE THIS B.M. ON THIS PROJECT ONLY!!

B.M. 130.27 NW cor conc. porch Ho# 2582 Bullinger.
Stationing on a 6" offset from face E.C.

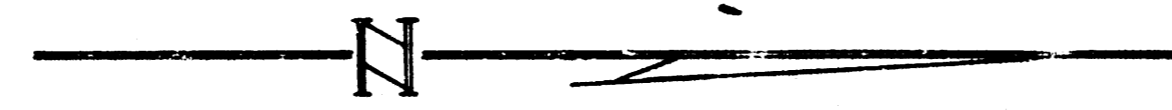

CURVE DATA: Sta. 7+66.07 to Sta. 8+86.93 on 6" offset from face E. curb. R= 205.70' Δ= 33° 40'

STATION	Arc Length 6" offset E.C.	Deflection Angle	Total Deflection	Chord Length 6" offset E.C.	Chord Length 6" offset W.C.
7+66.07					
+89.16	28.09	3° 12' 57"	3° 12' 57"	23.07	27.79
8+00	10.84	1° 20' 35"	4° 33' 32"	10.85	13.05
+25	25.0	3° 28' 54"	8° 12' 26"	24.98	30.09
+50	25.0	3° 28' 54"	11° 41' 20"	24.98	30.09
+75	25.0	3° 28' 54"	15° 10' 14"	24.98	30.09
8+86.93	11.93	1° 39' 41"	16° 49' 55"	11.93	14.36

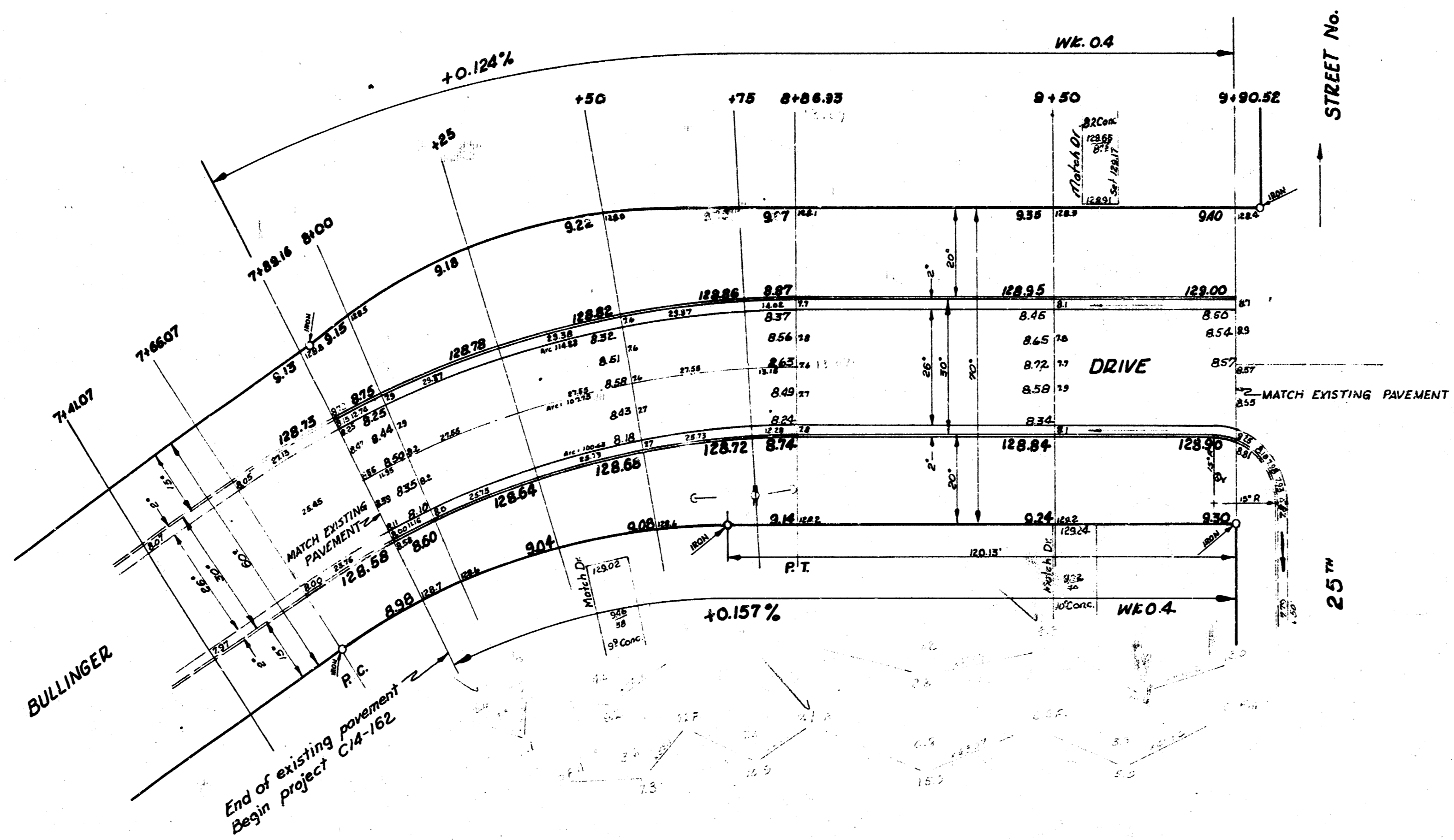

EXCAVATION TOTALS

PROPERTY 0.77

22.7
2.2
2.4
2.7
2.0

BULLINGER DRIVE
 NL Lot 23, Blk. 1 Riverlawn Heights Adds to SL 25th St.
 26'-2'-30" A.C.
 CITY OF WICHITA, KANSAS
 B.E. SMITH CITY ENGINEER
 APRIL 1958 PROJ. NO. C14-162

