

B.M. NE COR CORNER PORCH HO # 2561 NO. SALINA ELEV. 125.97
 B.M. "R" IN RT. W. E. W. C. OF BURNS & S.L. 25TH ELEV. 125.635

NOTE
 MATCH EXIST. PAVT. AT BOTH
 ENDS OF PROJECT.

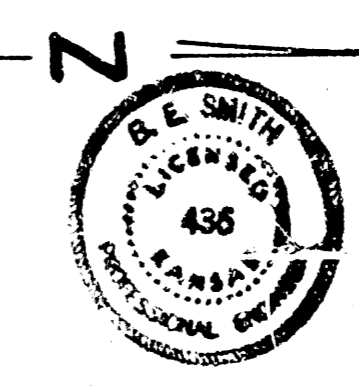
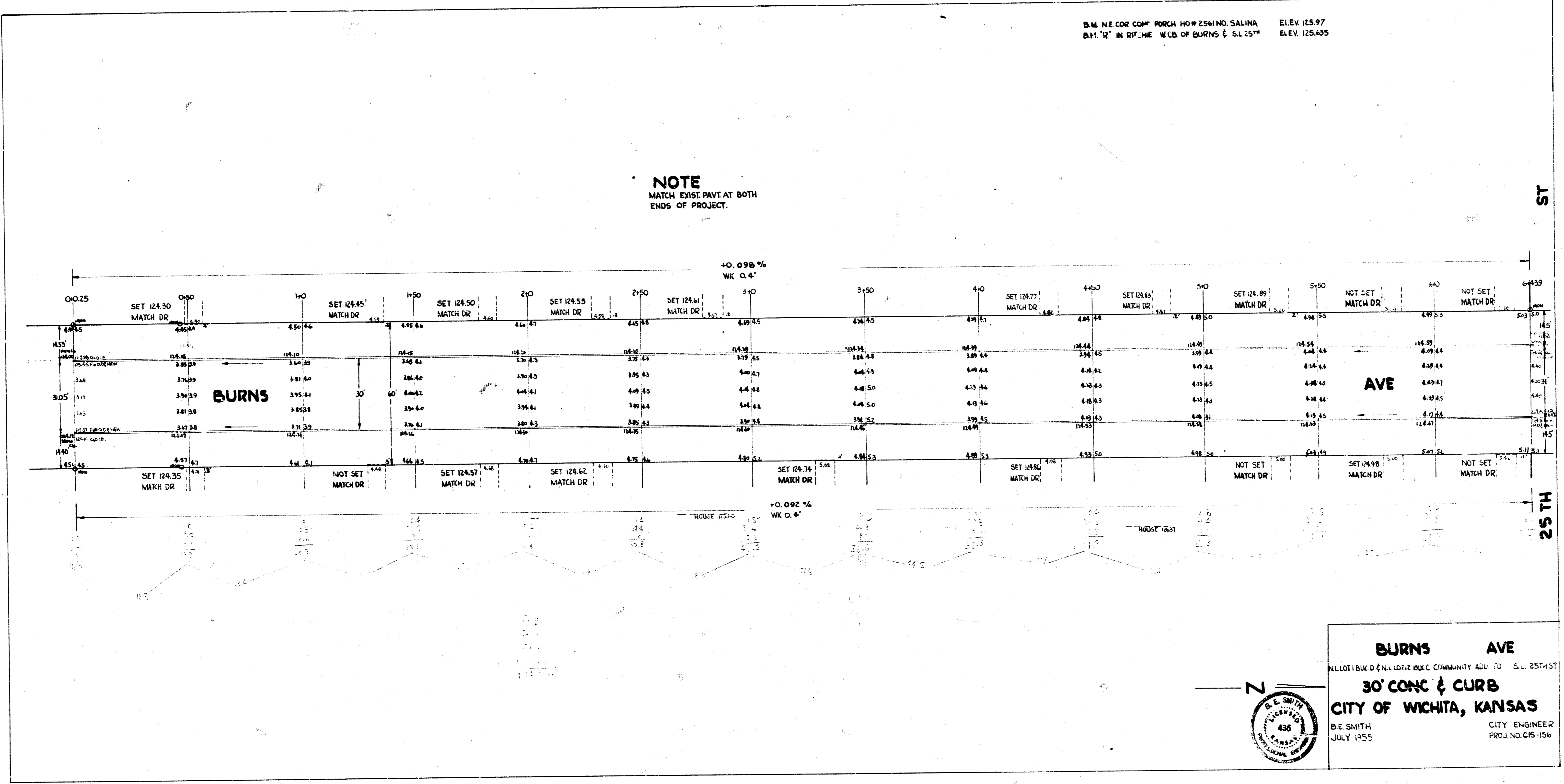

BURNS AVE
 30' CONC & CURB
 CITY OF WICHITA, KANSAS
 B.E. SMITH CITY ENGINEER
 JULY 1955 PROJ. NO. C15-156