

B.M. 174.11 "R" in Fitchie Top S. Cb. Rockwood @ E.L. Mission

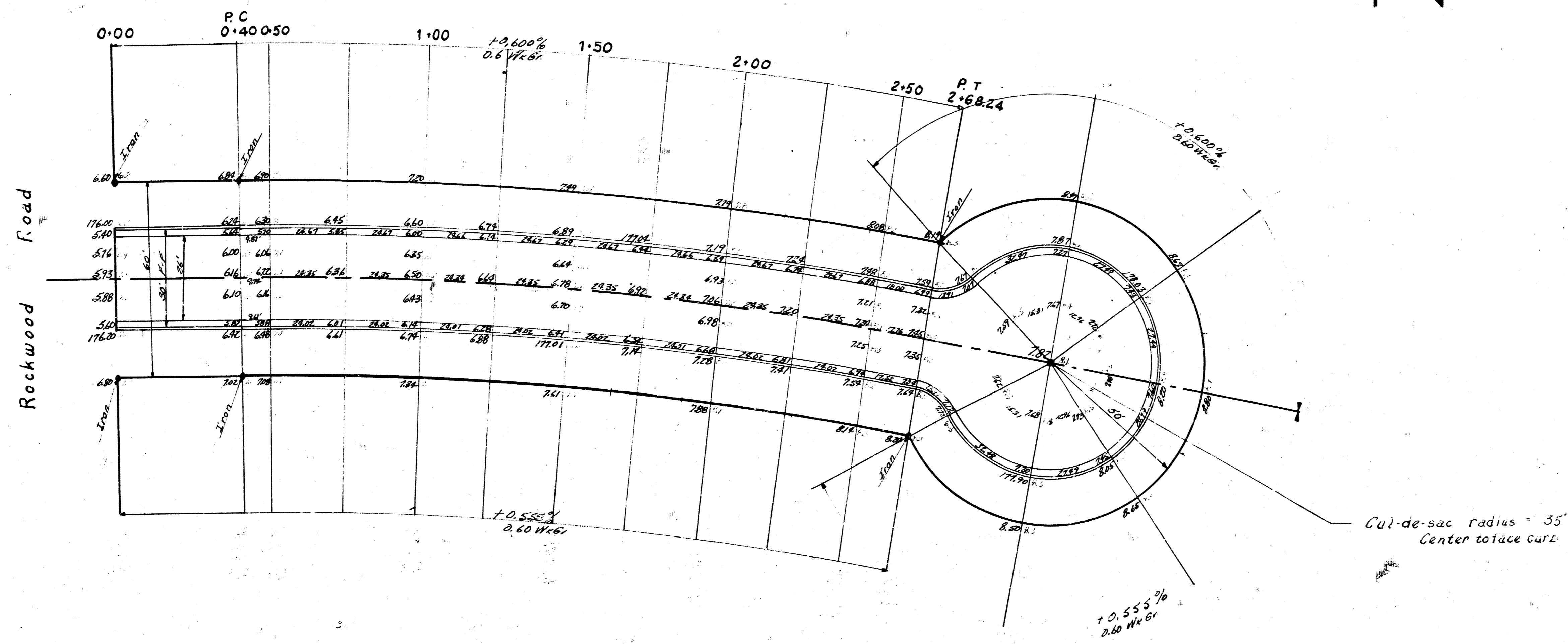
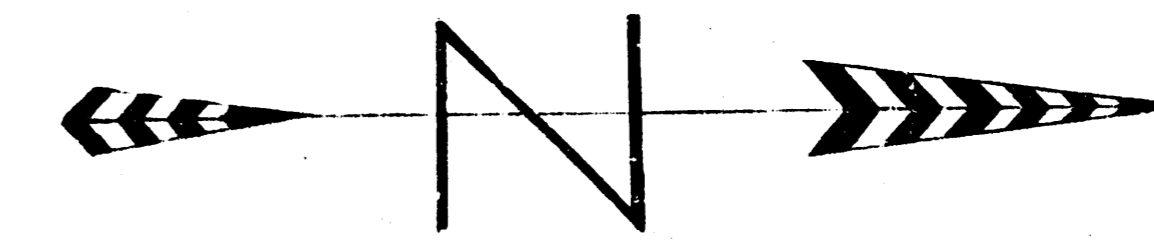

Curve Data Based on W.P. R=1145.0' Δ=1°25'16"

Sta	Arc	Chord	Deflection	Total Def'ts
P.C. 0+40	0	0	0° 00' 00"	0° 00' 00"
1+00	25	24.95	0° 37' 38"	0° 37' 38"
1+50	50	49.89	0° 57' 51"	0° 57' 51"
2+00	75	74.84	1° 18' 04"	1° 18' 04"
2+50	100	99.79	1° 38' 17"	1° 38' 17"
P.T. 2+68.24	128.24	128.12	1° 58' 30"	1° 58' 30"

Defl. Per Ft. 1.5012 mins

Excavatio  
 722.1 C.Y.  
 92.2 +10%  
 1014.3 Total C.Y.

Brookfield Place  
 NL Rockwood to incl cul-de-sac  
 26-2-30 A.C.  
 City of Wichita, Kansas  
 B.E. Smith City Engineer  
 Date April 1933, Proj. C 10-45

