

CURVE DATA					
LINEAR	LENGTH	RADIUS	Δ	TAN	L.C.
C-1	20.46'	211.58'	15°41'00"	20.84'	20.84'
C-2	62.11'	554.77'	10°54'01"	6.114'	62.02'
C-3	38.00'	330.77'	6°46'40"	19.31'	38.00'
C-4	34.97'	185.12'	11°26'52"	18.55'	34.91'

NOTES:
 1. REMOVE AND REPLACE ASPHALT SURFACE AS NECESSARY TO PROVIDE SMOOTH TRANSITION.
 2. EXISTING PER CITY OF MICHIGAN SEE NOTES #1, #2.
 3. PER CITY OF MICHIGAN SEE NOTES #1, #2.

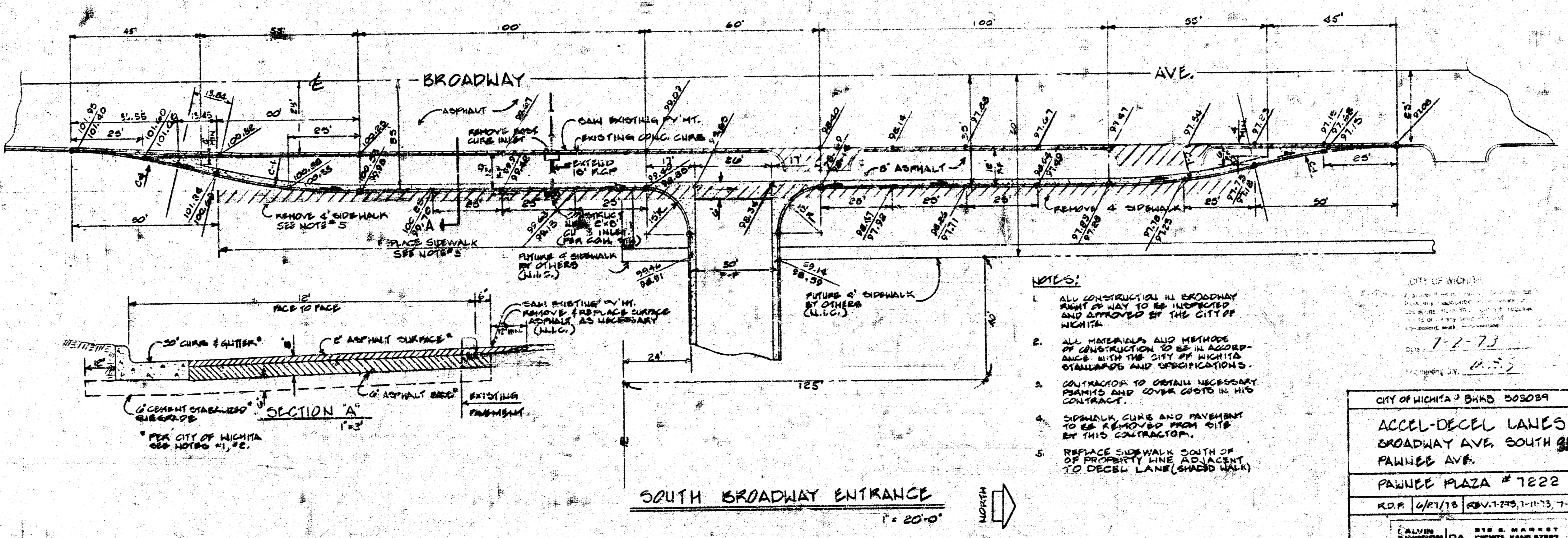

- NOTES:
1. ALL CONSTRUCTION IN BROADWAY RIGHT OF WAY TO BE INSPECTED AND APPROVED BY THE CITY OF MICHIGAN.
 2. ALL MATERIALS AND METHODS OF CONSTRUCTION TO BE IN ACCORDANCE WITH THE CITY OF MICHIGAN SPECIFICATIONS AND SPECIFICATIONS.
 3. CONTRACTOR TO OBTAIN NECESSARY PERMITS AND COVER COSTS IN HIS CONTRACT.
 4. SIDEWALK CURBS AND PAVEMENT TO BE A 20' WIDE FROM DIBS BY THIS CONTRACTOR.
 5. REPLACE SIDEWALK SOUTH OF 25' PROPERTY LINE TO A CURB TO DECEL LANE (SHOULDER).

CITY OF MICHIGAN BLDG 005039
 ACCEL-DECEL LANES
 BROADWAY AVE, SOUTH OF
 FAWNEE AVE.
 FAWNEE PLAZA # 7222
 R.D.# 4/RT/19 REV. 7-73, 1-11-73, 7-18-73

ALVIN B. BARNETT, P.E.
 B.S. MARKET
 CIVIL ENGINEER
 PROJECT ENGINEER