

B.M. 102.25 W in Wilson Bk. Wh. NE. Cr. Elm. & Boston  
 B.M. 102.48 X in Top Ch. E.S. Greenwood - 1' N of W.L. Boston

B.M. 104.40 T in Tray Top Hydr. N.W. Cr. Hydraulic & Boston

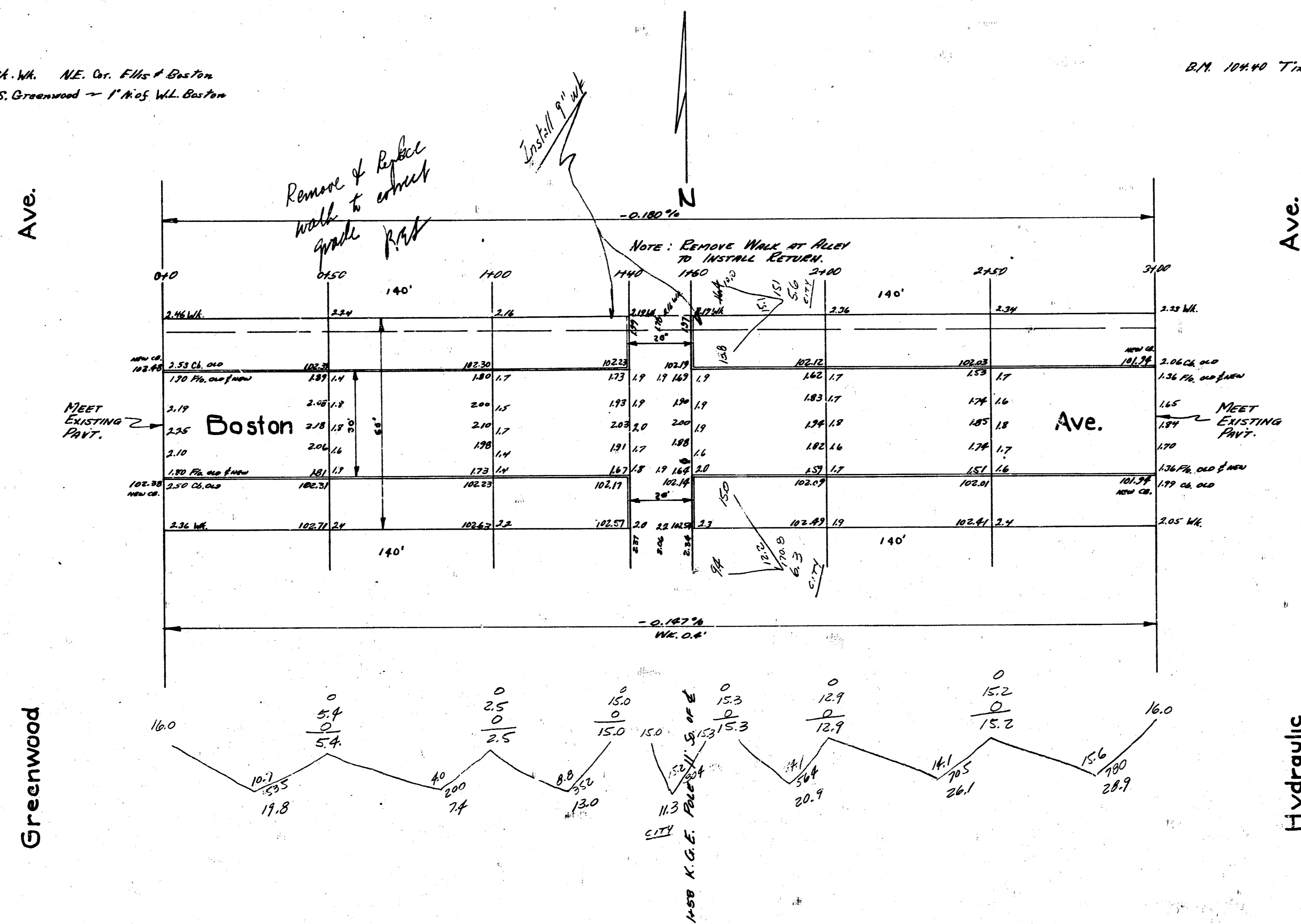

ELEVATION

PROJECTIONS	EXIST.
19.8	5.2
7.2	4.3
15.0	11.3
20.7	23.2
24.1	41.2
23.7	23.7
116.1	33.5 ch. 10.
±10%	
127.7 ch. 10.	

**Boston Ave.**  
 E.L. Greenwood - N.L. Hydraulic  
 30' Conc. & Curb  
 City of Wichita, Kansas  
 L.K. White - City Engineer  
 March 1949 Proj. # C19-35