

B.M. 126.67 R.P. Spk. S. Side F.R. N. Side 2nd St. & River Bk
 B.M. 125.11 " " in Ditchie W.L. Hyacinth S. Ch. Benjamin
 B.M. 131.37 N.E. Cor. State Mon. NW. Cor. 2nd & Cardinal Dr.

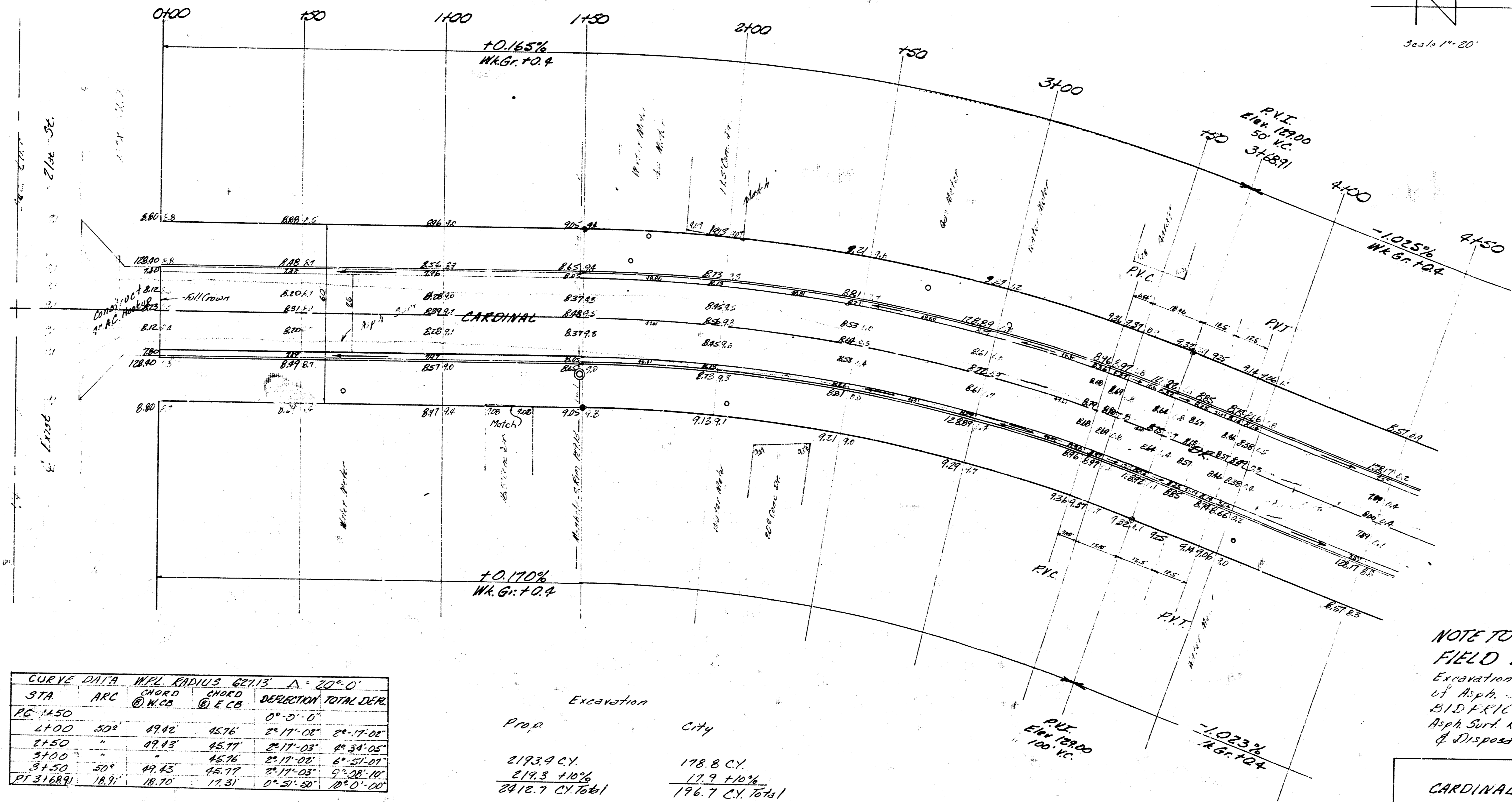
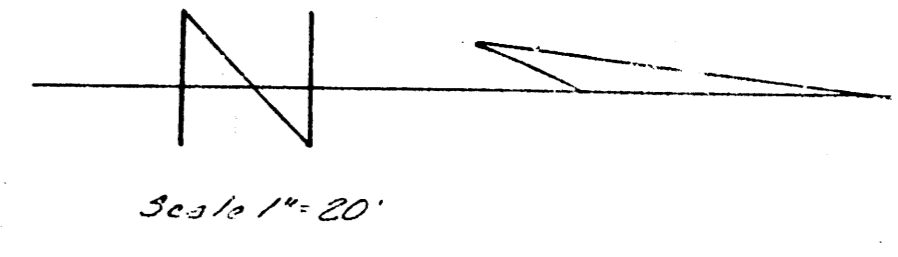

Base Line = W.L. Cardinal Dr.

STA	ARC	WPL	RADIUS	GEN'S	Δ	20' Δ
PC 4+50	50'	49.42	4576	2° 17' 05"	2° 17' 05"	2° 17' 05"
PI 4+50	-	49.13	4577	2° 17' 05"	2° 17' 05"	2° 17' 05"
PT 4+50	50'	49.43	4576	2° 17' 05"	2° 17' 05"	2° 17' 05"
PT 3+168.91	18.91'	18.70	17.51	0° 51' 30"	0° 51' 30"	0° 51' 30"

2.74086 min. 1/4"

Excavation	City
2193.9 CY	178.8 CY
2193.3 ±10%	177.9 ±10%
2412.7 CY 1641	196.7 CY 1641

NOTE TO CONTRACTOR & FIELD ENGR.

Excavation includes the volume of Asph. Surface BID PRICE for 5% Vol. of Asph. Surf. Rem. includes removal & Disposal.

CARDINAL DRIVE
 N.W. 21ST ST TO N.E. BENJAMIN DR.

26'-0" - 30' A.C.

CITY OF WICHITA, KANSAS
 B.E. SMITH CITY ENGINEER
 DATE MARCH 1987 PROJ. NO. C15-18



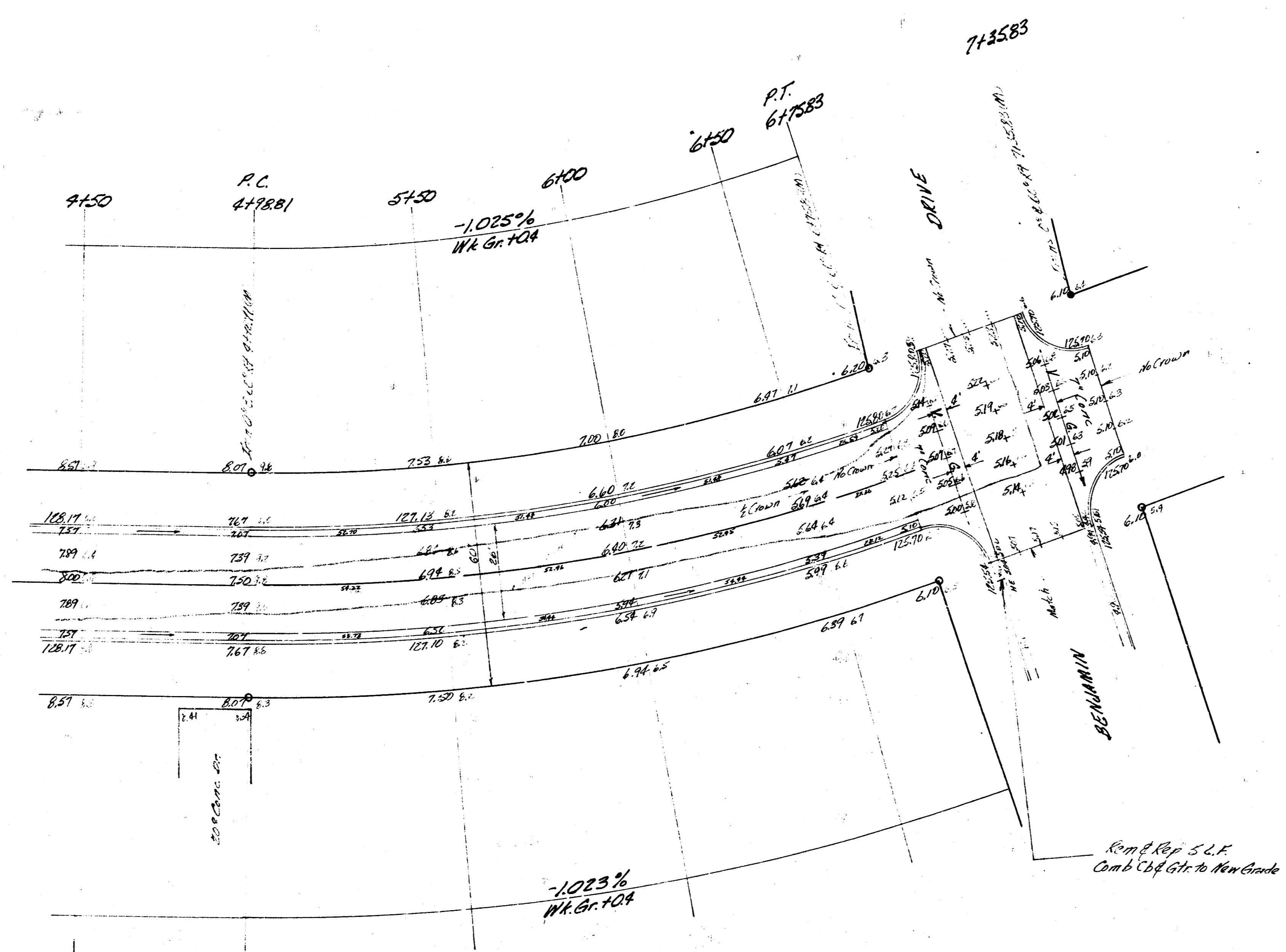

CURVE DATA W.P.L. 507.13 Δ = 20° 0'				
STA	P.C.	CHORD @ M.C.B.	CHORD @ E.C.B.	DEFLECTION TOTAL DATA
4150	4178.81	51.87	34.51	0° 0' 0"
6100	5150	50.0	55.20	2° 53' 30"
6150	5150	50.0	55.21	2° 57' 2"
P.T. 6175.83	5150	25.83	28.53	1° 27' 23"

3.38461 min/lr